

F.A.Z. NO.	SECTION	COUNTY	TOTAL SHEETS	SHEET NO.
55	2004-1196RR	WILL	15	14
STA.	TO STA.			
FED. ROAD DIST. NO. 1	ILLINOIS	FED. AID PROJECT		

CONTRACT No. 62885

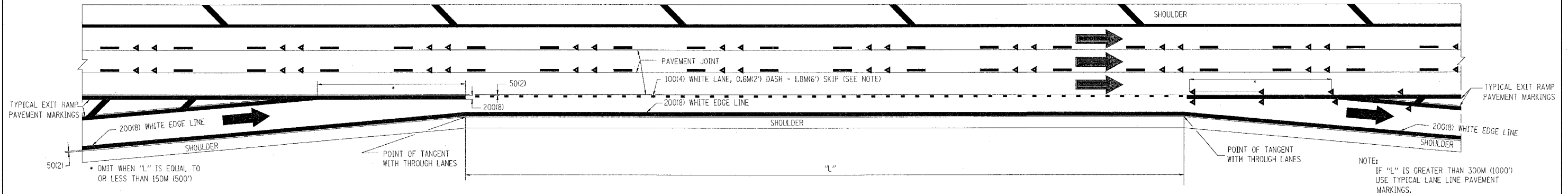

TYPICAL ENTRANCE/EXIT RAMP COMBINATION PAVEMENT MARKINGS

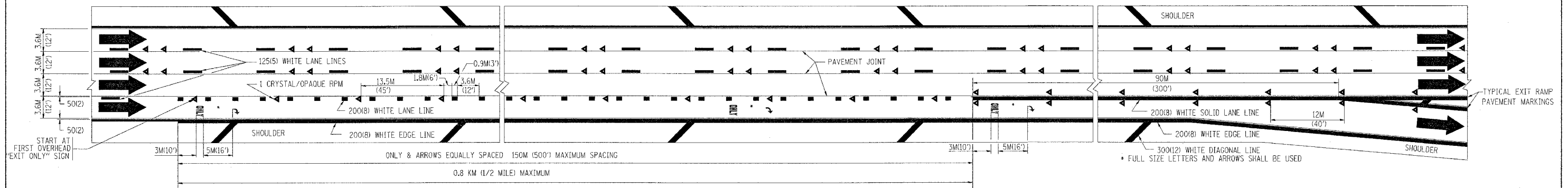

TYPICAL EXIT ONLY LANE PAVEMENT MARKINGS

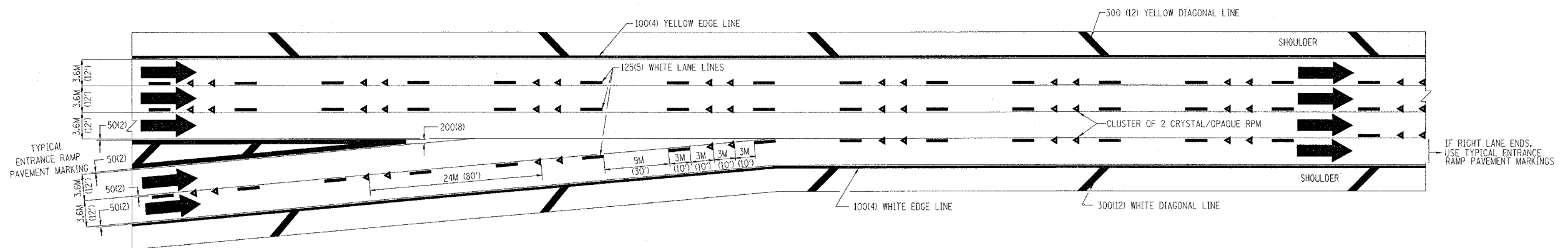

TYPICAL TWO LANE ENTRANCE RAMP PAVEMENT MARKINGS

REVISIONS	
NAME	DATE
DWS	1/90
DWS	5/91

ILLINOIS DEPARTMENT OF TRANSPORTATION

**MULTI-LANE FREEWAY  
PAVEMENT MARKING  
DETAILS**

SCALE: NONE  
DATE: 4/18/2005

DRAWN BY C.A.D.D.  
CHECKED BY

TC12 SHEET 2 OF 2

REVISION DATE: 01/01/96