

STATE OF ILLINOIS
DEPARTMENT OF TRANSPORTATION

ROUTE NO.	SECTION	COUNTY	TOTAL SHEETS	SHEET NO.	SHEET NO. 1 3 SHEETS
		Will	14	7	
FED. ROAD DIST. NO. 7	ILLINOIS	FED. AID PROJECT			

62900

GENERAL NOTES

Plan dimensions and details relative to existing structure have been taken from existing plans and are subject to nominal construction variations. It shall be the Contractor's responsibility to verify such dimensions and details in the field and make necessary approved adjustments prior to construction or ordering of materials. Such variations shall not be cause for additional compensation for a change in the scope of the work, however, the Contractor will be paid for the quantity actually furnished at the unit price bid for the work.

Any damage done to the bridge during beam removal shall be repaired by the Contractor. Cost to be included in the cost of "Removal of Existing P.P.C. Deck Beams".

Reinforcement bars shall conform to the requirements of AASHTO M-31 or M322 Grade 60.

The top surface of the beams shall be finished in accordance with Article 504.06 of the Standard Specifications except that the surface shall not be roughened by brooming. The finished surface shall be free of depressions or high spots with sharp corners, and the top edge of keys shall be rounded or chamfered a minimum of 1/4".

Temporary concrete barrier shall only be anchored into the overlay and not the PPC Deck Beams.

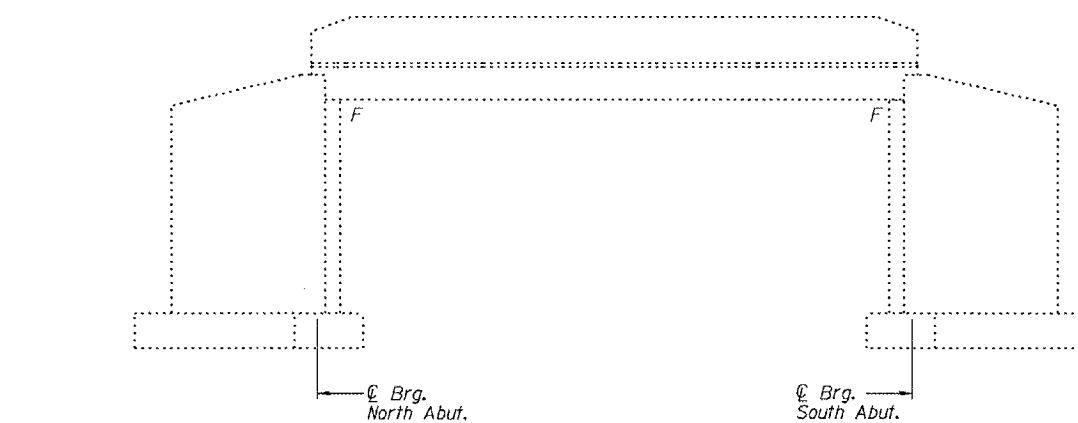

ELEVATION

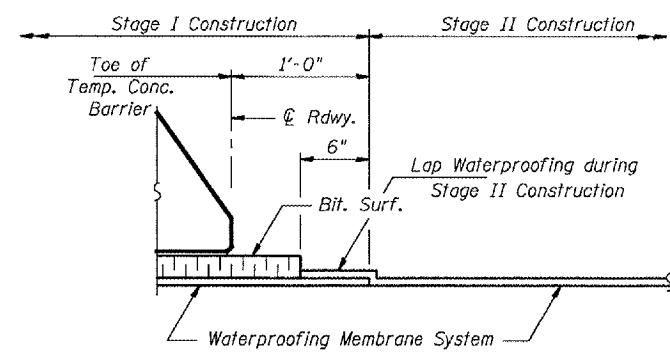
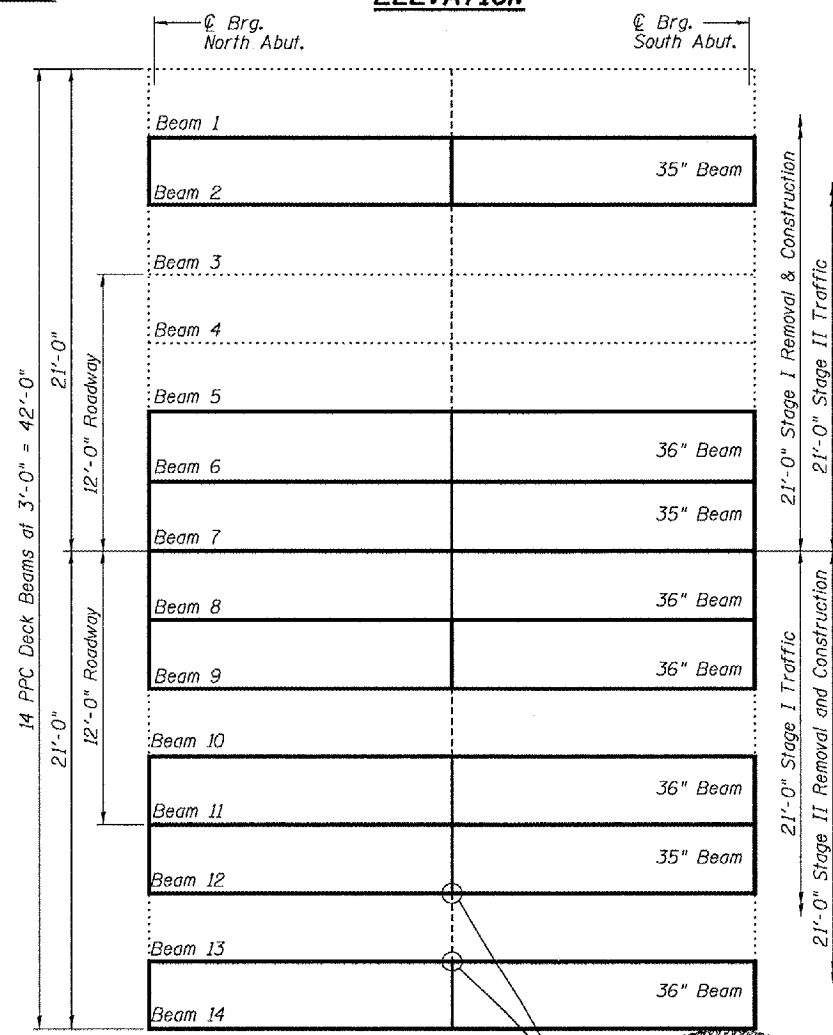

WATERPROOFING TREATMENT AT STAGE CONSTRUCTION

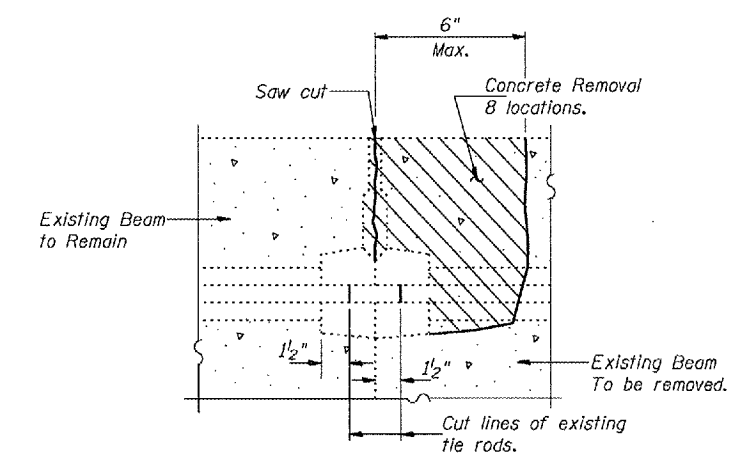

BEAM REMOVAL DETAIL AT TRANSVERSE TIES

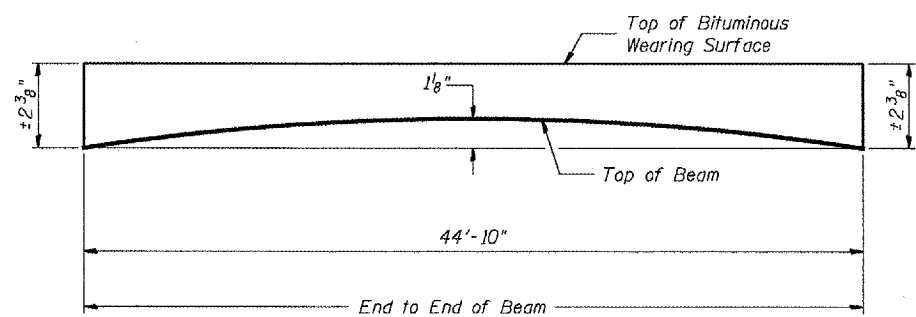

ANTICIPATED INITIAL CAMBER DIAGRAM

DESIGN STRESSES

FIELD UNITS

f'c = 3,500 psi
f'y = 60,000 psi

DESIGN STRESSES

PRESTRESS UNITS

f'c = 5,000 psi
f'ci = 4,000 psi
f's = 270,000 psi (1/2" Low Relaxation Strands)
f'si = 201,960 psi (1/2" Low Relaxation Strands)

TOTAL BILL OF MATERIAL

ITEM	UNIT	QUANTITY
Precast Prestressed Concrete Deck Beams (21" Depth)	Sq. Ft.	1065
Bituminous Concrete Surface Removal	Sq. Yd.	83.6
Removal of Existing PPC Deck Beams	Sq. Ft.	1076
Bituminous Concrete Surface Course, Superpave Mix "D" NS0	Tons	21.8
PC Mortar Fairing Course	Foot	494
Reinforcement Bars, Epoxy Coated	Pound	830
Waterproofing Membrane System	Sq. Yd.	193.5
Concrete Superstructure	Cu. Yd.	5.2
Concrete Removal	Cu. Yd.	5.2
Protective Coat	Sq. Yd.	19.5

* Includes only bituminous on beams to remain.

Existing Tie Rods to be cut (Typ). See Detail This sheet.

PLAN

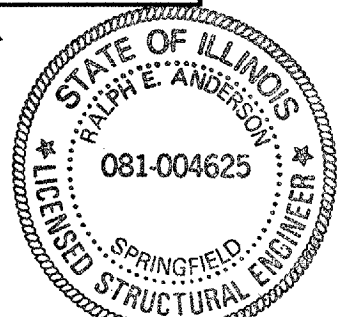

Expires 11-30-06

DESIGNED	Michael H. Velazquez
CHECKED	Ronald Fisher
DRAWN	[Signature]
CHECKED	VHV P35

EXAMINED	John A. Morris	May 8, 2005
PASSED	Ralph E. Anderson	

**PLAN AND ELEVATION
US 45 OVER NORTH
BRANCH PRAIRIE CREEK
WILL COUNTY
SN.099-0118**