

F.A.I. RTE.	SECTION	COUNTY	TOTAL SHEETS	SHEET NO.
412	(62-2VB)I	MARSHALL	19	6
FED. ROAD DIST. NO. ILLINOIS PROJECT				

GENERAL NOTES

Existing reinforcement bars extending into the concrete removal area (abutment), that are to remain, shall be cleaned, straightened and incorporated into the new concrete. If reinforcement bars that are to remain, are damaged during concrete removal operation, or the Engineer has determined that they are deteriorated beyond effectiveness, the bars shall be cut off flush with the concrete and v (E) bars shall be drilled and epoxy grouted. The cost of drilling and grouting new bars shall be paid for as specified elsewhere.

Existing approach slab seat shall be thoroughly cleaned prior to placement of concrete, and all unsuitable material shall be removed. The Contractor shall monitor the approach slab seat during the concrete placement to insure the seat remain clean and free from all unsuitable material.

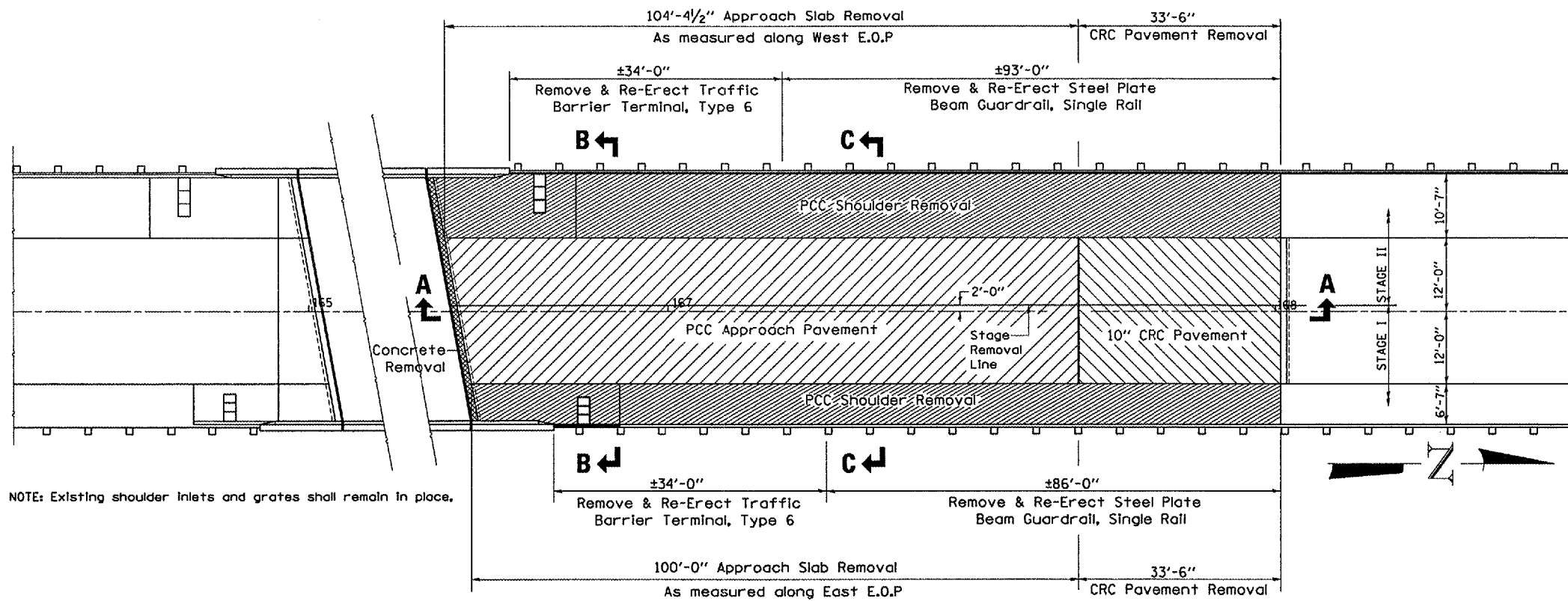

NOTE: Existing shoulder inlets and grates shall remain in place.

- APPROACH SLAB REMOVAL
- CRC PAVEMENT REMOVAL
- STRUCTURE EXCAVATION
- EARTH EXCAVATION
- PCC SHOULDER REMOVAL

PLAN
NORTH APPROACH PAVEMENT

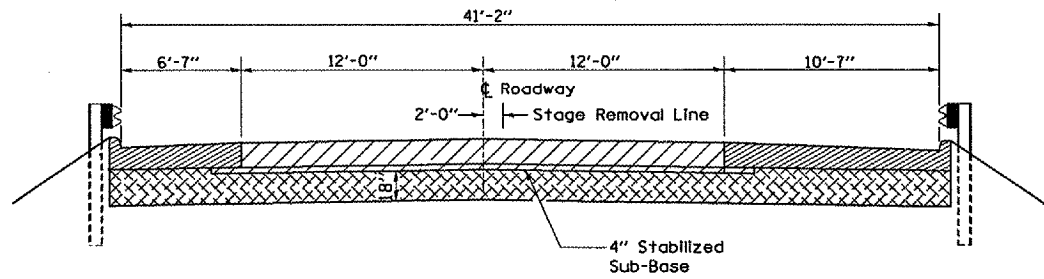

SECTION B-B

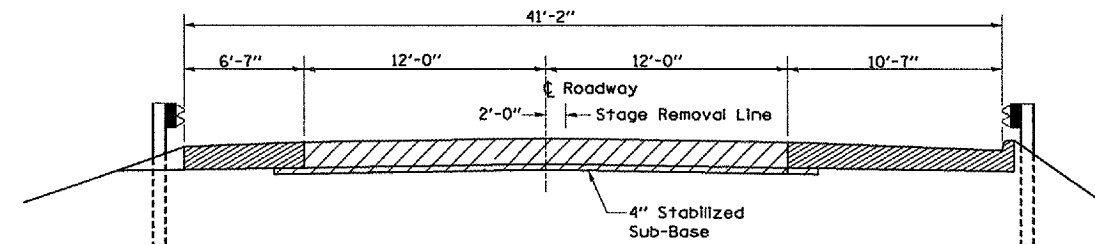

SECTION C-C

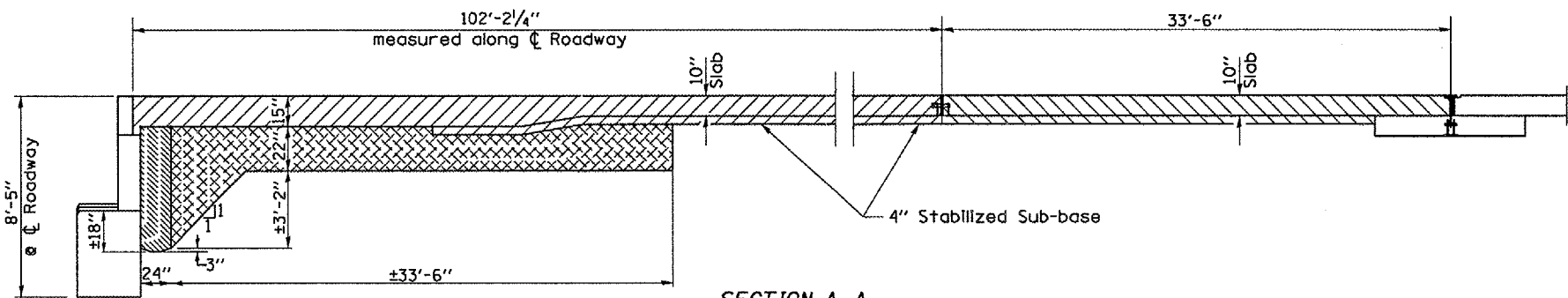

SECTION A-A

REVISIONS	
NAME	DATE

ILLINOIS DEPARTMENT OF TRANSPORTATION
**EXISTING APPROACH PAVEMENT
 DETAILS - NORTH APPROACH**
 FAI 412 (I-39)
 SECTION (62-2VB)I
 STA. 165+90.23
 MARSHALL COUNTY

SCALE: VERT. _____
 HORIZ. _____
 DATE 04/26/2005

DRAWN BY RLW
 CHECKED BY _____

Date: 04/26/2005
 File: c:\projects\cm308\details.dgn