

F.A.I. RTE.	SECTION	COUNTY	TOTAL SHEETS	SHEET NO.
412	(62-2VB)I-1	MARSHALL	19	14
FED. ROAD DIST. NO. ILLINOIS		PROJECT		

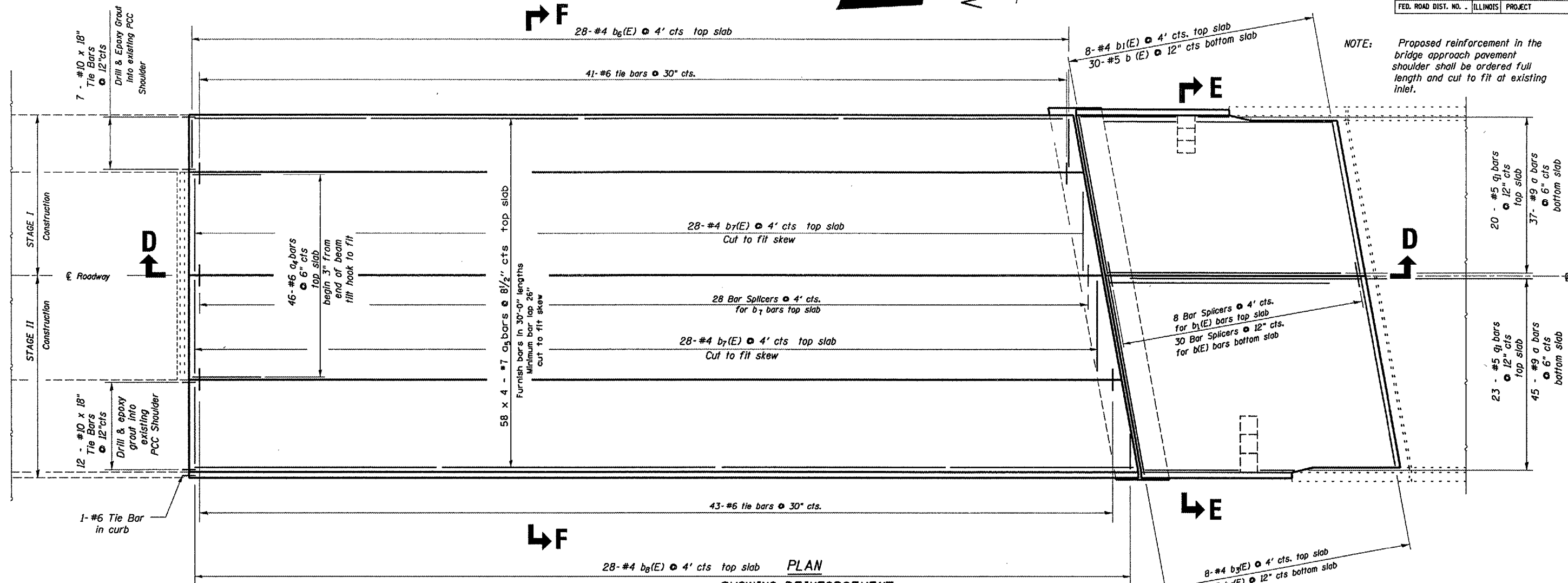

NOTE: Proposed reinforcement in the bridge approach pavement shoulder shall be ordered full length and cut to fit at existing inlet.

PLAN
SHOWING REINFORCEMENT

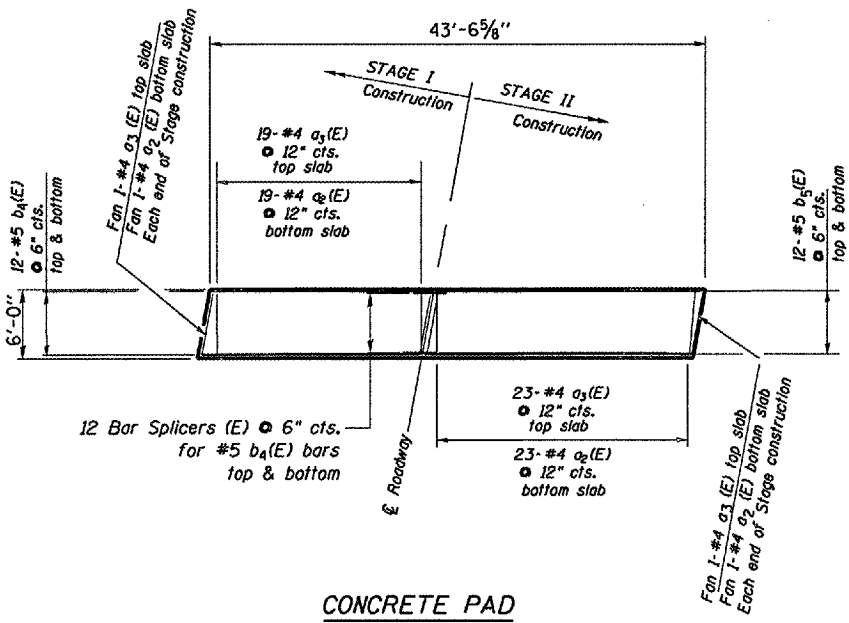

CONCRETE PAD
SHOWING REINFORCEMENT

BRIDGE APPROACH PAVEMENT REINFORCEMENT TABLE

BAR	NO.	SIZE	LENGTH	SHAPE
a(E)	82	#9	29'-6"	U
a1(E)	43	#5	29'-6"	—
a2(E)	44	#4	6'-8"	U
a3(E)	44	#4	5'-8"	—
b(E)	30	#5	19'-3"	—
b1(E)	8	#4	19'-3"	—
b2(E)	30	#5	23'-3"	—
b3(E)	8	#4	23'-3"	—
b4(E)	24	#5	19'-5"	—
b5(E)	24	#5	23'-5"	—
REINFORCEMENT BARS, EPOXY COATED			12540	
BAR SPLICERS			38	

NOTE: Reinforcement bars designated (E) shall be Epoxy Coated
Bars indicated thus 58x4 #7 a indicates 58 lines of bars with 4 lengths per line

BRIDGE APPROACH PAVEMENT CONNECTOR (PCC) REINFORCEMENT TABLE

BAR	NO.	SIZE	LENGTH	SHAPE
a4	46	#6	8'-6"	U
a5	232	#7	30'-0"	—
b6	28	#4	6'-2"	—
b7	56	#4	11'-8"	—
b8	28	#4	10'-3"	—
REINFORCEMENT BARS			15557	
BAR SPLICERS			52	
TIE BARS			103	

* For information only. Cost included with Bridge Approach Pavement Connector (PCC).
** For information only. Cost included with Bridge Approach Pavement (Special)

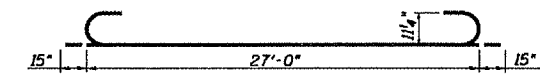

BAR a (E)

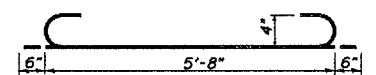

BAR a4 (E)

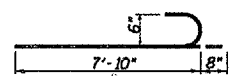

BAR a5 (E)

REVISIONS	
NAME	DATE

ILLINOIS DEPARTMENT OF TRANSPORTATION
PROPOSED APPROACH PAVEMENT
DETAILS - SOUTH APPROACH
FAI 412 (I-39)
SECTION (62-2VB)I-1
STA. 165+90.23
MARSHALL COUNTY
SCALE: VERT. _____
HORIZ. _____
DATE 04/26/2005
DRAWN BY RLW
CHECKED BY _____

Date: 06/08/2005
File: c:\projects\main06\cm309\details.dgn