

EXIST. CURVE PSC12
 PI STA. = 140+47.57
 $\Delta = 3^\circ 44' 40''$ (LT)
 $D = 1^\circ 23' 06''$
 $R = 4,136.74'$
 $T = 135.22'$
 $L = 270.34'$
 $E = 2.21'$
 P.C. STA. = 139+12.35
 P.T. STA. = 141+82.69

PROP. CURVE PSC12
 PI STA. = 140+47.52
 $\Delta = 3^\circ 44' 40''$ (LT)
 $D = 1^\circ 23' 06''$
 $R = 4,136.74'$
 $T = 135.22'$
 $L = 270.34'$
 $E = 2.21'$
 P.C. STA. = 139+12.30
 P.T. STA. = 141+82.64

SE = 3.10%
 SE TRANS:
 LT STA 138+27.063 TO STA 139+67.290 (0.0% - -3.1%)
 RT STA 138+27.063 TO STA 139+67.290 (0.0 - +3.1%)
 LT STA 141+27.630 TO STA 142+75.689 (-3.1% - 0.0%)
 RT STA 141+27.630 TO STA 142+75.689 (+3.1% - 0.0%)

EXIST. CURVE PSC13
 PI STA. = 144+33.82
 $\Delta = 2^\circ 01' 14''$ (RT)
 $D = 0^\circ 58' 44''$
 $R = 5,853.14'$
 $T = 103.21'$
 $L = 206.41'$
 $E = 0.91'$
 P.C. STA. = 143+30.60
 P.T. STA. = 145+37.01

PROP. CURVE PSC13
 PI STA. = 144+33.77
 $\Delta = 2^\circ 01' 14''$ (RT)
 $D = 0^\circ 58' 44''$
 $R = 5,853.14'$
 $T = 103.21'$
 $L = 206.41'$
 $E = 0.91'$
 P.C. STA. = 143+30.55
 P.T. STA. = 145+36.96

SE = 2.30%
 SE TRANS:
 LT STA 142+75.689 TO STA 143+85.540 (0.0% - 2.3%)
 RT STA 142+75.689 TO STA 143+85.540 (0.0 - -2.3%)
 LT STA 144+90.428 TO STA 145+78.139 (+2.3% - 0.0%)
 RT STA 144+90.428 TO STA 145+78.139 (-2.3% - 0.0%)

EXIST. CURVE PSC14
 PI STA. = 148+43.33
 $\Delta = 32^\circ 29' 36''$ (LT)
 $D = 18^\circ 16' 18''$
 $R = 313.58'$
 $T = 91.38'$
 $L = 177.83'$
 $E = 13.04'$
 P.C. STA. = 147+51.95
 P.T. STA. = 149+29.78

PROP. CURVE PSC14
 PI STA. = 148+43.28
 $\Delta = 32^\circ 29' 36''$ (LT)
 $D = 18^\circ 16' 18''$
 $R = 313.58'$
 $T = 91.38'$
 $L = 177.83'$
 $E = 13.04'$
 P.C. STA. = 147+51.90
 P.T. STA. = 149+29.73

SE = 6.00%
 SE TRANS:
 LT STA 145+78.139 TO STA 148+06.950 (0.0% - -6.0%)
 RT STA 145+78.139 TO STA 148+06.950 (0.0 - +6.0%)
 LT STA 148+74.780 TO STA 149+84.780 (-6.0% - -2.0%)
 RT STA 148+74.780 TO STA 150+94.780 (+6.0% - -2.0%)

CONTRACT NO. 72118	F.A. RTE.	SECTION	COUNTY	TOTAL SHEETS	SHEET NO.
		**	MASON	86	31
STA. 138+00		TO STA. 150+00			
FED. ROAD DIST. NO.		ILLINOIS FED. AID PROJECT			

- PARK ROADS
- SAND RIDGE STATE FOREST INTERNAL ROADS 2004



STA. 138+00 TO STA. 138+50
 STA. 139+00 TO STA. 140+00
 STA. 140+50 TO STA. 142+90
 PR TREE REMOVAL = 0.46 ACRES
 NOTE : (1) MEASURED AREA FOR PAYMENT
 3' OUTSIDE CONST. LIMITS
 TO 3' OUTSIDE CONSTRUCTION LIMITS
 (2) SAVE AS MANY TREES AS POSSIBLE

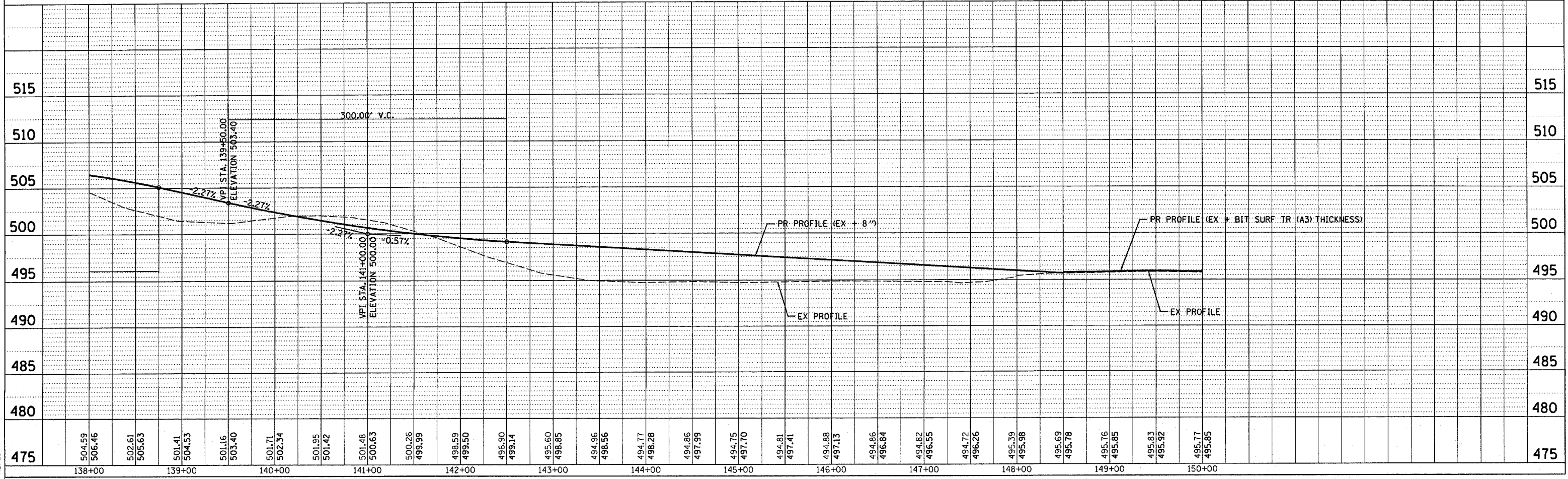
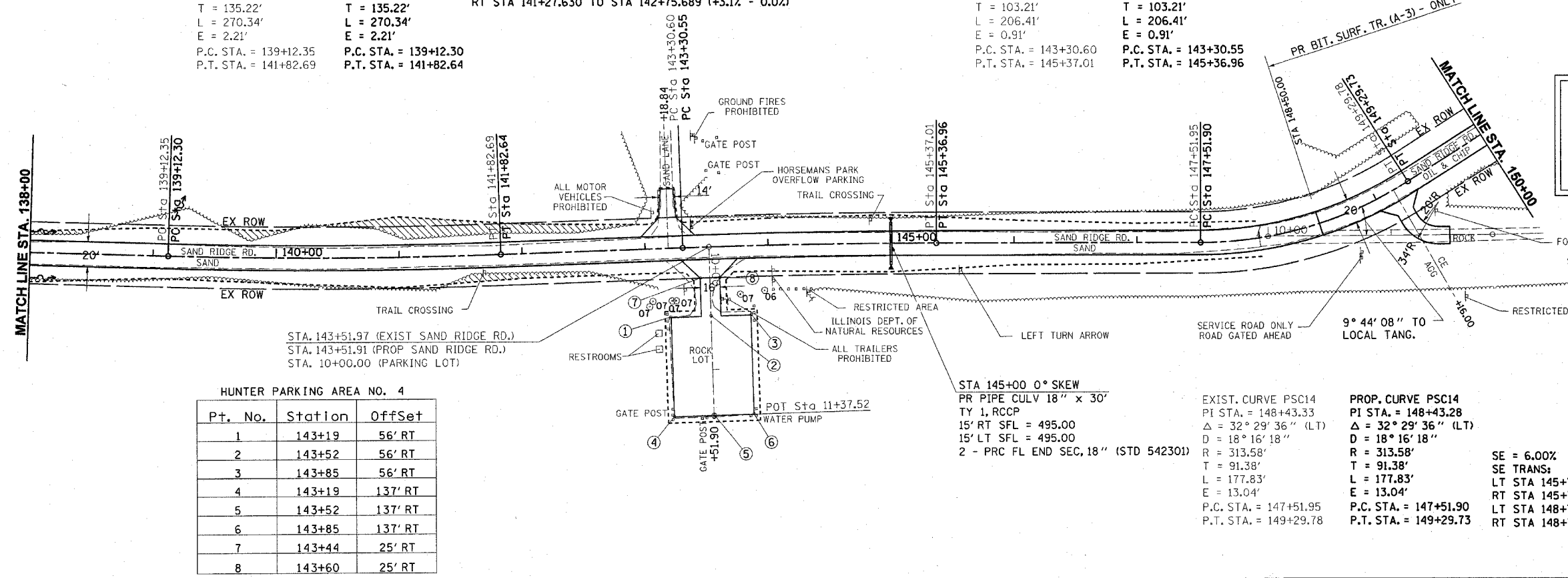

PLAN
 SURVEYED
 PLOTTED
 CHECKED
 DATE

PROFILE
 SURVEYED
 PLOTTED
 CHECKED
 DATE

PROJECTS
 0654196
 P&SANDRIDGE.DGN
 2/6/2004