

F.A. RTE.	SECTION	COUNTY	TOTAL SHEETS	SHEET NO.
103	27-1R	ST. CLAIR	382	171
STA.		TO STA.		
FED. ROAD DIST. NO.	ILLINOIS	FED. AID PROJECT		
CONTRACT NO. 76300				

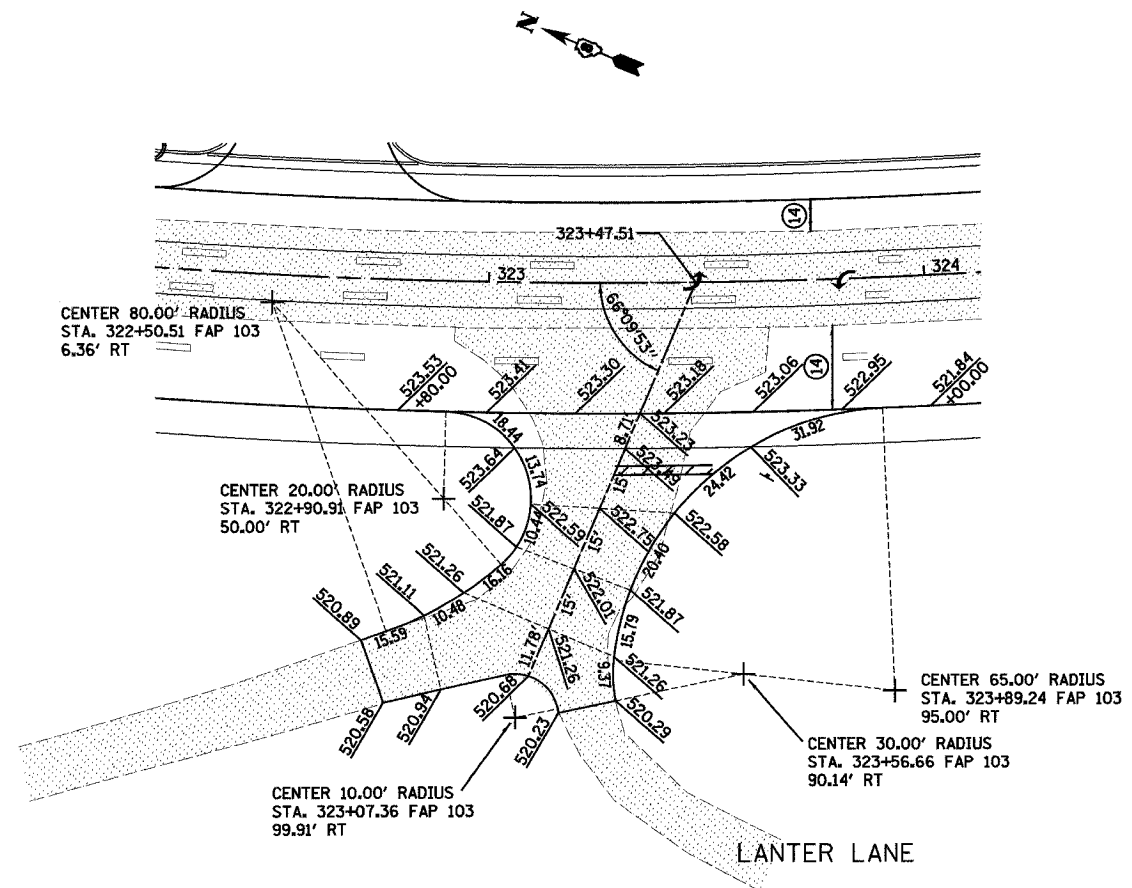

DENOTES EXISTING PAVEMENT

- ⑦ PROPOSED BITUMINOUS CONCRETE PAVEMENT (FULL-DEPTH) SUPERPAVE, 14"
  - ⑭ PROPOSED BITUMINOUS CONCRETE BINDER COURSE, SUPERPAVE, IL - 19.0, N90 - 12-1/2"
- SEE TYPICAL SECTIONS FOR ADDITIONAL INFORMATION

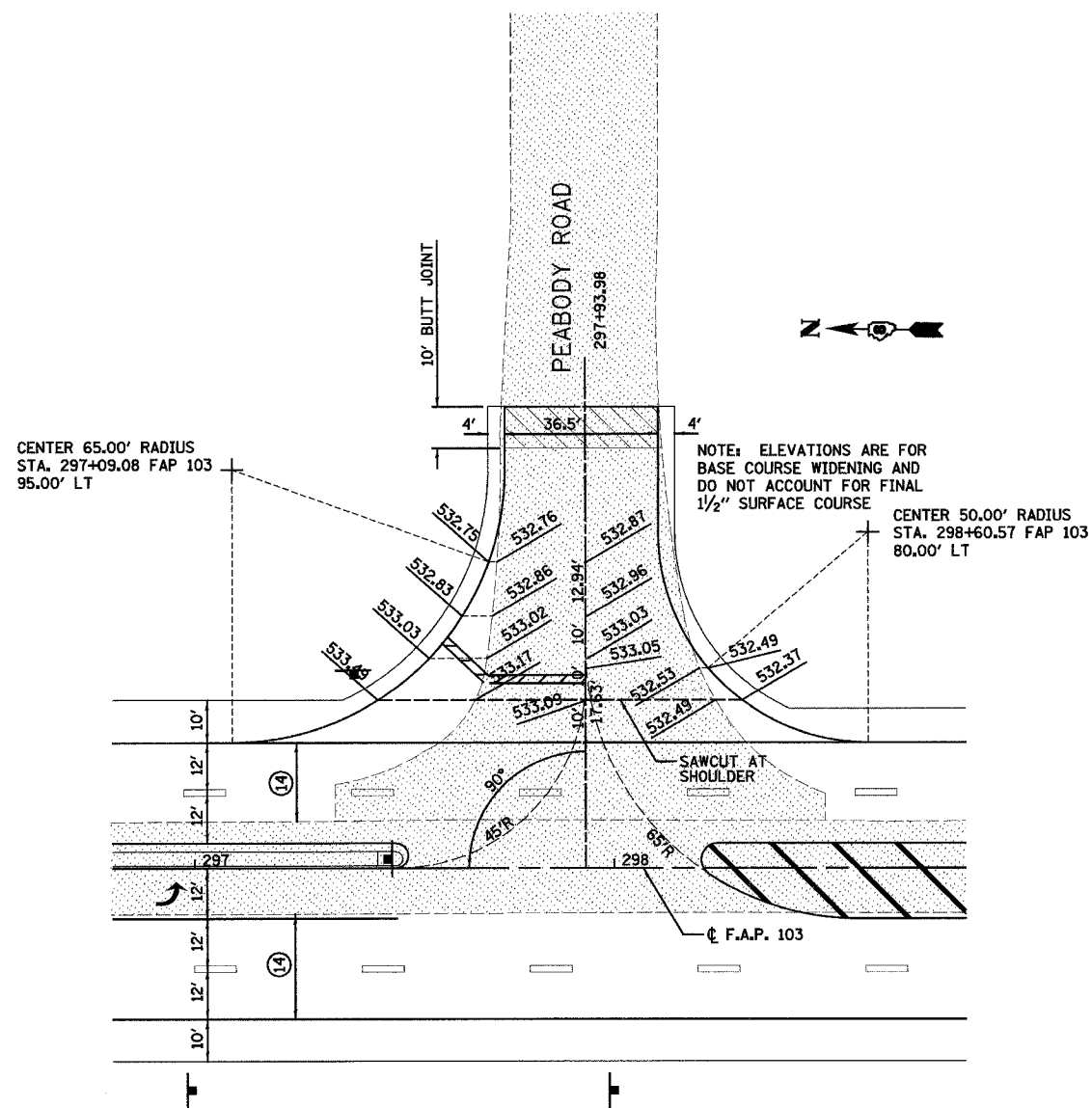
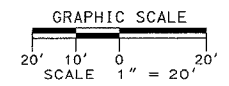

REVISIONS	
NAME	DATE

ILLINOIS DEPARTMENT OF TRANSPORTATION  
**INTERSECTION DETAIL**  
**PEABODY ROAD AND LANTER LANE**  
 F.A.P. 103 (IL. RTE. 13/15)  
 SECTION 27-1R - ST. CLAIR CO.  
 SCALE: 1" = 20'  
 DATE: February 11, 2005  
 DRAWN BY: KEB  
 CHECKED BY: RCY

J:\2005\020508\0000\civil\gdg\interact\_dtl\_03\_07.dgn 3/10/2005 8:53:37 AM