

160 150 140 130 120 110 100 90 80 70 60 50 40 30 20 10 0 10 20 30 40 50 60 70 80 90 100 110 120

F.A. RTE.	SECTION	COUNTY	TOTAL SHEETS	SHEET NO.
103	27-1R	ST. CLAIR	382	203
STA.		TO STA.		
FED. ROAD DIST. NO.		ILLINOIS FED. AID PROJECT		
CONTRACT NO. 76300				

PROP. F.A.P. 103

DATE	BY
DATE	BY
DATE	BY
DATE	BY
DATE	BY

DATE	BY
DATE	BY
DATE	BY
DATE	BY
DATE	BY

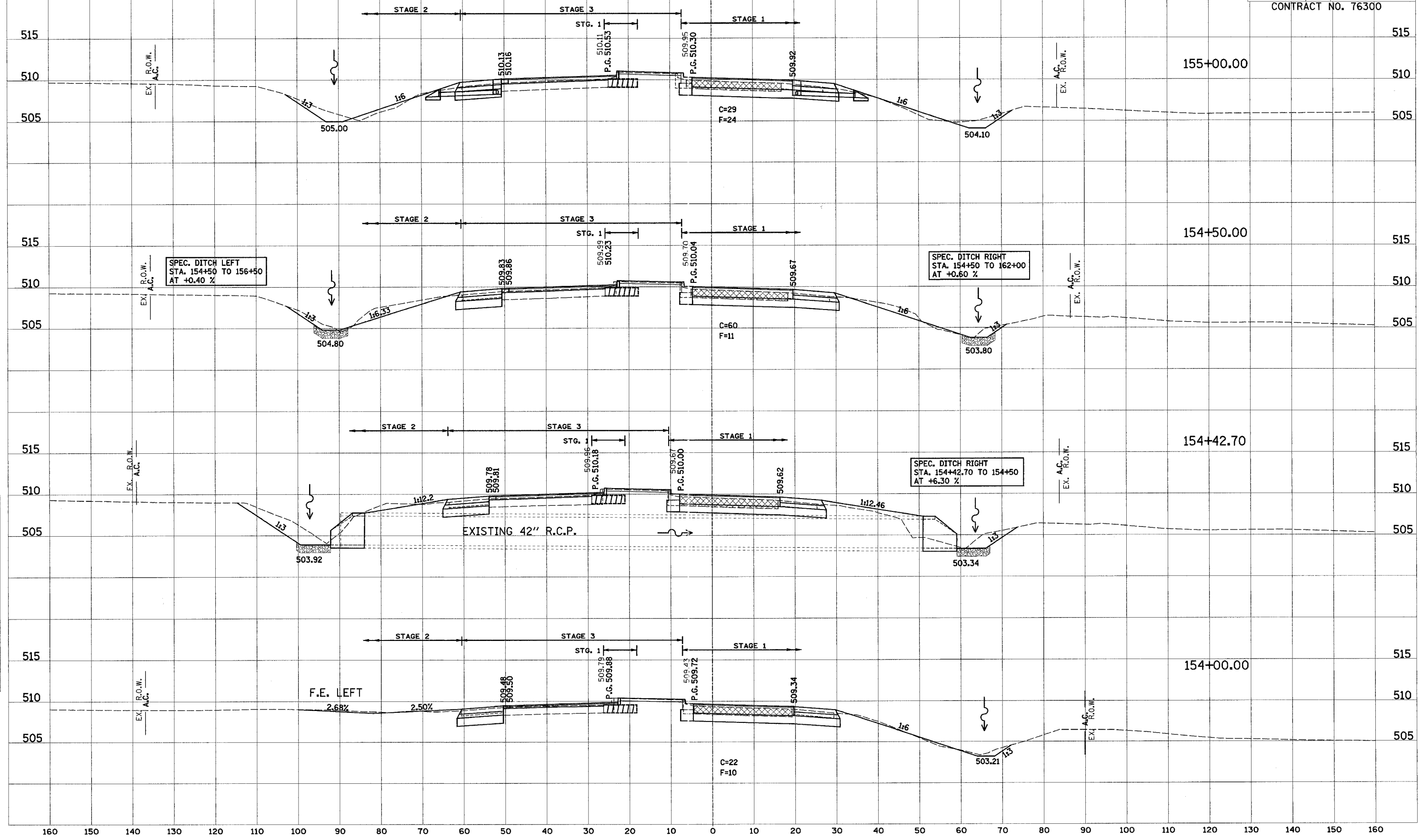

SPEC. DITCH LEFT
STA. 154+50 TO 156+50
AT +0.40 %

SPEC. DITCH RIGHT
STA. 154+50 TO 162+00
AT +0.60 %

SPEC. DITCH RIGHT
STA. 154+42.70 TO 154+50
AT +6.30 %

EXISTING 42" R.C.P.

F.E. LEFT

C=22
F=10