

F.A. RTE.	SECTION	COUNTY	TOTAL SHEETS	SHEET NO.
103	27-1R	ST. CLAIR	382	363
STA.		TO STA.		
FED. ROAD DIST. NO.		ILLINOIS	FED. AID PROJECT	
CONTRACT NO. 76300				

↑ P.CR.61

FINAL SURVEY  
 SURVEYED \_\_\_\_\_ DATE \_\_\_\_\_  
 BY \_\_\_\_\_  
 NOTE BOOK \_\_\_\_\_  
 NO. \_\_\_\_\_ AREAS CHECKED \_\_\_\_\_

ORIGINAL SURVEY  
 SURVEYED \_\_\_\_\_ DATE \_\_\_\_\_  
 BY \_\_\_\_\_  
 NOTE BOOK \_\_\_\_\_  
 NO. \_\_\_\_\_ AREAS CHECKED \_\_\_\_\_

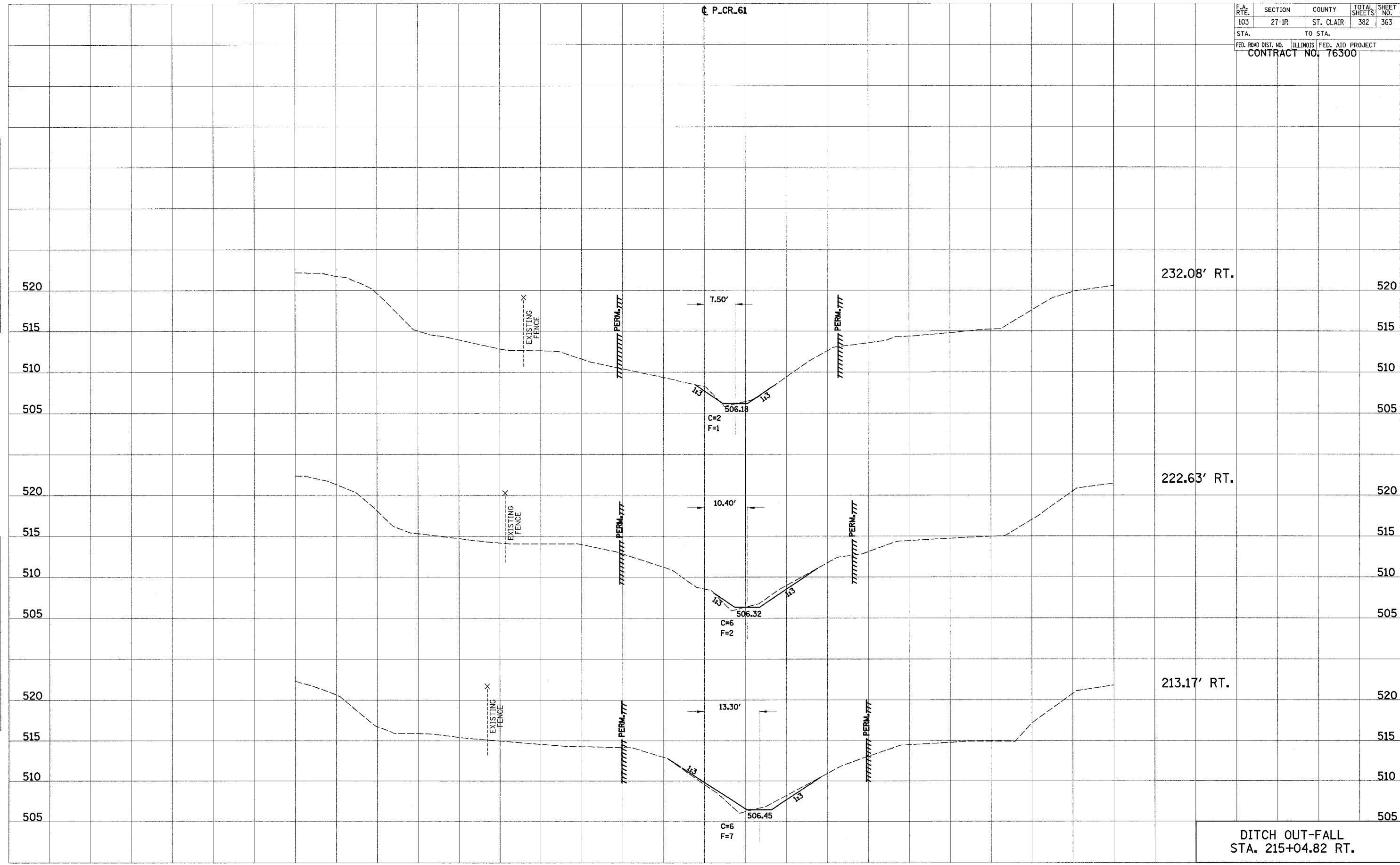

DITCH OUT-FALL  
 STA. 215+04.82 RT.