

F.A.U. RTE.	SECTION	COUNTY	TOTAL SHEETS	SHEET NO.
9128	28-RS-1	MADISON	14	1

STATE OF ILLINOIS  
 DEPARTMENT OF TRANSPORTATION  
 DIVISION OF HIGHWAYS  
**PROPOSED  
 HIGHWAY PLANS**

FAU ROUTE 9128 (US 40 /COLLINSVILLE ROAD)  
 SECTION 28-RS-1  
 PROJECT: HS-9128(004)  
 MADISON COUNTY  
 INTERSECTION RESURFACING  
 C-98-128-05

INDEX OF SHEETS

PAGE	TITLE
1	COVER SHEET
2	STANDARDS, GENERAL NOTES, COMMITMENTS & SCHEDULES
3	SUMMARY OF QUANTITIES
4 - 6	TYPICAL SECTIONS
7 - 9	PLAN SHEETS
10-12	PAVEMENT MARKING PLAN PAVEMENT MARKING DETAILS
13-14	ELECTRICAL PLAN

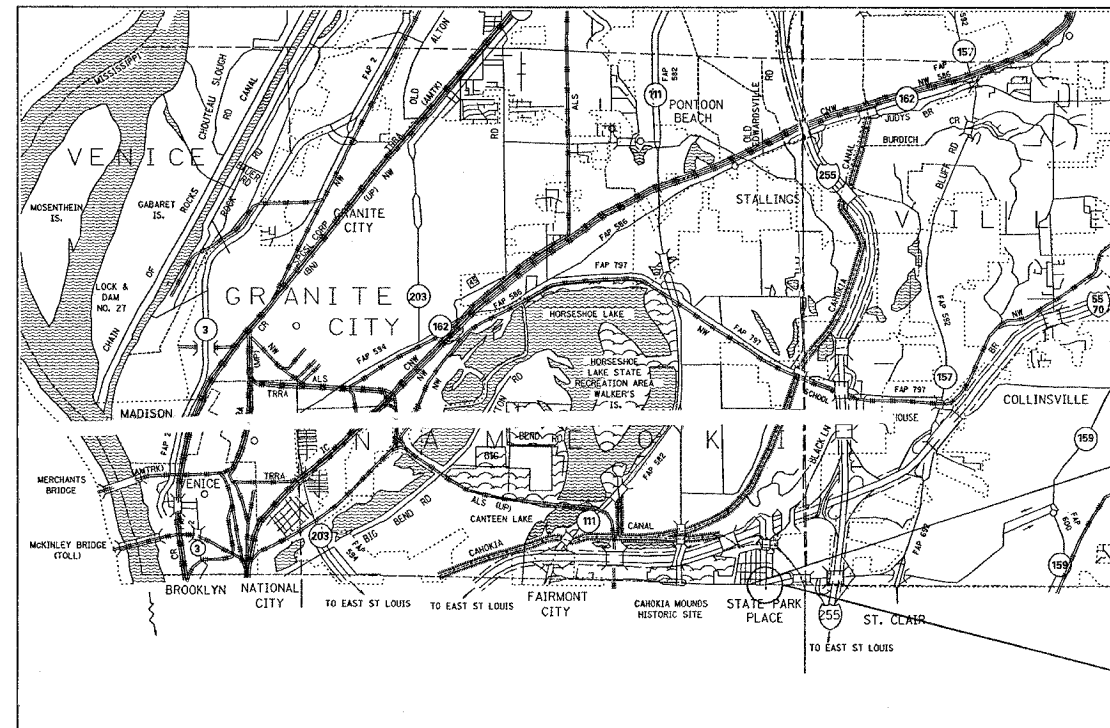
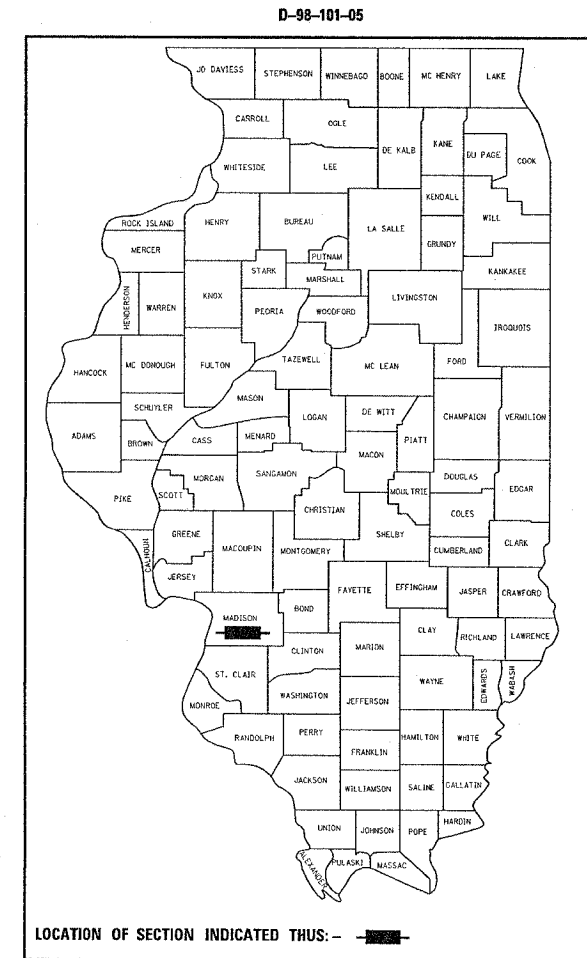

BEGIN STA 286+85  
 LAT. 38.65840  
 LONG. -90.04737

END STA 299+35  
 LAT. 38.65867  
 LONG. -90.04659

MICROFILMED \_\_\_\_\_  
 REEL NUMBER \_\_\_\_\_  
 AWARDED \_\_\_\_\_  
 RESIDENT ENGINEER \_\_\_\_\_  
 AS BUILT CHANGES WERE MADE  
 ON THE FOLLOWING SHEETS

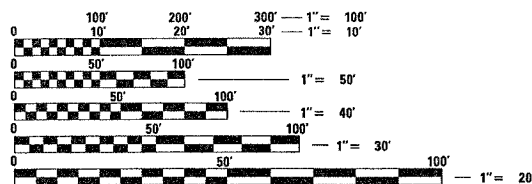

FULL SIZE PLANS HAVE BEEN PREPARED USING STANDARD  
 ENGINEERING SCALES. REDUCED SIZED PLANS WILL NOT  
 CONFORM TO STANDARD SCALES. IN MAKING MEASUREMENTS  
 ON REDUCED PLANS, THE ABOVE SCALES MAY BE USED.

J.U.L.I.E.  
 JOINT UTILITY LOCATION INFORMATION FOR EXCAVATION  
 1-800-892-0123

CONTRACT NO. 76960



ADT INFO.

US 40 EAST OF BLACK LN	US 40 WEST OF BLACK LN	BLACK LANE NORTH OF US 40	BLACK LANE SOUTH OF US 40
2005 = 8400	2005 = 7300	2005 = 3400	2005 = 4700
2025 = 9300	2025 = 8100	2025 = 3800	2025 = 5200
SU = 4.5%	SU = 5.1%	SU = 4.5%	SU = 4.4%
MU = 1.6%	MU = 1.5%	MU = 1.0%	MU = 1.0%

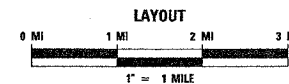

GROSS LENGTH 1,580 FT  
 NET LENGTH 1,580 FT

STATE OF ILLINOIS  
 DEPARTMENT OF TRANSPORTATION  
 DIVISION OF HIGHWAYS

SUBMITTED July 20 05  
Victor Modest  
 DEPUTY DIRECTOR OF HIGHWAYS  
 REGION FIVE ENGINEER

August 19, 2005  
Mike Shire  
 ENGINEER OF DESIGN AND ENVIRONMENT

August 19, 2005  
Victor Modest  
 DIRECTOR, DIVISION OF HIGHWAYS

**PRINTED BY THE AUTHORITY  
 OF THE STATE OF ILLINOIS**

PROJECT ENG NEER: WENDA SOUTHERLAND (618)-346-3159  
 SQUAD LEAD: BRIAN COURTWRIGHT (618)-346-3192

F.A.U. RTE.	SECTION	COUNTY	TOTAL SHEETS	SHEET NO.
9128	28-RS-1	MADISON	14	2
STA.		TO STA.		
FED. ROAD DIST. NO.		ILLINOIS	FED. AID PROJECT	

GENERAL NOTES

- SAW CUTTING ON ALL EDGES FOR REMOVAL ITEMS SHALL BE INCLUDED IN THE COST OF THE REMOVAL ITEM AS INDICATED AND IN ACCORDANCE WITH SECTION 440 OF THE STANDARD SPECIFICATIONS.
- IF ANY SECTION OR SUB-SECTION MONUMENTS ARE ENCOUNTERED, THE ENGINEER SHALL BE NOTIFIED BEFORE SUCH MONUMENTS ARE REMOVED OR RESURFACED OVER. THE CONTRACTOR SHALL PROTECT AND CAREFULLY PRESERVE ALL PROPERTY MARKERS AND MONUMENTS UNTIL THE OWNER, AN AUTHORIZED SURVEYOR, OR AGENT HAS WITNESSED OR OTHERWISE REFERENCED THEIR LOCATION.
- EXCESS BITUMINOUS REMOVAL SHALL BE PAID FOR ACCORDING TO ARTICLE 109.04 OF THE STANDARD SPECIFICATIONS.
- MIXTURES FOR JOINTS, CRACKS, AND FLANGWAYS SHALL BE PAID FOR ACCORDING TO ARTICLE 109.04 OF THE STANDARD SPECIFICATIONS.
- THE THICKNESS OF THE BITUMINOUS MIXTURE SHOWN ON THE PLANS IS THE NOMINAL THICKNESS. DEVIATIONS FROM THE NOMINAL THICKNESS WILL BE PERMITTED WHEN SUCH DEVIATIONS OCCUR DUE TO IRREGULARITIES IN THE EXISTING SURFACE OR BASE ON WHICH THE BITUMINOUS MIXTURE IS PLACED.
- THE THICKNESS OF BITUMINOUS SURFACE REMOVAL IS THE REMOVAL DEPTH AT THE LOCATIONS SHOWN ON THE TYPICAL SECTIONS. THE REMOVAL DEPTH VARIES FROM 1 3/4" TO 2 3/4". AN ESTIMATED 1375 TONS OF BITUMINOUS SURFACE WILL BE REMOVED.
- THE CONTRACTOR SHALL STOCK PILE THE MATERIAL CREATED BY THE BITUMINOUS SURFACE REMOVAL AS DIRECTED BY ENGINEER AND STAN RUDY FROM THE TROY OPERATION'S YARD (613-667-0720). THE MATERIAL SHALL BECOME THE PROPERTY OF I.D.O.T.
- ILLINOIS STATE LAW REQUIRES A 48-HOUR NOTICE BE GIVEN TO ALL UTILITIES BEFORE DIGGING. FIELD MARKING OF FACILITIES MAY BE OBTAINED BY CONTACTING J.U.L.I.E. OR FOR NON-MEMBERS, THE UTILITY COMPANY DIRECTLY. AGENCIES KNOWN TO HAVE FACILITIES WITHIN THE PROJECT AREA ARE AS FOLLOWS:  
  
AMEREN IP (AERIAL & BURIED)\*  
CITY OF COLLINSVILLE (BURIED)\*  
MCLEOD USA TELECOMMUNICATIONS, INC (BURIED)\*  
MEDIACOM LLC CENTRAL (BURIED)\*  
MOUND PUBLIC WATER AND SEWER DISTRICT (BURIED)\*  
SBC (AERIAL & BURIED)\*  
  
MEMBERS OF J.U.L.I.E. (800)-892-0123 ARE INDICATED BY \*. NON J.U.L.I.E. MEMBERS MUST BE NOTIFIED INDIVIDUALLY.
- ALL TEMPORARY PAVEMENT MARKINGS WILL BE PLACED IN SUCH A MANNER SO AS NOT TO INTERFERE WITH THE PLACEMENT OF PERMANENT PAVEMENT MARKINGS.
- BITUMINOUS CONCRETE USED FOR PAVEMENT PATCHING AND/OR BASE COURSE WIDENING SHALL BE PRODUCED UNDER THE SUPERPAVE SPECIAL PROVISION.
- THE CONTRACTOR SHALL BE AWARE THAT THERE ARE MANHOLES & VALVES LOCATED WITHIN THE RESURFACING LIMITS. CARE SHALL BE TAKEN IN THESE LOCATIONS DURING MILLING OPERATIONS.
- THE CONTRACTOR SHALL VERIFY ALL DIMENSIONS AND CONDITIONS IN THE FIELD PRIOR TO CONSTRUCTION AND ORDERING OF MATERIALS.
- NO OVERNIGHT LANE CLOSURES WILL BE ALLOWED.
- "ROAD CONSTRUCTION AHEAD" SIGNS SHALL BE PLACED AT THE BEGINNING AND END OF THE PROJECT PLUS THE INTERSECTING SIDE ROADS, AND WILL BE INCLUDED IN THE TRAFFIC CONTROL PAY ITEMS. ALL CONSTRUCTION SIGNS SHALL BE FLUORESCENT ORANGE.
- FLAGMEN SHALL BE PRESENT DURING ALL CLOSURE HOURS, INCLUDING LUNCH HOUR, AND NO ADDITIONAL COMPENSATION SHALL BE APPLIED.

COMMITMENTS

COMMITMENTS FOR THIS PROJECT ARE AS FOLLOWS:  
NONE

US 40 (Collinsville Ave. Resurfacing Schedule)

STA to STA	Length (ft)	Width1 (ft)	Width2 (ft)	Avg. Width (ft)	Area (sq yds)	Bit. Surf. Rem. 2 1/4" (sq yds)	Bit. Mat'l (PR,CT.) (tons)	Agg. (PR,CT.) (tons)	Leveling Binder (MM) (tons)	Surface Course (tons)
<i>E.B. Mainline</i>										
286+85 to 288+48	163	21	24	22.5	407.50	408	0.13	0.61	17	34
288+48 to 289+48	100	24	24	24.0	266.67	267	0.08	0.40	11	22
289+48 to 290+59	111	24	24	24.0	296.00	296	0.09	0.44	12	25
290+59 to 291+63	104	24	24	24.0	277.33	277	0.09	0.42	12	23
291+63 to 293+33	170	24	24	24.0	453.33	453	0.14	0.68	19	38
293+33 to 294+60	127	24	24	24.0	338.67	339	0.11	0.51	14	28
294+60 to 295+28	68	24	24	24.0	181.33	181	0.06	0.27	8	15
295+28 to 296+23	95	24	24	24.0	253.33	253	0.08	0.38	11	21
296+23 to 297+65	142	24	24	24.0	378.67	379	0.12	0.57	16	32
297+65 to 299+35	170	24	24	24.0	453.33	453	0.14	0.68	19	38
<i>E.B. Right Turn Lanes / Bus Unloading Lanes</i>										
286+85 to 288+48	163	11	0	5.5	99.61	100	0.03	0.15	4	8
288+48 to 290+00	152	0	12	6.0	101.33	101	0.03	0.15	4	9
290+00 to 290+67	67	12	12	12.0	89.33	89	0.03	0.13	4	8
294+60 to 295+28	68	0	8	4.0	30.22	30	0.01	0.05	1	3
295+28 to 296+23	95	8	8	8.0	84.44	84	0.03	0.13	4	7
296+23 to 297+14	91	8	0	4.0	40.44	40	0.01	0.06	2	3
<i>E.B. Left Turn Lane</i>										
289+48 to 290+59	111	0	12	6.0	74.00	74	0.02	0.11	3	6
290+59 to 291+63	104	12	12	12.0	138.67	139	0.04	0.21	6	12
<i>W.B. Mainline</i>										
286+85 to 288+36	151	25	24	24.5	411.06	411	0.13	0.62	17	35
288+36 to 289+48	112	24	24	24.0	298.67	299	0.09	0.45	13	25
289+48 to 292+68	320	24	24	24.0	853.33	853	0.27	1.28	36	72
292+68 to 294+43	175	24	24	24.0	466.67	467	0.15	0.70	20	39
294+43 to 296+24	181	24	24	24.0	482.67	483	0.15	0.72	20	41
296+24 to 297+42	118	24	24	24.0	314.67	315	0.10	0.47	13	26
297+42 to 299+35	193	24	25	24.5	525.39	525	0.16	0.79	22	44
<i>W.B. Right Turn Lanes / Bus Unloading Lanes</i>										
286+85 to 288+36	151	6	10	8.0	134.22	134	0.04	0.20	6	11
288+36 to 289+48	112	10	0	5.0	62.22	62	0.02	0.09	3	5
293+64 to 294+43	79	12	12	12.0	105.33	105	0.03	0.16	4	9
294+43 to 297+42	299	12	0	6.0	199.33	199	0.06	0.30	8	17
<i>W.B. Left Turn Lane</i>										
292+68 to 294+43	175	12	12	12.0	233.33	233	0.07	0.35	10	20
294+43 to 296+24	181	12	0	6.0	120.67	121	0.04	0.18	5	10
<i>Medians Crossover</i>										
288+48 to 289+48					124	124	0.04	0.19	5	10
291+63 to 292+68					206	206	0.06	0.31	9	17
296+24 to 297+42					197	197	0.06	0.30	8	17
TOTAL =						8697	2.7	13.1	366	730

PAVEMENT PATCHING 17" SCHEDULE

STA	DIR.	LENGTH (ft)	WIDTH (ft)	PAVEMENT PATCHING TYPE 1 (sq yd)	PAVEMENT PATCHING TYPE 2 (sq yd)	PAVEMENT PATCHING TYPE 3 (sq yd)	PAVEMENT PATCHING TYPE 4 (sq yd)
287+50	EB/MEDIAN	6.0	18.0		12		
290+60	EB	12.0	12.0			16	
295+25	WB	6.0	12.0		8		
299+50	EB/MEDIAN	6.0	18.0		12		
299+50	WB/MEDIAN	6.0	18.0		12		
NB N. BLACK LN		6.0	24.0			16	
SB N. BLACK LN		6.0	24.0			16	
SUBTOTAL =					44	48	
ANTICIPATED FAILURES (5%) =					2	2	
TOTAL =					46	50	

LIST OF STANDARDS

- 000001-04
- 001006
- 442201-01
- 780001-01
- 781001-02
- 701101-01
- 701106-01
- 701601-04
- 701701-04
- 702001-05

MIX REQUIREMENT CHART

MIXTURE USE	SURFACE	L BINDER	PATCHING
AC/PG	SBS T6-22	PG70-22	PAG64-22
RAP % (MAX)	0%	10%	10%
DESIGN AIR VOIDS	4.0% @ Ndes=70	4.0% @ Ndes=70	4% @ Ndes=90
MIX COMPOSITION (GRADATION MIXTURE)			
FRICTION AGG	MIX "D"	MIX "C"	MIX "B"

REVISIONS		ILLINOIS DEPARTMENT OF TRANSPORTATION GENERAL NOTES, COMMITMENT, HIGHWAY STANDARDS & SCHEDULES  FAU ROUTE 9128 SECTION 28-RS-1 MADISON COUNTY
NAME	DATE	
SCALE: VERT.	HORIZ.	DRAWN BY
DATE		CHECKED BY

PLT DATE = 7/29/2006  
FILE NAME = c:\projects\9128\9128-rs-1\9128-rs-1.dgn  
PLOT SCALE = 50,000.00 / IN.  
REFERENCE = \*REF\*

# SUMMARY OF QUANTITIES

90% FED. / 10% STATE

F.A. RTE.	SECTION	COUNTY	TOTAL SHEETS	SHEET NO.
9128	28-RS-1	MADISON	14	3
STA.		TO STA.		
FED. ROAD DIST. NO.		ILLINOIS FED. AID PROJECT		

SUMMARY OF QUANTITIES			CONSTRUCTION TYPE CODE	
CODE NO	ITEM	UNIT	TOTAL QUANTITIES	URBAN 1000-IA
40600200	BITUMINOUS MATERIALS (PRIME COAT)	TON	3.4	3.4
40600300	AGGREGATE (PRIME COAT)	TON	16.4	16.4
40600990	TEMPORARY RAMP	SQ YD	115	115
44200202	PAVEMENT PATCHING, TYPE II, 17 INCH	SQ YD	46	46
44200204	PAVEMENT PATCHING, TYPE III, 17 INCH	SQ YD	50	50
67100100	MOBILIZATION	L SUM	1	1
70102630	TRAFFIC CONTROL AND PROTECTION, STANDARD 701601	L SUM	1	1
70102635	TRAFFIC CONTROL AND PROTECTION, STANDARD 701701	L SUM	1	1
<del>70103815</del>	<del>TRAFFIC CONTROL SURVEILLANCE</del>	<del>CAL DA</del>	<del>7</del>	<del>7</del>
70300100	SHORT-TERM PAVEMENT MARKING	FOOT	647	647
70300210	TEMPORARY PAVEMENT MARKING - LETTERS AND SYMBOLS	SQ FT	240	240
70300220	TEMPORARY PAVEMENT MARKING - LINE 4"	FOOT	6091	6091
70300250	TEMPORARY PAVEMENT MARKING - LINE 8"	FOOT	440	440
70300260	TEMPORARY PAVEMENT MARKING - LINE 12"	FOOT	97	97
70300280	TEMPORARY PAVEMENT MARKING - LINE 24"	FOOT	192	192
70301000	WORK ZONE PAVEMENT MARKING REMOVAL	SQ FT	1592	1592
* 78001100	<del>PAINT</del> THERMOPLASTIC PAVEMENT MARKING - LETTERS AND SYMBOLS	SQ FT	240	240
* 78001110	<del>PAINT</del> THERMOPLASTIC PAVEMENT MARKING - LINE 4"	FOOT	6091	6091
* 78001140	<del>PAINT</del> THERMOPLASTIC PAVEMENT MARKING - LINE 8"	FOOT	440	440
* 78001150	<del>PAINT</del> THERMOPLASTIC PAVEMENT MARKING - LINE 12"	FOOT	97	97
* 78001160	<del>PAINT</del> THERMOPLASTIC PAVEMENT MARKING - LINE 24"	FOOT	192	192
* 78100100	RAISED REFLECTIVE PAVEMENT MARKER	EACH	123	123
78300200	RAISED REFLECTIVE PAVEMENT MARKER REMOVAL	EACH	58	58
* 88600100	DETECTOR LOOP, TYPE I	FOOT	2345	2345
X4066526	POLYMERIZED BITUMINOUS CONCRETE SURFACE COURSE, SUPERPAVE, MIX "D", N70	TON	915	915
X4066770	LEVELING BINDER (MACHINE METHOD), SUPERPAVE N70	TON	458	458
X4409410	BITUMINOUS SURFACE REMOVAL 2 1/4"	SQ YD	10893	10893

SUMMARY OF QUANTITIES			CONSTRUCTION TYPE CODE	
CODE NO	ITEM	UNIT	TOTAL QUANTITIES	

\* SPECIALTY ITEMS

PLOT DATE = 6/28/2006  
 FILE NAME = C:\2006\11111111\11111111.dwg  
 PLOT SCALE = 1/8" = 1'-0"  
 REFERENCE = REF#

Rev.

FAU RTE.	SECTION	COUNTY	TOTAL SHEETS	SHEET NO.
9128	28-RS-1	MADISON	14	4
STA.		TO STA.		
FED. ROAD DIST. NO.	ILLINOIS	FED. AID PROJECT		

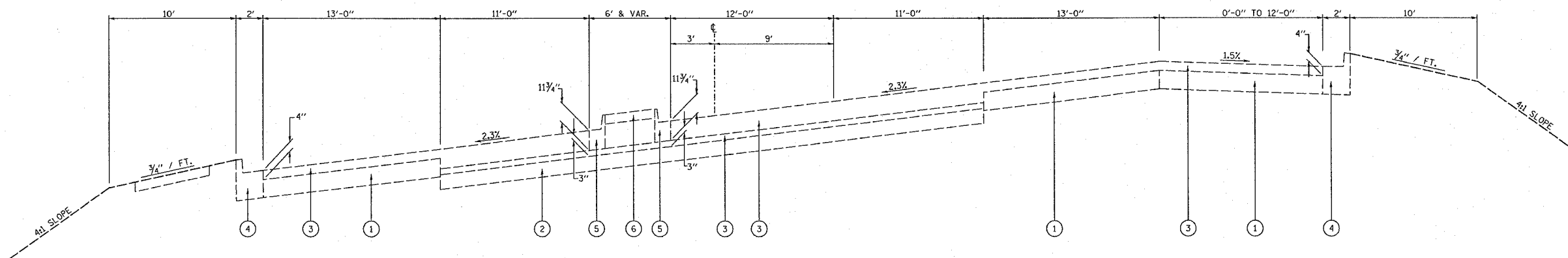

**EXISTING SUPERELEVATION TYPICAL SECTION**  
289+94.21 TO 291+98.18

**LEFT TURN LANE**  
289+48 TO 291+63 E.B.  
292+60 TO 296+24 W.B.

**RIGHT TURN LANE**  
288+48 TO 290+67 E.B.  
293+64 TO 297+42 W.B.

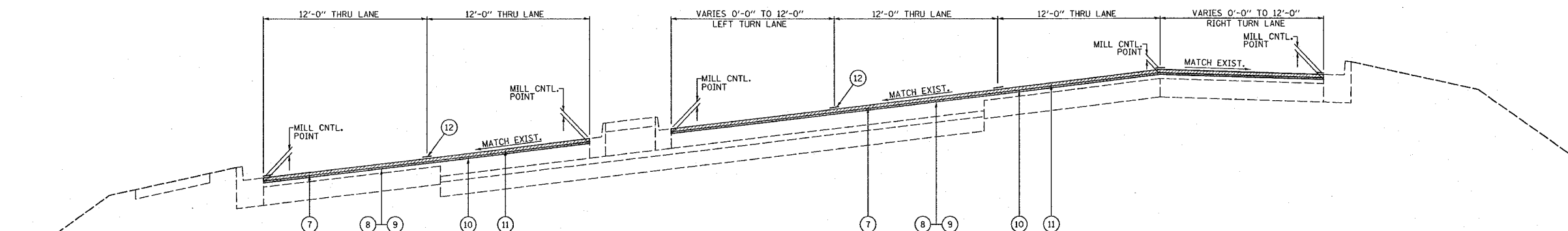

**PROPOSED SUPERELEVATION TYPICAL SECTION**  
289+94.21 TO 291+98.18

**LEFT TURN LANE**  
289+48 TO 291+63 E.B.  
292+60 TO 296+24 W.B.

**RIGHT TURN LANE**  
288+48 TO 290+67 E.B.  
293+64 TO 297+42 W.B.

**LEGEND**

- ① EXISTING P.C.C. PAVEMENT - 8"
- ② EXISTING P.C.C. PAVEMENT - 9"
- ③ EXISTING BITUMINOUS OVERLAY - VARIES 3" TO 1 1/4"
- ④ EXISTING CONCRETE COMBINATION C&G T-B 6.24
- ⑤ EXISTING CONCRETE COMBINATION C&G T-M 6.06
- ⑥ EXISTING P.C.C. MEDIAN SURFACE - 4"
- ⑦ PROPOSED BITUMINOUS SURFACE REMOVAL - 2 1/4"
- ⑧ PROPOSED BITUMINOUS MATERIAL (PRIME COAT)
- ⑨ PROPOSED AGGREGATE (PRIME COAT)
- ⑩ PROPOSED LEVELING BINDER (MIN.) - 3/4"
- ⑪ PROPOSED SURFACE COURSE - 1 1/2"
- ⑫ PROPOSED THERMOPLASTIC PAVEMENT MARKING

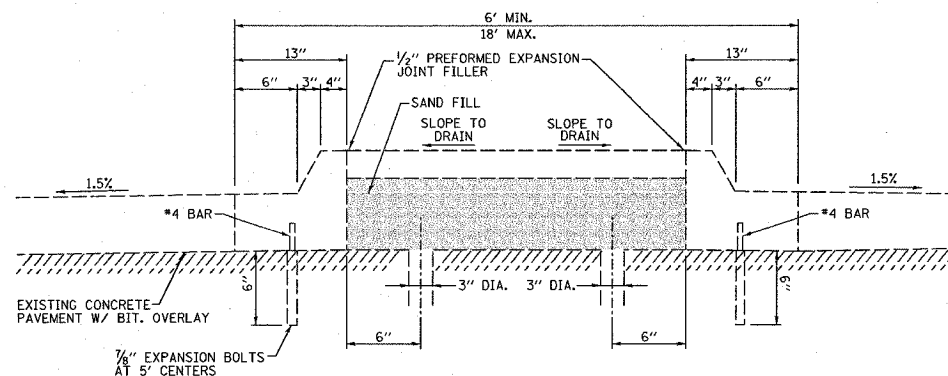

**DETAIL OF EXISTING P.C.C. MEDIAN & COMBINATION CONCRETE CURB AND GUTTER, TYPE M-6.06 (MODIFIED)**

REVISIONS	
NAME	DATE

ILLINOIS DEPARTMENT OF TRANSPORTATION

**TYPICAL SECTIONS**

FAU ROUTE 9128  
SECTION 28-RS-1  
MADISON COUNTY

SCALE: VERT.  
HORIZ.  
DATE

DRAWN BY  
CHECKED BY

FAU RTE.	SECTION	COUNTY	TOTAL SHEETS	SHEET NO.
9128	28-RS-1	MADISON	14	5
STA.		TO STA.		
FED. ROAD DIST. NO.	ILLINOIS	FED. AID PROJECT		

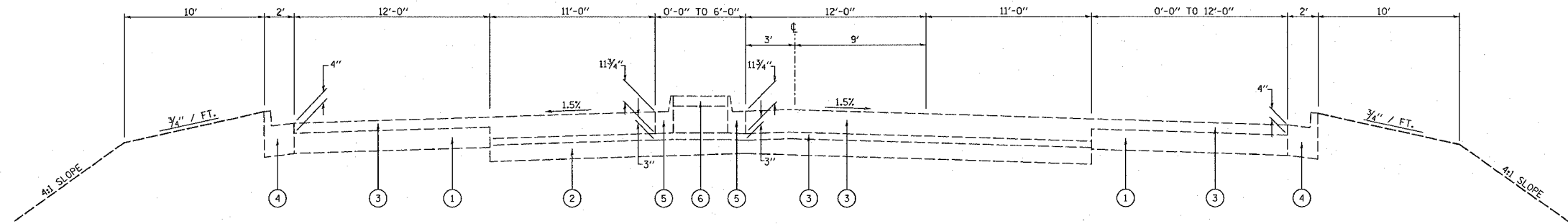

**EXISTING TANGENT TYPICAL SECTION**  
 297+42 TO 299+35 W.B.    297+65 TO 299+35 E.B.

**RIGHT TURN LANE**  
 288+48 TO 290+67 E.B.  
 293+64 TO 297+42 W.B.

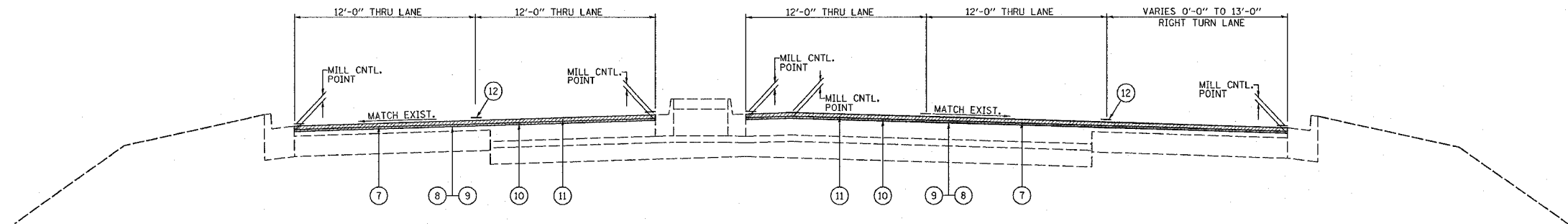

**PROPOSED TANGENT TYPICAL SECTION**  
 297+42 TO 299+35 W.B.    297+65 TO 299+35 E.B.

**RIGHT TURN LANE**  
 288+48 TO 290+67 E.B.  
 293+64 TO 297+42 W.B.

**LEGEND**

- ① EXISTING P.C.C. PAVEMENT - 8"
- ② EXISTING P.C.C. PAVEMENT - 9"
- ③ EXISTING BITUMINOUS OVERLAY - VARIES 3" TO 1 1/4"
- ④ EXISTING CONCRETE COMBINATION C&G T-B 6.24
- ⑤ EXISTING CONCRETE COMBINATION C&G T-M 6.06
- ⑥ EXISTING P.C.C. MEDIAN SURFACE - 4"
- ⑦ PROPOSED BITUMINOUS SURFACE REMOVAL - 2 1/4"
- ⑧ PROPOSED BITUMINOUS MATERIAL (PRIME COAT)
- ⑨ PROPOSED AGGREGATE (PRIME COAT)
- ⑩ PROPOSED LEVELING BINDER (MIN.) - 3/4"
- ⑪ PROPOSED SURFACE COURSE - 1 1/2"
- ⑫ PROPOSED THERMOPLASTIC PAVEMENT MARKING

REVISIONS	
NAME	DATE

ILLINOIS DEPARTMENT OF TRANSPORTATION  
**TYPICAL SECTIONS**  
 FAU ROUTE 9128  
 SECTION 28-RS-1  
 MADISON COUNTY

SCALE: VERT.    DRAWN BY  
 HORIZ.        CHECKED BY  
 DATE

FAU RTE.	SECTION	COUNTY	TOTAL SHEETS	SHEET NO.
9128	28-RS-1	MADISON	14	6
STA.		TO STA.		
FED. ROAD DIST. NO.	ILLINOIS	FED. AID PROJECT		

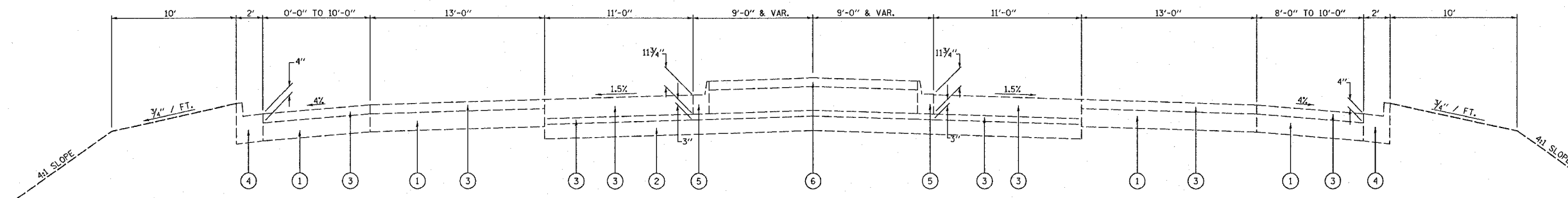

EXISTING TANGENT TYPICAL SECTION W/ BUS LOADING LANE  
 286+85 TO 288+36 W.B. 286+85 TO 288+48 E.B.  
 294+69 TO 296+23 E.B.

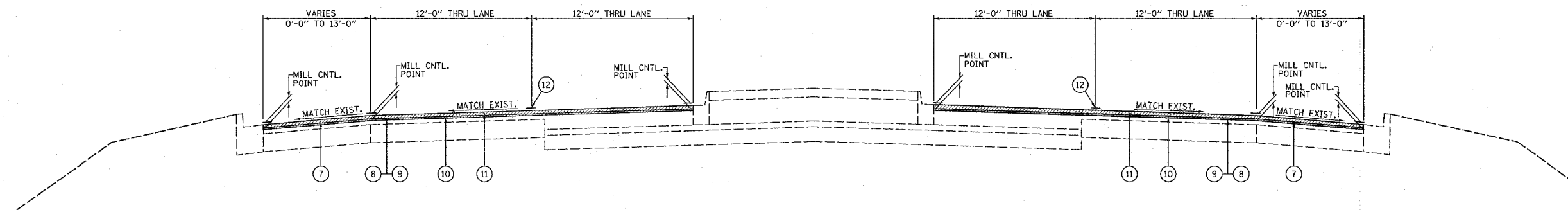

PROPOSED TANGENT TYPICAL SECTION W/ BUS LOADING LANE  
 286+85 TO 288+36 W.B. 286+85 TO 288+48 E.B.  
 294+69 TO 296+23 E.B.

**LEGEND**

- ① EXISTING P.C.C. PAVEMENT - 8"
- ② EXISTING P.C.C. PAVEMENT - 9"
- ③ EXISTING BITUMINOUS OVERLAY - VARIES 3" TO 11 3/4"
- ④ EXISTING CONCRETE COMBINATION C&G T-B 6.24
- ⑤ EXISTING CONCRETE COMBINATION C&G T-M 6.06
- ⑥ EXISTING P.C.C. MEDIAN SURFACE - 4"
- ⑦ PROPOSED BITUMINOUS SURFACE REMOVAL - 2 1/4"
- ⑧ PROPOSED BITUMINOUS MATERIAL (PRIME COAT)
- ⑨ PROPOSED AGGREGATE (PRIME COAT)
- ⑩ PROPOSED LEVELING BINDER (MIN.) - 3/4"
- ⑪ PROPOSED SURFACE COURSE - 1 1/2"
- ⑫ PROPOSED THERMOPLASTIC PAVEMENT MARKING

REVISIONS		ILLINOIS DEPARTMENT OF TRANSPORTATION
NAME	DATE	
		<b>TYPICAL SECTIONS</b> FAU ROUTE 9128 SECTION 28-RS-1 MADISON COUNTY  SCALE: VERT. _____ HORIZ. _____ DATE _____
DRAWN BY _____		CHECKED BY _____

PLOT DATE = 6/30/2008  
 FILE NAME = C:\Users\jw\Documents\76960\28-RS-1\28-RS-1.dgn  
 PLOT SCALE = 1/8" = 1'-0"  
 REFERENCE = #REF#

F.A.U. RTE.	SECTION	COUNTY	TOTAL SHEETS	SHEET NO.
9128	28-RS-1	MADISON	14	7
STA.		TO STA.		
FED. ROAD DIST. NO.	ILLINOIS	FED. AID PROJECT		

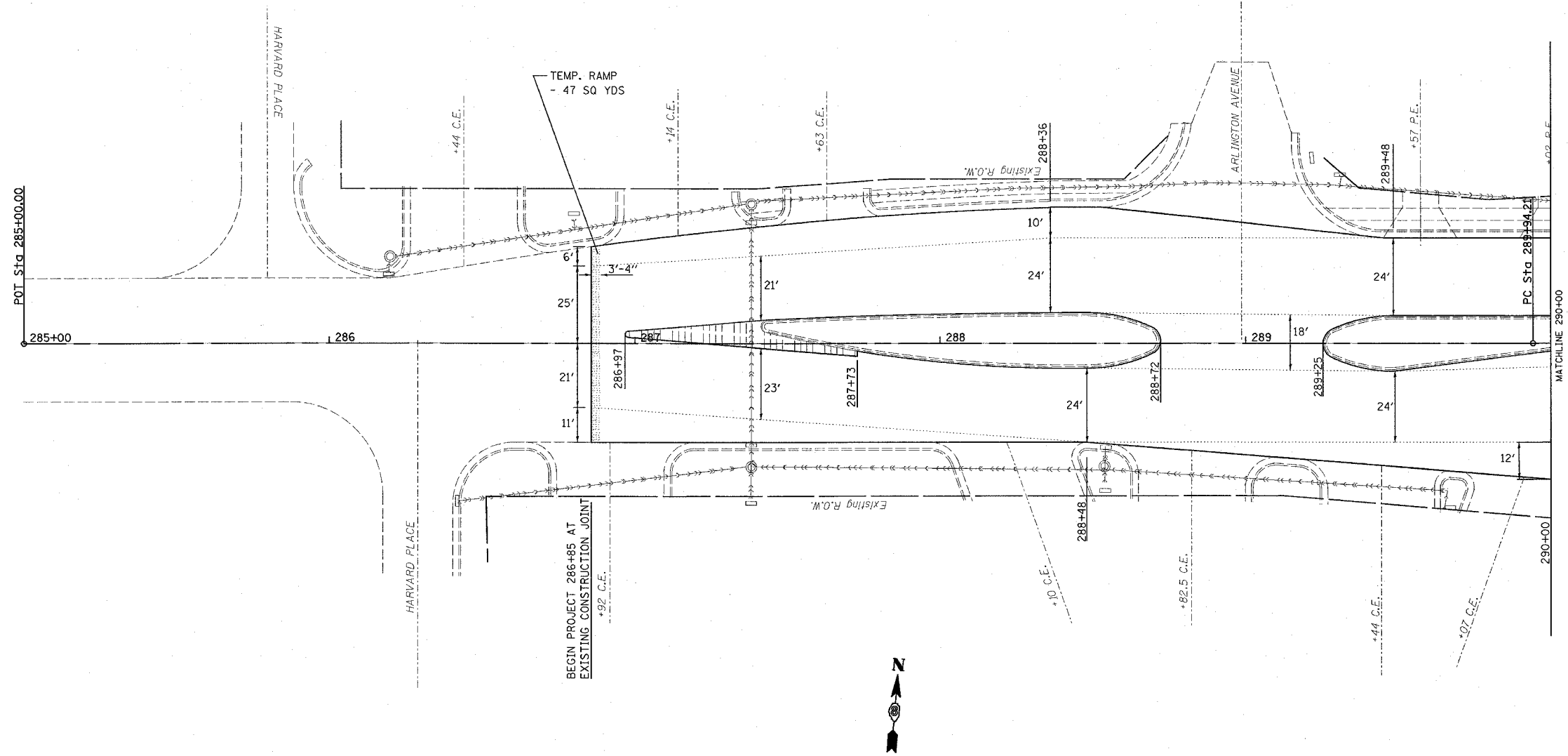

PLOT DATE = 6/28/2005  
 FILE NAME = c:\projects\m1005\plan\p10101a.dgn  
 PLOT SCALE = 28.0000 / 1 IN.  
 REFERENCE = 48C\*

REVISIONS	
NAME	DATE

ILLINOIS DEPARTMENT OF TRANSPORTATION  
**PLAN VIEW**  
 FAU ROUTE 9128  
 SECTION 28-RS-1  
 MADISON COUNTY

SCALE: VERT.      DRAWN BY  
 HORIZ.              CHECKED BY

F.A.U. RTE.	SECTION	COUNTY	TOTAL SHEETS	SHEET NO.
9128	28-RS-1	MADISON	14	8
STA.		TO STA.		
FED. ROAD DIST. NO.		ILLINOIS FED. AID PROJECT		

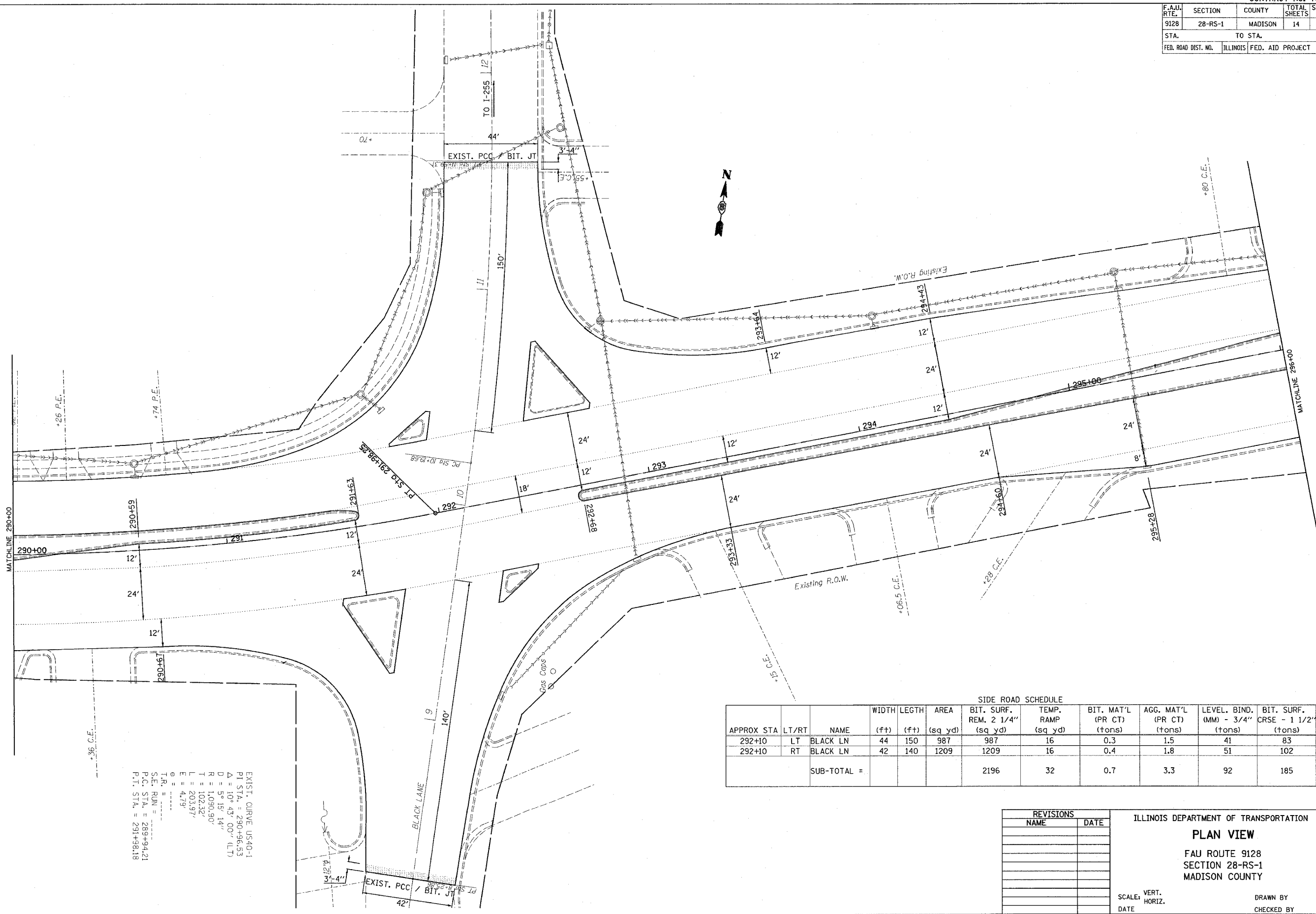

APPROX STA	LT/RT	NAME	WIDTH (ft)	LENGH (ft)	AREA (sq yd)	BIT. SURF. REM. 2 1/4" (sq yd)	TEMP. RAMP (sq yd)	BIT. MAT'L (PR CT) (tons)	AGG. MAT'L (PR CT) (tons)	LEVEL. BIND. (MM) - 3/4" CRSE - 1 1/2" (tons)	BIT. SURF. CRSE - 1 1/2" (tons)
292+10	LT	BLACK LN	44	150	987	987	16	0.3	1.5	41	83
292+10	RT	BLACK LN	42	140	1209	1209	16	0.4	1.8	51	102
SUB-TOTAL =						2196	32	0.7	3.3	92	185

EXIST. CURVE US-40-1  
 PI STA. = 290+96.53  
 $\Delta = 10^\circ 43' 00''$  (LT)  
 $D = 5^\circ 18' 14''$   
 $R = 1,090.90'$   
 $T = 102.32'$   
 $L = 203.97'$   
 $E = 4.79'$   
 $\theta = 4.79'$   
 T.R. = .....  
 S.E. RUN = .....  
 P.C. STA. = 289+94.21  
 P.T. STA. = 291+98.18

REVISIONS	
NAME	DATE

ILLINOIS DEPARTMENT OF TRANSPORTATION  
**PLAN VIEW**  
 FAU ROUTE 9128  
 SECTION 28-RS-1  
 MADISON COUNTY  
 SCALE: VERT. \_\_\_\_\_  
 HORIZ. \_\_\_\_\_  
 DATE \_\_\_\_\_  
 DRAWN BY \_\_\_\_\_  
 CHECKED BY \_\_\_\_\_

PLOT DATE = 7/7/2005  
 FILE NAME = S:\p03\9128\plan\plan\28rs1\05.dgn  
 PLOT SCALE = 1" = 40'  
 REFERENCE = #REF#



F.A.I. RTE.	SECTION	COUNTY	TOTAL SHEETS	SHEET NO.
9128	28-RS-1	MADISON	14	9
STA.		TO STA.		
FED. ROAD DIST. NO.	ILLINOIS	FED. AID PROJECT		

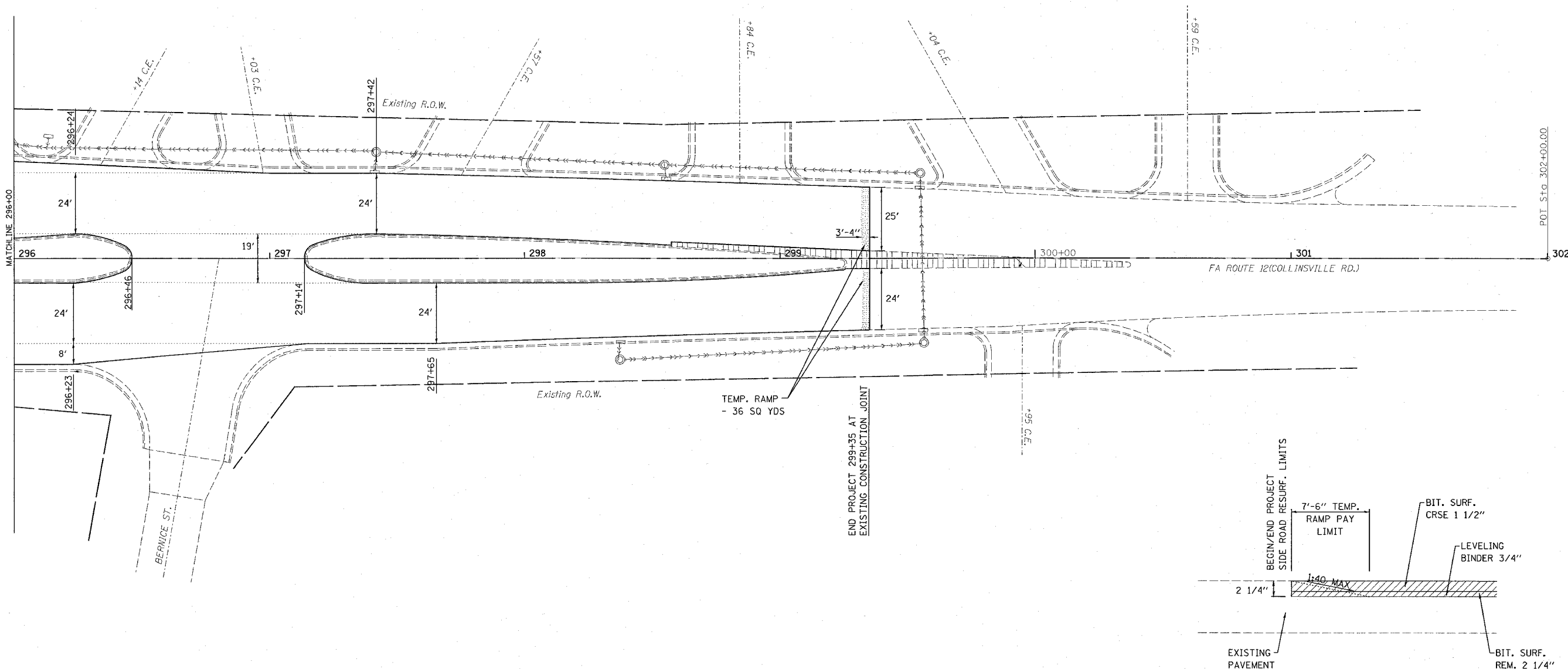

PLOT DATE = 6/30/2005  
 FILE NAME = \\s010105\p1m\p1m10105.dgn  
 PLOT SCALE = 20,000000 / IN.  
 REFERENCE = #REF#

REVISIONS		ILLINOIS DEPARTMENT OF TRANSPORTATION
NAME	DATE	
		<b>PLAN VIEW</b> FAU ROUTE 9128 SECTION 28-RS-1 MADISON COUNTY  SCALE: VERT. _____ HORIZ. _____ DATE _____

DRAWN BY \_\_\_\_\_  
 CHECKED BY \_\_\_\_\_

F.A.U. RTE.	SECTION	COUNTY	TOTAL SHEETS	SHEET NO.
9128	28-RS-1	MADISON	14	10
STA.		TO STA.		
FED. ROAD DIST. NO.	ILLINOIS	FED. AID PROJECT		

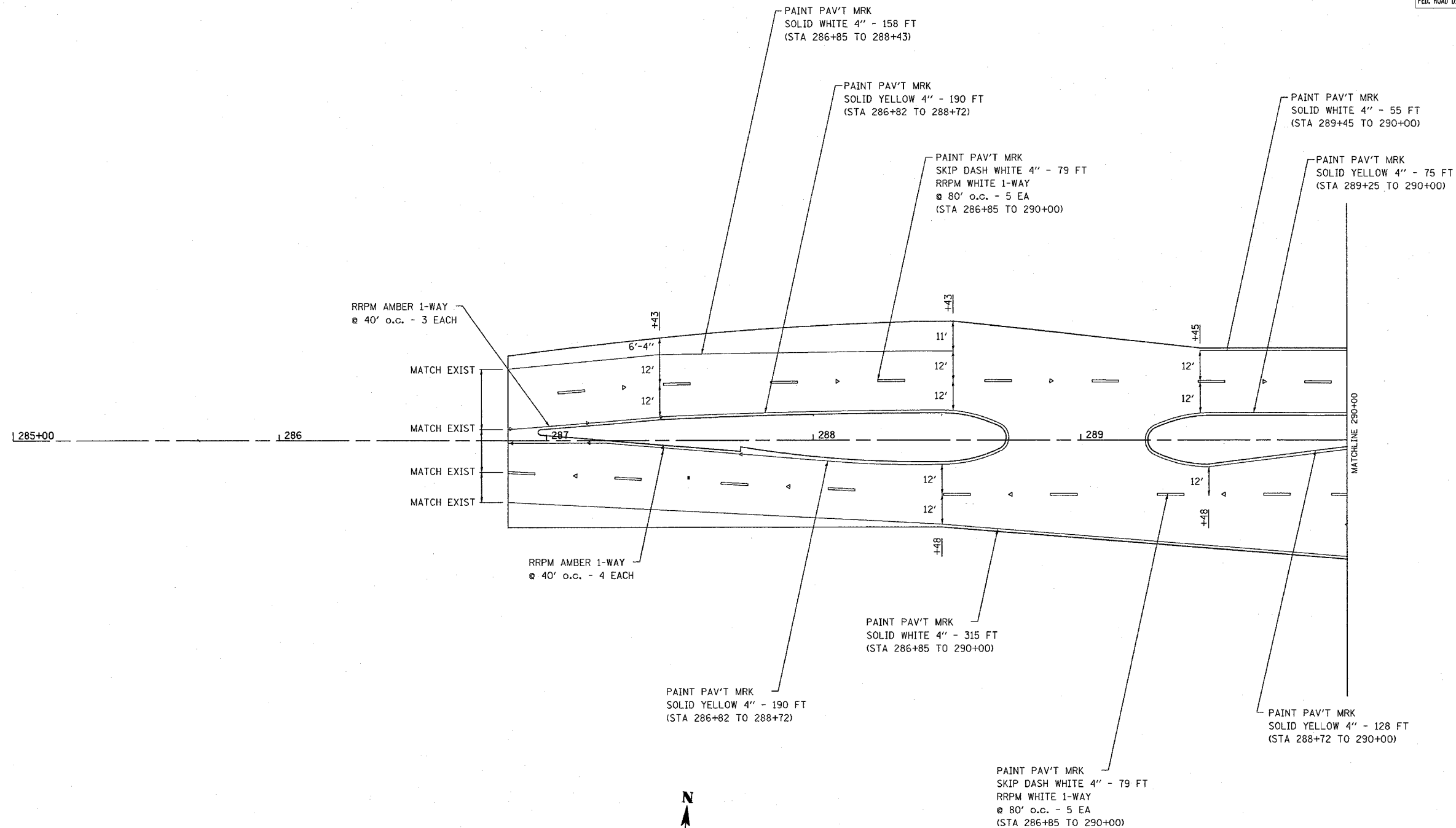

PLOT DATE = 7/23/2005  
FILE NAME = c:\projects\pav\pav\plan\pav\pav.dgn  
PLOT SCALE = 28.0000 / 1 IN.  
REFERENCE = #1004

REVISIONS	
NAME	DATE

ILLINOIS DEPARTMENT OF TRANSPORTATION  
**PAVEMENT MARKING  
PLANS**  
FAU ROUTE 9128  
SECTION 28-RS-1  
MADISON COUNTY

SCALE: VERT. \_\_\_\_\_  
HORIZ. \_\_\_\_\_  
DATE \_\_\_\_\_

DRAWN BY \_\_\_\_\_  
CHECKED BY \_\_\_\_\_

F.A.U. RTE.	SECTION	COUNTY	TOTAL SHEETS	SHEET NO.
9128	28-RS-1	MADISON	14	11
STA.		TO STA.		
FED. ROAD DIST. NO.		ILLINOIS FED. AID PROJECT		

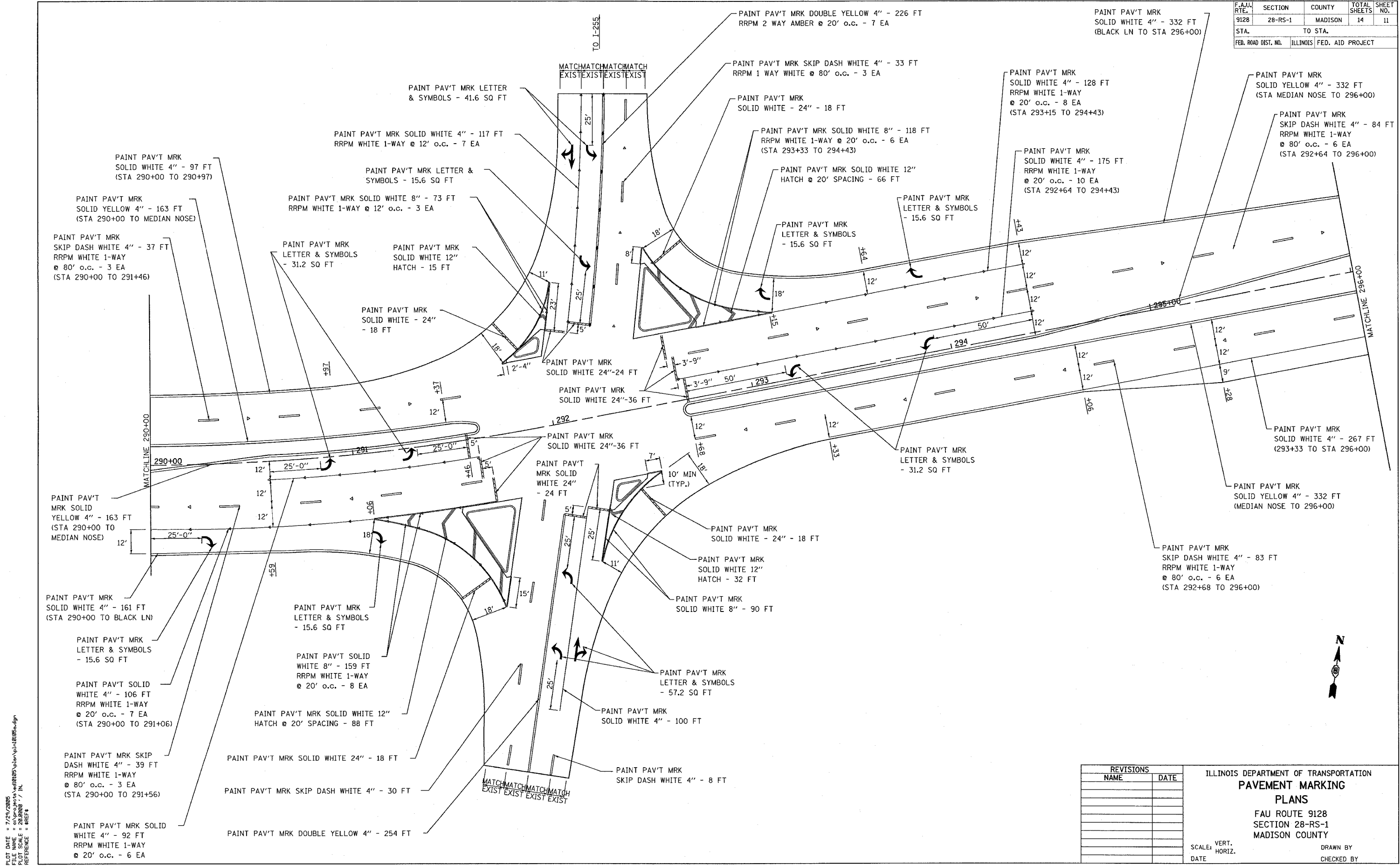

PLOT DATE = 7/23/2005  
 FILE NAME = c:\p\proj\28-rs-1\plan\p11b106.dgn  
 PLOT SCALE = 20.0000 / 1"  
 REFERENCE = SHEET 4

REVISIONS	
NAME	DATE

ILLINOIS DEPARTMENT OF TRANSPORTATION  
**PAVEMENT MARKING PLANS**  
 FAU ROUTE 9128  
 SECTION 28-RS-1  
 MADISON COUNTY

SCALE: VERT. \_\_\_\_\_  
 HORIZ. \_\_\_\_\_  
 DATE \_\_\_\_\_

DRAWN BY \_\_\_\_\_  
 CHECKED BY \_\_\_\_\_

F.A.U. RTE.	SECTION	COUNTY	TOTAL SHEETS	SHEET NO.
9128	28-RS-1	MADISON	14	12
STA.		TO STA.		
FED. ROAD DIST. NO.		ILLINOIS FED. AID PROJECT		

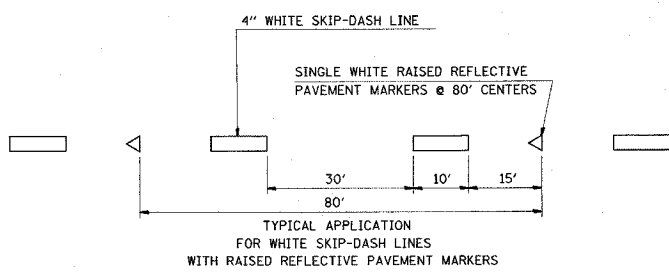
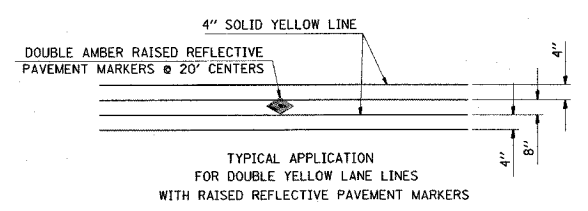
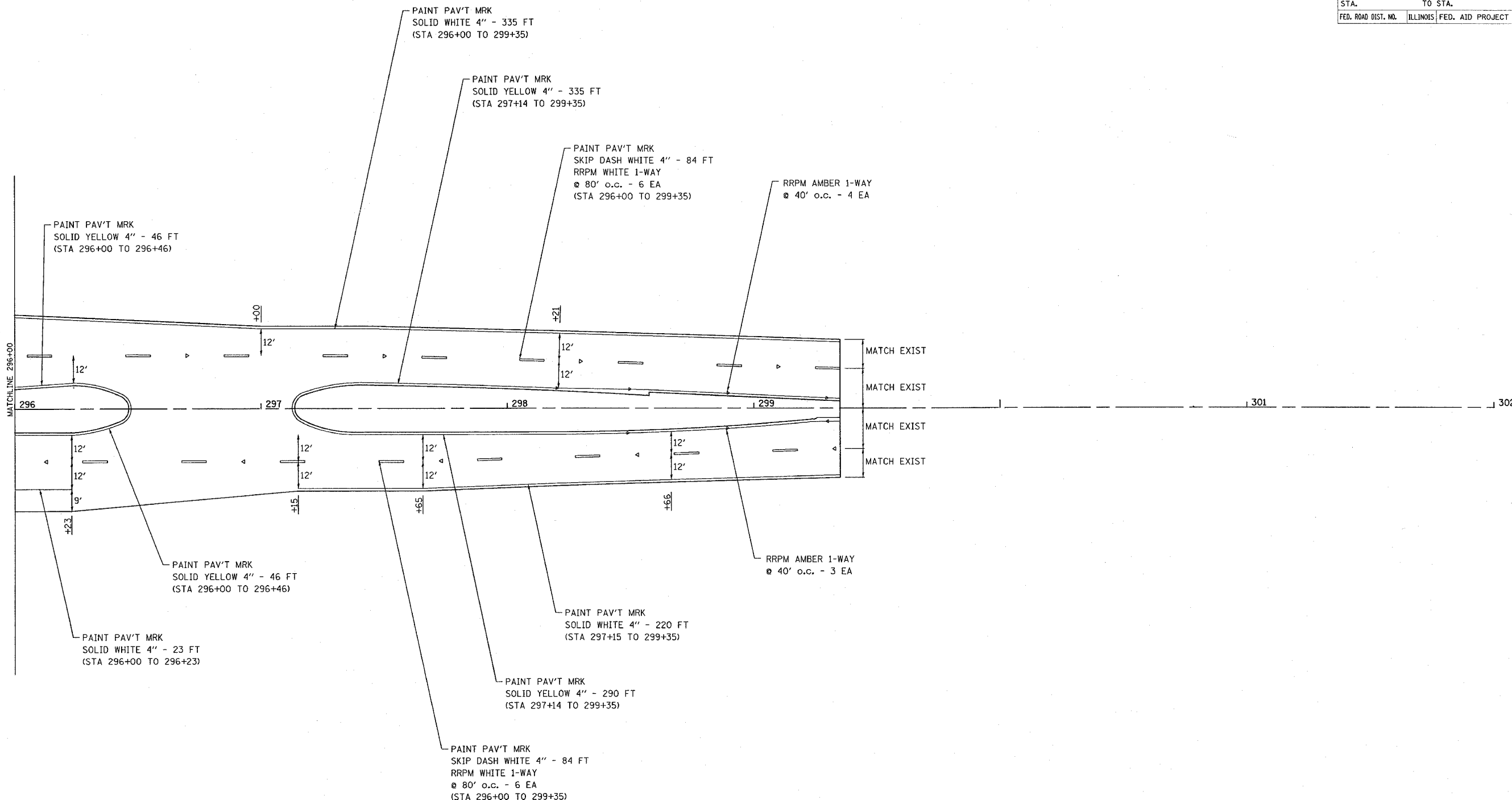

REVISIONS	
NAME	DATE

ILLINOIS DEPARTMENT OF TRANSPORTATION  
**PAVEMENT MARKING PLANS**  
 FAU ROUTE 9128  
 SECTION 28-RS-1  
 MADISON COUNTY

SCALE: VERT. \_\_\_\_\_  
 HORIZ. \_\_\_\_\_

DATE \_\_\_\_\_

DRAWN BY \_\_\_\_\_  
 CHECKED BY \_\_\_\_\_

PLOT DATE = 7/23/2005  
 FILE NAME = c:\projects\76960\plan\plan10105a.dgn  
 PLOT SCALE = 1/8" = 1'-0"  
 REFERENCE = 48674

F.A.U. RTE.	SECTION	COUNTY	TOTAL SHEETS	SHEET NO.
9128	28-RS-1	MADISON	14	13
STA.		TO STA.		
FED. ROAD DIST. NO.	ILLINOIS	FED. AID PROJECT		

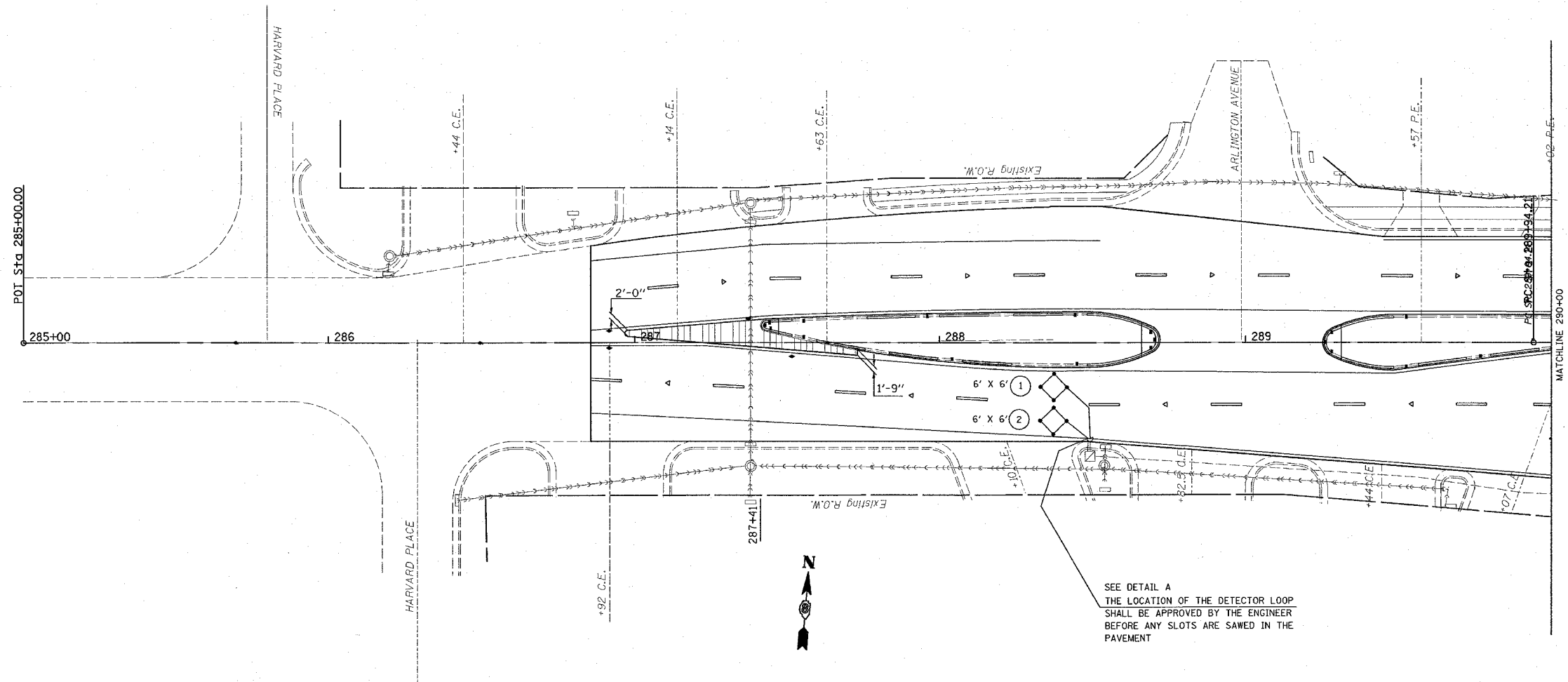

PLOT DATE = 6/30/2005  
 FILE NAME = c:\projects\wd1005\plan\plan10105.dgn  
 PLOT SCALE = 28.0000 / 1 IN.  
 REFERENCE = \$REF\$

REVISIONS	
NAME	DATE

ILLINOIS DEPARTMENT OF TRANSPORTATION  
**DETECTOR LOOP REPLACEMENT**  
 PLAN SHT.1 OF 2  
 FAU ROUTE 9128  
 SECTION 28-RS-1  
 MADISON COUNTY

SCALE: VERT.      DRAWN BY  
 HORIZ.              CHECKED BY  
 DATE

F.A.U. RTE.	SECTION	COUNTY	TOTAL SHEETS	SHEET NO.
9128	28-RS-1	MADISON	14	14
STA.		TO STA.		
FED. ROAD DIST. NO.	ILLINOIS	FED. AID PROJECT		

DETECTOR LOOP REQUIREMENTS AND CALCULATIONS FOR COLLINSVILLE ROAD AND BLACK LANE

LOOP	PHASE (Ø)	LOOP SIZE(FT)	REQUIRED # OF TURNS	CALCULATED INDUCTANCE MICROHENRIES (µH)	CALCULATED RESISTANCE OHMS (Ω)
1. EB CCO A	6	6' X 6'	6	360.0	2.8
2. EB CCO B	6	6' X 6'	6	357.7	2.7
3. EB LT CD	1	6' X 50'Q	3-6-3	812.8	2.2
4. EB THRU CD A	6	6' X 50'Q	3-6-3	819.1	2.3
5. EB THRU CD	6	6' X 50'Q	3-6-3	815.7	2.3
6. EB RT CD	6	6' X 25'Q	3-6-3	443.9	1.6
7. NB CCO	4	NA	NA	NA	NA
8. NB LT CD	4	6' X 50'Q	3-6-3	833.0	2.7
9. NB THRU CD	4	6' X 50'Q	3-6-3	831.2	2.6
10. NB RT CD A	4	NA	NA	NA	NA
11. NB RT CD B	4	6' X 25'Q	3-6-3	458.1	1.9
12. WB CCO	2	6' X 6'	6	364.4	2.9
13. WB CCO	2	6' X 6'	6	361.7	2.8
14. WB LT CD	5	6' X 50'Q	3-6-3	820.0	2.4
15. WB THRU CD A	2	6' X 50'Q	3-6-3	816.8	2.3
16. WB THRU CD B	2	6' X 50'Q	3-6-3	813.2	2.2
17. WB RT CD	2	6' X 25'Q	3-6-3	439.1	1.5
18. SB CCO A	3	NA	NA	NA	NA
19. SB CCO B	3	NA	NA	NA	NA
20. SB LT CD	3	6' X 50'Q	3-6-3	803.1	2.0
21. SB THRU CD	3	6' X 50'Q	3-6-3	801.0	1.9
22. SB RT CD A	3	NA	NA	NA	NA
23. SB RT CD B	3	6' X 25'Q	3-6-3	425.5	1.2

THE ABOVE VALUES ARE CALCULATED OF COMBINED LOOP AND LEAD-IN INDUCTANCE AND RESISTANCE. ACTUAL MEASURED VALUES SHOULD BE WITHIN +/- 20% OF THESE VALUES.

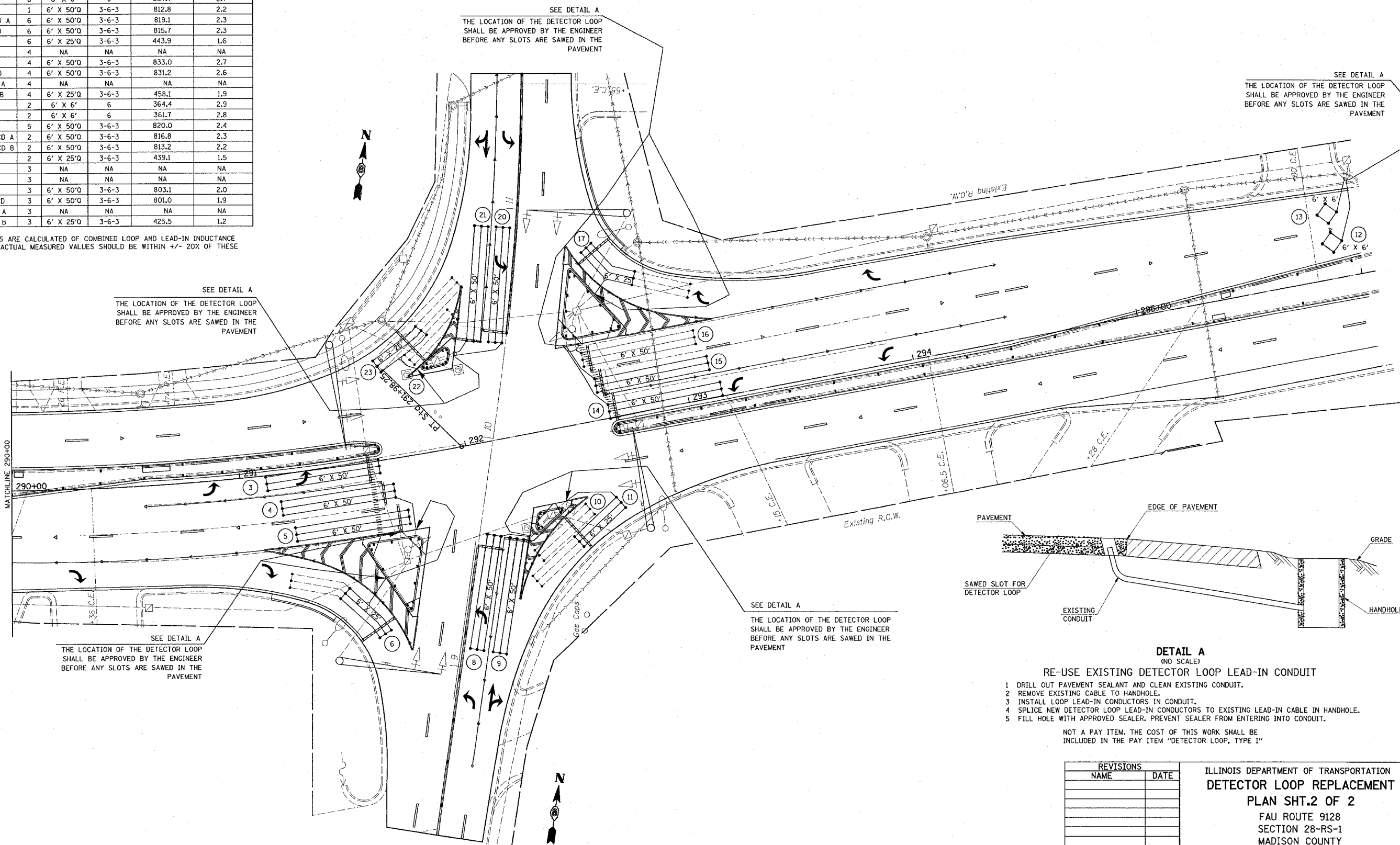

SEE DETAIL A  
THE LOCATION OF THE DETECTOR LOOP SHALL BE APPROVED BY THE ENGINEER BEFORE ANY SLOTS ARE SAWED IN THE PAVEMENT

SEE DETAIL A  
THE LOCATION OF THE DETECTOR LOOP SHALL BE APPROVED BY THE ENGINEER BEFORE ANY SLOTS ARE SAWED IN THE PAVEMENT

SEE DETAIL A  
THE LOCATION OF THE DETECTOR LOOP SHALL BE APPROVED BY THE ENGINEER BEFORE ANY SLOTS ARE SAWED IN THE PAVEMENT

SEE DETAIL A  
THE LOCATION OF THE DETECTOR LOOP SHALL BE APPROVED BY THE ENGINEER BEFORE ANY SLOTS ARE SAWED IN THE PAVEMENT

SEE DETAIL A  
THE LOCATION OF THE DETECTOR LOOP SHALL BE APPROVED BY THE ENGINEER BEFORE ANY SLOTS ARE SAWED IN THE PAVEMENT

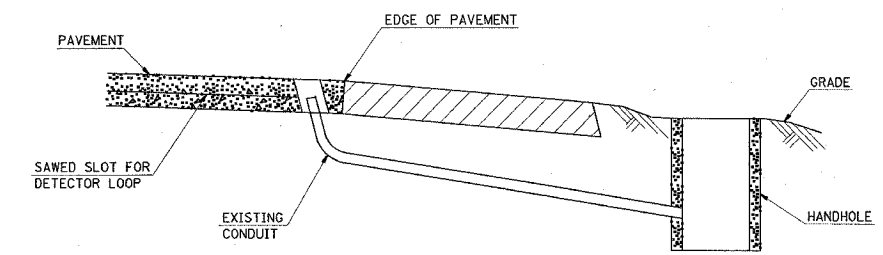

- DETAIL A**  
(NO SCALE)
- RE-USE EXISTING DETECTOR LOOP LEAD-IN CONDUIT**
- 1 DRILL OUT PAVEMENT SEALANT AND CLEAN EXISTING CONDUIT.
  - 2 REMOVE EXISTING CABLE TO HANDHOLE.
  - 3 INSTALL LOOP LEAD-IN CONDUCTORS IN CONDUIT.
  - 4 SPLICE NEW DETECTOR LOOP LEAD-IN CONDUCTORS TO EXISTING LEAD-IN CABLE IN HANDHOLE.
  - 5 FILL HOLE WITH APPROVED SEALER. PREVENT SEALER FROM ENTERING INTO CONDUIT.
- NOT A PAY ITEM. THE COST OF THIS WORK SHALL BE INCLUDED IN THE PAY ITEM "DETECTOR LOOP, TYPE I"

REVISIONS	
NAME	DATE

ILLINOIS DEPARTMENT OF TRANSPORTATION  
**DETECTOR LOOP REPLACEMENT**  
**PLAN SHT.2 OF 2**  
FAU ROUTE 9128  
SECTION 28-RS-1  
MADISON COUNTY

SCALE: VERT. \_\_\_\_\_  
HORIZ. \_\_\_\_\_  
DATE \_\_\_\_\_  
DRAWN BY \_\_\_\_\_  
CHECKED BY \_\_\_\_\_

PLOT DATE = 6/20/2006  
FILE NAME = c:\pvc\sect\105\plan\plan10105.dgn  
PLOT SCALE = 28,800% / IN.  
REFERENCE = #REF#