

**STATE OF ILLINOIS
DEPARTMENT OF TRANSPORTATION**

F.A.U. RTE.	SECTION	COUNTY	TOTAL SHEETS	SHEET NO.
275B	D2-00025-00-BR	LAKE	40	11
FED. ROAD DIST. NO.	ILLINOIS	FED. AID PROJECT		
			CONTRACT 83790	

SHEET NO. 1
30 SHEETS

Benchmark: Set Square on NE abutment/wingwall El. 665.04
Existing Structure: S.N. 049-6801. Built in 1964 as Moffett Road Bridge Section 44-12-1B-CA (Part 1B) (County) and Section 8B-CS (Part 1B) (Village). 3-Span P.P.C. deck on open abutments. 114'-9" Back to Back of Abutments, 31'-0" Out of Out Deck. Structure is to be removed. Traffic will be detoured during construction.
Salvage: None.

LOADING HS20-44

Allow 50#/sq. ft. for future wearing surface

DESIGN SPECIFICATIONS

AASHTO 2002 Standard Specifications for Highway Bridges, 17th Edition

DESIGN STRESSES

FIELD UNITS

f'c = 3,500 psi
fy = 60,000 psi (Reinforcement)

PRECAST PRESTRESSED UNITS

f'c = 6,000 psi
f'ci = 5,000 psi
f's = 270,000 psi (1/2" low lax. strands)
fsl = 201,960 psi (1/2" low lax. strands)

SEISMIC DATA

Seismic Performance Category (SPC) = A
Bedrock Acceleration Coefficient (A) = 3.5%
Site Coefficient (S) = 1.0

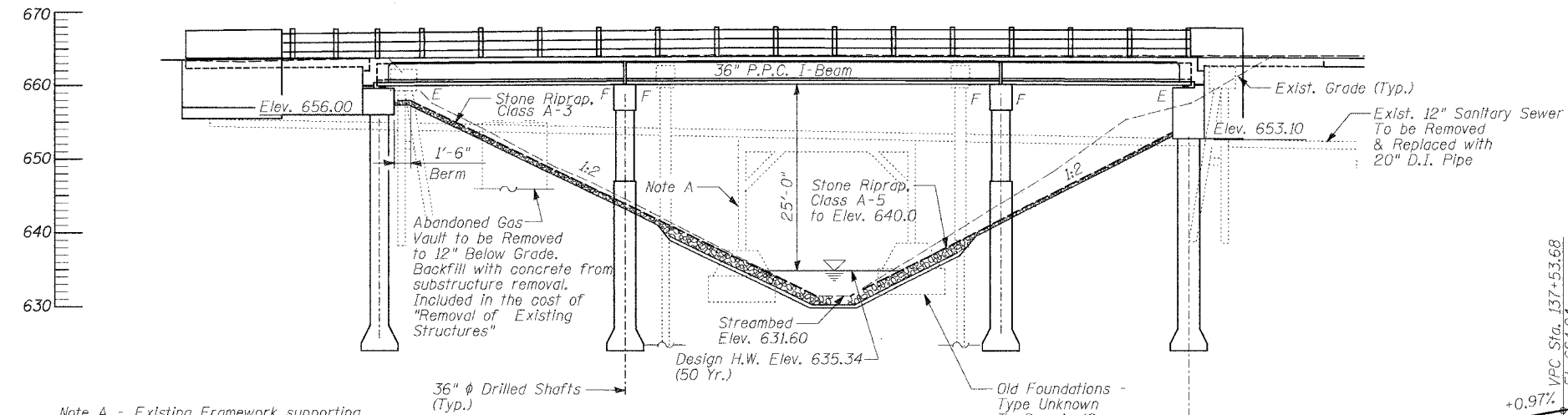

Note A - Existing Framework supporting 12" Sanitary Sewer to remain in place.

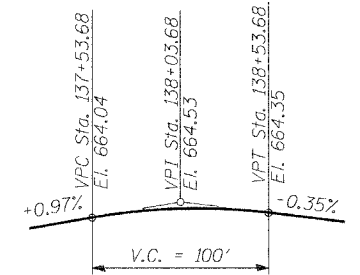

PROFILE GRADE
(along C roadway)

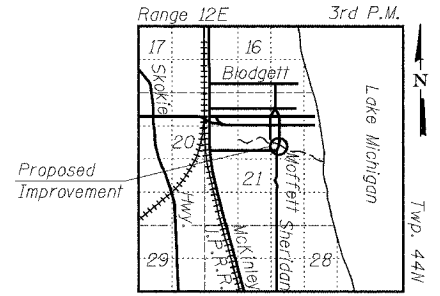
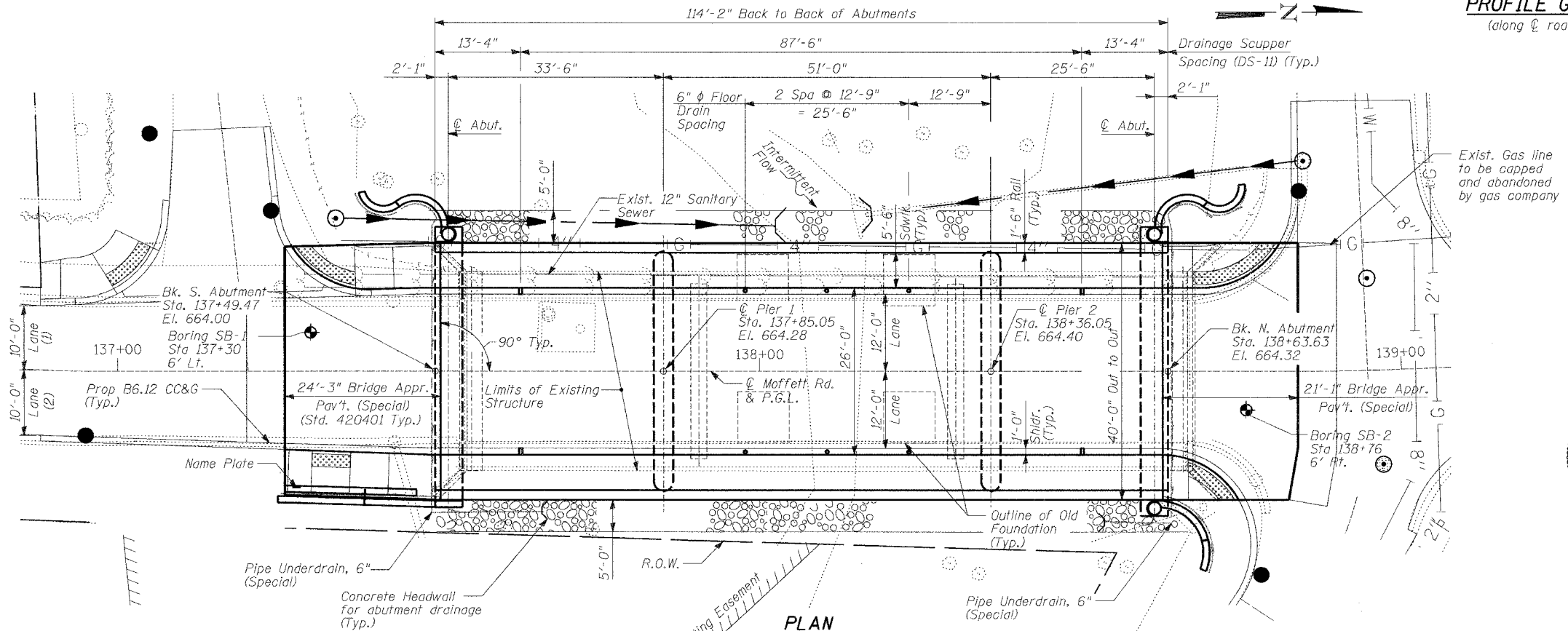

LOCATION SKETCH

I certify that to the best of my knowledge, information and belief, this bridge design is structurally adequate for the design loading shown on the plans. The design is an economical one for the use of the structure and complies with requirements of the current "AASHTO STANDARD SPECIFICATIONS FOR HIGHWAY BRIDGES."



Signed Phillip D. Frey
Phillip D. Frey, S.E. II, Lic. No. 081-004826
Expires 11-30-2005.
Date 2/23/05

TYLIN INTERNATIONAL

DESIGNED	SP, DR
CHECKED	SP
DRAWN	SP, DR
CHECKED	PF
DATE	12-22-2004

(1) Lane width varies from 10'-0" at Sta. 137+88.00 to 12'-0" at Sta. 137+48.14.
(2) Lane width varies from 10'-0" at Sta. 137+88.00 to 12'-0" at Sta. 137+48.21.

GENERAL PLAN AND ELEVATION

MOFFETT ROAD OVER
DRAINAGE RAVINE
FAU 2758
LAKE COUNTY
S.N. 049-6803