

CABLE PLAN LEGEND

- | EXISTING | PROPOSED | |
|----------|----------|---|
| | | 8" (200mm) TRAFFIC SIGNAL SECTION |
| | | 12" (300mm) TRAFFIC SIGNAL SECTION |
| | | 12" (300mm) PEDESTRIAN SIGNAL SECTION |
| | | 12" (300mm) PEDESTRIAN SIGNAL SECTION |
| | | CONTROLLER CABINET |
| | | SERVICE INSTALLATION |
| | | TELEPHONE CONNECTION |
| | | VEHICLE DETECTOR, INDUCTION LOOP |
| | | MAGNETIC DETECTOR |
| | | EMERGENCY VEHICLE LIGHT DETECTOR |
| | | CONFIRMATION BEACON |
| | | PUSHBUTTON DETECTOR |
| | | DENOTES NUMBER OF CONDUCTORS. ALL CABLE NO. 14 EXCEPT AS INDICATED. ALL LOOP DETECTOR CABLE TO BE SHIELDED. |
| | | GROUND CABLE IN CONDUIT NO. 6 SOLID COPPER (GREEN) |
| | | FIBER OPTIC CABLE IN CONDUIT NO. 62.5/125 MM12F SM12F |
| | | SIGNAL FACE WITH BACKPLATE. "P" INDICATES PROGRAMMED HEAD. |
| | | RAILROAD CONTROL CABINET |
| | | ILLUMINATED SIGN "NO LEFT TURN" |
| | | ILLUMINATED SIGN "NO RIGHT TURN" |
| | | GROUND ROD AT HANDHOLE (H), DOUBLE HANDHOLE (H), OR CONTROLLER (C) |
| | | GROUND ROD AT POST (P) OR MAST ARM POLE (MA) |
| | | GROUND ROD AT ELECTRIC SERVICE INSTALLATION |
| | | MICROWAVE VEHICLE SENSOR |
| | | FIBER OPTIC CABLE IN CONDUIT NO. 62.5/125 MM24F SM12F |
| | | PAN-TILT-ZOOM CAMERA |

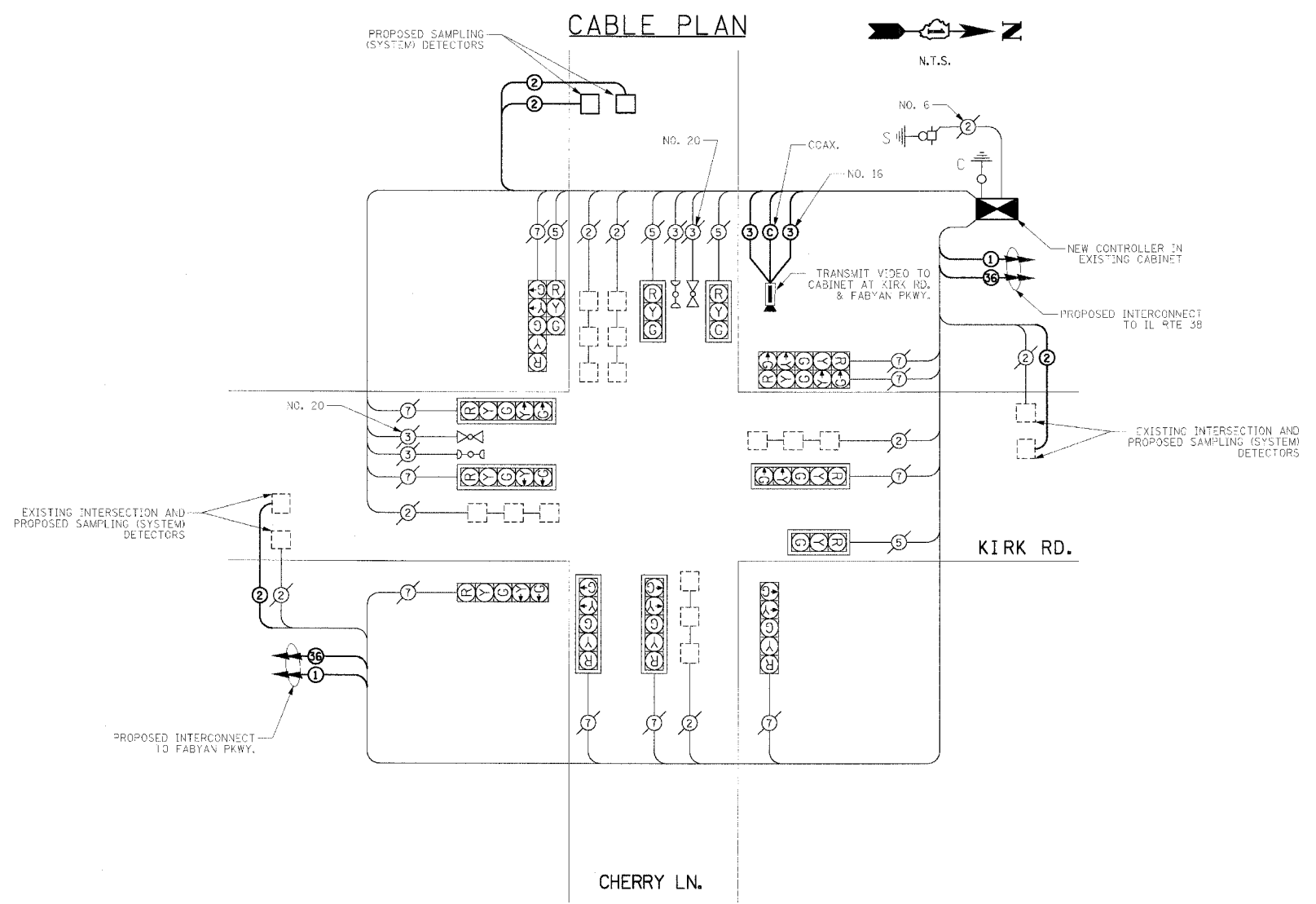

PROPOSED CONTROLLER SEQUENCE

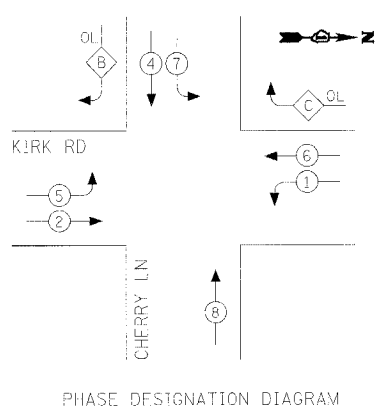

OVERLAP LETTER	PERMISSIVE PHASE	PROTECTED PHASE
B	= 4	+ 5
C	= 6	- 7

SCHEDULE OF QUANTITIES

QTY	UNIT	ITEM DESCRIPTION
218	FOOT	CONDUIT IN TRENCH, 2" DIA., GALVANIZED STEEL
40	FOOT	CONDUIT PUSHED, 2" DIA., GALVANIZED STEEL
1	EACH	HANDHOLE
218	FOOT	TRENCH AND BACKFILL FOR ELECTRICAL WORK
1	EACH	MAINTENANCE OF EXISTING TRAFFIC SIGNAL INSTALLATION
1	EACH	FULL-ACTUATED CONTROLLER IN EXISTING CABINET, SPECIAL
1	EACH	TRANSCIVER - FIBER OPTIC
87	FOOT	ELECTRIC CABLE IN CONDUIT, SIGNAL NO. 14 3C
1590	FOOT	ELECTRIC CABLE IN CONDUIT, LEAD-IN, NO. 14 1 PAIR
87	FOOT	VIDEO ELECTRIC CABLE IN CONDUIT, NO. 16 3C
87	FOOT	VIDEO BELDEN 8281 COAXIAL CABLE IN CONDUIT
7	EACH	DRILL EXISTING HANDHOLE
4	EACH	INDUCTIVE LOOP DETECTOR
66	FOOT	DETECTOR LOOP, TYPE I
1	EACH	REMOVE EXISTING TRAFFIC SIGNAL EQUIPMENT
1	EACH	REMOTE-CONTROLLED VIDEO SYSTEM

I.D.O.T TRAFFIC SIGNAL INSTALLATION ELECTRICAL SERVICE REQUIREMENTS					TOTAL WATTAGE
TYPE	NO. LAMPS	WATTAGE INCAND.	WATTAGE LED	% OPERATION	
SIGNAL (RED)	14	135	17	0.50	945.0
(YELLOW)	14	135	25	0.25	472.5
(GREEN)	14	135	15	0.25	472.5
ARROW	20	135	12	0.10	270.0
PED. SIGNAL		90	25	1.00	
CONTROLLER	1	100	100	1.00	100.0
ILLUM. SIGN		84		0.05	
FLASHER				0.50	
ENERGY COSTS TO: KANE COUNTY DIVISION OF TRANSPORTATION 41011 BURLINGTON ROAD ST. CHARLES, ILLINOIS 60175					TOTAL = 2260.0
ENERGY SUPPLY CONTACT: CLAY TIKNIS PHONE: (630) 691-4363 COMPANY: COMED					

NOTE:
THE TRAFFIC SIGNAL CONTROL EQUIPMENT FOR THIS PROJECT SHALL BE "EAGLE" TO MATCH THE EXISTING ADJACENT SYSTEM.

FOUNDATION (DEPTH)	FT. (m)	CABLE SLACK	FT. (m)	VERTICAL	FT. (m)
TYPE A - POST	4 (1.2)	HANDHOLE	6.5 (2.0)	ALL FOUNDATIONS	3.5 (1.0)
D - CONTROLLER	4 (1.2)	DOUBLE HANDHOLE	13 (4.0)	MAST ARM (L) POLE	20'-H-2=
E - M. ARM POLE		SIGNAL POST	2 (1.0)	(6m+H-0.6m)=	
24" (600mm)	10 (3.0)	CONTROLLER CAB.	1 (0.5)	BRACKET MOUNTED	13 (4.0)
30" (750mm)	15 (4.6)	FIBER OPTIC	13 (4.0)	PED. PUSHBUTTON	4 (1.2)
		ELECTRIC SERVICE	1 (0.5)	ELECTRIC SERVICE	13.5 (4.1)
		GROUND CABLE	1 (0.5)	SERVICE TO GROUND	13.5 (4.1)
				POST MOUNTED	6 (1.8)

PROPOSED EMERGENCY VEHICLE PREEMPTION SEQUENCE

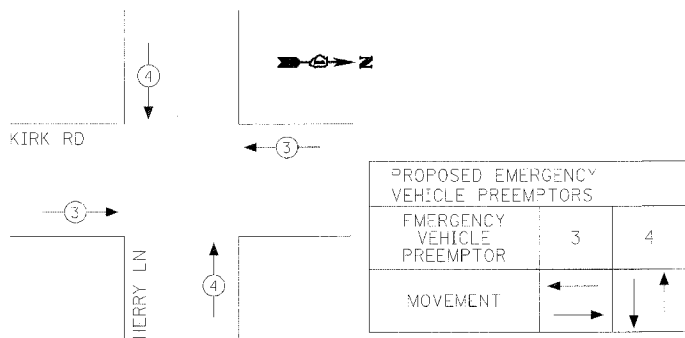

KENIG, LINDGREN, O'HARA, ABOONA, INC.
9575 West Higgins Road, Suite 400
Rosemont, Illinois 60018
(847) 518-9990 FAX (847) 518-9987

REVISIONS	
NAME	DATE

ILLINOIS DEPARTMENT OF TRANSPORTATION
CABLE PLAN, PHASE DESIGNATION DIAGRAM,
SCHEDULE OF QUANTITIES
KIRK RD AT CHERRY LN

SCALE: NONE
DATE: 07/19/05

DRAWN BY: DMS
DESIGNED BY: DMS
CHECKED BY: DMS