

F.A.U. ROUTE NO.	SECTION	5 COUNTY	TOTAL SHEETS	SHEET NO.
2830	*	COOK	10	4
ILLINOIS PROJECT: M-8003 (525)				
CONTRACT NO.: 83809				

* 02-00086-00-RS

BAXTER

WOODMAN
 Consulting Engineers
Baxter & Woodman
 Crystal Lake, Illinois 815.459.1260
 Burlington, Wisconsin 262.763.7834
 Mokena, Illinois 708.478.2090
 DeKalb, Illinois 815.787.3111
 Graylake, Illinois 847.223.5088
 Rockford, Illinois 815.489.1651
 www.baxwood.com

CONSULTANTS

NO.	DATE	DESCRIPTION
1	7/6/05	PER IDOT COMMENTS

REFER TO EQUIPMENT MANUFACTURER'S SHOP DRAWING

PLAN SHEET DESIGNATION

- COVER
- G - GENERAL
- H - HAZARDOUS MATERIALS
- C - CIVIL
- L - LANDSCAPE
- S - STRUCTURAL
- A - ARCHITECTURAL
- I - INTERIORS
- O - EQUIPMENT
- F - FIRE PROTECTION
- P - PLUMBING
- M - MECHANICAL
- E - ELECTRICAL
- T - TELECOMMUNICATIONS
- R - RESOURCE

PROJECT NO:	031064
DWG FILE:	
SCALE:	AS SHOWN
DRAWING DATE:	06-17-05
DESIGNED BY:	JER / DSD
DRAWN BY:	ABN / DSD
CHECKED BY:	LDH
PLOTTED BY:	

CLIENT

VILLAGE OF PARK FOREST ILLINOIS
(FAU 2830) MONEE ROAD STP (LAPP) PROJECT

SHEET TITLE
MONEE ROAD
STA. 11+42.89 TO 20+50
ROADWAY & PAVEMENT MARKINGS
PLAN

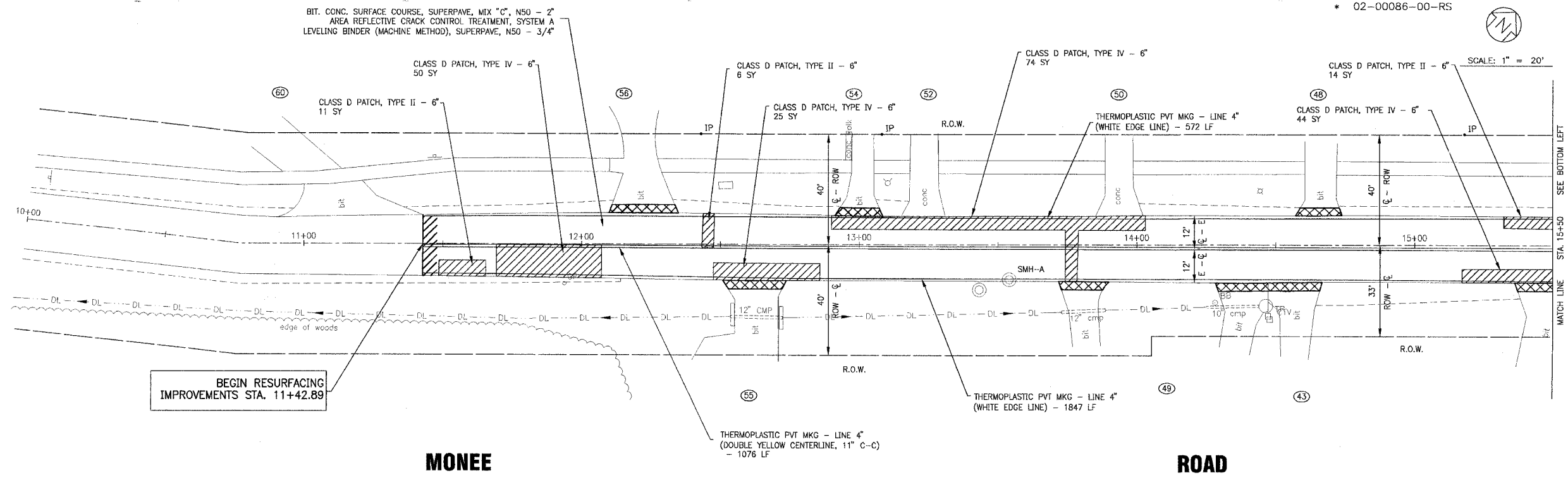

BEGIN RESURFACING IMPROVEMENTS STA. 11+42.89

MONEE

ROAD

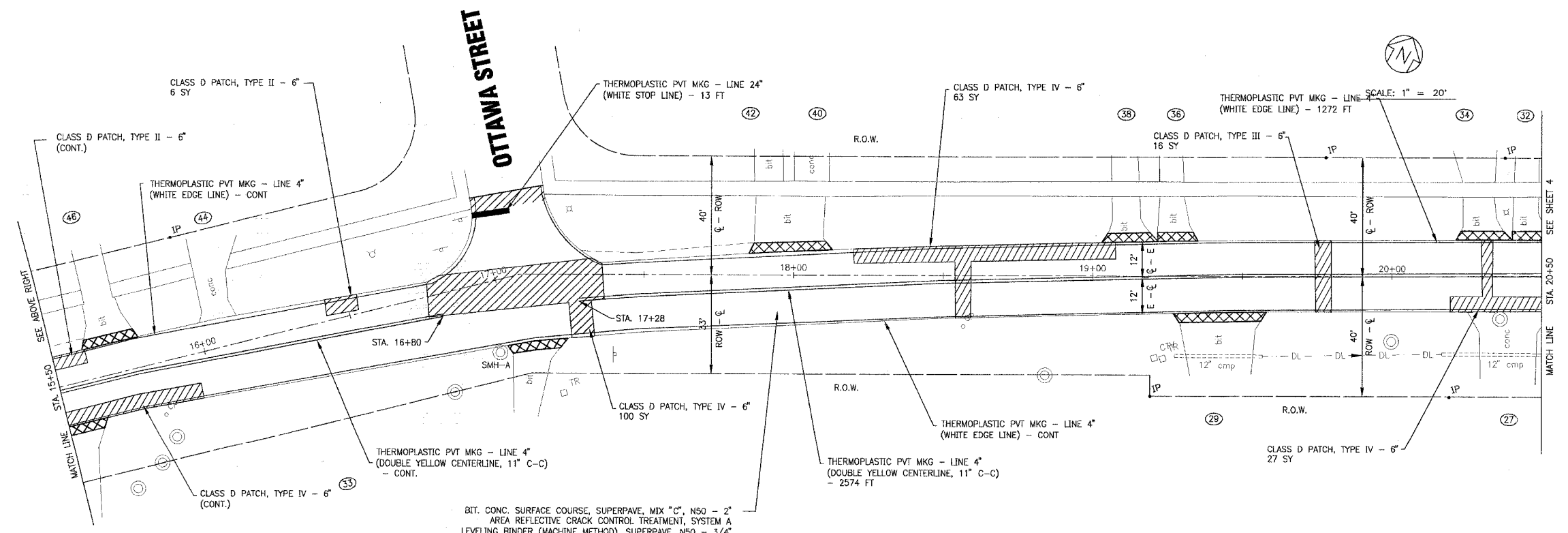

OTTAWA STREET

MONEE

ROAD

I:\PRKFT\031064\DWG\31054APL.DWG
 Plotted: 7-19-05 @ 4:50pm By: 368/jer
 Copyright © 2005, By Baxter & Woodman, Inc.
 State of Illinois - Professional Engineer
 License No. - 184-001121 - Expires 4-30-07