

FAU ROUTE NO.	SECTION	COUNTY	TOTAL SHEETS	SHEET NO.
2830	*	COOK	10	7
ILLINOIS PROJECT: M-8003 (525)				
CONTRACT NO.: 83809				
* 02-00086-00-RS				

BAXTER

WOODMAN
 Consulting Engineers
Baxter & Woodman
 Crystal Lake, Illinois 815.459.1260
 Burlington, Wisconsin 262.763.7884
 Mokena, Illinois 708.478.2090
 DeKalb, Illinois 815.787.3111
 Crystal Lake, Illinois 847.223.5088
 Rockford, Illinois 815.499.1551
 www.baxwood.com

CONSULTANTS

NO.	DATE	REVISIONS DESCRIPTION
1	7/6/05	PER IDOT COMMENTS

* - REFER TO EQUIPMENT MANUFACTURER'S SHOP DRAWING

PLAN SHEET DESIGNATION

- COVER
- G - GENERAL
- H - HAZARDOUS MATERIALS
- C - CIVIL
- L - LANDSCAPE
- S - STRUCTURAL
- A - ARCHITECTURAL
- I - INTERIORS
- Q - EQUIPMENT
- F - FIRE PROTECTION
- P - PLUMBING
- M - MECHANICAL
- E - ELECTRICAL
- T - TELECOMMUNICATIONS
- R - RESOURCE

PROJECT NO:	031064
DWG FILE:	
SCALE:	AS NOTED
DRAWING DATE:	3-16-04
DESIGNED BY:	JER
DRAWN BY:	TJB
CHECKED BY:	LDH
PLOTTED BY:	

CLIENT

VILLAGE OF PARK FOREST ILLINOIS
(FAU 2830) MONEE ROAD STP (LAPP) PROJECT

SHEET TITLE

IDOT PAVEMENT MARKINGS LETTERS AND SYMBOLS FOR TRAFFIC STAGING

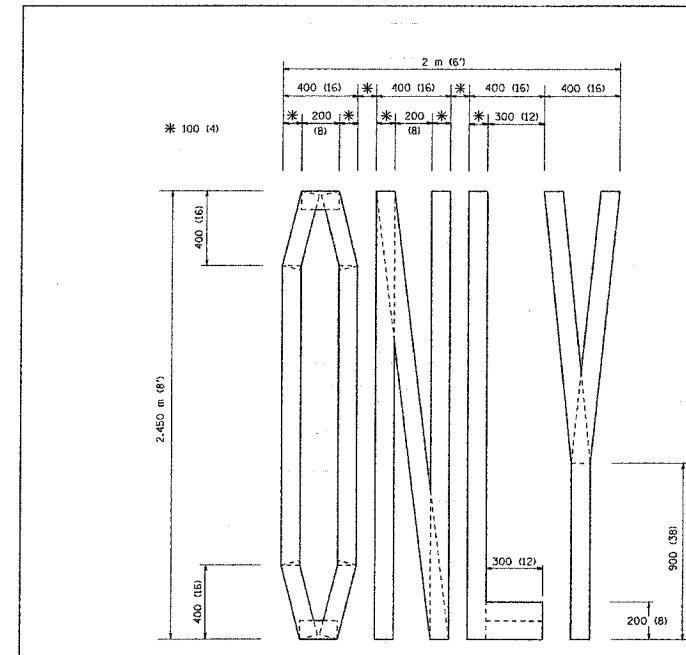

QUANTITY
 100 (4) LINE = 19.7 m (64.1 ft.)
 1.97 sq. m (21.1 sq. ft.)

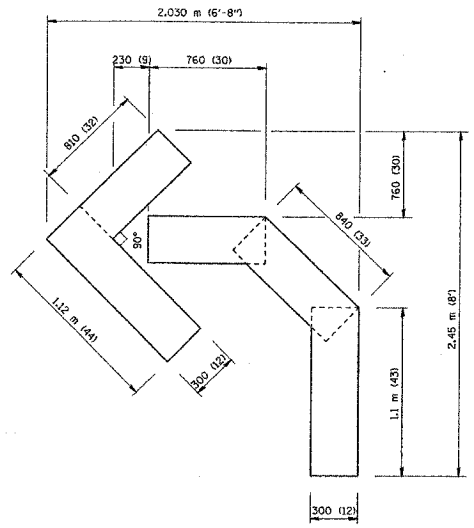

QUANTITY
 100 (4) LINE = 13.9 m (45.5 ft.)
 1.39 sq. m (15.2 sq. ft.)

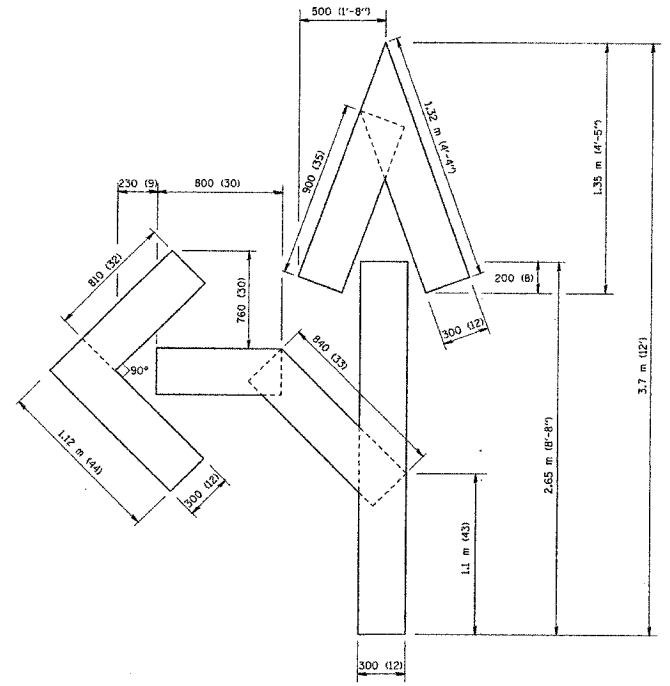

QUANTITY
 100 (4) LINE = 25.3 m (82.5 ft.)
 2.53 sq. m (27.5 sq. ft.)

All dimensions are in millimeters (inches) unless otherwise shown.

ILLINOIS DEPARTMENT OF TRANSPORTATION

PAVEMENT MARKING LETTERS AND SYMBOLS FOR TRAFFIC STAGING

REVISIONS	NAME	DATE
1	T. RAMMACHER	03/18/04
2	J. OBERLE	06/01/06
3	T. RAMMACHER	06/05/06
4	T. RAMMACHER	11/04/07
5	T. RAMMACHER	03/02/08
6	E. GOMEZ	08/28/00

SCALE: NONE
 DATE 11/20/01
 DRAWN BY CADD
 CHECKED BY

TC-16

I:\PRMT\031064\DWG\031064-6-10.dwg
 Plotted: 7-19-05 @ 4:52pm By: 388jler
 Copyright © 2005, By Baxter & Woodman, Inc.
 State of Illinois - Professional Design Firm
 License No. - 184-001121 - Expires 4-30-07

Tue Nov 20 16:09:07 2001
 \\dca01d\projects\dstated\to16.dgn LV:35
 V:\1616
 ah\to16.prk: 15:50:45 11/20/2001