

F.A. RTE.	SECTION	COUNTY	TOTAL SHEETS	SHEET NO.
	05-00192-00-SW	COOK	11	7
MOUNT PROSPECT ROAD				
STA. 36+25			TO STA. 47+00	

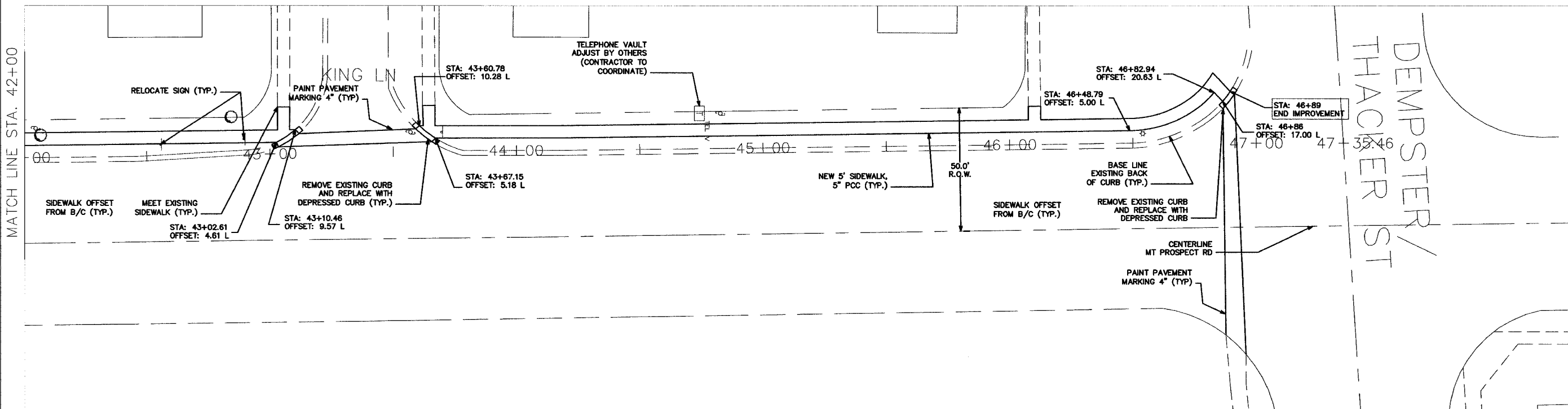
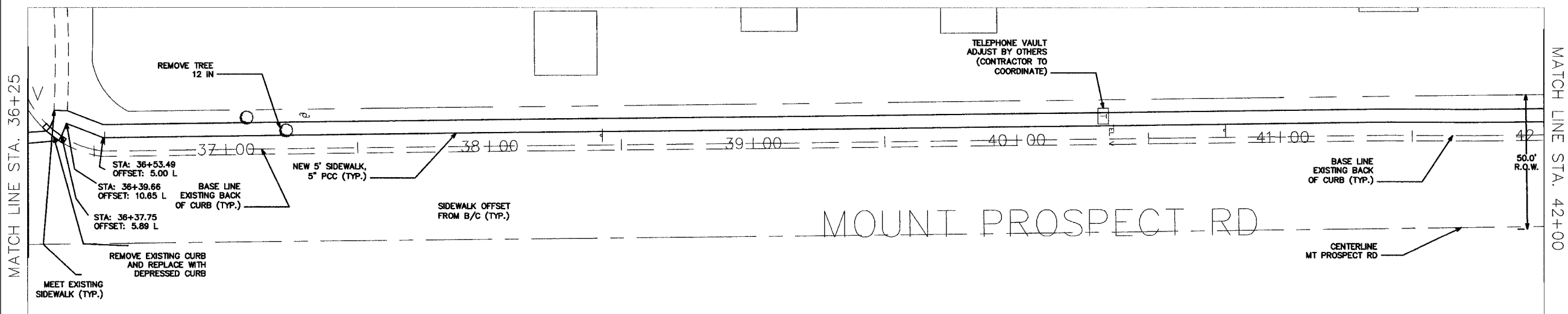
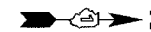

DETECTABLE WARNINGS ARE TO BE INSTALLED AT ALL INTERSECTIONS

REVISIONS	
NAME	DATE

ILLINOIS DEPARTMENT OF TRANSPORTATION

PLAN

MOUNT PROSPECT ROAD
DOVER DRIVE TO
DEMPSTER/THACKER STREET

SCALE: 20 SCALE
DATE: 5-31-05

DRAWN BY: BLS
CHECKED BY: AJD