

RTE. NO.	SECTION	COUNTY	TOTAL SHEETS	SHEET NO.
FAU 3512 FAP 364	02-00077-00-SW	COOK	8	1
FEDERAL RD. DIST. NO.		ILLINOIS	FEDERAL AID PROJECT	

CONTRACT NO.: 83812

STATE OF ILLINOIS
DEPARTMENT OF TRANSPORTATION
DIVISION OF HIGHWAYS

PLANS FOR PROPOSED FEDERAL AID HIGHWAY

FAU 3512 NORTHWEST HIGHWAY AND FAP 364 EUCLID AVENUE
SIDEWALK AND BIKE PATH IMPROVEMENTS

PROJECT NO.: ~~CMF-000S(469)~~
SECTION NO.: 02-00077-00-SW
VILLAGE OF PALATINE
COOK COUNTY
JOB NO.: C-91-108-03

INDEX OF SHEETS

- COVER SHEET
- LEGEND, GENERAL NOTES, TYPICAL SECTIONS & SUMMARY OF QUANTITIES
- NORTHWEST HIGHWAY SIDEWALK IMPROVEMENTS
- NORTHWEST HIGHWAY SIDEWALK IMPROVEMENTS
- NORTHWEST HIGHWAY SIDEWALK IMPROVEMENTS
- EUCLID AVENUE (HARPER COLLEGE) BIKE PATH
- EUCLID AVENUE (HARPER COLLEGE) BIKE PATH
- DETAILS

STATE STANDARDS

- 000001-04 STANDARD SYMBOL, ABBREVIATIONS AND PATTERNS
- 424001-04 CURB RAMPS FOR SIDEWALKS
- 606001-02 CONCRETE CURB AND COMBINATION CONCRETE CURB AND GUTTER
- 701801-03 LANE CLOSURE, MULTILANE, 1W OR 2W CROSSWALK OR SIDEWALK CLOSURE
- 702001-05 TRAFFIC CONTROL DEVICES

CONTACT

VILLAGE OF PALATINE
ENGINEERING DIVISION
CONTACT: MATT BERRY
OFFICE: 847-359-9044
FAX: 847-776-4733
24 HR:

BURNS & MCDONNELL
CONTACT: ANTHONY BRYANT
OFFICE: 630-724-3283
FAX: 630-724-2301

DESIGN DESIGNATION

NORTHWEST HIGHWAY SIDEWALK
EUCLID AVENUE SHARED-USE PATH

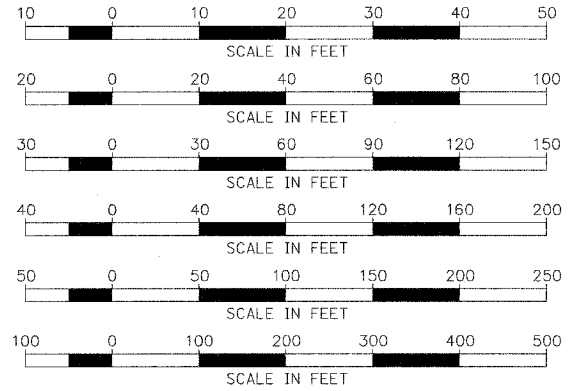

FULL SIZE PLANS HAVE BEEN PREPARED USING STANDARD ENGINEERING SCALES, REDUCED SIZED PLANS WILL NOT CONFORM TO STANDARD SCALES, IN MAKING MEASUREMENT ON REDUCED PLANS, THE ABOVE SCALES MAY BE USED.

CONTRACT NO.: 83812

WARNING

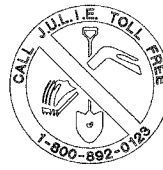

CALL
J.U.L.I.E.
BEFORE YOU DIG
1-800-892-0123

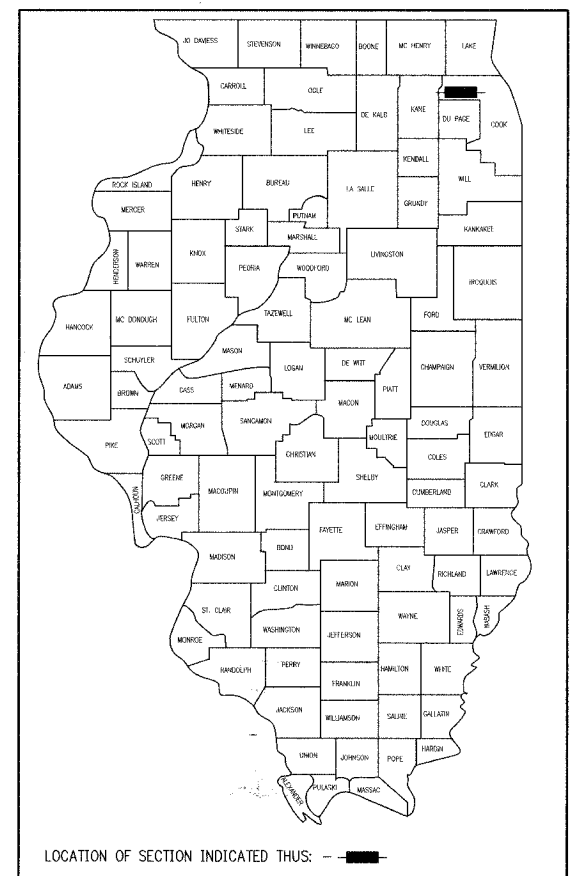

LOCATION OF SECTION INDICATED THUS: —

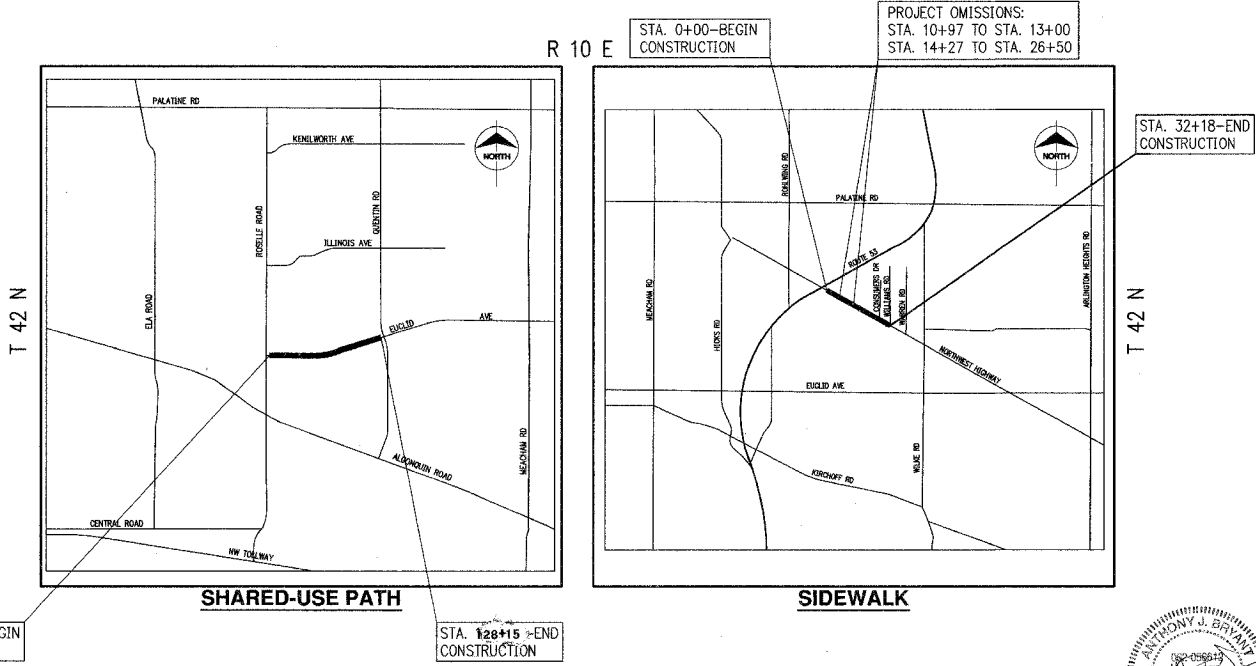

LOCATION MAPS
(N.T.S.)

LENGTH OF PROJECT

GROSS LENGTH NORTHWEST HIGHWAY = 3218 FEET (0.61 MILES)
NET LENGTH NORTHWEST HIGHWAY = 1,491 FEET (0.28 MILES)
GROSS LENGTH EUCLID AVENUE = 2583 FEET (0.49 MILES)
NET LENGTH EUCLID AVENUE = 2583 FEET (0.49 MILES)



ANTHONY J. BRYANT, P.E.
NO. 062-056612
EXP. DATE: 11/30/2005
Date: 7/21/2005

STATE OF ILLINOIS
DEPARTMENT OF TRANSPORTATION
DIVISION OF HIGHWAYS

APPROVED July 21, 2005
[Signature]
VILLAGE ENGINEER

APPROVED July 21, 2005
[Signature]
ENGINEER OF LOCAL ROADS AND STREETS

APPROVED July 21, 2005
[Signature]
DEPUTEE DIRECTOR OF HIGHWAYS, REGION ENGINEER

**PRINTED BY THE AUTHORITY
OF THE STATE OF ILLINOIS**

FEDERAL AID PROGRAM ENGINEER: CHARLES RIDDLE, P.E. 847-705-4406
CONSULTANTS: BURNS & MCDONNELL ENGINEERING, CO. 630-990-0300



IL DESIGN FIRM NO.
184-001310

LEGEND

- EXISTING R.O.W.
- x- PROPOSED FENCE
- - - EXISTING FENCE
- TREE LINE
- ⊙ LIGHT POLE
- ⊙ ELECTRICAL TRANSFORMER
- ⊙ ELECTRICAL TRANSFORMER W/CONC. PAD
- ⊙ TRAFFIC SIGNAL
- ⊙ POWER POLE
- ⊙ GUY WIRE
- ⊙ TELEPHONE PEDESTAL
- ⊙ HAND HOLE
- EXISTING CONTOUR
- PROPOSED CONTOUR
- ⊙ FIRE HYDRANT
- ⊙ LANDSCAPE STONE
- ⊙ STORM SEWER INLET
- ⊙ TREE STUMP
- ⊙ TREE OR SHRUB
- ⊙ PROPERTY PIPE (FOUND)
- ⊙ SIGN
- ⊙ CONTROL POINT (PK-NAIL)
- ⊙ BENCHMARK
- ▨ COMBINATION CONCRETE CURB & GUTTER REMOVAL/CURB REMOVAL
- EXISTING GROUND LINE

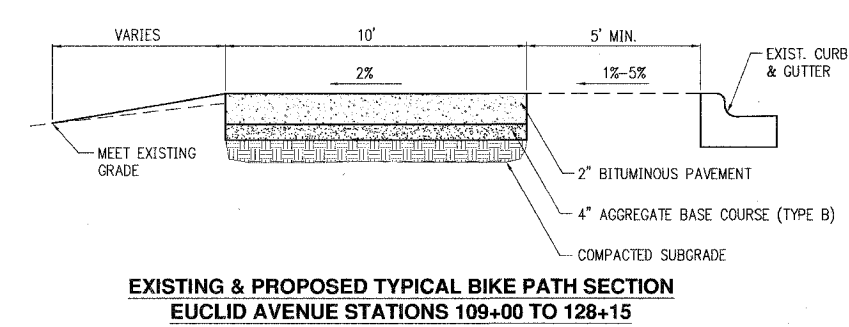
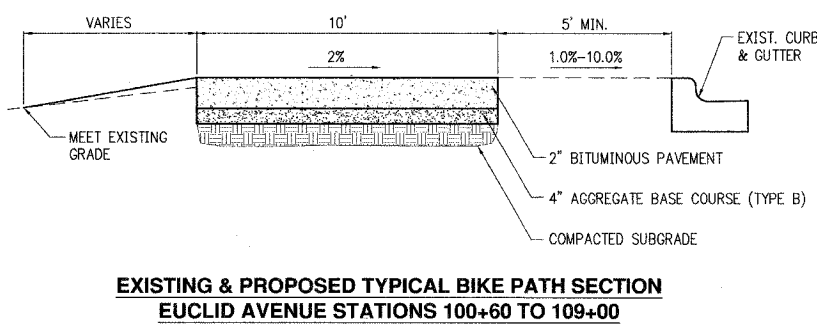
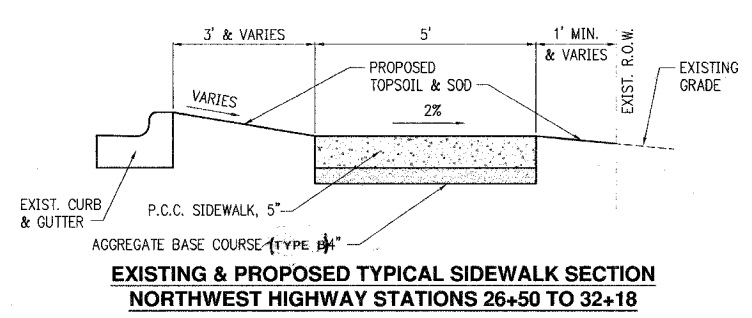
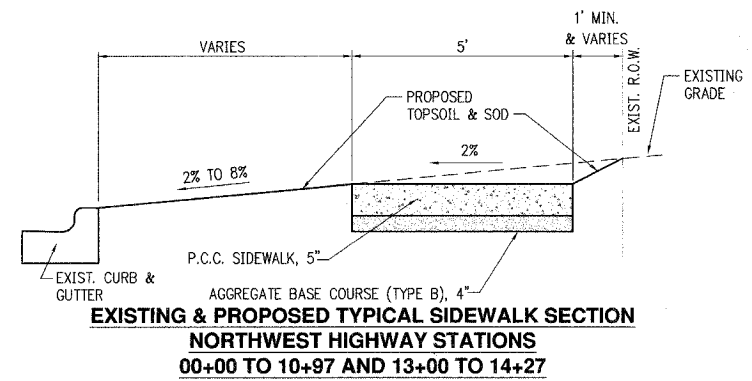

SUMMARY OF QUANTITIES

CODE NO.	ITEM	UNIT	SFTY-1B TOTAL
20076600	TRAINEES	HOUR	500
20101200	TREE ROOT PRUNING	EACH	20
20101300	TREE PRUNING (1-10 INCH DIA.)	EACH	20
20200100	EARTH EXCAVATION	CU YD	118
20201200	REMOVAL AND DISPOSAL OF UNSUITABLE MATERIAL	CU YD	414
21101615	TOPSOIL FURNISH AND PLACE, 4"	SQ YD	1822
25000400	NITROGEN FERTILIZER NUTRIENT	POUND	30
25000500	PHOSPHOROUS FERTILIZER NUTRIENT	POUND	30
25000600	POTASSIUM FERTILIZER NUTRIENT	POUND	30
25200110	SODDING, SALT TOLERANT	SQ YD	1822
25200200	SUPPLEMENTAL WATERING	UNIT	5
35101600	AGGREGATE BASE COURSE, TYPE B 4"	SQ YD	3700
42001300	PROTECTIVE COAT	SQ YD	1330
42400200	PORTLAND CEMENT CONCRETE SIDEWALK 5 INCH	SQ FT	7456
42400800	DETECTABLE WARNINGS	SQ FT	422
44000600	SIDEWALK REMOVAL	SQ FT	400
60255500	MANHOLE TO BE ADJUSTED	EACH	7
60265700	VALVE VAULTS TO BE ADJUSTED	EACH	3
67100100	MOBILIZATION	L SUM	1
70102640	TRAFFIC CONTROL AND PROTECTION, STANDARD 701801	L SUM	1
72000100	SIGN PANEL TYPE 1 *	SQ FOOT	39
78000200	THERMOPLASTIC PAVEMENT MARKING - LINE 4" YELLOW *	FOOT	600
78000400	THERMOPLASTIC PAVEMENT MARKING - LINE 6" WHITE *	FOOT	774
78000650	THERMOPLASTIC PAVEMENT MARKING - LINE 24" WHITE *	FOOT	20
XX000882	WOOD FENCE *	FOOT	815
XX006394	BIKE PATH BOLLARDS *	FOOT	18
X4066414	BITUMINOUS CONCRETE SURFACE COURSE SUPERPAVE, MIX C, N50	TON	322
XX000613	MODULAR BLOCK RETAINING WALL *	SQ FT	1396

* SPECIALITY ITEM
Δ = Y080

EARTHWORK SCHEDULE

LOCATION BIKE PATH	EARTH EXCAVATION (CU. YD.)	REMOVAL & DISPOSAL OF UNSUITABLE MATERIAL (CU. YD.)	TOPSOIL FURNISH AND PLACE, 4" (SQ. YD.)	SODDING, SALT TOLERANT (SQ. YD.)
STA. 100+60 TO STA. 128+15		320	1150	1150
STA. 106+80 TO STA. 107+90	18			
STA. 110+00 TO STA. 113+15	60			
STA. 121+25 TO STA. 123+50	40			
LOCATION SIDEWALK				
STA. 0+00 TO STA. 32+18		94	672	672

4" TOPSOIL REMOVAL ASSUMED

GENERAL NOTES

- THE CONTRACTOR SHALL NOTIFY J.U.L.I.E. (800-892-0123) AT LEAST 48 HOURS PRIOR TO CONSTRUCTION FOR LOCATIONS OF UTILITIES, AND SHALL BE RESPONSIBLE FOR THE PROTECTION OF THE SAME.
- THE CONTRACTOR SHALL NOTIFY BURNS & McDONNELL (THE ENGINEER) AT LEAST 48 HOURS IN ADVANCE OF CONSTRUCTION. NO UNDERGROUND WORK SHALL BE COVERED UNTIL IT HAS BEEN INSPECTED. APPROVAL TO PROCEED MUST BE OBTAINED FROM THE ENGINEER PRIOR TO INSTALLING ANY ROADWAY BASE, BINDER, AND SURFACE, AND PRIOR TO POURING ANY CONCRETE AFTER FORMS HAVE BEEN SET.
- CONTRACTORS ARE CAUTIONED AGAINST INSTITUTING ANY CHANGES AND/OR SUBSTITUTIONS TO THE PROJECT REPRESENTED BY THESE DRAWINGS WITHOUT PRIOR WRITTEN APPROVAL BY THE ENGINEER. VISUAL CONTACT WITH THESE DRAWINGS SHALL CONSTITUTE CONCLUSIVE EVIDENCE OF ACCEPTANCE OF THESE RESTRICTIONS.
- WRITTEN DIMENSIONS ON THESE DRAWINGS SHALL TAKE PRECEDENCE OVER SCALED DIMENSIONS. CONTRACTORS SHALL VERIFY AND BE RESPONSIBLE FOR ALL ELEVATIONS, DIMENSIONS, AND CONDITIONS ON THE JOB. THE ENGINEER SHALL BE NOTIFIED AS SOON AS POSSIBLE OF ANY VARIATIONS FROM THE DIMENSIONS AND CONDITIONS SHOWN ON THESE DRAWINGS.
- ALL WORK FOR WHICH THERE IS NO SPECIFIC PAY ITEM SHALL BE REIMBURSED PER ARTICLE 109.04.
- THE CONTRACTOR SHALL BE RESPONSIBLE FOR THE PROTECTION OF ALL PUBLIC AND PRIVATE UTILITIES, EVEN THOUGH THEY MAY NOT BE SHOWN ON THE DRAWINGS. ANY UTILITY DAMAGES DURING CONSTRUCTION SHALL BE REPAIRED OR REPLACED TO THE SATISFACTION OF THE OWNER AT THE CONTRACTOR'S EXPENSE.
- THE CONTRACTOR SHALL BE RESPONSIBLE FOR REMOVING IMMEDIATELY ANY MUD, DIRT, OR DEBRIS DEPOSITED ON ROADWAYS FROM ANY VEHICLES EXITING OR ENTERING THE SITE.
- THE CONTRACTOR IS ESPECIALLY ALERTED TO THE FACT THAT IT IS HIS RESPONSIBILITY TO GUARD AND PROTECT NEWLY POURED CONCRETE AGAINST ANY FOREIGN MARKINGS, GRAFFITI OR OTHER DAMAGE, AND AT HIS EXPENSE, REPLACE ANY SIDEWALK NOT ACCEPTABLE TO THE ENGINEER.
- ALL LANE CLOSURES WITHIN OR ALONG NORTHWEST HIGHWAY SHALL BE RESTRICTED TO THE HOURS OF 9:00 A.M. TO 3:00 P.M. ALL FOUR LANES SHALL BE KEPT OPEN FOR THE REMAINING PART OF EVERY DAY.
- BEFORE ACCEPTANCE BY THE VILLAGE, ALL WORK SHALL BE INSPECTED AND APPROVED BY THE ENGINEER AND THE ILLINOIS DEPARTMENT OF TRANSPORTATION. FINAL PAYMENT WILL BE MADE ONLY AFTER ALL OF THE CONTRACTOR'S WORK HAS BEEN APPROVED AND ACCEPTED.
- THE CONTRACTOR SHALL COORDINATE CONSTRUCTION ACTIVITIES WITH UTILITY COMPANIES AND THE VILLAGE OF PALATINE.
- ALL SHRUB REMOVAL LESS THAN 6 INCHES IN DIAMETER SHALL BE INCLUDED IN EARTH EXCAVATION.
- NO PLANT MATERIAL IS TO BE INSTALLED ON SITE WITHOUT APPROPRIATE IDOT ORANGE SEAL.
- THE ENGINEER IS TO VERIFY IN FIELD ALL PLANTING LAYOUTS PRIOR TO INSTALLATION.
- APPROVED WATERING EQUIPMENT SHALL BE AT THE SITE OF THE WORK AND IN OPERATING CONDITION PRIOR TO STARTING THE PLANTING OPERATION AND DURING ALL PLANTING OPERATIONS OR PLANTING WILL NOT BE ALLOWED.
- CONTRACTOR SHALL INSTALL TOPSOIL, COARSE SAND AND MULCH AROUND ALL NEW TREES. NO AGGREGATE AND GEOTECHNICAL FABRIC SHALL BE USED IN THE PLANTING HOLE.

MIX SCHEDULE

CODE NO.	AC TYPE	VOIDS	RAP%
BITUMINOUS CONCRETE SURFACE COURSE, SUPERPAVE, MIX C, N50	PG 64-22	4% @ 50GYR	15

THE UNIT WEIGHT USED TO CALCULATE ALL BITUMINOUS SURFACE MIXTURES IS: 112LBS/SQ YD/TN

RTE. NO.	SECTION	COUNTY	TOTAL SHEETS	SHEET NO.
FAU 3512 FAP 364	02-00077-00-SW	COOK	8	2
FEDERAL RD. DIST. NO.	ILLINOIS	FEDERAL AID PROJECT		

CONTRACT NO.: 83812

no.	date	by	ckd	description
Δ	07/20/05	AJB	AJB	INCORPORATE IDOT COMMENTS



date 06-28-05 detailed J. HOLZINGER
designed A. BRYANT checked J. STEENKEN



VILLAGE of PALATINE
SIDEWALK AND BIKE PATH IMPROVEMENTS
LEGEND, GENERAL NOTES, TYPICAL SECTIONS
EARTHWORK SUMMARY & SUMMARY OF QUANTITIES
project 33973 contract
drawing rev. 0
sheet 2 of 8 sheets
file I:\PALATINE\33973\CAD\BID\LGND_NOTES

COPYRIGHT © 2004 BURNS AND McDONNELL ENGINEERING COMPANY, INC.

1 2 3 4 5 6 7 8 9 10 11 12 13 14

RT. NO.	SECTION	COUNTY	TOTAL SHEETS	SHEET NO.
FAU 3512 FAP 364	02-00077-00-SW	COOK	8	3
FEDERAL RD. DIST. NO.	ILLINOIS FEDERAL AID PROJECT			
CONTRACT NO.: 83812				

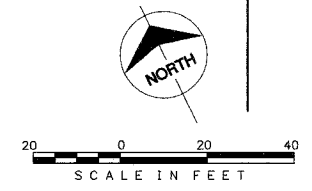
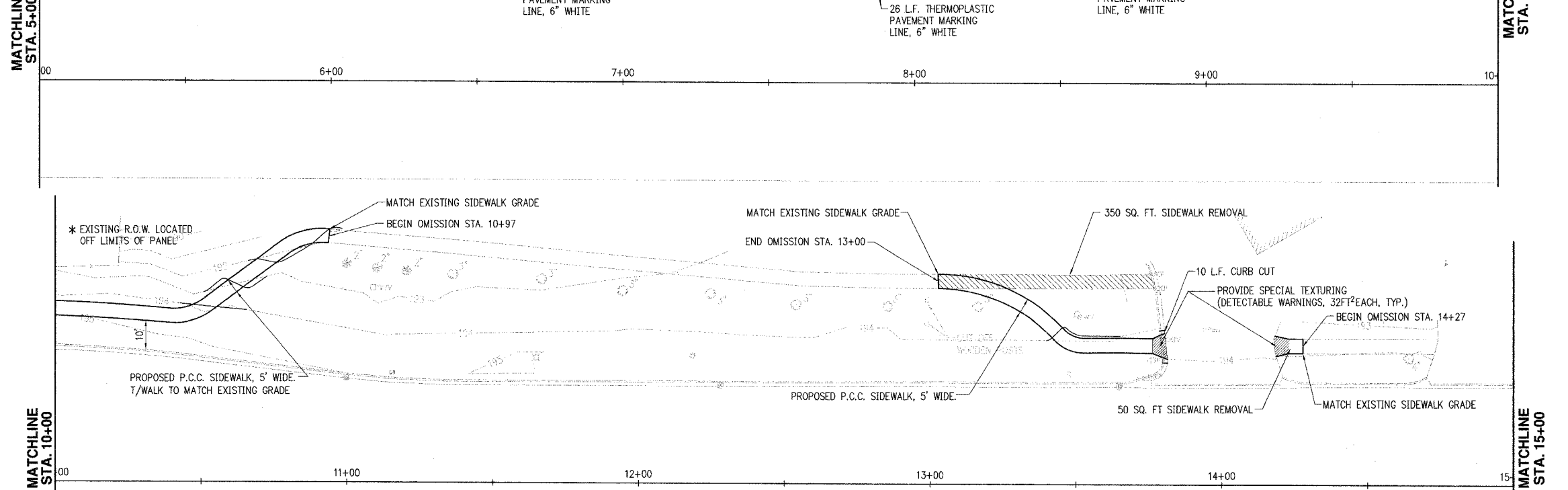
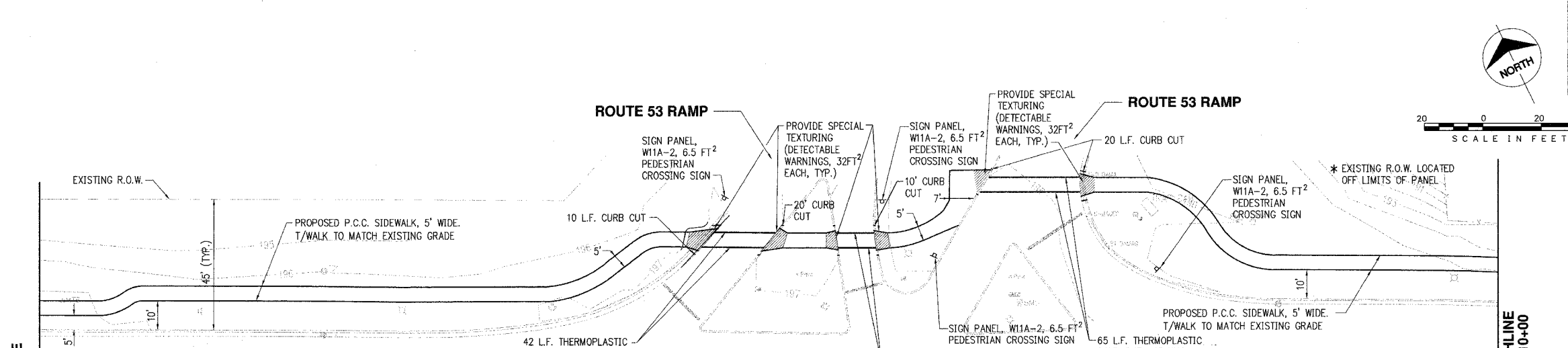
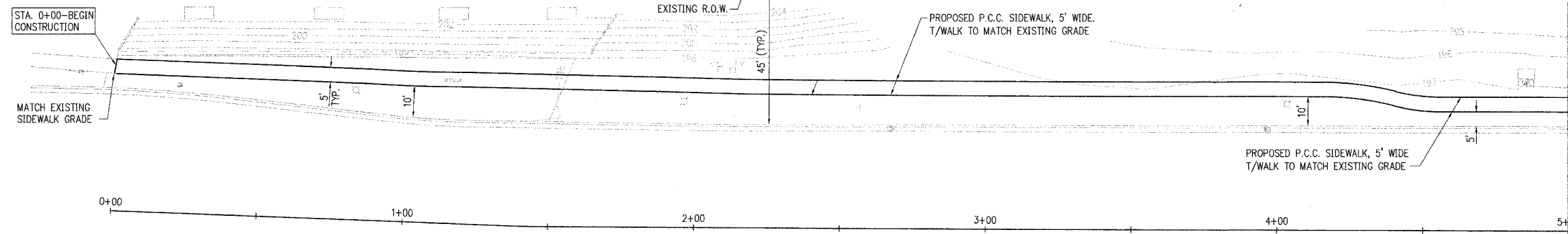

Scale For Microfilming
Millimeters
Inches

COPYRIGHT © 2003 BURNS AND McDONNELL ENGINEERING COMPANY, INC.

no.	date	by	ckd	description
△	07/20/06	AJB	AJB	INCORPORATE IDOT COMMENTS



date	06-28-05	detailed	L. SAUCEDO
designed	A. BRYANT	checked	J. STEENKEN



VILLAGE of PALATINE	
NORTHWEST HIGHWAY SIDEWALK IMPROVEMENTS	
project	contract
33973	
drawing	rev.
	1
sheet	3 of 8 sheets
file	I:\PALATINE\33973...CAD\BID\PLAN1

1 2 3 4 5 6 7 8 9 10 11 12 13 14

RTE. NO.	SECTION	COUNTY	TOTAL SHEETS	SHEET NO.
FAU 3512 FAP 364	02-00077-00-SW	COOK	8	4
FEDERAL RD. DIST. NO.		ILLINOIS FEDERAL AID PROJECT		

CONTRACT NO.: 83812

MATCHLINE
STA. 15+00

MATCHLINE
STA. 20+00

MATCHLINE
STA. 20+00

MATCHLINE
STA. 25+00

MATCHLINE
STA. 25+00

MATCHLINE
STA. 30+00

POST OFFICE
ENTRANCE

NORTHWEST
HIGHWAY

POST OFFICE
ENTRANCE

NORTHWEST
HIGHWAY

CONSUMERS
DRIVE

NORTHWEST
HIGHWAY

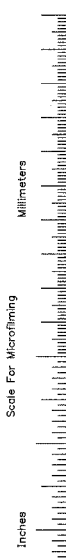

no.	date	by	ckd	description
1	07/20/05	AJB	AJB	INCORPORATE IDOT COMMENTS



date	06-28-05	detailed	L. SAUCEDO
designed	A. BRYANT	checked	J. STEENKEN



VILLAGE of PALATINE
NORTHWEST HIGHWAY SIDEWALK IMPROVEMENTS

project	33973	contract	
drawing		rev.	1

sheet 4 of 8 sheets
file I:\PALATINE\33973...CAD\BID\PLAN2

COPYRIGHT © 2003 BURNS AND McDONNELL ENGINEERING COMPANY, INC.

RTE. NO.	SECTION	COUNTY	TOTAL SHEETS	SHEET NO.
FAU 3512 FAP 364	02-00077-00-SW	COOK	8	5
FEDERAL RD. DIST. NO.		ILLINOIS	FEDERAL AID PROJECT	

CONTRACT NO.: 83812

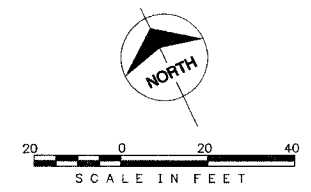
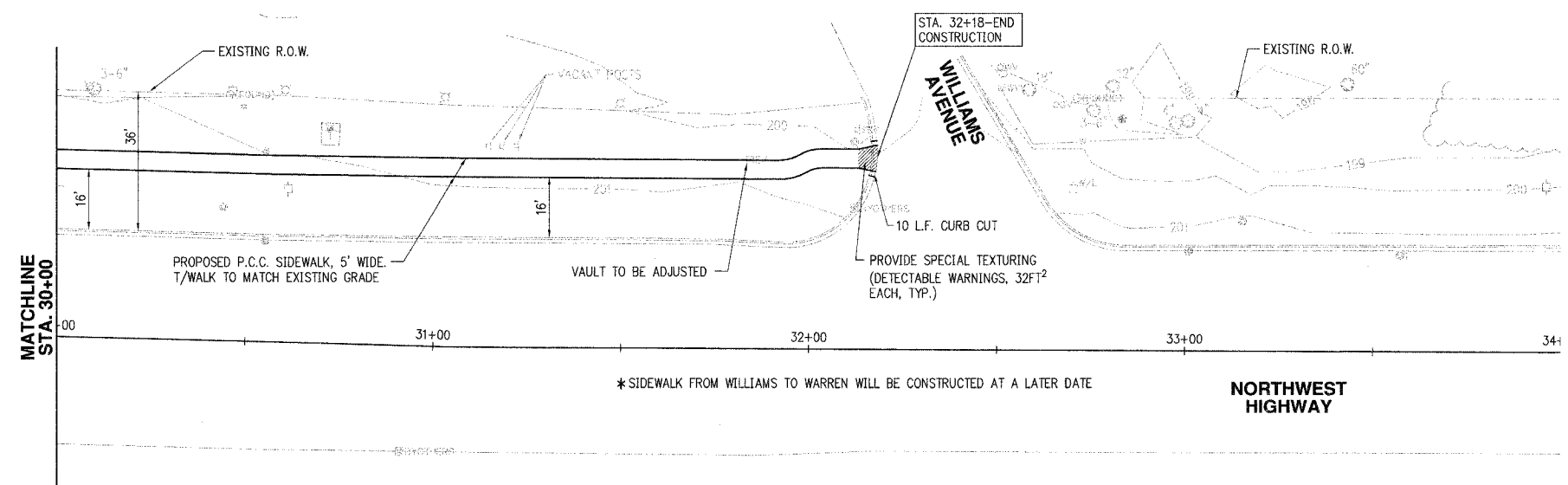

Scale For Microfilming
Millimeters
Inches

COPYRIGHT © 2003 BURNS AND MCDONNELL ENGINEERING COMPANY, INC.

no.	date	by	ckd	description
△	07/20/05	AJB	AJB	INCORPORATE IDOT COMMENTS



date	06-28-05	detailed	L. SAUCEDO
designed	A. BRYANT	checked	J. STEENKEN



VILLAGE of PALATINE
NORTHWEST HIGHWAY SIDEWALK IMPROVEMENTS

project	33973	contract	
drawing		rev.	1
sheet	5	of	8 sheets
file	I:\PALATINE\33973...\CAD\BID\PLAN3		

RTE. NO.	SECTION	COUNTY	TOTAL SHEETS	SHEET NO.
FAU 3512 FAP 364	02-00077-00-SW	COOK	8	6
FEDERAL RD. DIST. NO.		ILLINOIS FEDERAL AID PROJECT		

CONTRACT NO.: 83812

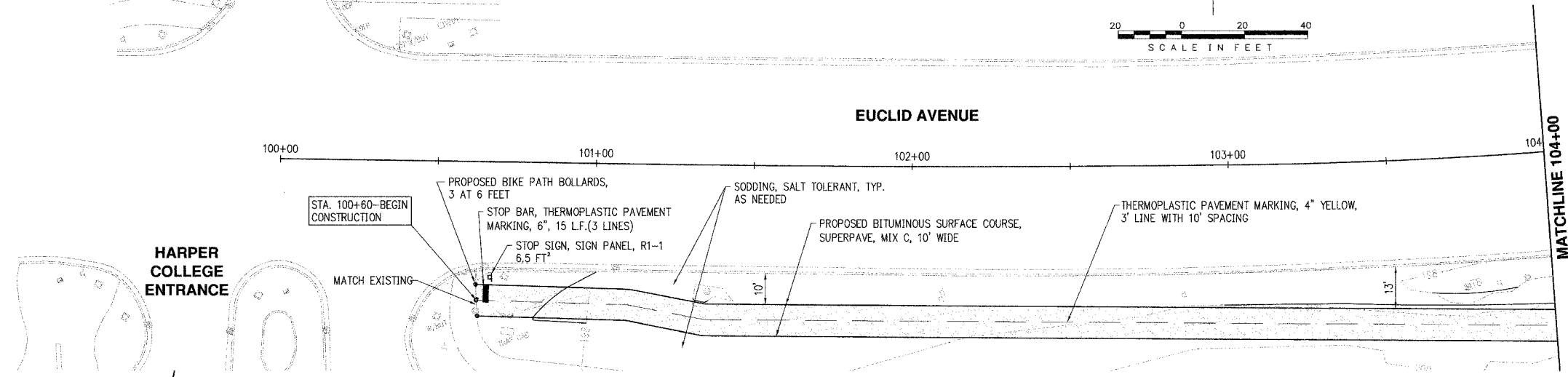

HARPER COLLEGE ENTRANCE

MATCHLINE 104+00

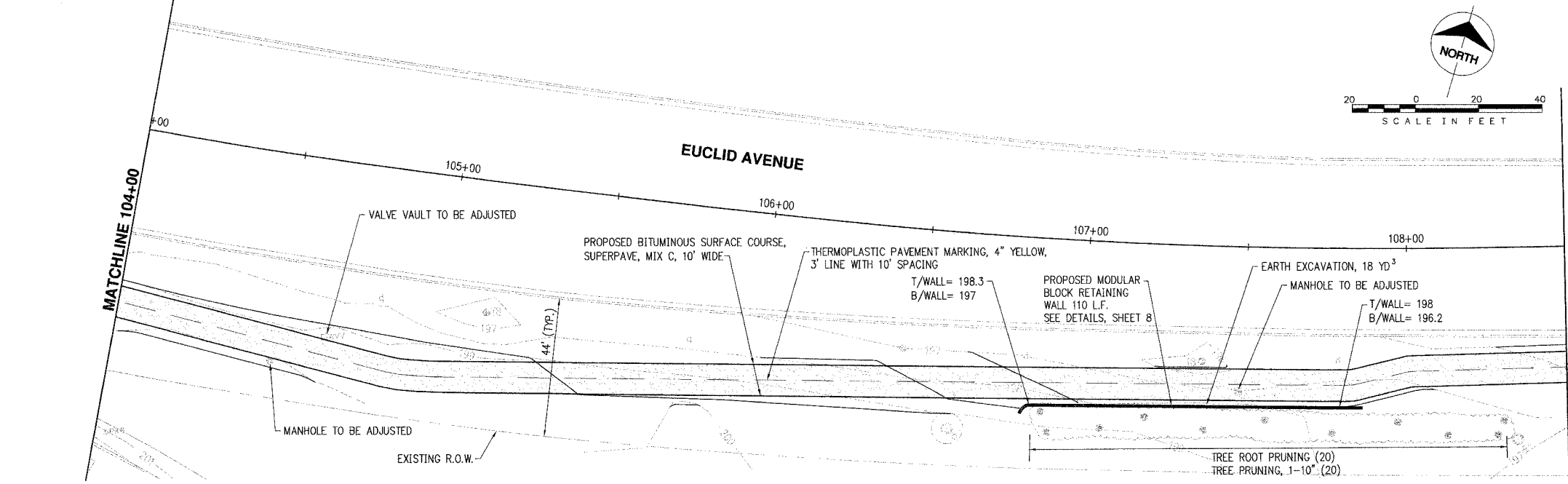

MATCHLINE 104+00

MATCHLINE 108+50

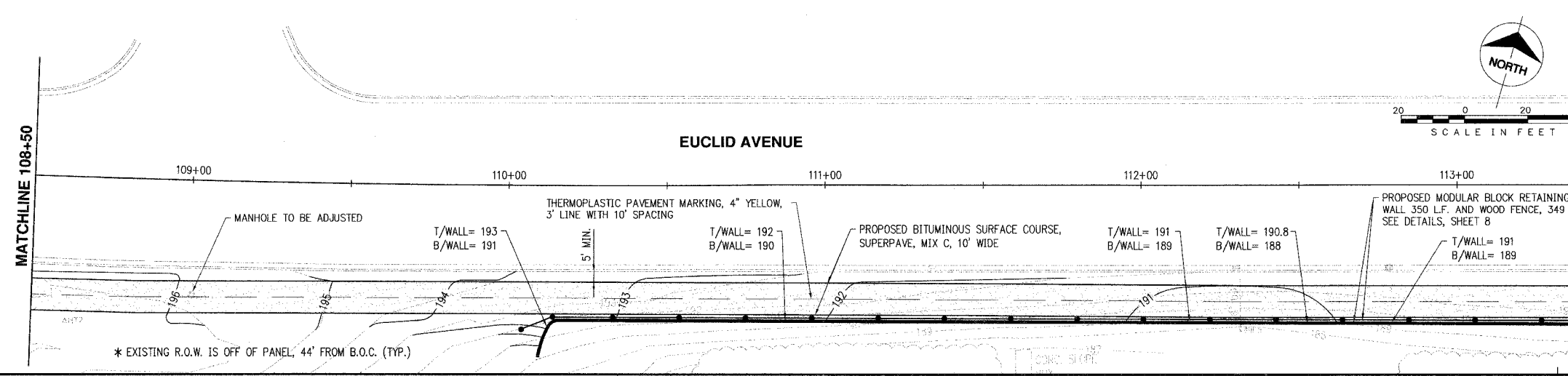

MATCHLINE 108+50

MATCHLINE 113+50

Scale For Microfilming

Inches

COPYRIGHT © 2003 BURNS AND MCDONNELL ENGINEERING COMPANY, INC.

A
B
C
D
E
F
G
H
I

no.	date	by	ckd	description
1	07/20/05	AJB	AJB	INCORPORATE IDOT COMMENTS



date	06-28-05	detailed	J. HOLZINGER
designed	A. BRYANT	checked	J. STEENKEN



EUCLID AVENUE (HARPER COLLEGE) BIKE PATH

project	33973	contract	
drawing		rev.	1
sheet	6	of	8 sheets
file I:\PALATINE\33973...CAD\BID\PLAN 1SOUTH			

1 2 3 4 5 6 7 8 9 10 11 12 13 14

RTE. NO.	SECTION	COUNTY	TOTAL SHEETS	SHEET NO.
FAU 3512 FAP 364	02-00077-00-SW	COOK	8	7
FEDERAL RD. DIST. NO.	ILLINOIS FEDERAL AID PROJECT			

CONTRACT NO.: 83812

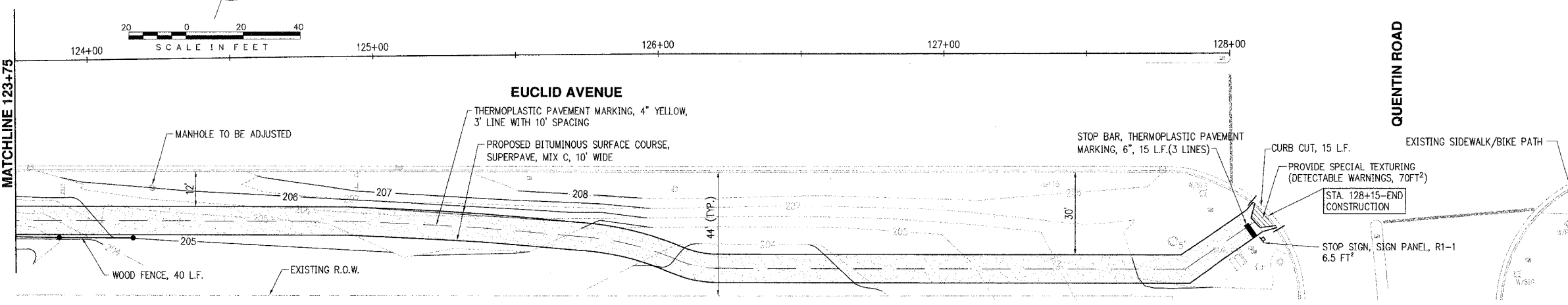
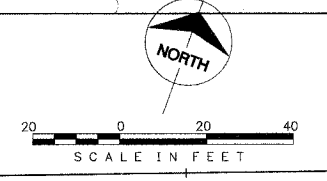
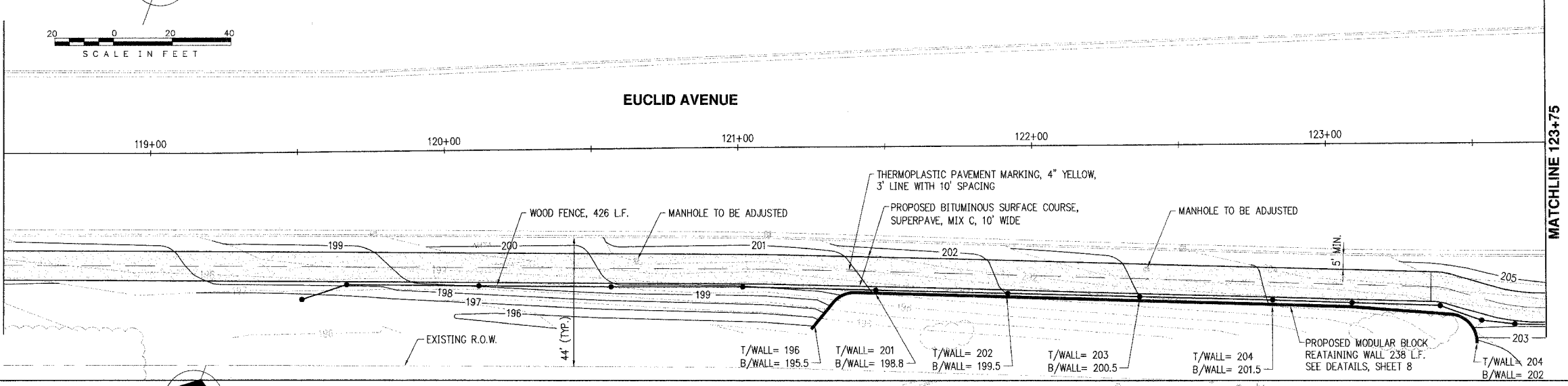
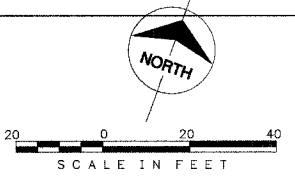
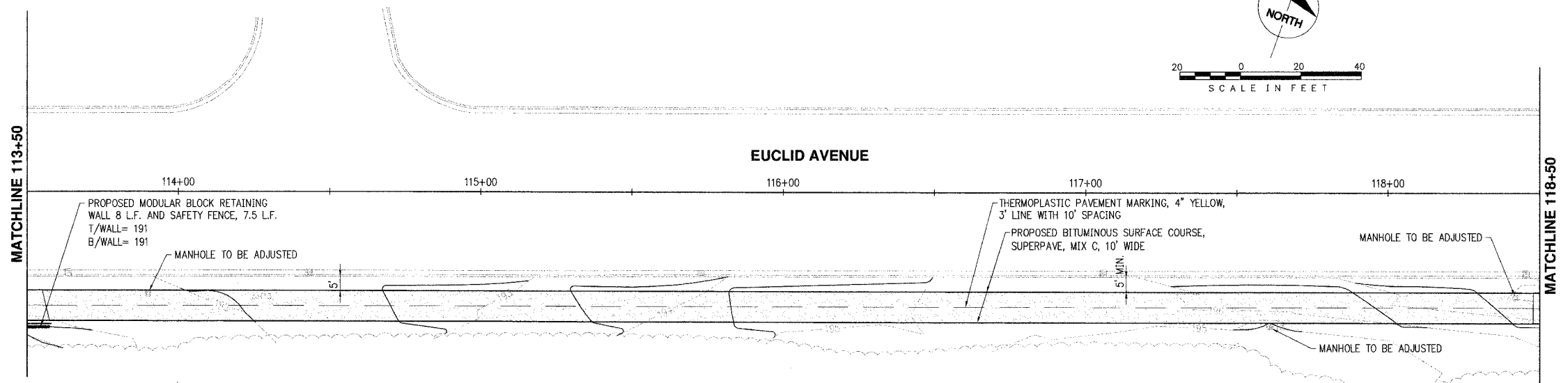
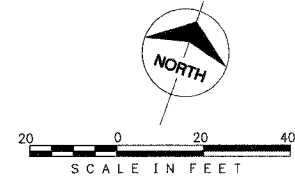

no.	date	by	ckd	description
1	07/20/05	AJB	AJB	INCORPORATE IDOT COMMENTS



date	06-28-05	detailed	J. HOLZINGER
designed	A. BRYANT	checked	J. STEENKEN



VILLAGE of PALATINE
EUCLID AVENUE (HARPER COLLEGE) BIKE PATH

project	33973	contract	
drawing		rev.	1
sheet	7	of	8 sheets
file I:\PALATINE\33973...CAD\BID\PLAN 250UTH			

Scale For Microfilming
Millimeters
Inches
COPYRIGHT © 2003 BURNS AND MCDONNELL ENGINEERING COMPANY, INC.

RTE. NO.	SECTION	COUNTY	TOTAL SHEETS	SHEET NO.
FAU 3512 FAP 364	02-00077-00-SW	COOK	8	8
FEDERAL RD. DIST. NO.	ILLINOIS		FEDERAL AID PROJECT	

CONTRACT NO.: 83812

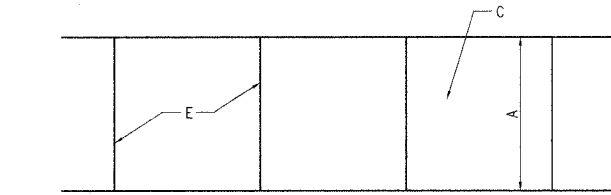

PLAN

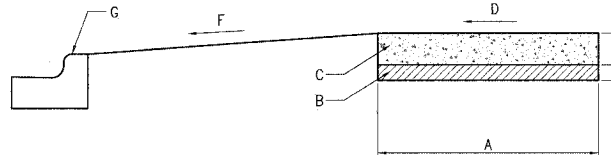

PROFILE

SIDEWALK DETAIL
NOT TO SCALE

CONSTRUCTION NOTES

- A. 5' NORMAL WIDTH
- B. CRUSHED STONE OR GRAVEL BASE
- C. P.C.C. SIDEWALK
- D. SLOPE 1/4" PER FOOT TO STREET SIDE
- E. JOINTS, SEE NOTES 3 AND 4
- F. SLOPE 2% TO 8% TOWARDS STREET
- G. CURB AND GUTTER
- H. CONCRETE THICKNESS, SEE NOTE 1

GENERAL NOTES

- 1. STANDARD THICKNESS OF CONCRETE SHALL BE A MINIMUM OF 5".
- 2. WHERE WOODEN FORMS ARE USED, 2x4'S ARE NOT ALLOWED. ONLY 2x6'S SHALL BE USED.
- 3. PREFORMED 3/8" EXPANSION JOINTS SHALL BE CONSTRUCTED AT MAX. SPACING OF 40'.
- 4. FORMED OR SAW-CUT CONTRACTION JOINTS SHALL BE SPACED GENERALLY 5' APART, BUT NO LESS THAN 4' AND NO MORE THAN 6'.
- 5. 1/2" EXPANSION JOINTS SHALL BE INSTALLED WHERE SIDEWALK ABUTS BUILDINGS, TRAFFIC SIGNAL FOUNDATIONS, SERVICE POLES, AND OTHER IMMOVABLE STRUCTURES.

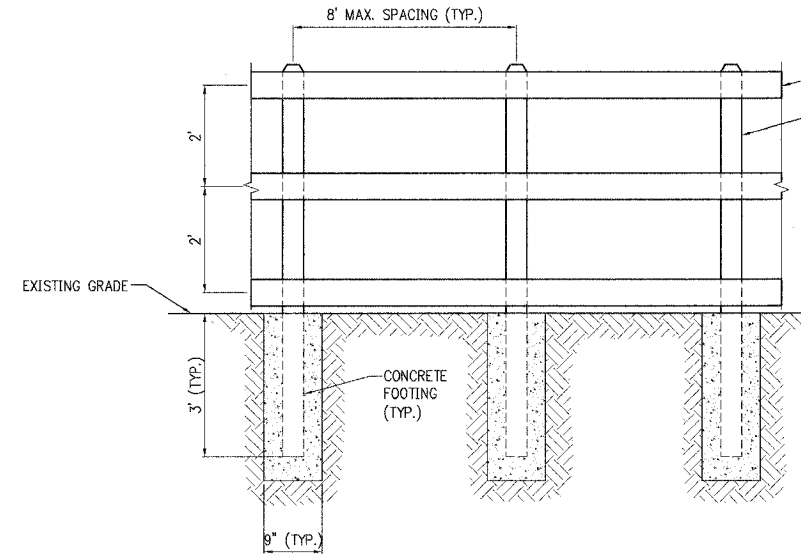

WOOD FENCE DETAIL

(OR AS SPECIFIED BY THE VILLAGE OF PALATINE)
NOT TO SCALE

- 1. ALL MATERIAL SHALL BE SOUTHERN YELLOW PINE IMPREGNATED WITH THE PRESERVATIVE, COPPER NAPHTHENATE (COPPERWOOD OR APPROVED EQUAL).
- 2. FENCE SHALL BE ASSEMBLED BY FACE NAILING.
- 3. CLASS S1 CONCRETE SHALL BE USED CONFORMING TO THE APPLICABLE PORTIONS OF SECTION 1020, EXCEPT THAT IF THE CONCRETE IS MIXED IN TRANSIT MIXERS OR TRANSPORTED IN AGITATOR TRUCKS, THE TIME LIMIT FOR UNLOADING IT MAY BE EXTENDED TO 120 MINUTES BY THE ENGINEER.

Scale For Microfilming

Inches

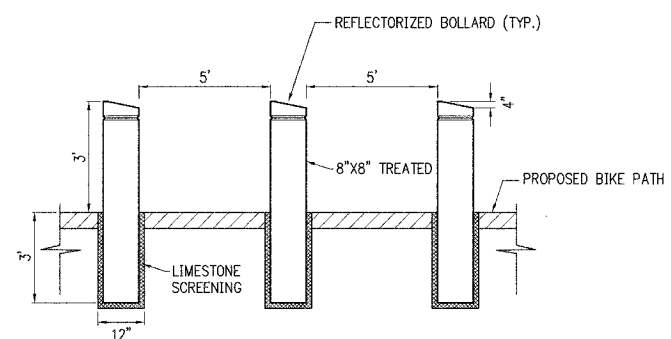

BIKE PATH BOLLARD DETAIL
NOT TO SCALE

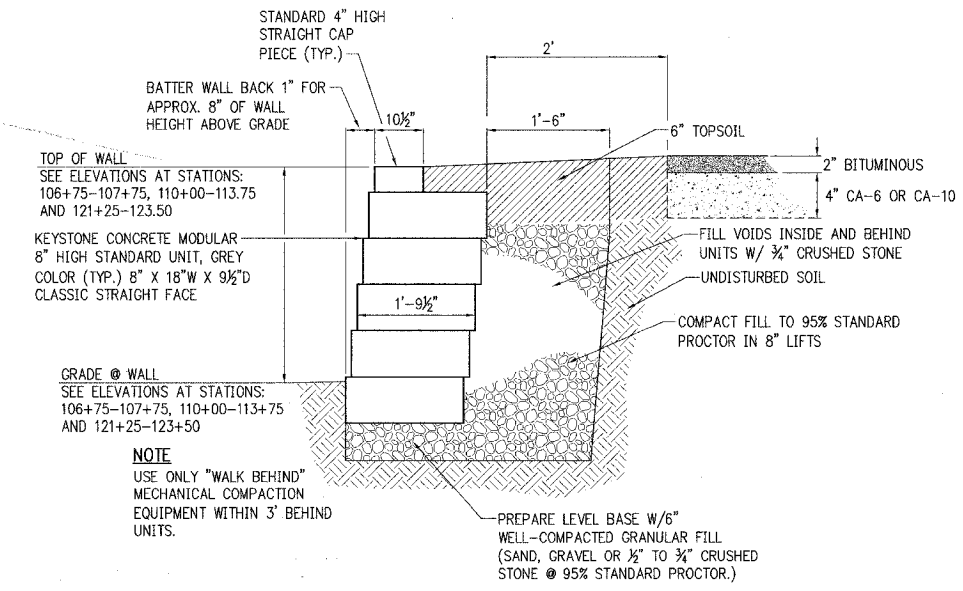

MODULAR BLOCK RETAINING WALL
TYPICAL SECTION

NOT TO SCALE

no.	date	by	ckd	description
1	07/20/05	AJB	AJB	INCORPORATE IDOT COMMENTS



date	06-28-05	detailed	J. HOLZINGER
designed	A. BRYANT	checked	J. STEENKEN



VILLAGE of PALATINE
SIDEWALK AND BIKE PATH IMPROVEMENTS
DETAILS

project	33973	contract	
drawing		rev.	1
sheet	8	of	8 sheets
file	I:\PALATINE\33973...CAD\BID\DETAILS		