

ROUTE NO.	SECTION	COUNTY	TOTAL SHEETS	SHEET NO.
T.R. 205	03-01123-00-BR	SHELBY	13	4
ROAD DIST.	ILLINOIS	ASH GROVE		
CONTRACT NO. 91335				

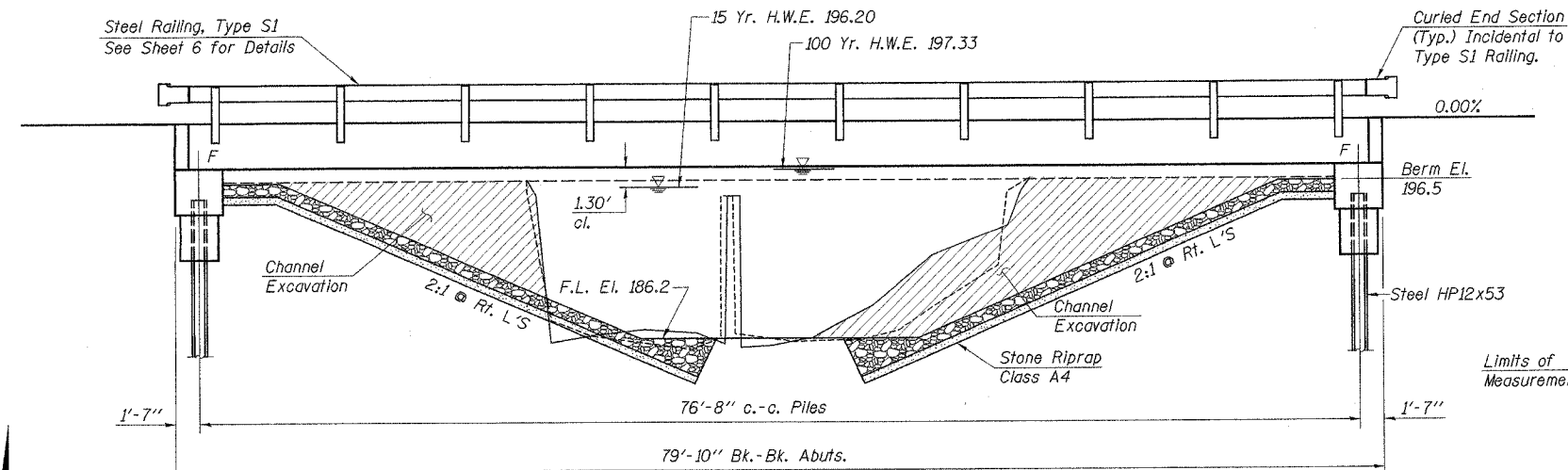

ELEVATION

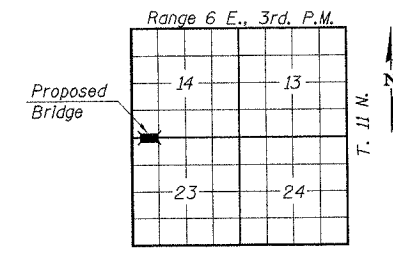

LOCATION PLAN

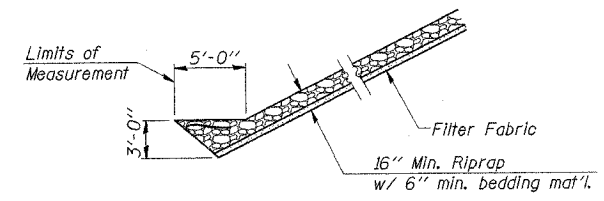

**SECTION A-A
RIPRAP PLACEMENT DETAIL**

GENERAL NOTES

See Proposal for Boring data.

Reinforcement bars shall conform to the requirements of AASHTO M-31, M-42 or M-53, Grade 60.

The Contractor shall drive one steel test pile in a permanent location at each abutment as directed by the Engineer, before ordering the remainder of piles.

Layout of slope protection system may be varied in the field to suit ground conditions as directed by the Engineer.

Excavation for structures shall be considered as included in the contract unit price for the class of concrete involved.

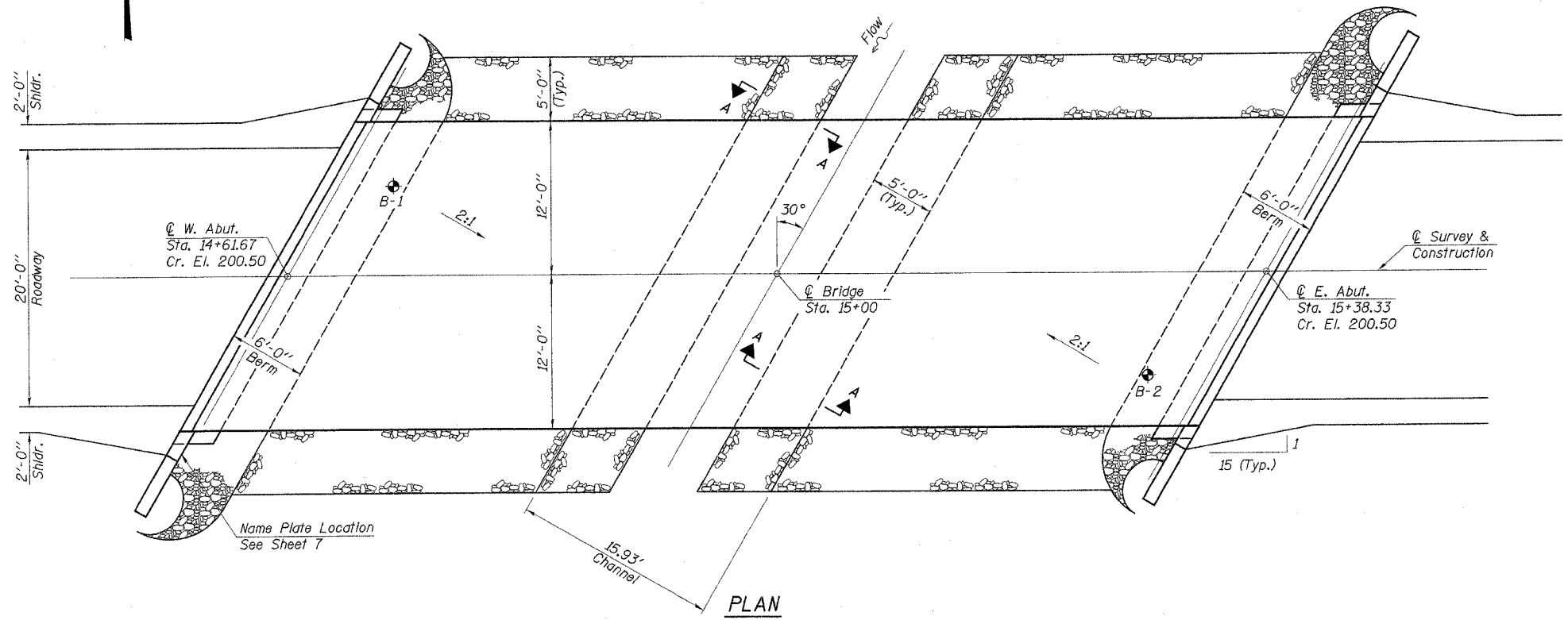

PLAN

DESIGN STRESSES

$f_c = 5,000$ p.s.i. (Prestressed Beams)
 $f_{cl} = 4,000$ p.s.i. (Prestressed Beams)
 $f_c = 1,400$ p.s.i. (Concrete)
 $f_s = 270,000$ p.s.i. (Prestressed Strands)
 $f_{sl} = 201,960$ p.s.i. (Prestressed Strands)
 $f_s = 24,000$ p.s.i. (Reinf. Bars -- Field Units)
 $f_y = 60,000$ p.s.i. (Reinf. Bars -- Field Units)
 $n = 9$ (Concrete)
 LOADING HS20-44
 Design Specifications: 2002 AASHTO
 25#/Sq. Ft. included in dead load for future wearing surface.

WATERWAY INFORMATION

Drainage Area	3.62 Sq. Mi.
Existing Opening (15 Yr.)	213 Sq. Ft.
Existing Over The Road (15 Yr.)	84 Sq. Ft.
Required Opening (15 Yr.)	362 Sq. Ft.
Proposed Opening (15 Yr.)	362 Sq. Ft.
Design Discharge (15 Yr.)	1153 C.F.S.
Created Head (15 Yr.)	0.04 Ft.
100 Year Discharge	1885 C.F.S.
100 Yr. Created Head	0.20 Ft.

DESIGNED	F.J.S.
CHECKED	S.F.M.
DRAWN	K.T.R. & S.A.P.
CHECKED	F.J.S.

**FLAT BRANCH
 BUILT 200_ BY
 ASH GROVE ROAD DISTRICT
 SHELBY COUNTY
 SEC. 03-01123-00-BR
 F.A. PROJ. BROS-173(129)
 STR. NO. 087-3545 LOADING HS20**

LETTERING FOR NAME PLATE
 See Std. 515001

TOTAL BILL OF MATERIAL

ITEM	UNIT	SUPER	SUB	TOTAL
Precast Prestressed Concrete Deck Beams (33" Depth)	Sq. Ft.	1872		1872
Concrete Structures	Cu. Yd.		27.2	27.2
Reinforcement Bars	Pound		3140	3140
Steel Railing, Type S1	Foot	156		156
Name Plates	Each		1	1
Steel Piles HP12x53	Foot		280	280
Test Pile Steel HP12x53	Each		2	2
Stone Riprap, Class A4	Ton		208	208
Filter Fabric	Sq. Yd.		262	262
Concrete Encasement	Cu. Yd.		5.5	5.5

"I certify that to the best of my knowledge, information and belief, this bridge design is structurally adequate for the design loading shown on the plans. The design is an economical one for the style of structure and complies with requirements of the current 'AASHTO Standard Specifications for Highway Bridges'."

Fred J. Stone, Jr. (7-12-05)
 ILLINOIS STRUCTURAL NO. 2934 (Expires 11/30/06)



GENERAL PLAN & ELEVATION

**SECTION 03-01123-00-BR
 ASH GROVE ROAD DISTRICT
 SHELBY COUNTY
 STATION 15+00**

4440 ASH GROVE SPRINGFIELD, IL 62711 (217) 793-8600 oasinc@tamvid.com	OZYURT AND STONE, INC. CONSULTING ENGINEERS	JOB NO.: 0322 FILE: 03226PE.DGN DATE: 07/12/05
--	---	--