

RTE.	SECTION	COUNTY	TOTAL SHEETS	SHEET NO.
TR 227	98-11120-00-BR	JEFFERSON	35	5
STA. 31+00.00	TO STA. 45+00.00			
FED. ROAD DIST. NO. 7	ILLINOIS	FED. AID PROJECT		
CONTRACT NO. 95437				

Note: Union Pacific Railroad Milepost #372 located +1473.5 feet north of \bar{C} of Roadway.

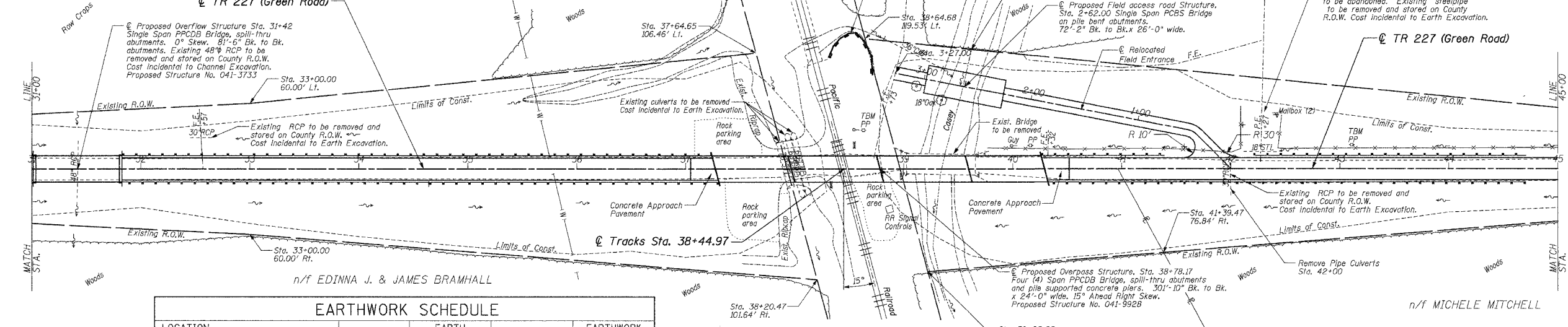
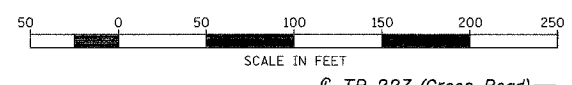

LOCATION	EARTH EXCAVATION		EARTH EMBANKMENT		EARTHWORK BALANCE** WASTE (+) OR SHORTAGE (-)
	CU. YD.	ADJUSTED FOR SHRINKAGE* CU. YD.	CU. YD.	CU. YD.	
STA. 31+00.00 TO STA. 37+78.00	83	63	39752	-39689	
STA. 39+00.00 TO STA. 45+00.00	91	68	29868	-29800	
TOTAL	174	131	69620	-69489	

*25% SHRINKAGE **FURNISHED EXCAVATION

The Existing Right of Way shown hereon has been protracted from existing records and is to be used for reference purposes only. Furthermore, no complete survey of said R.O.W. is implied by this drawing.

See Sheet 3 for Guard Rail Schedule.

DATE	
BY	
REVISIONS	
NO.	
DESCRIPTION	
DATE	
BY	
PLANNING	
DESIGN	
CONSTRUCTION	
AS-BUILT	

DATE	
BY	
REVISIONS	
NO.	
DESCRIPTION	
DATE	
BY	
PROFILES	
GRADES	
STRUCTURES	
NOVATING	
CON	

