

SEE RIAT ROAD
PLAN AND PROFILE 8
FOR LEGEND

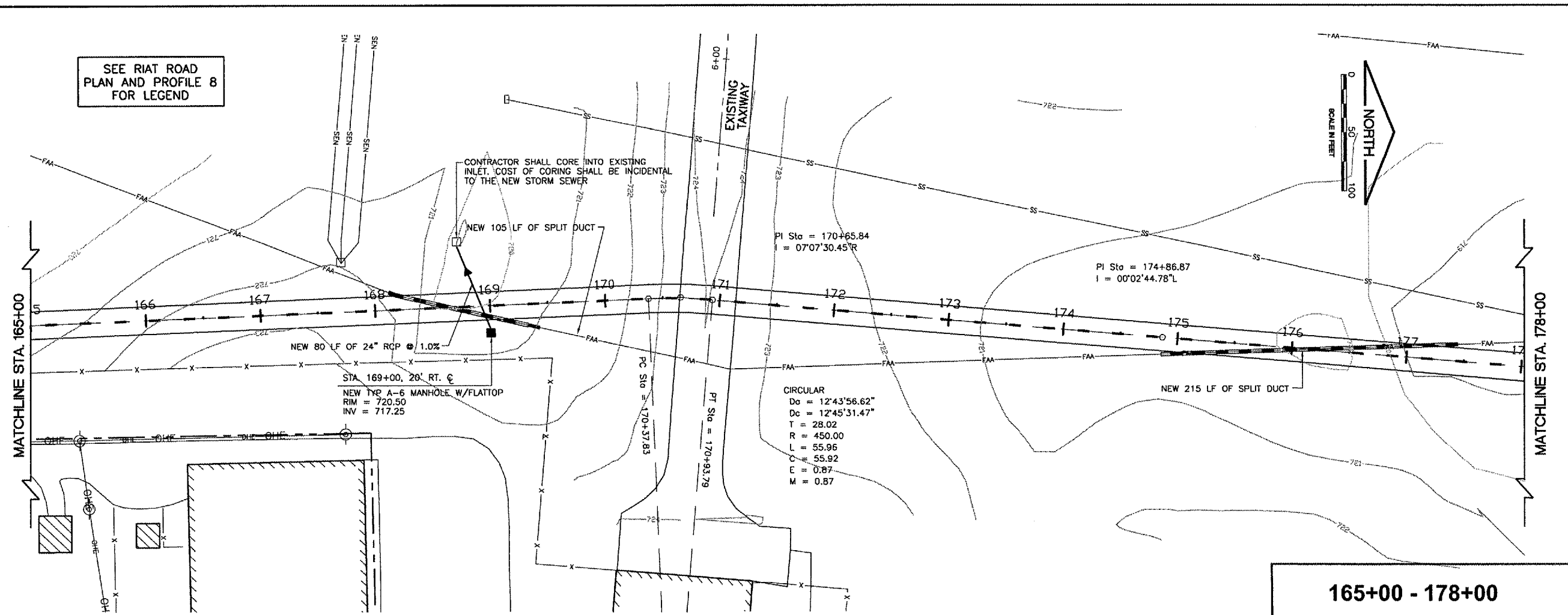

165+00 - 178+00

RO012

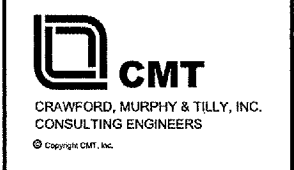

Rockford, Illinois
Greater Rockford
Airport Authority
AIP: 3-17-0088-43
RFD-3487

Rehab. Txy B;
Rwy 1/19 RSA Impr.,
Falcon Rd. Reloc.
S. RIAT Rd. Constr.
E. RIAT Rd. Reloc.

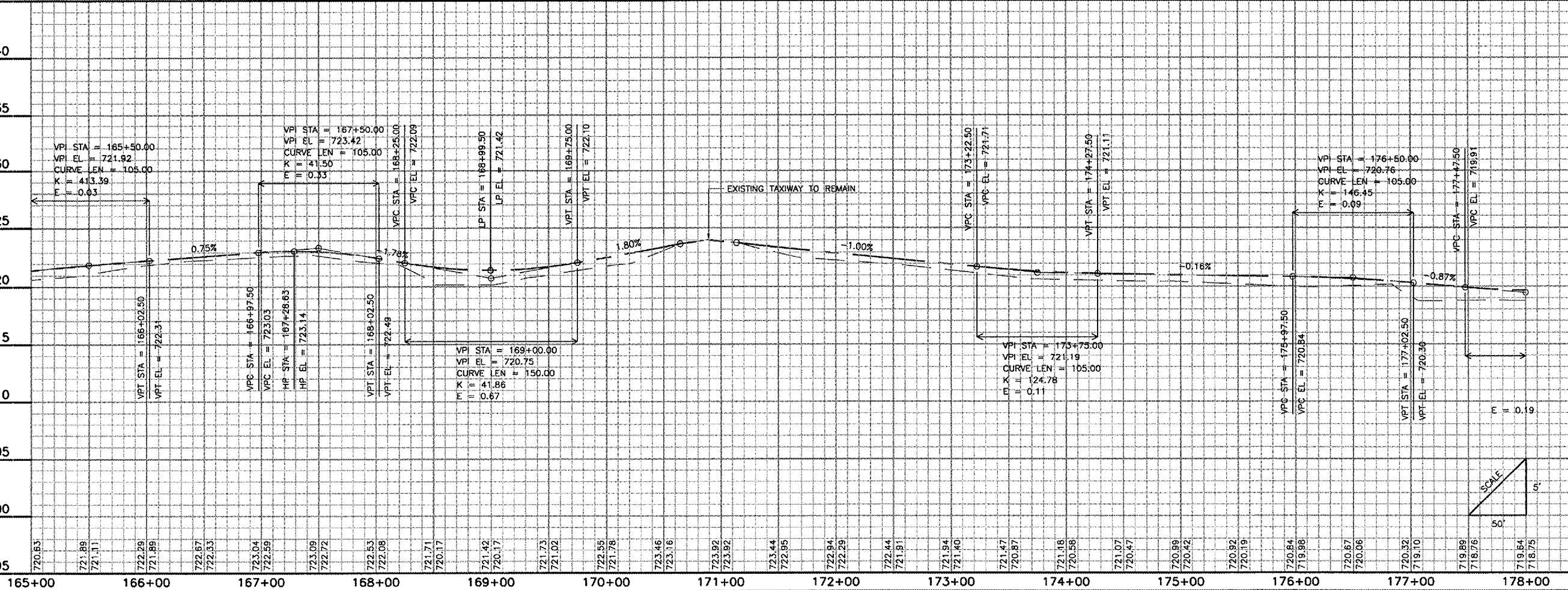

| Revisions | | |
|-----------|------|-------------|
| No. | Date | Description |
| 740 | | |
| 735 | | |
| 730 | | |
| 725 | | |

0 1
THIS BAR IS EQUAL TO 1"
AT FULL SCALE (17 X 11)

DESIGN BY: CMT-ARR
DRAWN BY: CMT-ARR
CHECKED BY: CMT-ARR
APPROVED BY: JGP
DATE: 7.29.2005
JOB No: 05258-04-00

PLAN AND
PROFILE
6
(SPP6)

35
SHEET 35 OF 52 SHEETS