

TRAFFIC BARRIER TERMINAL, TYPE 1 SPECIAL FLARED DETAIL

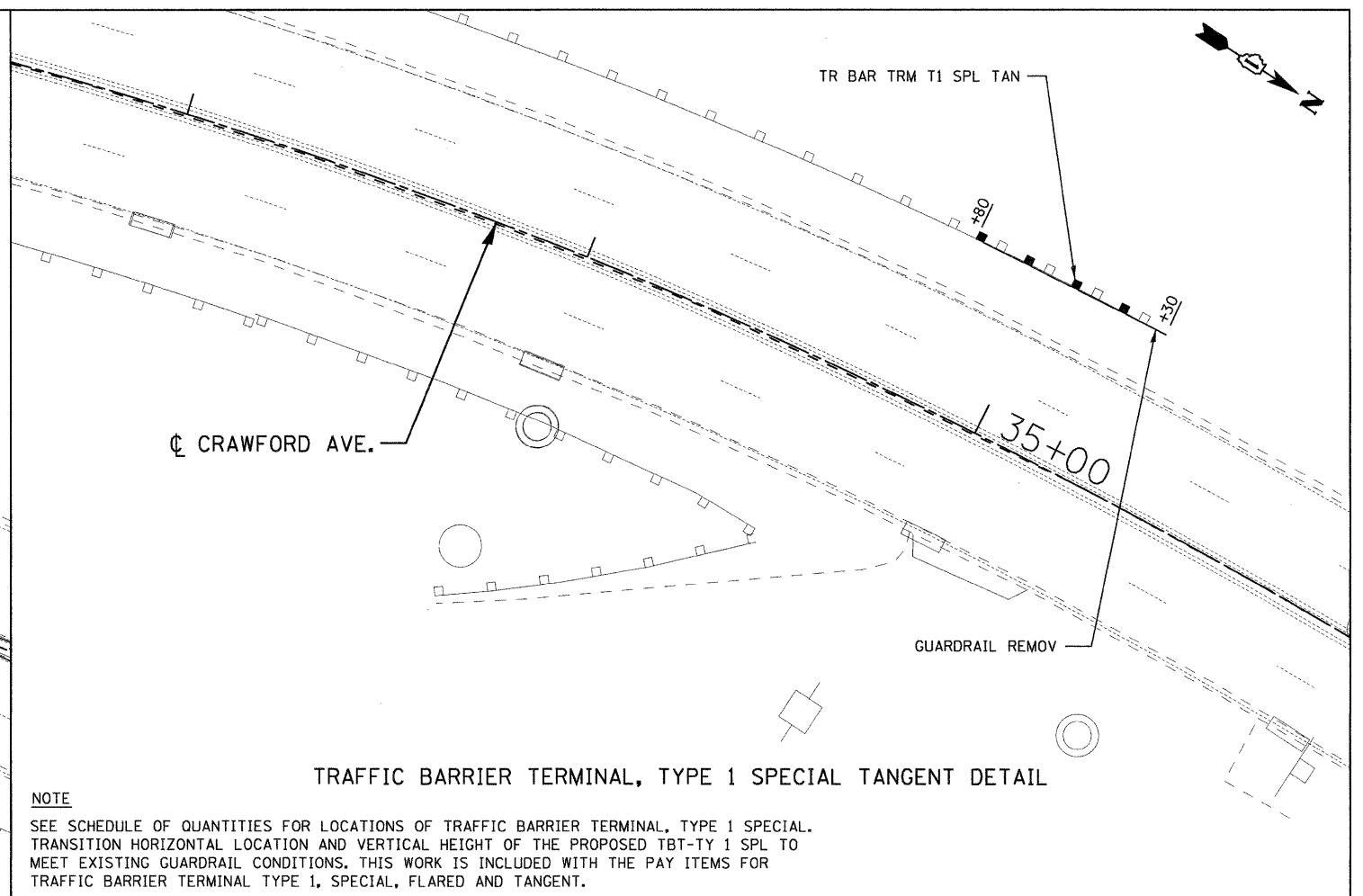

TRAFFIC BARRIER TERMINAL, TYPE 1 SPECIAL TANGENT DETAIL

NOTE

SEE SCHEDULE OF QUANTITIES FOR LOCATIONS OF TRAFFIC BARRIER TERMINAL, TYPE 1 SPECIAL. TRANSITION HORIZONTAL LOCATION AND VERTICAL HEIGHT OF THE PROPOSED TBT-TY 1 SPL TO MEET EXISTING GUARDRAIL CONDITIONS. THIS WORK IS INCLUDED WITH THE PAY ITEMS FOR TRAFFIC BARRIER TERMINAL TYPE 1, SPECIAL, FLARED AND TANGENT.



FILE NAME = G:\arc\proj\2102155_004\CAD\NC\11\Sh1\0160863-5\9aht-Rd\update\01.dgn

	USER NAME = zkujewo	DESIGNED - DJB	REVISED - 09-06-11 REV.	STATE OF ILLINOIS DEPARTMENT OF TRANSPORTATION	FAI ROUTE 57 (INTERSTATE 57) AT FAU ROUTE 3778 (CRAWFORD AVENUE) ROADWAY DETAILS			F.A.I. RTE. 57	SECTION 1112.1B	COUNTY COOK	TOTAL SHEETS 75	SHEET NO. 65
	PLOT SCALE = 20.00' / IN.	DRAWN - ENTRAN	REVISED -					SCALE: 20.00' / IN. SHEET NO. OF SHEETS STA. TO STA.			FED. ROAD DIST. NO. 1 ILLINOIS FED. AID PROJECT	
PLOT DATE = 08/26/2011	CHECKED - TMH	REVISED -				CONTRACT NO. 60863						
	DATE - 08/25/11	REVISED -										