

RESTORATION OF WORK AREA, RESTORATION OF THE TRAFFIC SIGNAL WORK AREA SHALL BE INCIDENTAL TO THE RELATED PAY ITEM SUCH AS FOUNDATION, CONDUIT, HANDHOLE, TRENCH AND BACKFILL, ETC., AND NO EXTRA COMPENSATION SHALL BE ALLOWED. ALL ROADWAY SURFACES SUCH AS SHOULDERS, MEDIANS, SIDEWALKS, PAVEMENT, ETC. SHALL BE REPLACED IN KIND. ALL DAMAGE TO MOWED LAWNS SHALL BE REPLACED WITH AN APPROVED SOD, AND ALL DAMAGE TO UNMOWED FIELDS SHALL BE SEEDING IN ACCORDANCE WITH STANDARD SPECIFICATIONS 252 AND 250 RESPECTIVELY.

NOTE:
THE TRAFFIC SIGNAL CONTROLLER EQUIPMENT FOR THIS PROJECT SHALL BE "ECONOLITE" TO MATCH THE EXISTING ADJACENT SYSTEM.

NOTE:
THE TRAFFIC SIGNAL CONTROLLER SHALL BE NTCIP COMPLIANT.

NOTE:
EXISTING RED LIGHT RUNNING (RLR) EQUIPMENT IS PRESENT AT THIS LOCATION. RELOCATION OF THE EQUIPMENT IS BY OTHERS. THE CONTRACTOR SHALL CONTACT GATSO-USA AT (480) 315-1386 AND THE VILLAGE OF LIBERTYVILLE AT (847) 362-2430 TO COORDINATE THE REMOVAL/RELOCATION OF THE RLR EQUIPMENT BY OTHERS.

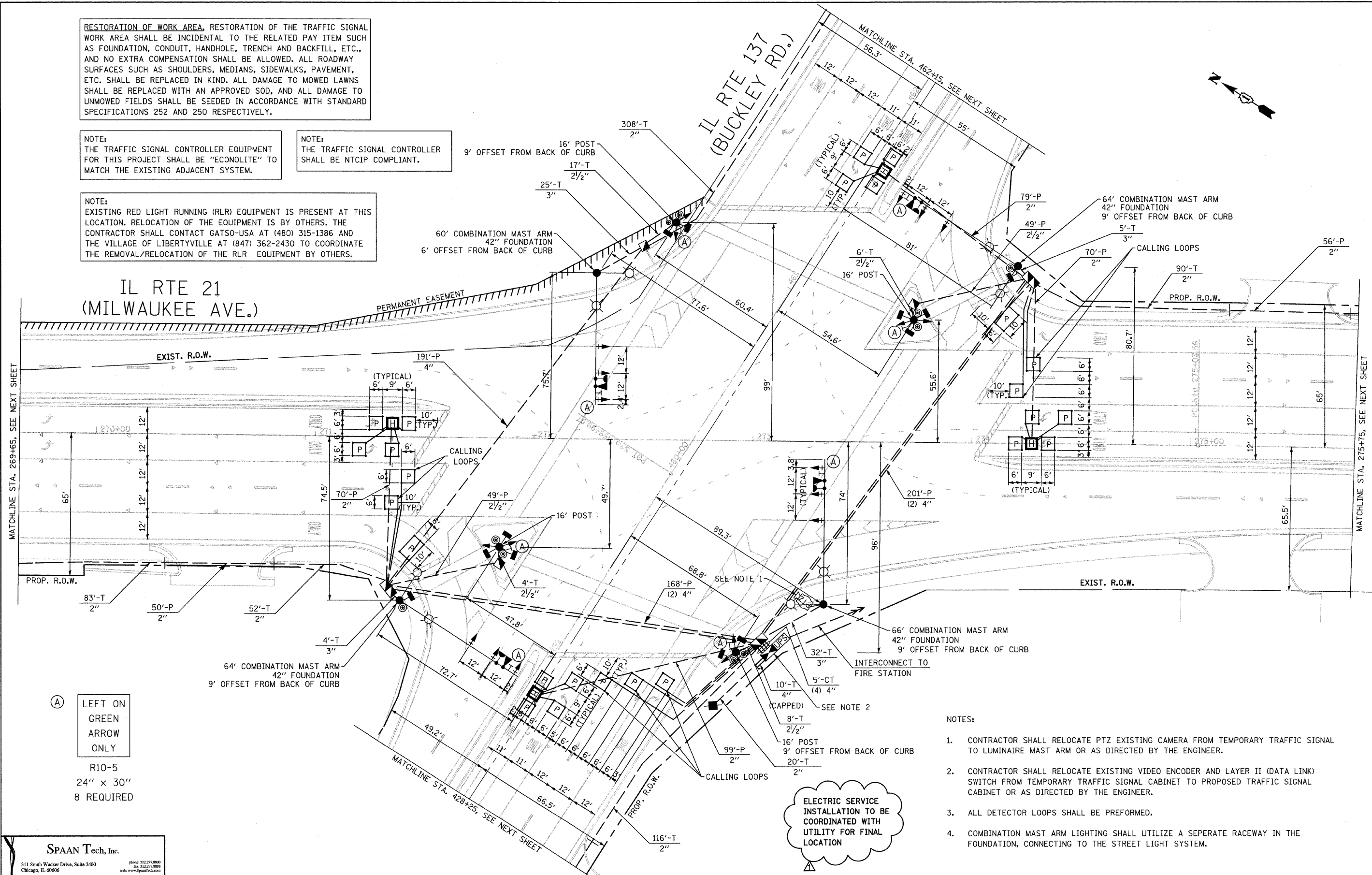

(A) LEFT ON GREEN ARROW ONLY
R10-5
24" x 30"
8 REQUIRED

- NOTES:
1. CONTRACTOR SHALL RELOCATE PTZ EXISTING CAMERA FROM TEMPORARY TRAFFIC SIGNAL TO LUMINAIRE MAST ARM OR AS DIRECTED BY THE ENGINEER.
 2. CONTRACTOR SHALL RELOCATE EXISTING VIDEO ENCODER AND LAYER II (DATA LINK) SWITCH FROM TEMPORARY TRAFFIC SIGNAL CABINET TO PROPOSED TRAFFIC SIGNAL CABINET OR AS DIRECTED BY THE ENGINEER.
 3. ALL DETECTOR LOOPS SHALL BE PREFORMED.
 4. COMBINATION MAST ARM LIGHTING SHALL UTILIZE A SEPERATE RACEWAY IN THE FOUNDATION, CONNECTING TO THE STREET LIGHT SYSTEM.

SPAAN Tech, Inc.
311 South Wacker Drive, Suite 2400
Chicago, IL 60606
Phone: 312.277.8800
Fax: 312.277.8808
Web: www.SpaanTech.com

15-TS-Buckley.dgn
HDR - PDF.plt
9/1/2011 1:54:45 PM

USER NAME = Toby Micokey	DESIGNED - TM	REVISED - 09/02/11 TM
PLOT SCALE = 40.000000' / 1" =	DRAWN - TM	REVISED -
HDR Fullerton Parkway.tbl	CHECKED - YK	REVISED -
	DATE - 04/13/11	REVISED -

STATE OF ILLINOIS
DEPARTMENT OF TRANSPORTATION

TRAFFIC SIGNAL MODERNIZATION PLAN
IL RTE 21 (MILWAUKEE AVE) AT IL RTE 137 (BUCKLEY ROAD)
SCALE: 1"=20' SHEET NO. 15 OF 41 SHEETS STA. TO STA.

F.A.P. RTE. 330	SECTION 128R-3	COUNTY LAKE	TOTAL SHEETS 518	SHEET NO. 203
CONTRACT NO. 60953				
ILLINOIS FED. AID PROJECT				