

- LEGEND**
- HOT-MIX ASPHALT SURFACE REMOVAL, 3" PAVEMENT REMOVAL
  - MEDIAN REMOVAL
  - HOT-MIX ASPHALT SURFACE REMOVAL, 3"
  - HOT-MIX ASPHALT SURFACE REMOVAL-BUTT JOINT
  - APPROACH SLAB REMOVAL
  - CLEARING (AREAS FOR CLEARING AS DIRECTED BY ENGINEER)

**NOTES:**  
 CONTRACTOR TO COORDINATE TREE REMOVAL WITH THE ENGINEER

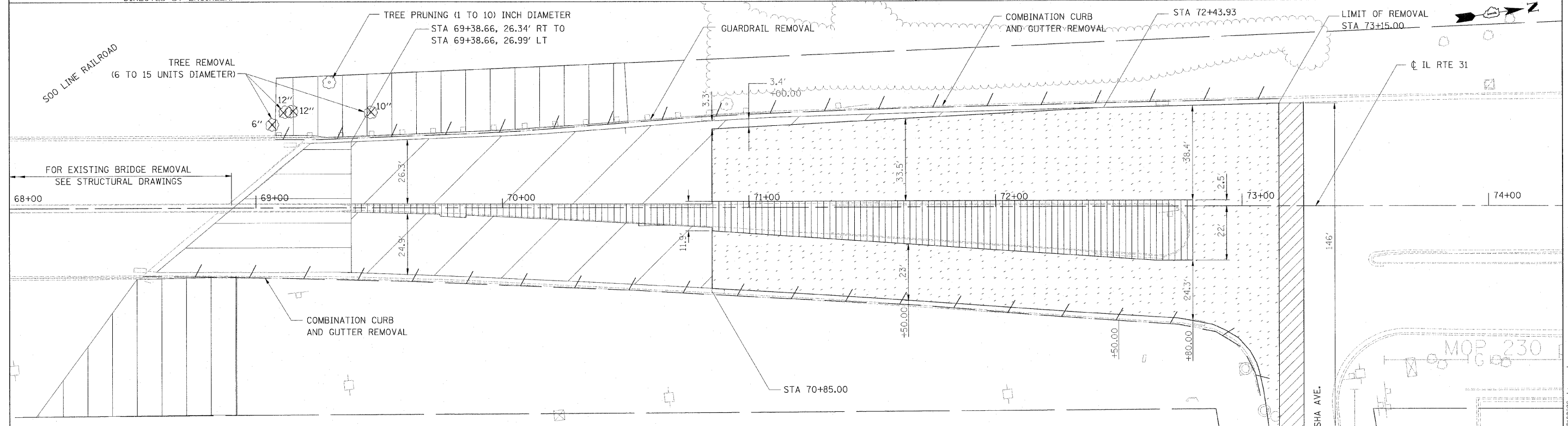

**BOWMAN, BARRETT & ASSOCIATES INC.**  
 CONSULTING ENGINEERS  
 Chicago, Illinois  
 312.228.0100  
 www.bbandainc.com

FILE NAME = D160C06-shtrrem.dgn	USER NAME = default	DESIGNED -	REVISED -
		DRAWN - RA	REVISED -
PLOT SCALE = #SCALE#		CHECKED - RS	REVISED -
PLOT DATE = 7/8/2011		DATE - 07/01/2011	REVISED -

**STATE OF ILLINOIS  
 DEPARTMENT OF TRANSPORTATION**

**REMOVAL PLAN**  
 SCALE: 1" = 20' SHEET NO. 1 OF 1 SHEETS STA. 61+00 TO STA. 75+00

F.A. RTE.	SECTION	COUNTY	TOTAL SHEETS	SHEET NO.
3887	R-VB-R	KANE	83	11
CONTRACT NO. 60C06			ILLINOIS FED. AID PROJECT	

s:\1918\05\_coads\1131\CAED\_Sheets\166C06-shtrrem.dgn