

CONTROLLER SEQUENCE

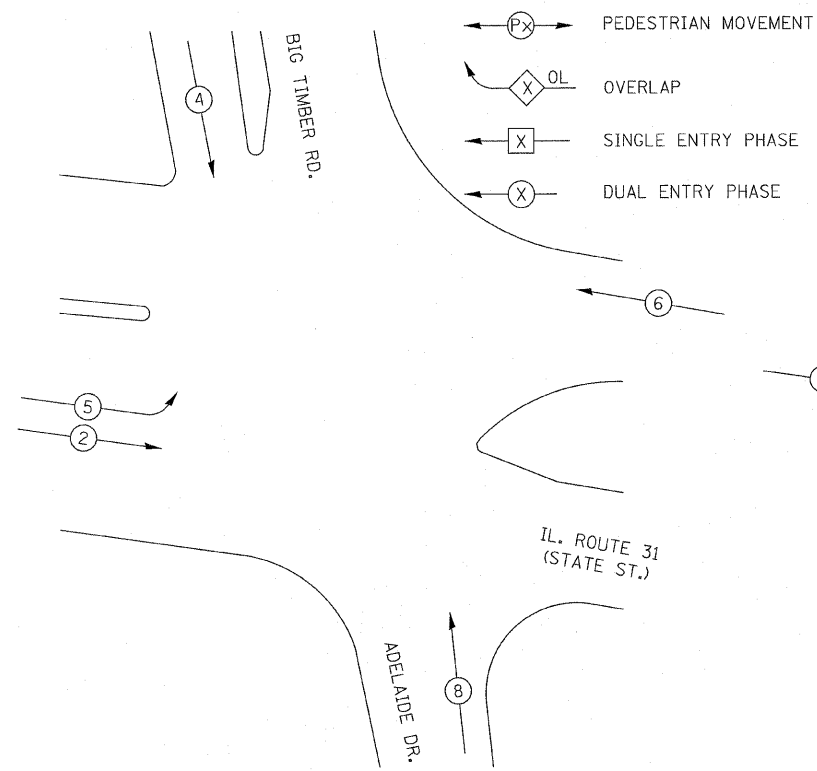

PHASE DESIGNATION DIAGRAM

NOT TO SCALE

LEGEND

- X NUMBER REFERS TO ASSOCIATED PHASE
- ⊗ PEDESTRIAN MOVEMENT
- ⊗ OL OVERLAP
- ⊗ SINGLE ENTRY PHASE
- ⊗ DUAL ENTRY PHASE

EMERGENCY VEHICLE PREEMPTION SEQUENCE

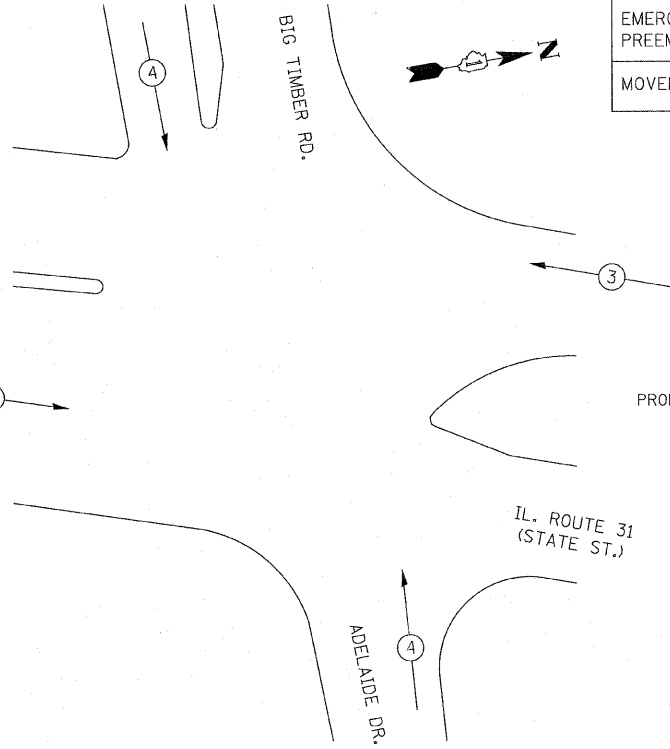

NOT TO SCALE

PROPOSED EMERGENCY VEHICLE PREEMPTORS		
EMERGENCY VEHICLE PREEMPTOR	3	4
MOVEMENT	←→	↑↓

PROPOSED TRACER CABLE  
PROPOSED INTERCONNECT TO STEPHEN DIMEO DR.

INTERSECTION AND SAMPLING (SYSTEM) DETECTORS

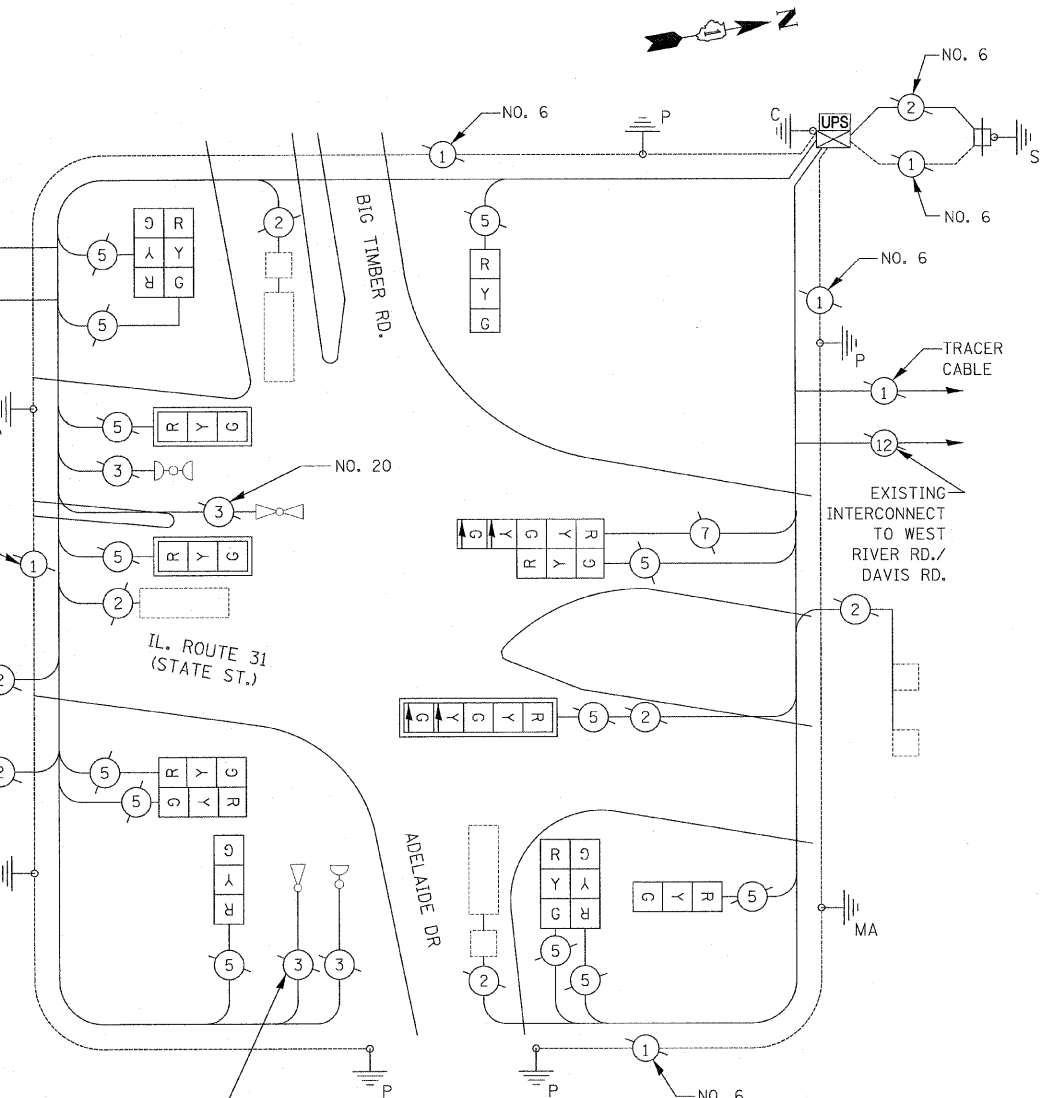

CABLE PLAN

NOT TO SCALE

THE ENVIRONMENTAL FIRM IS REQUIRED TO CONTINUOUSLY MONITOR FOR WORKER PROTECTION AND SOIL CONTAMINATION AT SEVERAL AREAS. SEE SPECIAL PROVISION AND SUPPLEMENTAL SPECIFICATIONS FOR DETAILS.

SCHEDULE OF QUANTITIES

ITEM	UNIT	QUANTITY
REMOVE EXISTING TRAFFIC SIGNAL EQUIPMENT	EACH	1
TRAFFIC SIGNAL POST, GALVANIZED STEEL 14 FT.	EACH	3
TRAFFIC SIGNAL POST, GALVANIZED STEEL 16 FT.	EACH	1
TRAFFIC SIGNAL POST, GALVANIZED STEEL 18 FT.	EACH	1
SIGNAL HEAD, LED, 1-FACE, 3-SECTION, BRACKET MOUNTED	EACH	3
SIGNAL HEAD, LED, 1-FACE, 3-SECTION, MAST-ARM MOUNTED	EACH	2
SIGNAL HEAD, LED, 1-FACE, 5-SECTION, MAST-ARM MOUNTED	EACH	1
SIGNAL HEAD, LED, 2-FACE, 3-SECTION, BRACKET MOUNTED	EACH	3
SIGNAL HEAD, LED, 2-FACE, 1-3 SECTION, 1-5 SECTION, BRACKET MOUNTED	EACH	1
TRAFFIC SIGNAL BACKPLATE, LOUVERED, ALUMINUM	EACH	3
MODIFY EXISTING CONTROLLER CABINET	EACH	1
UNINTERRUPTIBLE POWER SUPPLY	EACH	1
MAINTENANCE OF EXISTING TRAFFIC SIGNAL INSTALLATION	EACH	1

THE TRAFFIC SIGNAL CONTROLLER EQUIPMENT FOR THIS PROJECT SHALL BE "EAGLE" TO MATCH THE EXISTING ADJACENT SYSTEM.

I.D.O.T TRAFFIC SIGNAL INSTALLATION ELECTRICAL SERVICE REQUIREMENTS				TOTAL WATTAGE
TYPE	NO. OF LAMPS	WATTAGE x INCAND.	LED x % OPERATION	
SIGNAL (RED)	14		17 0.50	119
SIGNAL (YELLOW)	14		25 0.25	87.5
SIGNAL (GREEN)	14		15 0.25	52.5
ARROW	4		12 0.10	4.8
PED. SIGNAL			25 1.00	
CONTROLLER	1		100 1.00	100
ILLUM. SIGN				0.05
FLASHER				0.50
ENERGY COSTS TO:			TOTAL =	363.8

CITY OF ELGIN  
150 DEXTER COURT, ELGIN, IL 60120

ENERGY SUPPLY: CONTACT: KATHY NYSTROM  
PHONE: 847-608-2331  
COMPANY: COMED