

STATE OF ILLINOIS
DEPARTMENT OF TRANSPORTATION

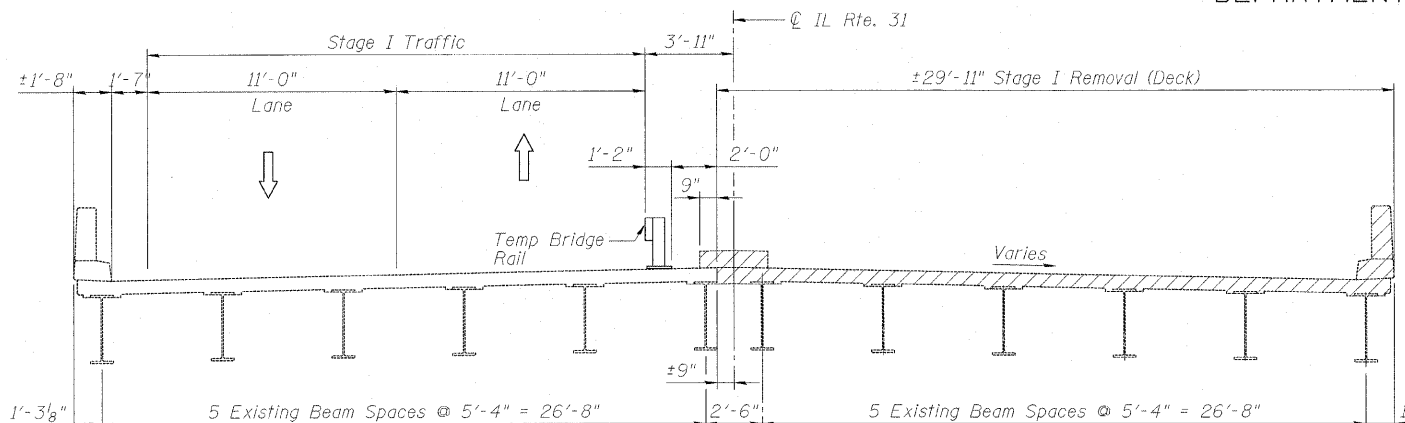

STAGE I REMOVAL

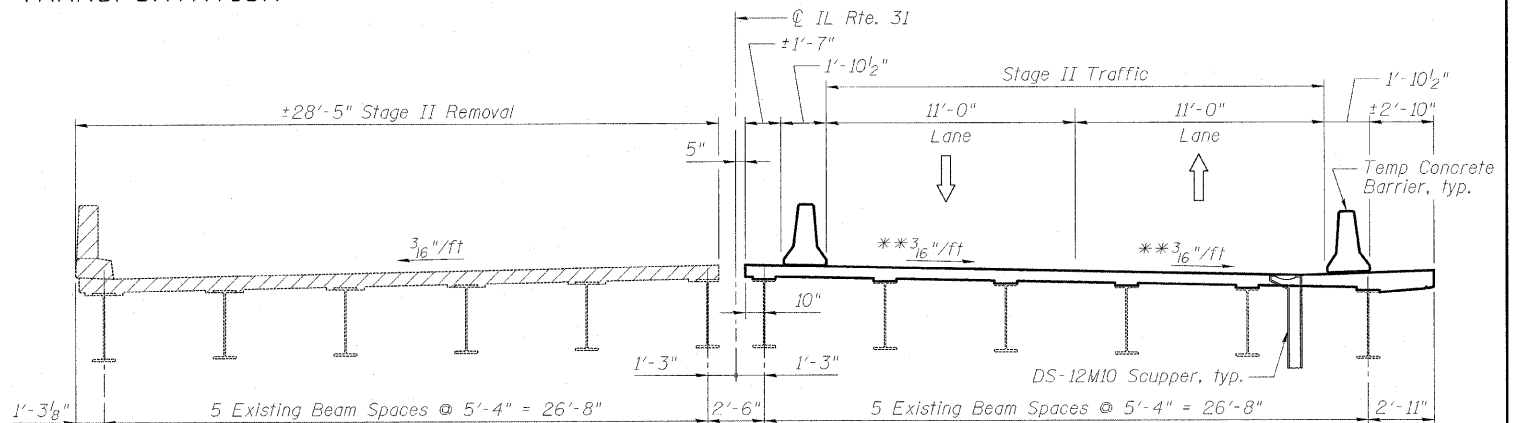

STAGE II REMOVAL

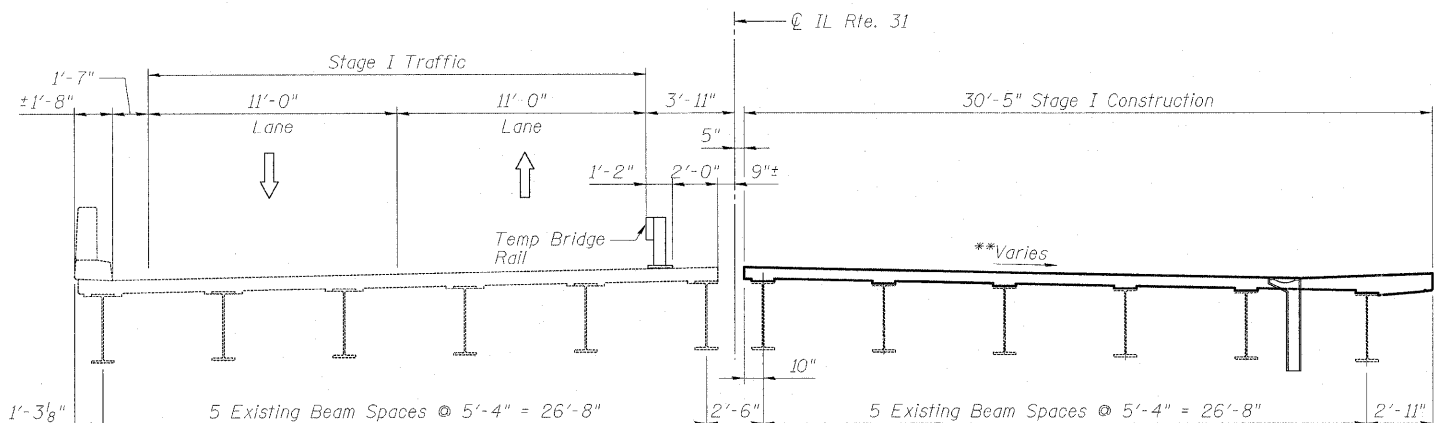

STAGE I CONSTRUCTION

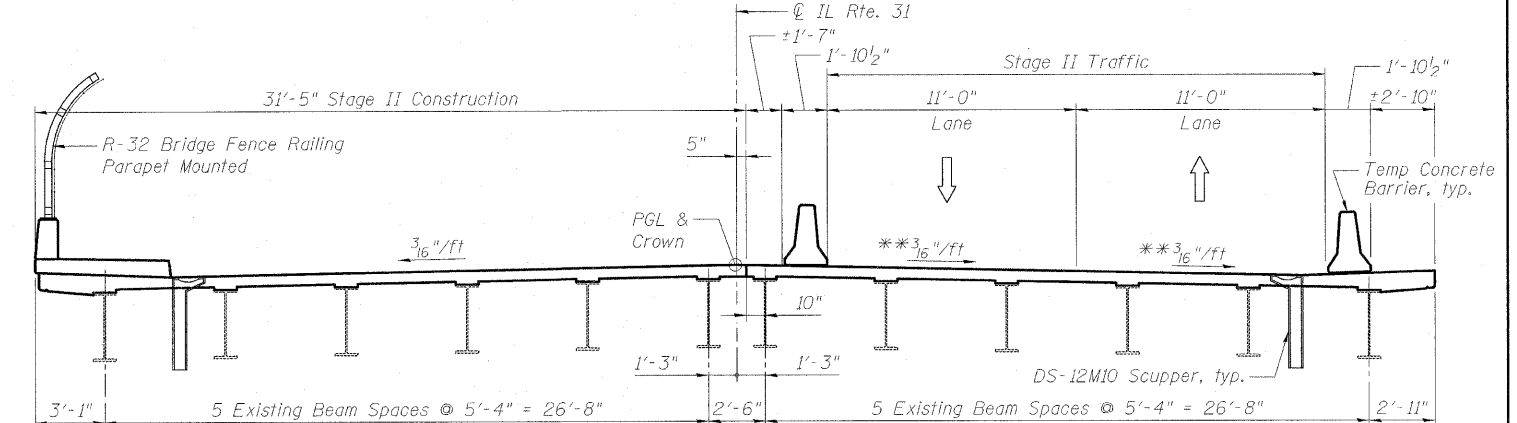

STAGE II CONSTRUCTION

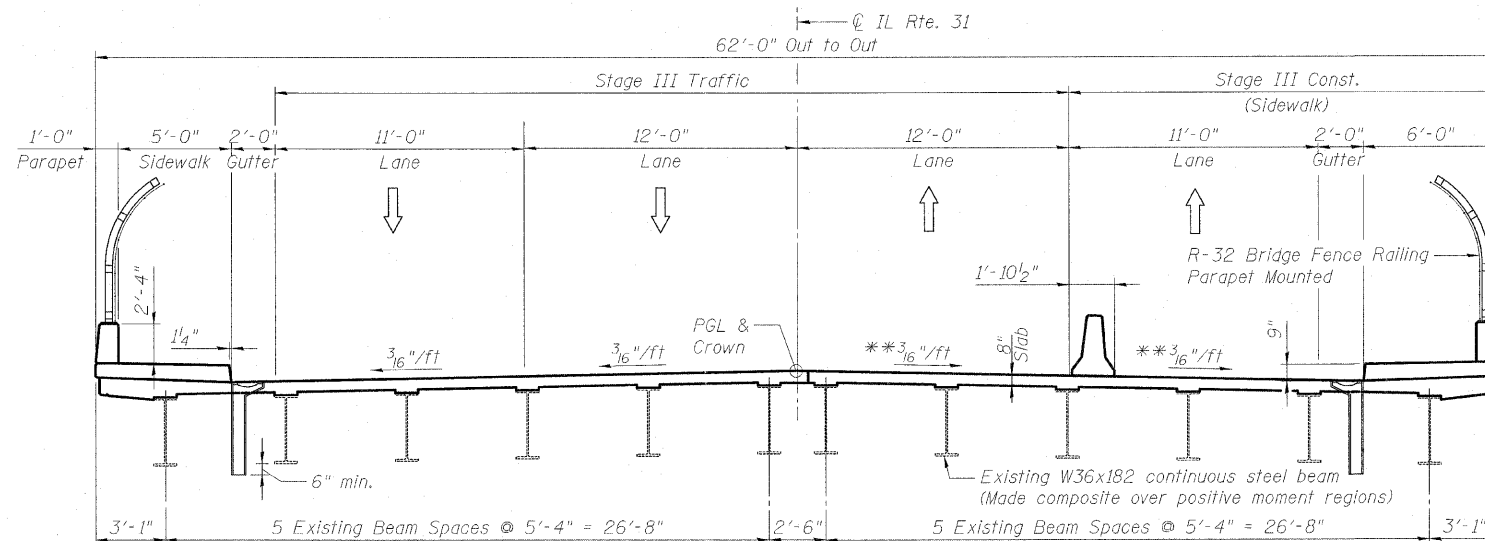

STAGE III CONSTRUCTION - FINAL

** Slope varies due to superelevation tangent run out. Superelevation transition occurs from Sta. 65+70 to Sta. 66+73.5 and cross-slope transitions from full S.E. (2.0%) to normal crown.

NOTES

1. Cross section views are looking north.
2. See Roadway Plans for quantity of Temporary Concrete Barrier.

LEGEND

Removal of Existing Concrete Deck

DESIGNED - TAH
CHECKED - DF
DRAWN - LAM
CHECKED - BLU

BOWMAN, BARRETT & ASSOCIATES INC.
CONSULTING ENGINEERS
Chicago, Illinois
312.228.0100
www.bbandainc.com
Job No. 910

SHEET NO. S-3 S-34 SHEETS	F.A.U. RTE. 3887	SECTION R-VB-R	COUNTY KANE	TOTAL SHEETS 83	SHEET NO. 37
	CONTRACT NO. 60C06				
FED. ROAD DIST. NO. 1 ILLINOIS FED. AID PROJECT					

CONSTRUCTION STAGING
STRUCTURE NO. 045-0016

6/27/2009 08:28:05 AM S:\910\95-CAD\01\3400-Struct\159506-60C06-003-58.dwg