

LEGEND

- ① **RESURFACING**
-PROP. POLYMERIZED HMA SURFACE COURSE, MIX "F", N90, 2"
- ② **WIDENING**
-PROP. POLYMERIZED HMA SURFACE COURSE, MIX "F", N90, 2"
-PROP. POLYMERIZED HMA BINDER COURSE, N90,
10 1/2" (IL 72) AND 9 1/2" (RANDALL RD.)
-PROP. AGGREGATE SUBGRADE, 12"
- ③ **P.E. DRIVEWAY**
-PROP. HMA SURFACE COURSE, MIX "C", N50, 2"
-PROP. HMA BASE COURSE, 6"
- ④ **C.E. DRIVEWAY**
-PROP. HMA SURFACE COURSE, MIX "C", N50, 2"
-PROP. HMA BASE COURSE, TYPE B, 8"
- ⑤ **FIELD ENTRANCE**
-PROP. HMA SURFACE COURSE, MIX "C", N50, 2"
-PROP. AGGREGATE BASE COURSE, TYPE B, 8"
- ⑥ **SHOULDER**
-PROP. POLYMERIZED HMA SURFACE COURSE, MIX "F", N90, 2"
-PROP. POLYMERIZED HMA BINDER COURSE, N90,
9 1/2" (RANDALL RD.) AND 10 1/2" (IL 72)
-PROP. AGGREGATE SUBGRADE, 12"

EXIST. CURVE E-72-1
PI STA. = 95+36.98
 $\Delta = 1^\circ 09' 12''$ (RT)
D = 0° 12' 37"
R = 27,243.63'
T = 274.22'
L = 548.42'
E = 1.38'
e = -----
T.R. = -----
S.E. RUN = -----
P.C. STA. = 92+62.76
P.T. STA. = 98+11.18

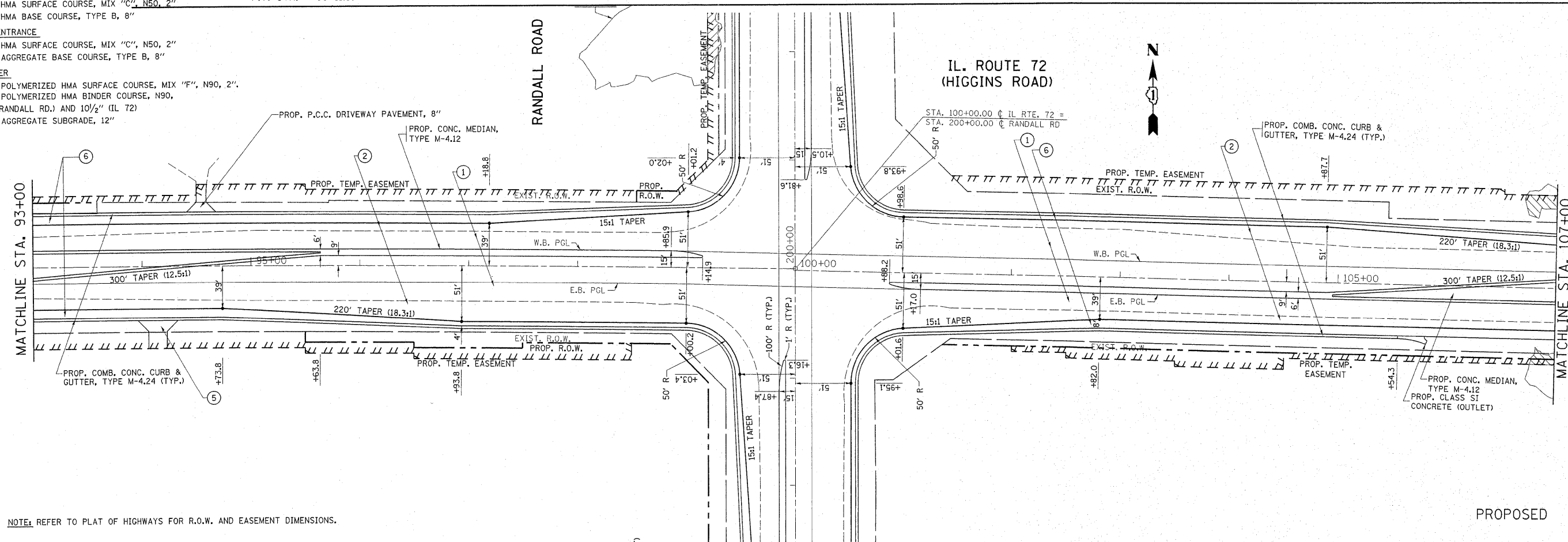

NOTE: REFER TO PLAT OF HIGHWAYS FOR R.O.W. AND EASEMENT DIMENSIONS.

FILE NAME = P110208-sht-plandgn

USER NAME = shronisb

DESIGNED -

REVISED - REV. 9/6/2011

DRAWN -

REVISED -

CHECKED -

REVISED -

DATE -

REVISED -

STATE OF ILLINOIS
DEPARTMENT OF TRANSPORTATION

IL. ROUTE 72 (HIGGINS RD.) AT RANDALL ROAD
EXISTING & PROPOSED ROADWAY PLAN

SCALE: 1" = 50' SHEET NO. OF SHEETS STA. 93+00.00 TO STA. 107+00.00

F.A.P. RTE.	SECTION	COUNTY	TOTAL SHEETS	SHEET NO.
341	62-N-1	KANE	148	21
				CONTRACT NO. 60K09
ILLINOIS FED. AID PROJECT				