

LEGEND (IL. ROUTE 72)

- ① PROP. THERMOPLASTIC PAVEMENT MARKING LINE 4" SKIP DASH @ 30' SKIP & 10' DASH, WHITE (TYP.)
- ② PROP. THERMOPLASTIC PAVEMENT MARKING LINE 4" DOUBLE LINE @ 11" C-C, YELLOW (TYP.)
- ③ PROP. THERMOPLASTIC PAVEMENT MARKING LINE 6" TURN LANE, WHITE (TYP.)
- ④ PROP. THERMOPLASTIC PAVEMENT MARKING LINE 12" DIAGONALS @ 45°, YELLOW (TYP.), 150' SPACING.
- ⑤ PROP. THERMOPLASTIC PAVEMENT MARKING LETTERS & SYMBOLS, WHITE (TYP.)
- ⑥ PROP. THERMOPLASTIC PAVEMENT MARKING LINE 24" STOP BAR, WHITE (TYP.)
- ⑦ PROP. THERMOPLASTIC PAVEMENT MARKING LINE 4" EDGE LINE, WHITE (TYP.)
- ⑧ PROP. THERMOPLASTIC PAVEMENT MARKING LINE 4" EDGE LINE, YELLOW (TYP.)
- ⑨ PROP. THERMOPLASTIC PAVEMENT MARKING LINE 6" DOTTED @ 6' SKIP & 2' DASH, WHITE (TYP.)

NOTES:
 1. ALL THE PAVEMENT MARKING FOR RANDALL RD. SHALL BE URETHANE PAVEMENT MARKING.
 2. THERE WILL BE NO RAISED REFLECTIVE PAVEMENT MARKERS INSTALLATION ON RANDALL RD.

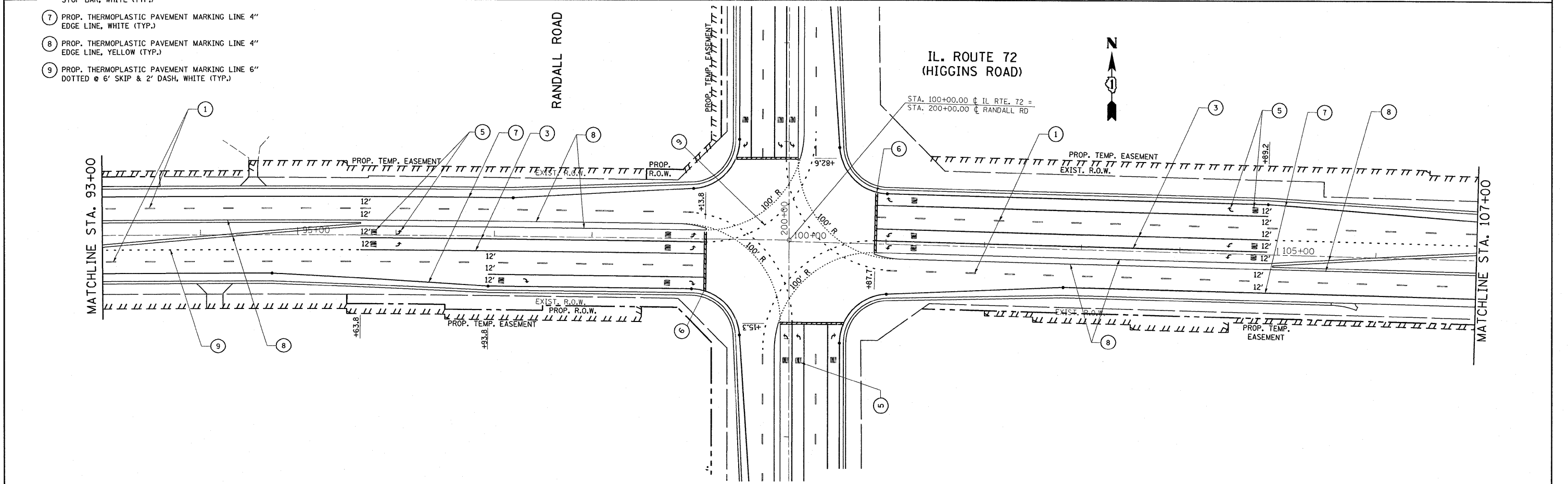

FILE NAME = P110008-sht-pmk.dgn	USER NAME = drvakosgn	DESIGNED -	REVISED -	STATE OF ILLINOIS DEPARTMENT OF TRANSPORTATION	IL. ROUTE 72 (HIGGINS ROAD) @ RANDALL ROAD PAVEMENT MARKING			F.A.P. RTE. 341	SECTION 62-N-1	COUNTY KANE	TOTAL SHEETS 148	SHEET NO. 56
	PLOT SCALE = 50.0000' / IN.	CHECKED -	REVISED -		SCALE: 1" = 50'	SHEET NO.	OF	SHEETS	STA. 78+00.00	TO STA. 107+00.00	CONTRACT NO. 60K09	
	PLOT DATE = 5/31/2011	DATE -	REVISED -		ILLINOIS FED. AID PROJECT							

19:29:28 05/22/2011