

NOTES FOR TEMPORARY TRAFFIC SIGNALS

- ALL CONTROL EQUIPMENT INCLUDING EMERGENCY PRE-EMPTION AND COMMUNICATION DEVICES FOR THE TEMPORARY TRAFFIC SIGNAL(S) SHALL BE FURNISHED BY THE CONTRACTOR.
- ONLY CONTROLLERS SUPPLIED BY ONE OF THE DISTRICT APPROVED CLOSED LOOP EQUIPMENT MANUFACTURERS WILL BE APPROVED FOR USE AT TEMPORARY SIGNAL LOCATIONS. ALL CONTROLLERS USED FOR TEMPORARY TRAFFIC SIGNALS SHALL BE FULLY ACTUATED NEMA MICROPROCESSOR BASED WITH RS232 DATA ENTRY PORTS COMPATIBLE WITH EXISTING MONITORING SOFTWARE APPROVED BY IDOT DISTRICT 1, INSTALLED IN A NEMA TS2 CABINET. ONLY ONE BRAND OF CONTROLLER WILL BE ACCEPTED FOR ANY ONE CONTRACT.
- ALL TRAFFIC SIGNAL SECTIONS AND PEDESTRIAN SIGNAL SECTIONS SHALL BE L.E.D. AND 12" (300 mm) DIAMETER. HEADS SHALL BE PLACED AS INDICATED ON THE TEMPORARY TRAFFIC SIGNAL PLAN OR AS DIRECTED BY THE ENGINEER. PEDESTRIAN SIGNALS SHALL INCLUDE SOLID INTERNATIONAL SYMBOLS. PEDESTRIAN SIGNALS WITH COUNTDOWN TIMERS SHALL BE USED WHEN THE EXISTING INSTALLATION UTILIZES COUNTDOWN TYPE OR AS DIRECTED BY THE ENGINEER. COUNTDOWN TYPE PEDESTRIAN SIGNALS ARE NOT TO BE INSTALLED AT A RAILROAD INTERSECTION. THE CONTRACTOR SHALL FURNISH ENOUGH CABLE SLACK TO RELOCATE HEADS TO ANY POSITION ON THE SPAN WIRE OR AT LOCATIONS ILLUSTRATED ON THE PLANS FOR CONSTRUCTION STAGING. THE TEMPORARY TRAFFIC SIGNAL SHALL REMAIN IN OPERATION DURING ALL SIGNAL HEAD RELOCATIONS. EACH TEMPORARY TRAFFIC SIGNAL HEAD SHALL HAVE ITS OWN CABLE FROM THE CONTROLLER CABINET TO THE SIGNAL HEAD.
- ALL EXISTING STREET NAME AND INTERSECTION REGULATORY SIGNS SHALL BE REMOVED FROM EXISTING POLES, RELOCATED AND SECURELY FASTENED TO THE SPAN WIRE OR WOOD POLE AS DIRECTED BY THE ENGINEER.
- ANY TEMPORARY SIGNAL WITHIN AN EXISTING CLOSED LOOP TRAFFIC SIGNAL SYSTEM SHALL BE INTERCONNECTED TO THAT SYSTEM USING SIMILAR BRAND CONTROL EQUIPMENT.
- THE TEMPORARY TRAFFIC SIGNAL SHALL HAVE THE SIGNAL HEAD DISPLAYS, SIGNAL HEAD PLACEMENTS AND CONTROLLER PHASING MATCH THE EXISTING TRAFFIC SIGNAL, AT THE TIME OF THE TURN ON, IF NO TRAFFIC STAGING IS IN PLACE OR WILL NOT BE STAGED ON THE DAY OF THE TURN ON.
- UNINTERRUPTIBLE POWER SUPPLY (UPS) SYSTEMS SHALL BE INSTALLED AND MADE OPERATIONAL AT TEMPORARY TRAFFIC SIGNAL INSTALLATIONS WHERE UPS IS INSTALLED AT THE EXISTING TRAFFIC SIGNAL. TEMPORARY TRAFFIC SIGNALS AT RAILROAD INTERSECTIONS, AND TEMPORARY TRAFFIC SIGNALS AT INTERSECTIONS WITH FIRE STATION ACTUATED EMERGENCY VEHICLE PRE-EMPTION, OR WHEN INDICATED ON THE PLANS.

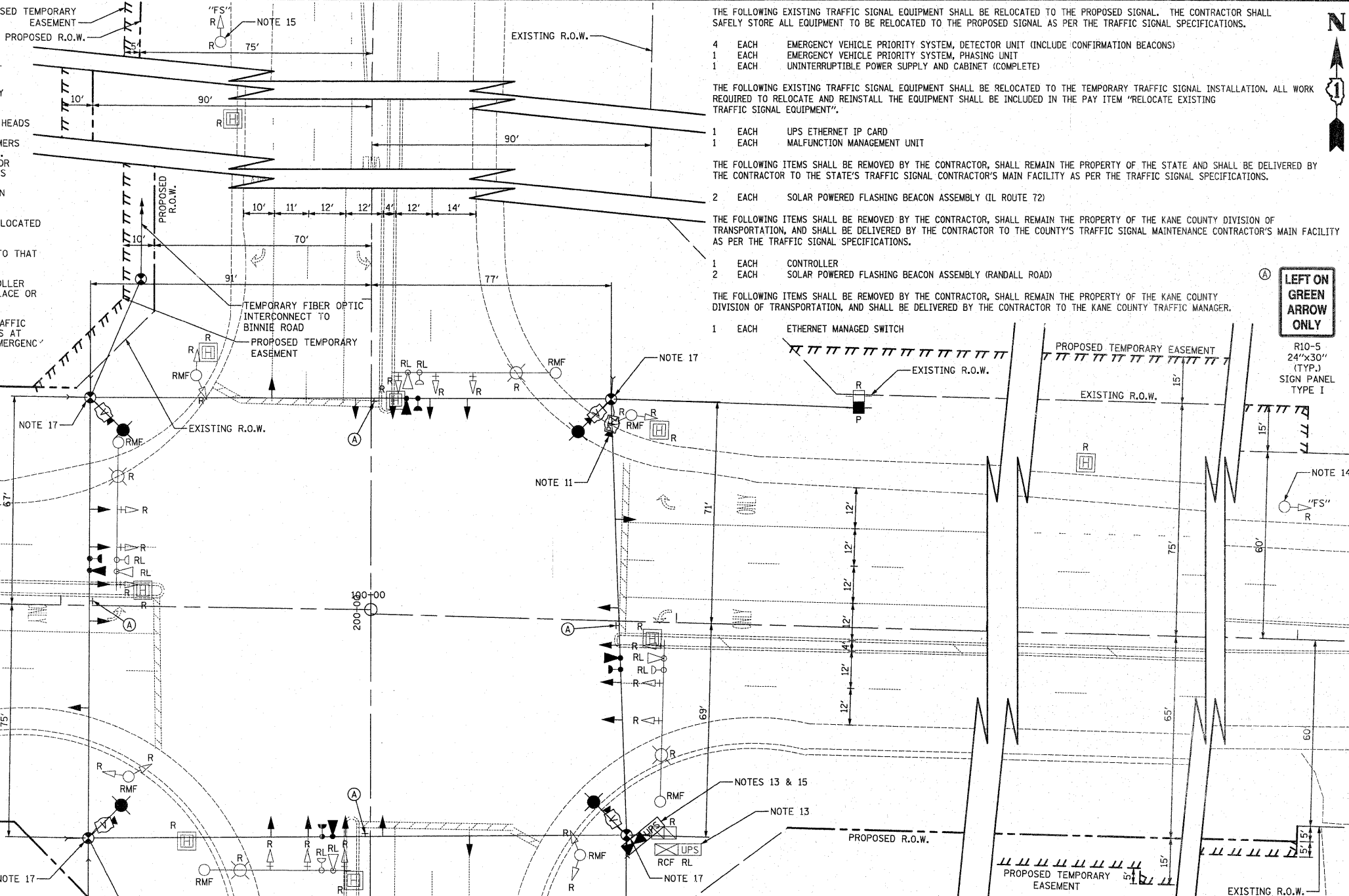

- THE FOLLOWING EXISTING TRAFFIC SIGNAL EQUIPMENT SHALL BE RELOCATED TO THE PROPOSED SIGNAL. THE CONTRACTOR SHALL SAFELY STORE ALL EQUIPMENT TO BE RELOCATED TO THE PROPOSED SIGNAL AS PER THE TRAFFIC SIGNAL SPECIFICATIONS.
- 4 EACH EMERGENCY VEHICLE PRIORITY SYSTEM, DETECTOR UNIT (INCLUDE CONFIRMATION BEACONS)
  - 1 EACH EMERGENCY VEHICLE PRIORITY SYSTEM, PHASING UNIT
  - 1 EACH UNINTERRUPTIBLE POWER SUPPLY AND CABINET (COMPLETE)
- THE FOLLOWING EXISTING TRAFFIC SIGNAL EQUIPMENT SHALL BE RELOCATED TO THE TEMPORARY TRAFFIC SIGNAL INSTALLATION. ALL WORK REQUIRED TO RELOCATE AND REINSTALL THE EQUIPMENT SHALL BE INCLUDED IN THE PAY ITEM "RELOCATE EXISTING TRAFFIC SIGNAL EQUIPMENT".
- 1 EACH UPS ETHERNET IP CARD
  - 1 EACH MALFUNCTION MANAGEMENT UNIT
- THE FOLLOWING ITEMS SHALL BE REMOVED BY THE CONTRACTOR, SHALL REMAIN THE PROPERTY OF THE STATE AND SHALL BE DELIVERED BY THE CONTRACTOR TO THE STATE'S TRAFFIC SIGNAL CONTRACTOR'S MAIN FACILITY AS PER THE TRAFFIC SIGNAL SPECIFICATIONS.
- 2 EACH SOLAR POWERED FLASHING BEACON ASSEMBLY (IL ROUTE 72)
- THE FOLLOWING ITEMS SHALL BE REMOVED BY THE CONTRACTOR, SHALL REMAIN THE PROPERTY OF THE KANE COUNTY DIVISION OF TRANSPORTATION, AND SHALL BE DELIVERED BY THE CONTRACTOR TO THE COUNTY'S TRAFFIC SIGNAL MAINTENANCE CONTRACTOR'S MAIN FACILITY AS PER THE TRAFFIC SIGNAL SPECIFICATIONS.
- 1 EACH CONTROLLER
  - 2 EACH SOLAR POWERED FLASHING BEACON ASSEMBLY (RANDALL ROAD)
- THE FOLLOWING ITEMS SHALL BE REMOVED BY THE CONTRACTOR, SHALL REMAIN THE PROPERTY OF THE KANE COUNTY DIVISION OF TRANSPORTATION, AND SHALL BE DELIVERED BY THE CONTRACTOR TO THE KANE COUNTY TRAFFIC MANAGER.
- 1 EACH ETHERNET MANAGED SWITCH

**LEFT ON GREEN ARROW ONLY**

R10-5  
24"x30"  
(TYP.)  
SIGN PANEL  
TYPE I

NOTES FOR TEMPORARY TRAFFIC SIGNALS (CONTINUED)

- TRAFFIC SIGNAL MANAGEMENT SYSTEMS SHALL BE MAINTAINED IN OPERATION AS INDICATED ON THE PLANS OR AS DIRECTED BY THE ENGINEER. REQUIRED EQUIPMENT SHALL BE AS SHOWN ON THE PLANS AND THE CONTRACTOR SHALL PLACE THE EQUIPMENT IN OPERATION TO THE SATISFACTION OF THE ENGINEER AND THE AGENCY RESPONSIBLE FOR THE TRAFFIC SIGNAL MANAGEMENT SYSTEM.
- DETECTION AT TEMPORARY TRAFFIC SIGNALS SHALL BE INCLUDED FOR ALL APPROACHES OF THE INTERSECTION UNLESS INDICATED OTHERWISE ON THE PLANS. THE DETECTION SYSTEM MUST MEET THE SPECIFICATIONS OF DISTRICT 1 AND THE CONTRACTOR SHALL PLACE THE DETECTORS INTO OPERATION TO THE SATISFACTION OF THE ENGINEER.
- WHEN PAN, TILT, ZOOM CAMERAS ARE INSTALLED AT THE EXISTING INTERSECTION OR ARE CALLED FOR IN THE PLANS, THE CONTRACTOR SHALL BE RESPONSIBLE FOR INSTALLING AND MAINTAINING THE CAMERAS TO THE SATISFACTION OF THE ENGINEER AND THE AGENCY RESPONSIBLE FOR THE CAMERAS.
- THE PROPOSED PAN, TILT, ZOOM CAMERA SHALL BE INSTALLED ON THE TEMPORARY SIGNAL AT THE LOCATION SHOWN ON THE PLANS. THE PTZ CAMERA SHALL BE RELOCATED TO THE PERMANENT SIGNAL INSTALLATION PRIOR TO TURN-ON. ALL WORK REQUIRED TO RELOCATE THE PTZ CAMERA TO THE PERMANENT TRAFFIC SIGNAL AND ENSURE PROPER OPERATION TO THE SATISFACTION OF THE ENGINEER AND THE KANE COUNTY DIVISION OF TRANSPORTATION SHALL BE INCLUDED IN THE PAY ITEM "VIDEO TRAFFIC MONITORING SYSTEM WITH PTZ CAMERA".
- THE VIDEO DETECTION CAMERAS INSTALLED ON THE TEMPORARY TRAFFIC SIGNAL INSTALLATION SHALL HAVE THE CAPABILITY TO BE REMOTELY ACCESSED THROUGH THE KANE COUNTY ATMS NETWORK. THIS WORK SHALL BE INCLUDED IN THE PAY ITEM "NETWORK CONFIGURATION".
- THE ETHERNET IP CARD IN THE EXISTING UNINTERRUPTIBLE POWER SUPPLY SHALL BE REMOVED AND REINSTALLED IN THE TEMPORARY UNINTERRUPTIBLE POWER SUPPLY. UPON TURN-ON OF THE PERMANENT TRAFFIC SIGNAL EQUIPMENT, THE ETHERNET IP CARD SHALL BE REMOVED FROM THE TEMPORARY UPS UNIT AND INSTALLED IN THE PERMANENT UPS UNIT. THIS WORK SHALL BE INCLUDED IN THE PAY ITEM "RELOCATE EXISTING TRAFFIC SIGNAL EQUIPMENT".
- THE EXISTING SOLAR POWER UNITS AND FLASHING BEACONS SHALL BE REMOVED FROM THE EXISTING FLASHING BEACON ASSEMBLIES ON IL ROUTE 72. THE EXISTING W3-3 ADVANCE SIGNAL WARNING SIGNS AND SUPPLEMENTARY STREET NAME PLAQUE SHALL REMAIN. THIS WORK SHALL BE INCLUDED IN THE PAY ITEM "REMOVE EXISTING FLASHING BEACON INSTALLATION COMPLETE".

NOTES FOR TEMPORARY TRAFFIC SIGNALS (CONTINUED)

- THE EXISTING FLASHING BEACON ASSEMBLIES AND W3-3 ADVANCE SIGNAL WARNING SIGNS SHALL BE REMOVED FROM THE NORTHBOUND AND SOUTHBOUND APPROACHES ON RANDALL ROAD. THIS WORK SHALL BE PAID AT THE CONTRACT UNIT PRICE EACH FOR "REMOVE EXISTING FLASHING BEACON INSTALLATION COMPLETE".
- A NEW ETHERNET MANAGED SWITCH SHALL BE INSTALLED IN THE TEMPORARY TRAFFIC SIGNAL CONTROLLER CABINET AND SHALL BE RELOCATED TO THE PERMANENT TRAFFIC SIGNAL INSTALLATION UPON TURN-ON. ALL WORK ASSOCIATED WITH INSTALLATION AND RELOCATION OF THE ETHERNET MANAGED SWITCH TO THE SATISFACTION OF THE ENGINEER AND THE KANE COUNTY DIVISION OF TRANSPORTATION SHALL BE INCLUDED IN THE PAY ITEM "ETHERNET MANAGED SWITCH, TYPE 1".
- THE TEMPORARY TRAFFIC SIGNAL WOOD POLES SHALL BE 60 FEET IN HEIGHT TO ACCOMMODATE INSTALLATION OF TEMPORARY LIGHTING AT THE INTERSECTION.

THE FOLLOWING ITEMS SHALL BE REMOVED BY THE CONTRACTOR AND SHALL BE DISPOSED OF BY THEM OUTSIDE THE RIGHT-OF-WAY AT THEIR EXPENSE. THE SALVAGE VALUE OF THE REMOVED EQUIPMENT SHALL BE REFLECTED IN THE CONTRACT BID PRICE.

- 1 EACH CONTROLLER CABINET, TYPE IV
- 4 EACH STEEL COMBINATION MAST ARM ASSEMBLY AND POLE
- 4 EACH SIGNAL POST
- 9 EACH SIGNAL HEAD, 1-FACE, 3-SECTION
- 3 EACH SIGNAL HEAD, 1-FACE, 5-SECTION
- 1 EACH SIGNAL HEAD, 2-FACE, 3 SECTION
- 3 EACH SIGNAL HEAD, 2-FACE, 1-3 SECTION, 1-5 SECTION
- 1 EACH SERVICE INSTALLATION
- 4 EACH LUMINAIRE

**RESTORATION OF WORK AREA.**  
RESTORATION OF THE TRAFFIC SIGNAL WORK AREA SHALL BE INCIDENTAL TO THE RELATED PAY ITEM SUCH AS FOUNDATION, CONDUIT, HANDHOLE, TRENCH AND BACKFILL, ETC., AND NO EXTRA COMPENSATION SHALL BE ALLOWED. ALL ROADWAY SURFACES SUCH AS SHOULDER, MEDIAN, SIDEWALKS, PAVEMENT, ETC. SHALL BE REPLACED IN KIND. ALL DAMAGE TO MOWED LAWNS SHALL BE REPLACED WITH AN APPROVED SALT TOLERANT SOD, AND ALL DAMAGE TO UNMOWED FIELDS SHALL BE SEEDED IN ACCORDANCE WITH STANDARD SPECIFICATIONS 252 AND 250 RESPECTIVELY.

NOTE:  
THE TRAFFIC SIGNAL CONTROLLER EQUIPMENT FOR THIS PROJECT SHALL BE "EAGLE" TO MATCH THE EXISTING ADJACENT SYSTEM.

FILE NAME =	USER NAME = brd	DESIGNED - BRD	REVISED -
...P110008-01_Temp_Sig_Plan.dgn		DRAWN - OJT	REVISED -
		CHECKED - JJE	REVISED -
		DATE - 03/25/2011	REVISED -

**STATE OF ILLINOIS  
DEPARTMENT OF TRANSPORTATION**

**IL ROUTE 72 (HIGGINS RD) AT RANDALL ROAD  
TEMPORARY TRAFFIC SIGNAL INSTALLATION PLAN AND REMOVAL PLAN**

SCALE: 1" = 20'    SHEET NO. 1 OF 1 SHEETS    STA.    TO STA.

F.A.P. RTE.	SECTION	COUNTY	TOTAL SHEETS	SHEET NO.
341	62-N-1	KANE	149	65
CONTRACT NO. 60K09				
FED. ROAD DIST. NO. 7 ILLINOIS FED. AID PROJECT				