

DATE	
BY	
REVISIONS	
PLANNED	
ALIGNED	
CHECKED	
NO. 1	
NO. 2	
NO. 3	
NO. 4	
NO. 5	
NO. 6	
NO. 7	
NO. 8	
NO. 9	
NO. 10	
NO. 11	
NO. 12	
NO. 13	
NO. 14	
NO. 15	
NO. 16	
NO. 17	
NO. 18	
NO. 19	
NO. 20	
NO. 21	
NO. 22	
NO. 23	
NO. 24	
NO. 25	
NO. 26	
NO. 27	
NO. 28	
NO. 29	
NO. 30	
NO. 31	
NO. 32	
NO. 33	
NO. 34	
NO. 35	
NO. 36	
NO. 37	
NO. 38	
NO. 39	
NO. 40	
NO. 41	
NO. 42	
NO. 43	
NO. 44	
NO. 45	
NO. 46	
NO. 47	
NO. 48	
NO. 49	
NO. 50	

DATE	
BY	
REVISIONS	
PLANNED	
ALIGNED	
CHECKED	
NO. 1	
NO. 2	
NO. 3	
NO. 4	
NO. 5	
NO. 6	
NO. 7	
NO. 8	
NO. 9	
NO. 10	
NO. 11	
NO. 12	
NO. 13	
NO. 14	
NO. 15	
NO. 16	
NO. 17	
NO. 18	
NO. 19	
NO. 20	
NO. 21	
NO. 22	
NO. 23	
NO. 24	
NO. 25	
NO. 26	
NO. 27	
NO. 28	
NO. 29	
NO. 30	
NO. 31	
NO. 32	
NO. 33	
NO. 34	
NO. 35	
NO. 36	
NO. 37	
NO. 38	
NO. 39	
NO. 40	
NO. 41	
NO. 42	
NO. 43	
NO. 44	
NO. 45	
NO. 46	
NO. 47	
NO. 48	
NO. 49	
NO. 50	

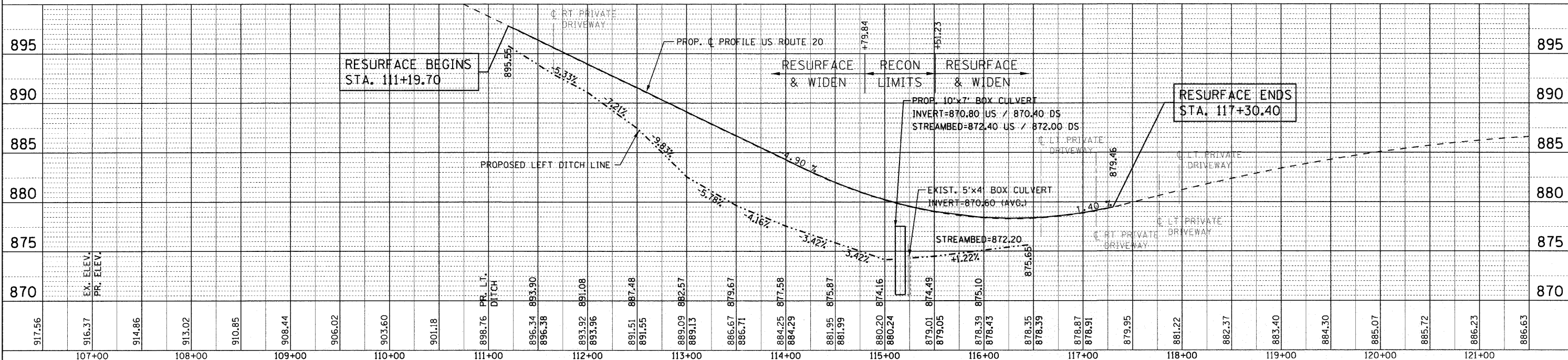
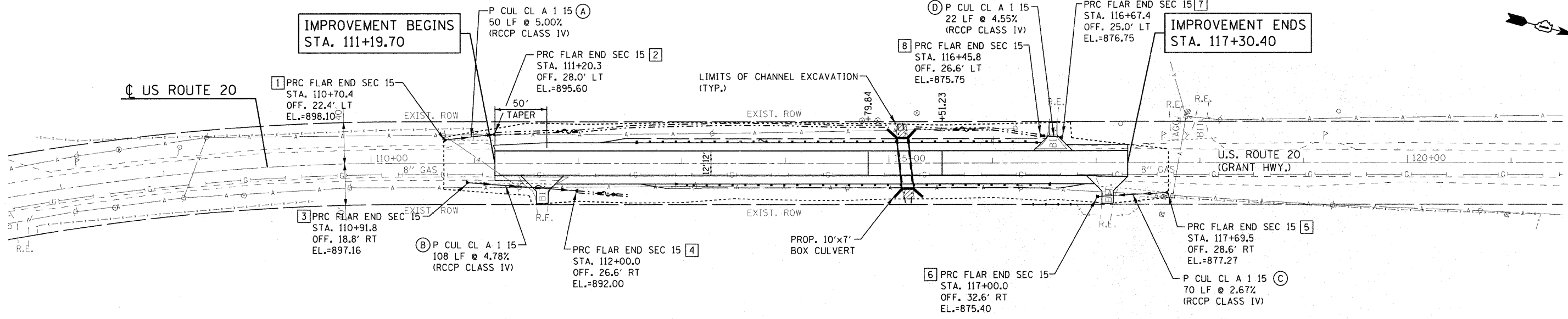
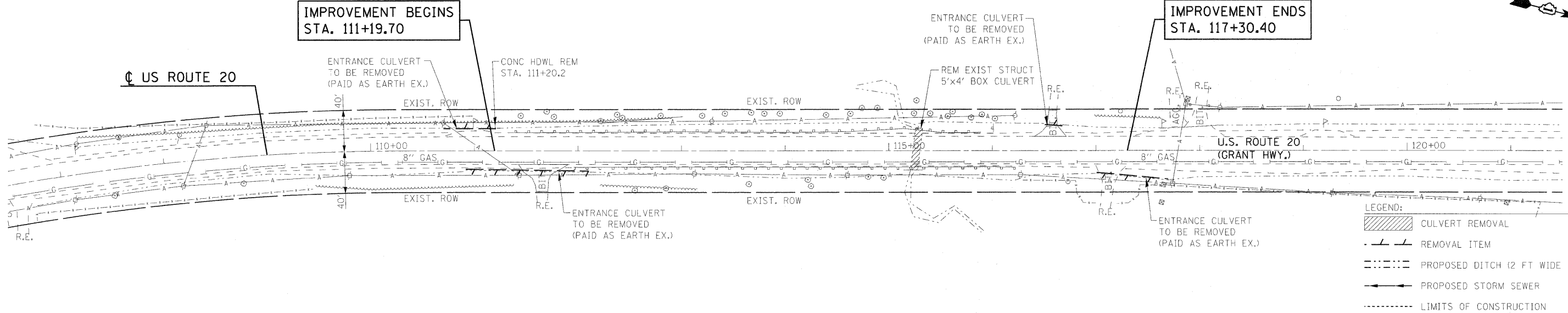

	USER NAME = 2kujawc	DESIGNED - DJB	REVISED -
	PLOT SCALE = 50.00' / IN.	DRAWN - ENTRAN	REVISED -
	PLOT DATE = 06/20/2011	CHECKED - TMH	REVISED -
STATE OF ILLINOIS DEPARTMENT OF TRANSPORTATION		FAP ROUTE 525 (US ROUTE 20) OVER DRAINAGE DITCH EXISTING AND PROPOSED DRAINAGE AND UTILITY PLAN	
SCALE: 1" = 50'	SHEET NO. OF SHEETS	STA. TO STA.	F.A.P. RTE. 525
			SECTION 11-T-1
			COUNTY McHENRY
			TOTAL SHEETS 34
			SHEET NO. 11
			CONTRACT NO. 60M53
			FED. ROAD DIST. NO. ILLINOIS FED. AID PROJECT