

CONSTRUCTION NOTES:

- 1 REMOVE EXISTING TRAFFIC SIGNAL BACKPLATE. INSTALL RETROREFLECTIVE BACKPLATE.

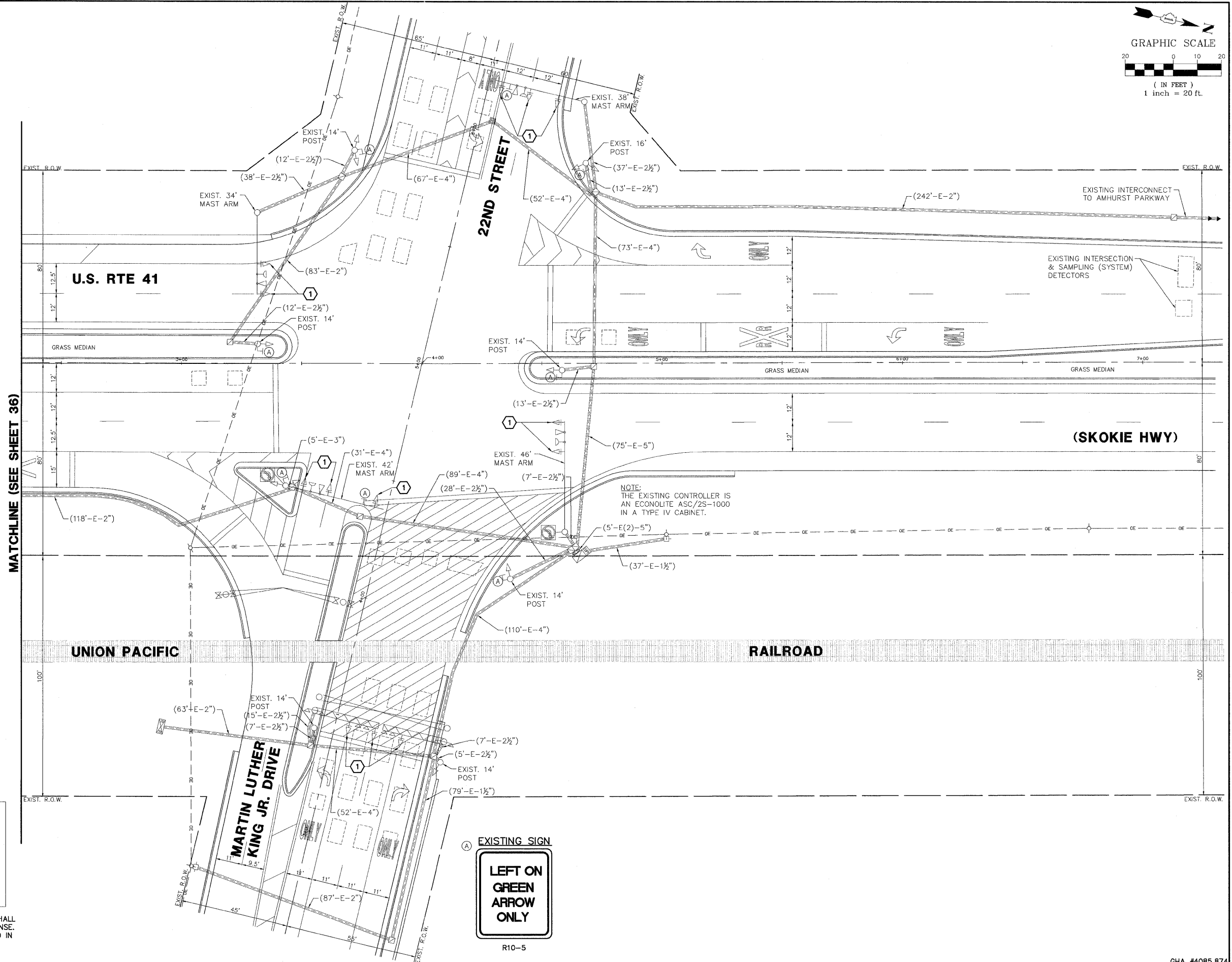
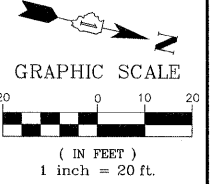

THE TRAFFIC SIGNAL CONTROL EQUIPMENT FOR THIS PROJECT SHALL BE "ECONOLITE" TO MATCH THE EXISTING ADJACENT SYSTEM.

Restoration of Work Area. Restoration of the traffic signal work area shall be incidental to the related pay items such as foundation, conduit, handhole, trench and backfill, etc., and no extra compensation shall be allowed. All roadway surfaces such as shoulders, medians, sidewalks, pavement, etc. shall be replaced in kind. All damage to mowed lawns shall be replaced with an approved sod, and all damage to unmowed fields shall be seeded in accordance with Standard Specifications 252 and 250 respectively.

THE FOLLOWING ITEMS SHALL BE REMOVED BY THE CONTRACTOR AND SHALL BE DISPOSED OF BY THEM OUTSIDE THE RIGHT-OF-WAY AT THEIR EXPENSE. THE SALVAGE VALUE OF THE REMOVED EQUIPMENT SHALL BE REFLECTED IN THE CONTRACT BID PRICE.
 13 EACH TRAFFIC SIGNAL BACKPLATE

| | | | | | | | | | | | | |
|---------------------------------|---------------------------|-------------------------------|--|---|--|---------------------|------------------------|----------------|--------------------|---------------------------|---------------------|---------------|
| FILE NAME = 4085.874-TR1.dwg | USER NAME = ZACH WALLSTEN | DESIGNED - JRD DRAWN - ZCW | REVISED - REVISED - REVISED - REVISED - | STATE OF ILLINOIS DEPARTMENT OF TRANSPORTATION | TRAFFIC SIGNAL MODERNIZATION PLAN U.S. RTE 41 (SKOKIE HIGHWAY) AT MARTIN LUTHER KING JR. DRIVE / 22ND STREET | F.A.P. RTE 346 | SECTION 2011-042-TS | COUNTY LAKE | TOTAL SHEETS 62 | SHEET NO. 35 | CONTRACT # 60P49 | GHA #4085.874 |
| PLOT SCALE = 1" = .0833' | | | | SCALE: 1"=20' | | SHEET NO. OF SHEETS | | STA. TO STA. | | ILLINOIS FED. AID PROJECT | | |