

**EXISTING STRUCTURES**

- ① FILLING INLETS  
STA. 59+02.08 42.7' LT  
RIM = 641.93  
INV = V.I.F.
- ② MANHOLES TO BE ADJUSTED  
STA. 59+18.26 0.6' LT  
PR. RIM = 641.63  
EX. RIM = 641.57  
INV = 629.28 (V.I.F.)
- ③ FILLING INLETS  
STA. 59+23.84 24.1' RT  
RIM = 640.00  
INV = V.I.F.
- ④ FILLING INLETS  
STA. 59+30.45 45.9' RT  
RIM = 639.26  
INV = V.I.F.
- ⑤ FILLING INLETS  
STA. 60+31.44 36.4' RT  
RIM = 639.00  
INV = V.I.F.

EX. MH #920  
STA. 56+10.98 0.2' RT  
RIM = 649.28

EX. MH #907  
STA. 53+38.09 0.2' RT  
RIM = 656.74

WATERS OF THE US 2

WETLAND AREA SITE 1

CLEAN EXISTING DRAINAGE SYSTEM  
EX. MH #920 TO EXISTING OUTLET

NOTE:  
CONTRACTOR TO CLEAN EXISTING DRAINAGE SYSTEM WHEN WORK IS COMPLETE.

**EXISTING CONDITION**

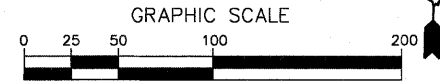

SCALE: 1"=50'

**PROPOSED STRUCTURES**

- A CATCH BASIN, TYPE A, 4' DIAMETER, TYPE 1 FRAME, OPEN LID  
STA. 58+90.12 3.5' LT  
RIM = 641.76  
INV = 634.70 (S)  
INV = 633.30 (E)  
INV = 634.70 (N)
- B INLETS, TYPE B, TYPE 1 FRAME, OPEN LID  
STA. 59+30.81 47.0' RT  
RIM = 640.83  
INV = 635.00 (N)  
INV = 635.00 (S)
- C EX. MH  
STA. 59+18.26 0.6' LT  
RIM = 641.57  
INV = 633.00 (W)  
INV = 629.28 (E) EXISTING
- D INLETS, TYPE B, TYPE 1 FRAME, OPEN LID  
STA. 58+71.68 49.6' LT  
RIM = 642.43  
INV = 635.22
- E INLETS, TYPE B, TYPE 1 FRAME, OPEN LID  
STA. 59+12.30 52.0' RT  
RIM = 639.37  
INV = 635.30

PROPOSED STORM SEWERS, CLASS A, TYPE 2 12"  
52.0' RCP @ 1%

PROPOSED STORM SEWERS, CLASS A, TYPE 2 12"  
30.0' RCP @ 1%

PROPOSED STORM SEWERS, CLASS A, TYPE 2 12"  
30.0' RCP @ 1%

PROPOSED STORM SEWERS, CLASS A, TYPE 2 12"  
30.0' RCP @ 1%

WATERS OF THE US 2

WETLAND AREA SITE 1

TEMPORARY EASEMENT 15' X 53'

**PROPOSED CONDITION**

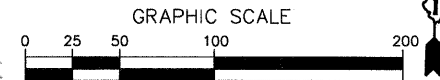

SCALE: 1"=50'

PLAN	SURVEYED	DATE
	PLOTTED	
	CHECKED	
	BY	
	NO. OF WAY CHECKED	
	DATE FILE NAME	
	NO.	

PROFILE	SURVEYED	DATE
	PLOTTED	
	CHECKED	
	BY	
	NO. OF WAY CHECKED	
	DATE FILE NAME	
	NO.	

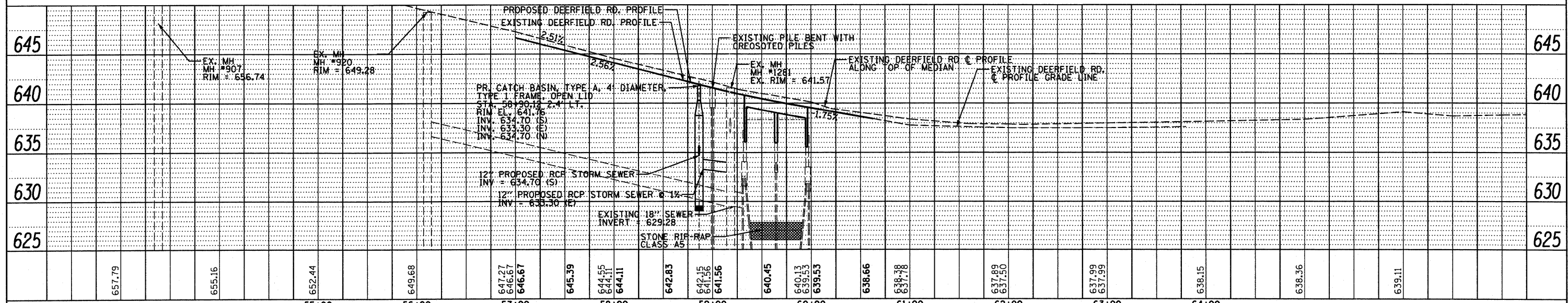

FILE NAME =	DESIGNED - MC	REVISED -	<p>STATE OF ILLINOIS DEPARTMENT OF TRANSPORTATION</p>	DRAINAGE AND UTILITIES		F.A.U. RTE.	SECTION	COUNTY	TOTAL SHEETS	SHEET NO.
... \01-62101-shd-drain-util.dgn	DRAWN - MC	REVISED -		1257	104RB-R	LAKE	54	15		
PLOT TIME = 5:01:14 PM	CHECKED - TRP	REVISED -		SCALE: 1" = 50'		SHEET NO. 1 OF 1 SHEETS		STA. 53+16.21 TO STA. 67+69.99	CONTRACT NO. 62102	
PLOT DATE = 6/23/2011	DATE - 06/24/2011	REVISED -		ILLINOIS FED. AID PROJECT						