

FILE NAME = s:\756-004\ombard - gwt bridges phase 1\cadd sheets\structural\IPRR\0223122-410-EAST BRIDGE APPROACH SLAB.dgn

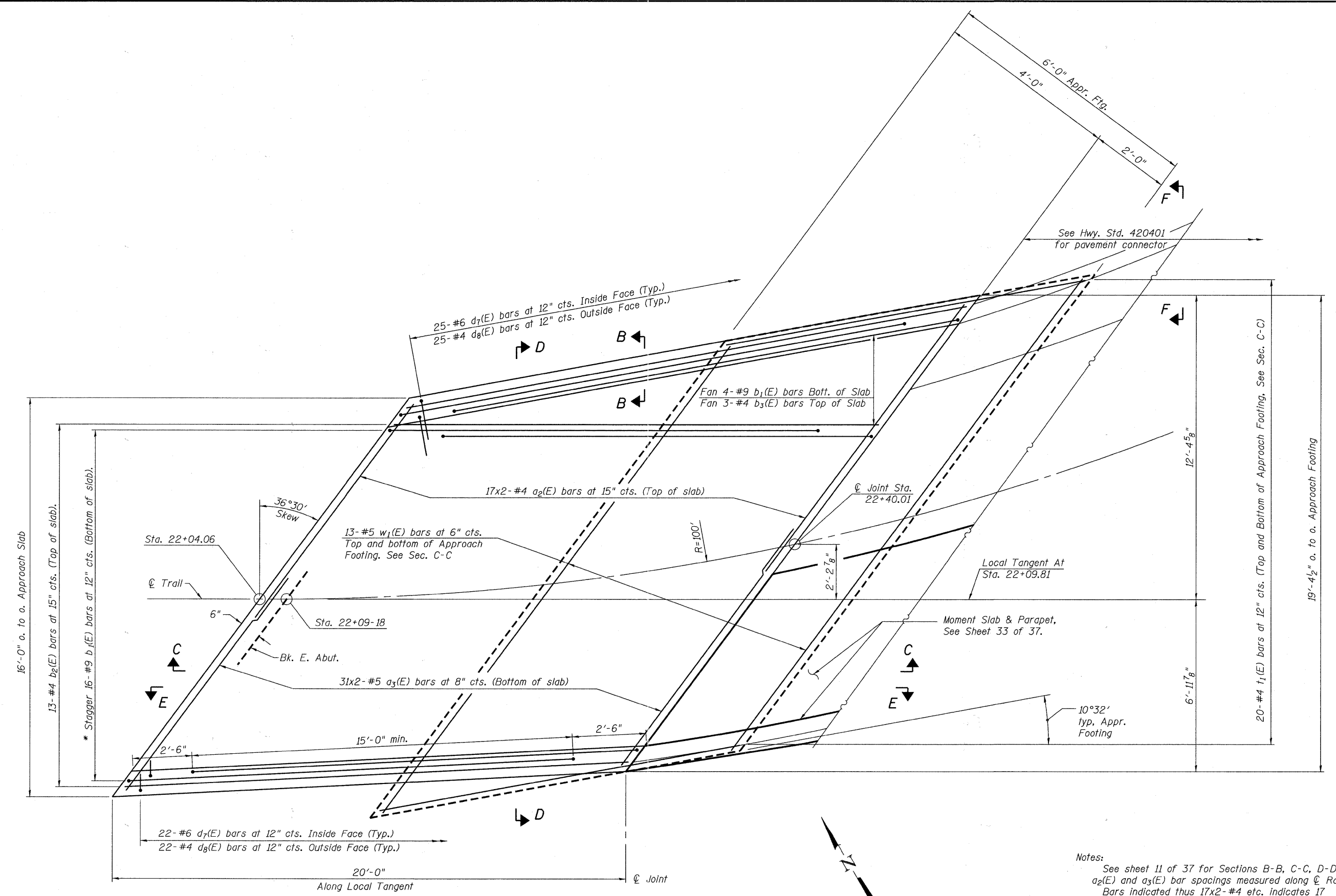

EAST APPROACH PLAN

* Tilt #9 b₁(E) bars as required to maintain clearance.

Notes:
See sheet 11 of 37 for Sections B-B, C-C, D-D, E-E and F-F.
a₂(E) and a₃(E) bar spacings measured along ϕ Rdwy.
Bars indicated thus 17x2-#4 etc. indicates 17 lines of bars with 2 length per line.

(Sheet 2 of 3)

Bollinger, Lach & Associates, Inc.
TASCA, ILLINOIS

USER NAME = gonzo	DESIGNED SRT	REVISIONS
PLOT SCALE =	CHECKED JJI	REVISIONS
PLOT DATE = 7/26/2011	DRAWN GM	REVISIONS
	CHECKED JJI	REVISIONS

DESIGNED SRT	REVISIONS
CHECKED JJI	REVISIONS
DRAWN GM	REVISIONS
CHECKED JJI	REVISIONS

**STATE OF ILLINOIS
GREAT WESTERN TRAIL
UNION PACIFIC RAILROAD**

**EAST BRIDGE APPROACH SLAB
STRUCTURE NO. 022-3122**
SHEET NO. 10 OF 37 SHEETS

F.A. RTE.	SECTION	COUNTY	TOTAL SHEETS	SHEET NO.
	06-00151-00-BR	DuPAGE	201	90
				CONTRACT NO. 63568
ILLINOIS FED. AID PROJECT				