

* Locate top row of longitudinal parapet reinforcement clear of rail post anchors, maintain minimum reinforcement clearance.

PARAPET ELEVATION
(Outside Face Shown)

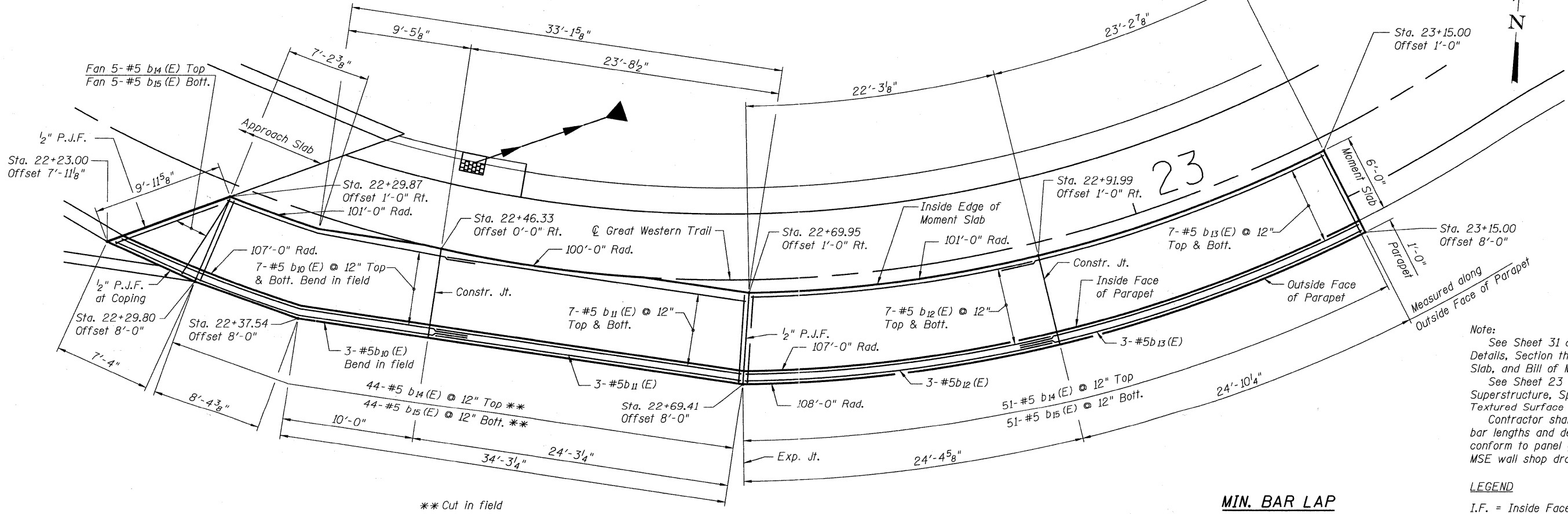

** Cut in field as required

MOMENT SLAB/PARAPET PLAN

MIN. BAR LAP
#5 bar = 2'-3"

Note:
See Sheet 31 and 32 of 37 for Wall Details, Section thru Parapet and Moment Slab, and Bill of Material.
See Sheet 23 of 37 for Concrete Superstructure, Special and Form liner Textured Surface (Special) details.
Contractor shall coordinate and adjust bar lengths and details as required to conform to panel geometry on approved MSE wall shop drawings.

LEGEND
I.F. = Inside Face
O.F. = Outside Face
E.F. = Each Face

FILE NAME = s:\756-004_tombard - gwt_bridges\phase 11\wood_sheets\structural\IPRRN\0223122-033-Parapet and Moment Slab.dgn

Bollinger, Lach & Associates, Inc.
ITASCA, ILLINOIS

USER NAME = gonzalo	DESIGNED SRT	REVISIONS
PLOT SCALE =	CHECKED JJI	REVISIONS
PLOT DATE = 7/26/2011	DRAWN GM	REVISIONS
	CHECKED JJI	REVISIONS

STATE OF ILLINOIS
GREAT WESTERN TRAIL
UNION PACIFIC RAILROAD

PARAPET AND MOMENT SLAB SOUTHEAST MSE WALL
STRUCTURE NO. 022-3122

SHEET NO. 33 OF 37 SHEETS

F.A. RTE.	SECTION	COUNTY	TOTAL SHEETS	SHEET NO.
	06-00151-00-BR	DuPAGE	201	113
			CONTRACT NO. 63568	

ILLINOIS FED. AID PROJECT