

PLAN	SURVEYED	DATE
	PLOTTED	
	NOTED	
	BY	
	DATE	
	BY	
	DATE	
	BY	
	DATE	

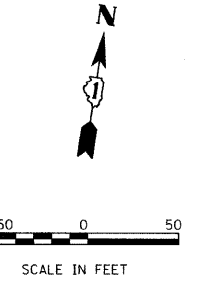

LEGEND	
	REMOVAL LIMITS (PVT, C&G, SW, AND MEDIANS)
	TREE REMOVAL
	TREE TRUNK PROTECTION
	TREE PRUNING & TREE ROOT PRUNING
	HMA SURF REM. VARIABLE DEPTH
	PCC SURF REM. (PAID FOR AS HMA SURF REM. VARIABLE DEPTH)

PROFILE	SURVEYED	DATE
	PLOTTED	
	NOTED	
	BY	
	DATE	
	BY	
	DATE	
	BY	
	DATE	

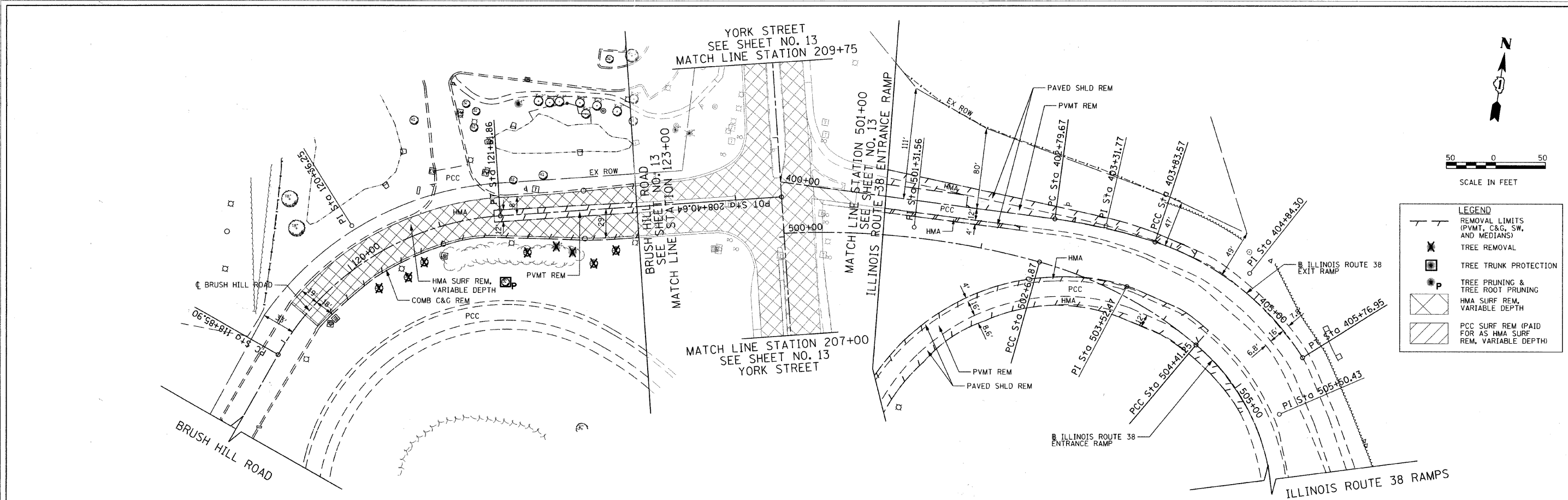
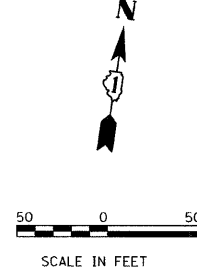
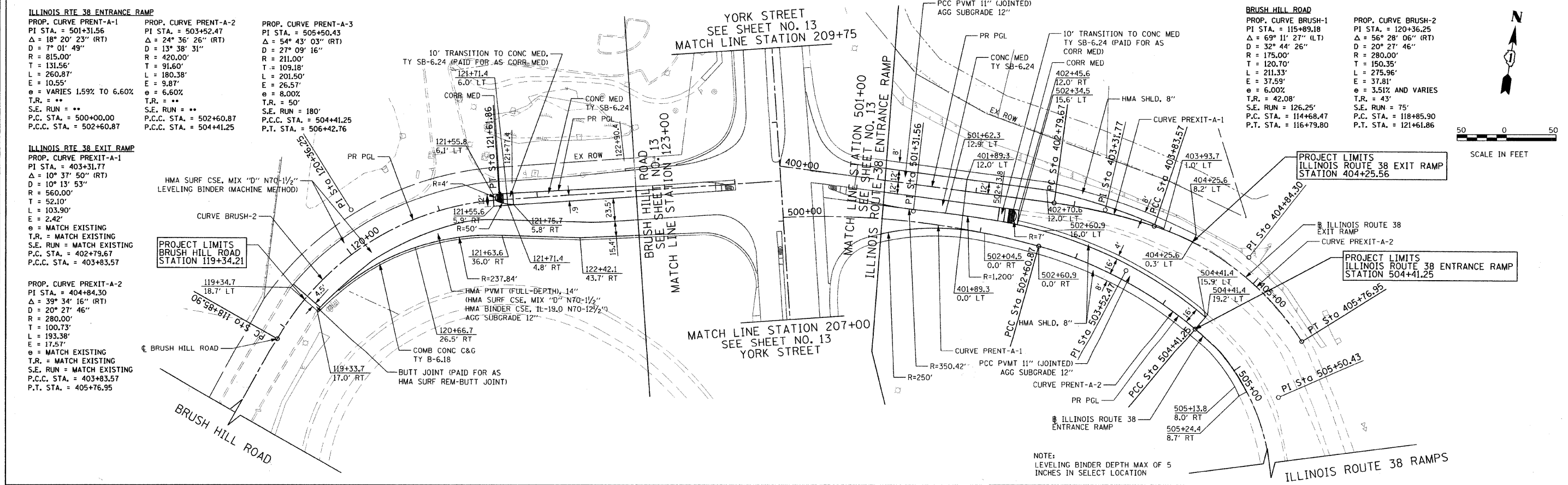

ILLINOIS RTE 38 ENTRANCE RAMP		
PROP. CURVE PRENT-A-1 PI STA. = 501+31.56 Δ = 18° 20' 23" (RT) D = 7° 01' 49" R = 815.00' T = 131.56' L = 260.87' E = 10.55' θ = VARIES 1.59% TO 6.60% T.R. = ** S.E. RUN = ** P.C. STA. = 500+00.00 P.C.C. STA. = 502+60.87	PROP. CURVE PRENT-A-2 PI STA. = 503+52.47 Δ = 24° 36' 26" (RT) D = 13° 38' 31" R = 420.00' T = 91.60' L = 180.38' E = 9.87' θ = 6.60% T.R. = ** S.E. RUN = ** P.C.C. STA. = 502+60.87 P.C.C. STA. = 504+41.25	PROP. CURVE PRENT-A-3 PI STA. = 505+50.43 Δ = 54° 43' 03" (RT) D = 27° 09' 16" R = 211.00' T = 109.18' L = 201.50' E = 26.57' θ = 8.00% T.R. = 50' S.E. RUN = 180' P.C.C. STA. = 504+41.25 P.T. STA. = 506+42.76

ILLINOIS RTE 38 EXIT RAMP	
PROP. CURVE PREXIT-A-1 PI STA. = 403+31.77 Δ = 10° 37' 50" (RT) D = 10° 13' 53" R = 560.00' T = 52.10' L = 103.90' E = 2.42' θ = MATCH EXISTING T.R. = MATCH EXISTING S.E. RUN = MATCH EXISTING P.C. STA. = 402+79.67 P.C.C. STA. = 403+83.57	PROP. CURVE BRUSH-1 PI STA. = 115+89.18 Δ = 69° 11' 27" (LT) D = 32° 44' 26" R = 175.00' T = 120.70' L = 211.33' E = 37.59' θ = 6.00% T.R. = 42.08' S.E. RUN = 126.25' P.C. STA. = 114+68.47 P.T. STA. = 116+79.80

PROP. CURVE PREXIT-A-2	
PI STA. = 404+84.30 Δ = 39° 34' 16" (RT) D = 20° 27' 46" R = 280.00' T = 100.73' L = 193.38' E = 17.57' θ = MATCH EXISTING T.R. = MATCH EXISTING S.E. RUN = MATCH EXISTING P.C. STA. = 403+83.57 P.T. STA. = 405+76.95	PROP. CURVE BRUSH-2 PI STA. = 120+36.25 Δ = 56° 28' 06" (RT) D = 20° 27' 46" R = 280.00' T = 150.35' L = 275.96' E = 37.81' θ = 3.51% AND VARIES T.R. = 43' S.E. RUN = 75' P.C. STA. = 118+85.90 P.T. STA. = 121+61.86

NOTE: LEVELING BINDER DEPTH MAX OF 5 INCHES IN SELECT LOCATION

FILE NAME = g:\ch\08\0007\road\phase 2\sheet\01X0007	USER NAME = jingoemba	DESIGNED - TKH	REVISED -	<b>STATE OF ILLINOIS DEPARTMENT OF TRANSPORTATION</b>	<b>YORK STREET AT IL RTE 38 RAMPS/BRUSH HILL ROAD REMOVAL PLAN AND ROADWAY PLAN</b>			F.A.U. RTE. 2678	SECTION 09-00171-00-CH	COUNTY	TOTAL SHEETS 85	SHEET NO. 14
PLOT SCALE = 5/8"=1'-0"	PLOT DATE = 6/4/2011	DRAWN - TKH	REVISED -		SCALE: 1"=50'	SHEET NO. 14 OF 85 SHEETS	STA. 118+00	TO STA. 506+00	CONTRACT NO. 63610			
		CHECKED - JMG	REVISED -		FED. ROAD DIST. NO. 7 ILLINOIS FED. AID PROJECT							
		DATE - 7/4/2011	REVISED -									