

DATE	
BY	
FINAL SURVEY	SURVEYED
NOTE BOOK	PLOTTED
NO.	TEMPLATE
	AREAS CHECKED

DATE	
BY	
ORIGINAL SURVEY	SURVEYED
NOTE BOOK	PLOTTED
NO.	TEMPLATE
	AREAS CHECKED

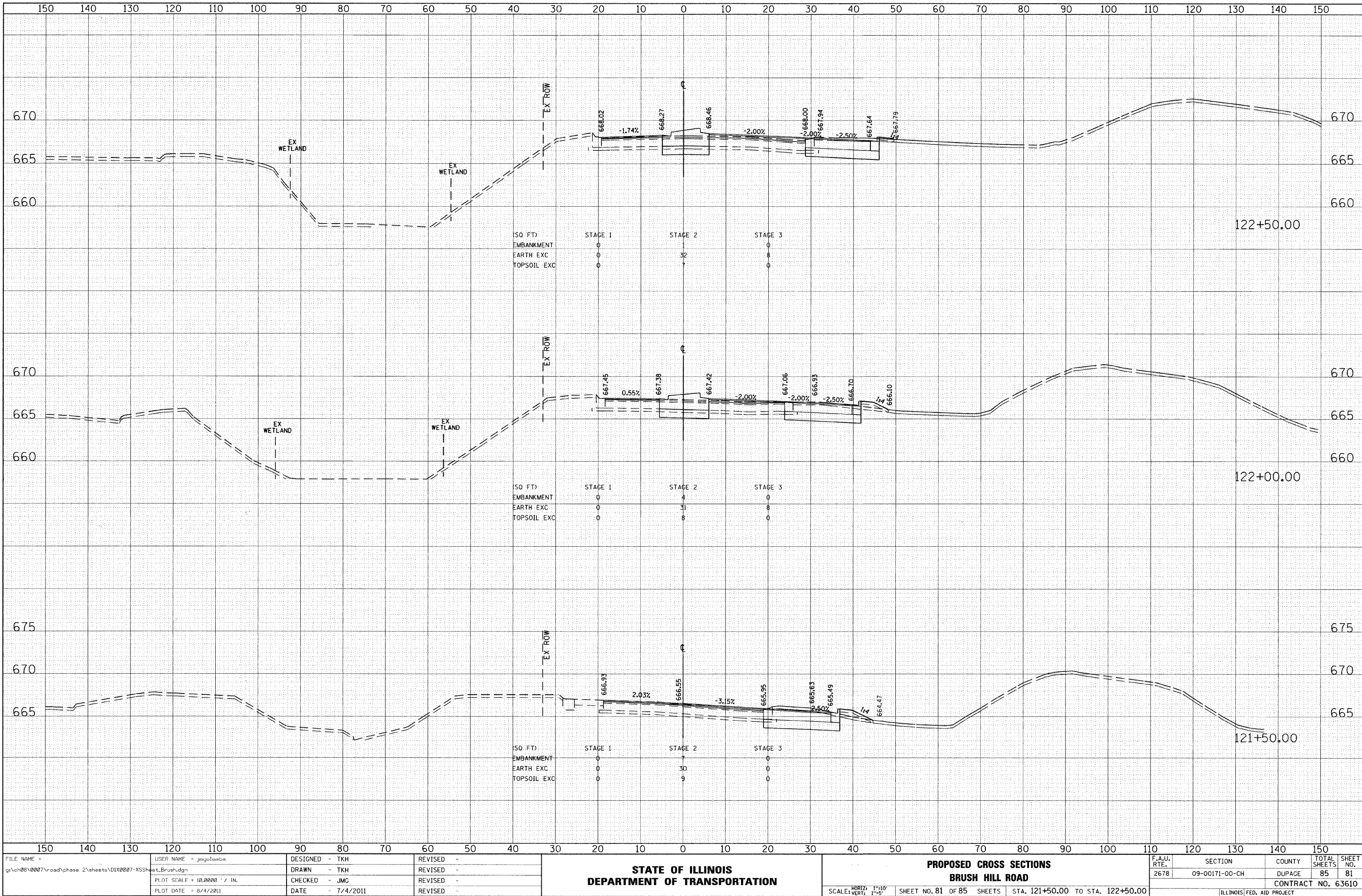

FILE NAME = g:\ch\08\0007\road\phase 2\sheet\01X0007-XSSheet1.Brush.dgn

USER NAME = jmgolamba
 PLOT SCALE = 10.0000' / IN.
 PLOT DATE = 8/4/2011

DESIGNED - TKH
 DRAWN - TKH
 CHECKED - JMG
 DATE - 7/4/2011

REVISED -
 REVISED -
 REVISED -
 REVISED -

**STATE OF ILLINOIS
 DEPARTMENT OF TRANSPORTATION**

**PROPOSED CROSS SECTIONS
 BRUSH HILL ROAD**

SCALE: HORIZ: 1"=10'
 VERT: 1"=5'

SHEET NO. 81 OF 85 SHEETS STA. 121+50.00 TO STA. 122+50.00

F.A.U. RTE.	SECTION	COUNTY	TOTAL SHEETS	SHEET NO.
2678	09-00171-00-CH	DUPAGE	85	81
				CONTRACT NO. 63610
ILLINOIS FED. AID PROJECT				