

EXISTING CONDITIONS

NOTES:

- EXISTING HMA DRIVEWAY TO BE RESTORED WITH HMA BASE COURSE, 6" & 2" HMA SURFACE PAVEMENT COURSE, MIX C N50.
- PAVEMENT SAWCUT & CLASS D PATCH FOR STORM SEWER PIPE INSTALLATION, AS DIRECTED BY THE ENGINEER.
- ONE OF THE EXISTING GRANULAR DRIVEWAYS SHOULD BE ELIMINATED. COORDINATE WITH THE PROPERTY OWNER AND THE ENGINEER.

STORM INLETS

ST-IN 2
INLET, TY A, TY 8 GRATE
STA 264+68, 24.5' RT
RIM 666.80
INV 663.30 12" N

ST-IN 3
INLET, TY A, TY 8 GRATE
STA 266+92, 24.5' RT
RIM 663.60
INV 660.20 12" N

STORM CATCHBASINS

ST-CB 3
CATCH BASIN, TY C, 2' DIA, TY 8 GRATE
STA 264+70, 14' RT
RIM 668.60
INV 667.80 12" N, 8" S

ST-CB 4
CATCH BASIN, TY A, 4' DIA, TY 1 F, CL
STA 262+15, 14' RT
RIM 662.40
INV 666.00 15" E, 12" S

ST-CB 5
CATCH BASIN, TY A, 4' DIA, TY 1 F, OL
STA 264+70, 14' RT
RIM 668.60
INV 663.00 18" E, 15" W, 12" S

ST-CB 6
CATCH BASIN, TY A, 4' DIA, TY 1 F, OL
STA 266+89, 14' RT
RIM 662.20
INV 660.00 18" W, E, 12" S

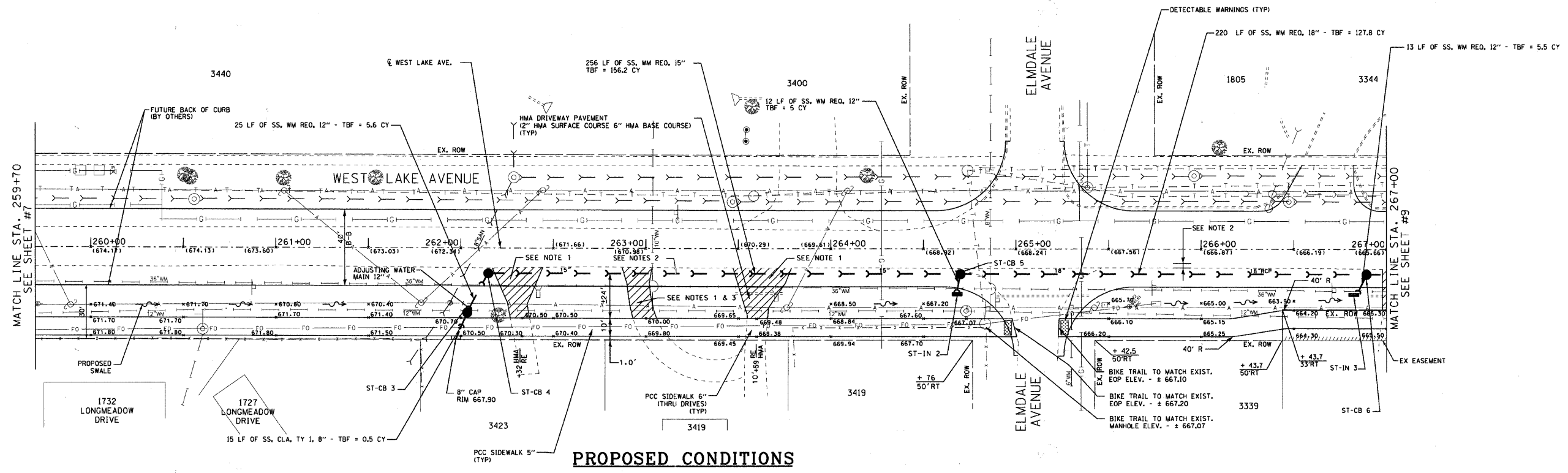

PROPOSED CONDITIONS

CAPITAL PROJECTS DEPARTMENT

DISCLAIMER
The attached files contain information for the exclusive use of the individual or entity to whom they are addressed and may contain information that is proprietary, privileged, confidential and/or exempt from disclosure. The addressee must protect any and all proprietary, privileged, confidential and/or exempt information from disclosure. Any unauthorized use, misuse or sharing of data is a violation of applicable copyright laws. The Village makes no warranty or other representation regarding the use of the attached files for any purpose other than that for which they are originally transmitted.



WEST LAKE AVENUE
CENTENNIAL BIKE TRAIL - SEGMENT #1
SITE PLAN - EXISTING & PROPOSED CONDITIONS
STA. 259+70 TO STA. 267+00

REVISIONS		
NO.	DATE	DESCRIPTION
1	4-18-11	PER IDOT COMMENTS
2	8-28-11	PER IDOT COMMENTS

DESIGNED BY: E.L.	F.A.U. RTE.	SECTION	COUNTY	TOTAL SHEETS	SHEET NO.
DATE: 11-10-2010	1284	07-00164-01-RS	COOK	34	8
DRAWN BY: Z.S.					
DATE: 11-10-2010					
CHECKED BY: E.L.	JOB NO: C-91-275-11	FED. AID PROJECT: TE-00D1 (841)			
DATE: 2-24-2011	FED. ROAD DIST. NO. 1	ILLINOIS CONTRACT NO. 83612			

COPYRIGHT © 2011 BY BUREAU OF ENGINEERING & SURVEYING, INC. ALL RIGHTS RESERVED. THIS DRAWING IS THE PROPERTY OF BUREAU OF ENGINEERING & SURVEYING, INC. AND IS NOT TO BE REPRODUCED OR TRANSMITTED IN ANY FORM OR BY ANY MEANS, ELECTRONIC OR MECHANICAL, INCLUDING PHOTOCOPYING, RECORDING, OR BY ANY INFORMATION STORAGE AND RETRIEVAL SYSTEM, WITHOUT THE WRITTEN PERMISSION OF BUREAU OF ENGINEERING & SURVEYING, INC.