

TEMPORARY TRAFFIC SIGNS

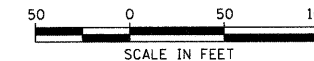

1. **NO TURN ON RED** R10-11A-2430
 LOCATIONS:
 1. TRAFFIC SIGNAL POST IN NORTHEAST CORNER FACING WEST.
 2. EASTBOUND MAST ARM 3' SOUTH OF THE OUTER SIGNAL HEAD FACING WEST.

2. **ONE WAY** R6-2-2430
 LOCATIONS:
 1. TRAFFIC SIGNAL POST IN NORTHEAST CORNER FACING EAST.

2A. **ONE WAY** R6-2-2430
 LOCATIONS:
 1. TRAFFIC SIGNAL POST IN SOUTHWEST CORNER FACING EAST.

3. **ONLY** R3-5R-3036

3A. **30 MIN PARKING** R7-115-1218

4. **DO NOT ENTER** R5-1-3030
 LOCATIONS:
 1. MOUNTED ON SPAN WIRE FACING EAST AND CENTERED OVER WESTBOUND RIGHT-TURN LANE.

5. **STOP** R1-1-36

6. **3 WAY** R1-3-3-126

7. **W3-1A-36**

8. **W6-3-36**

9A. **R3-8-3636**

9B. **R3-8-3636**

10. **CROSS TRAFFIC DOES NOT STOP** R1-1100-3018
 MOUNT BELOW STOP SIGN ON WATER STREET AT BENTON STREET

11. **R3-8-3636**

12. **TEMPORARY INFORMATION SIGNING**
 SIDEWALK OPEN TO BUSINESSES
 SIDEWALK CLOSED AT BRIDGE

13. **ALL WAY** R4-1-186

14. **ROAD CONSTRUCTION AHEAD** W20-1(10)-48

15. **M6-1(10)-2115**

16. **ROAD CLOSED** R11-2-4830

17. **ROAD CLOSED TO THRU TRAFFIC** R11-4-6030

18A. **RIVERWALK OPEN AT DOWNER PLACE**

18B. **RIVERWALK CLOSED AT DOWNER PLACE**

19. **DETOUR** M4-9L(10)-3024

20. **DETOUR** M4-9(10)-3024

21. **ACCESS TO DOWNER PL ON STOLP ISLAND** M6-1R(10)-2115

22. **ACCESS TO DOWNER PL ON STOLP ISLAND** M6-1R(10)-2115

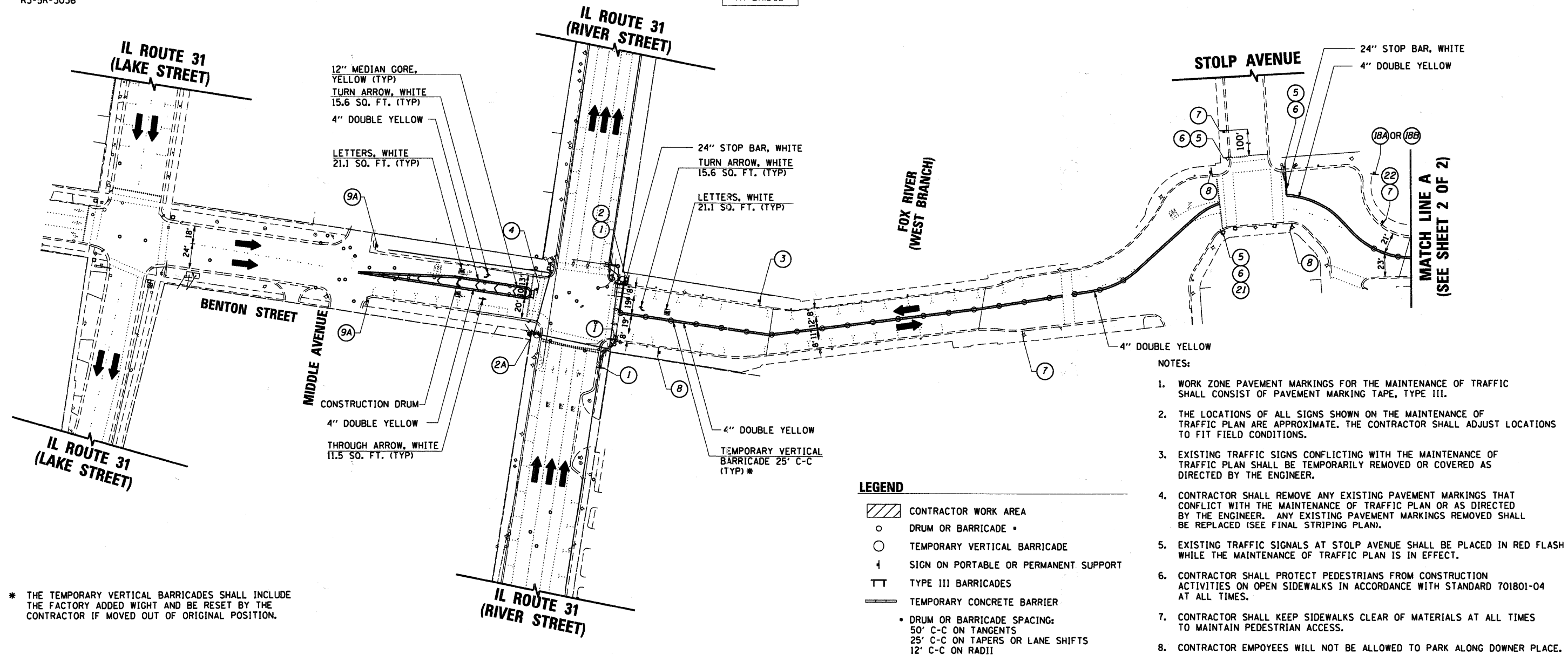

* THE TEMPORARY VERTICAL BARRICADES SHALL INCLUDE THE FACTORY ADDED WIGHT AND BE RESET BY THE CONTRACTOR IF MOVED OUT OF ORIGINAL POSITION.

- NOTES:
1. WORK ZONE PAVEMENT MARKINGS FOR THE MAINTENANCE OF TRAFFIC SHALL CONSIST OF PAVEMENT MARKING TAPE, TYPE III.
 2. THE LOCATIONS OF ALL SIGNS SHOWN ON THE MAINTENANCE OF TRAFFIC PLAN ARE APPROXIMATE. THE CONTRACTOR SHALL ADJUST LOCATIONS TO FIT FIELD CONDITIONS.
 3. EXISTING TRAFFIC SIGNS CONFLICTING WITH THE MAINTENANCE OF TRAFFIC PLAN SHALL BE TEMPORARILY REMOVED OR COVERED AS DIRECTED BY THE ENGINEER.
 4. CONTRACTOR SHALL REMOVE ANY EXISTING PAVEMENT MARKINGS THAT CONFLICT WITH THE MAINTENANCE OF TRAFFIC PLAN OR AS DIRECTED BY THE ENGINEER. ANY EXISTING PAVEMENT MARKINGS REMOVED SHALL BE REPLACED (SEE FINAL STRIPING PLAN).
 5. EXISTING TRAFFIC SIGNALS AT STOLP AVENUE SHALL BE PLACED IN RED FLASH WHILE THE MAINTENANCE OF TRAFFIC PLAN IS IN EFFECT.
 6. CONTRACTOR SHALL PROTECT PEDESTRIANS FROM CONSTRUCTION ACTIVITIES ON OPEN SIDEWALKS IN ACCORDANCE WITH STANDARD 701801-04 AT ALL TIMES.
 7. CONTRACTOR SHALL KEEP SIDEWALKS CLEAR OF MATERIALS AT ALL TIMES TO MAINTAIN PEDESTRIAN ACCESS.
 8. CONTRACTOR EMPLOYEES WILL NOT BE ALLOWED TO PARK ALONG DOWNER PLACE.

LEGEND

- CONTRACTOR WORK AREA
- DRUM OR BARRICADE
- TEMPORARY VERTICAL BARRICADE
- SIGN ON PORTABLE OR PERMANENT SUPPORT
- TYPE III BARRICADES
- TEMPORARY CONCRETE BARRIER

• DRUM OR BARRICADE SPACING:
 50' C-C ON TANGENTS
 25' C-C ON TAPERS OR LANE SHIFTS
 12' C-C ON RADII

HRGreen
 PROJECT CONTACT: Michael G. Herdich
 CLIENT: City of Aurora
 DATE PLOTTED: 7/26/2011 10:54:46 AM
 FILE: R11-4-6030-11-101-01.bentondgn
 PLOT DRIVER: default
 PEN TABLE: Stract_22x34.tbl

HRGreen.com Illinois Professional Design Firm # 184-001322	USER NAME = whood FILE NAME = 86898472-mot_01.bentondgn PLOT SCALE = PLOT DATE = 7/26/2011	DESIGNED - JMR DRAWN - JMR CHECKED - APS DATE - 7/26/11	REVISED - REVISED - REVISED - REVISED -	CITY OF AURORA SUGGESTED MAINTENANCE OF TRAFFIC PLAN BENTON STREET	SCALE: SHEET NO. 1 OF 2 SHEETS STA. TO STA.	F.A.U. RTE. SECTION COUNTY TOTAL SHEETS SHEET NO.	07-00264-00-BR KANE 164 15	CONTRACT NO. 63620 FED. ROAD DIST. NO. ILLINOIS FED. AID PROJECT
	* THE TEMPORARY VERTICAL BARRICADES SHALL INCLUDE THE FACTORY ADDED WIGHT AND BE RESET BY THE CONTRACTOR IF MOVED OUT OF ORIGINAL POSITION.				MATCH LINE A (SEE SHEET 2 OF 2)			