

PLAN - N.W. CORNER OF WEST ABUTMENT
Railing not shown for clarity

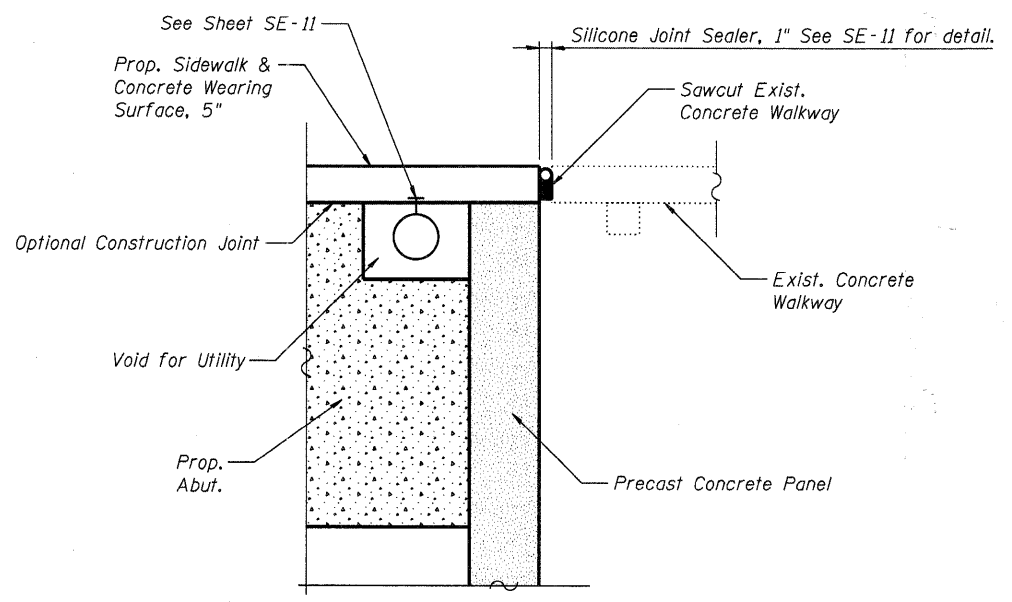

SECTION E-E

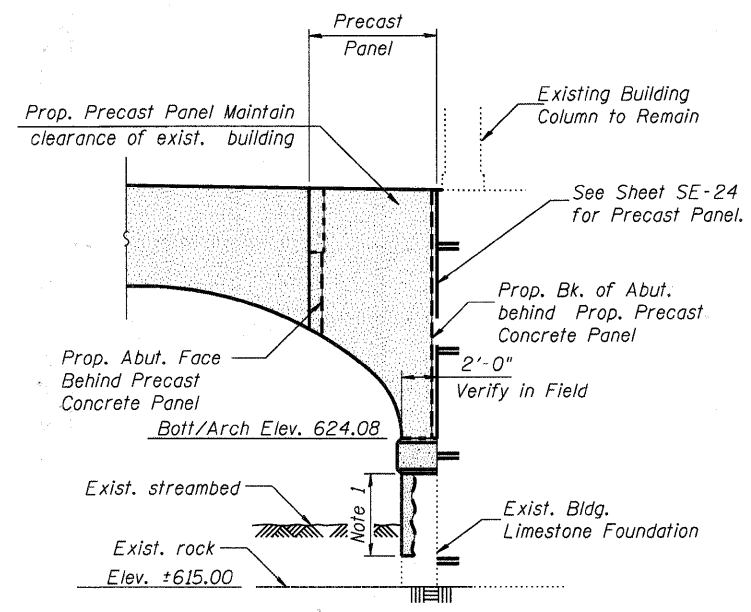

ELEVATION AT N.W. CORNER OF WEST ABUTMENT

- Parallel to Roadway &
- Railing not shown for clarity

HRGreen
G. Harding
City of Aurora
7/26/2011 10:06:00 AM
86090472-0-Ab11ncv-dgn
pdf.plt
Struct 22x34.tbl

HRGreen.com
Illinois Professional Design Firm
#194-01322

USER NAME = whoad	DESIGNED - JMW	REVISED -
PLOT SCALE = N.T.S.	CHECKED - RGD	REVISED -
PLOT DATE = 7/26/2011	DRAWN - WJH	REVISED -
	CHECKED -	REVISED -

CITY OF AURORA
DOWNER PLACE OVER THE EAST BRANCH
OF THE FOX RIVER

NORTHWEST CORNER DETAILS
STRUCTURE NO. 045-6005
SHEET NO. SE-32 OF SE-45 SHEETS

F.A. RTE.	SECTION	COUNTY	TOTAL SHEETS	SHEET NO.
	07-00264-00-BR	KANE	164	132
CONTRACT NO. 63620				
[ILLINOIS] FED. AID PROJECT				

Notes:
1. Structural Repair of Concrete, See SE-6
2. See next sheet for Sections C-C and D-D