

DATE	
BY	
REVIEWED	
PLANNED	
ALIGNED	
CHECKED	
NOTE BOOK	
NO.	
FILE NAME	
NO.	

DATE	
BY	
REVIEWED	
PLANNED	
ALIGNED	
CHECKED	
NOTE BOOK	
NO.	
FILE NAME	
NO.	

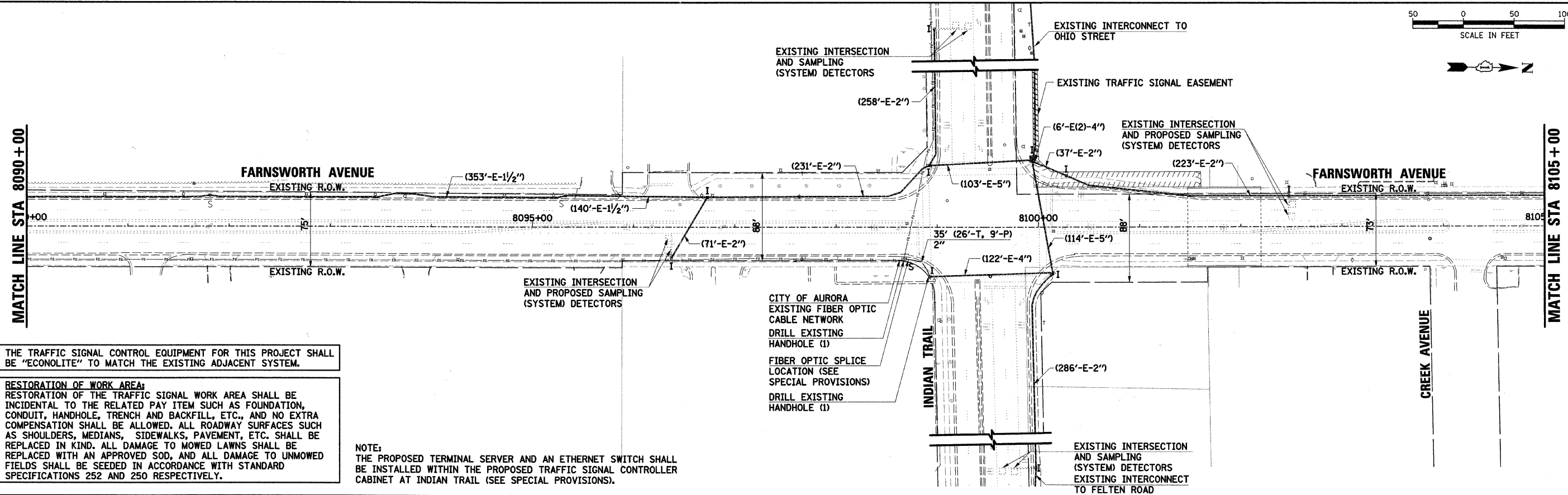
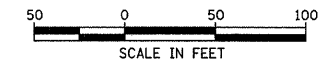

THE TRAFFIC SIGNAL CONTROL EQUIPMENT FOR THIS PROJECT SHALL BE "ECONOLITE" TO MATCH THE EXISTING ADJACENT SYSTEM.

**RESTORATION OF WORK AREA:**  
 RESTORATION OF THE TRAFFIC SIGNAL WORK AREA SHALL BE INCIDENTAL TO THE RELATED PAY ITEM SUCH AS FOUNDATION, CONDUIT, HANDHOLE, TRENCH AND BACKFILL, ETC., AND NO EXTRA COMPENSATION SHALL BE ALLOWED. ALL ROADWAY SURFACES SUCH AS SHOULDERS, MEDIANS, SIDEWALKS, PAVEMENT, ETC. SHALL BE REPLACED IN KIND. ALL DAMAGE TO MOWED LAWNS SHALL BE REPLACED WITH AN APPROVED SOD, AND ALL DAMAGE TO UNMOWED FIELDS SHALL BE SEEDED IN ACCORDANCE WITH STANDARD SPECIFICATIONS 252 AND 250 RESPECTIVELY.

**NOTE:**  
 THE PROPOSED TERMINAL SERVER AND AN ETHERNET SWITCH SHALL BE INSTALLED WITHIN THE PROPOSED TRAFFIC SIGNAL CONTROLLER CABINET AT INDIAN TRAIL (SEE SPECIAL PROVISIONS).

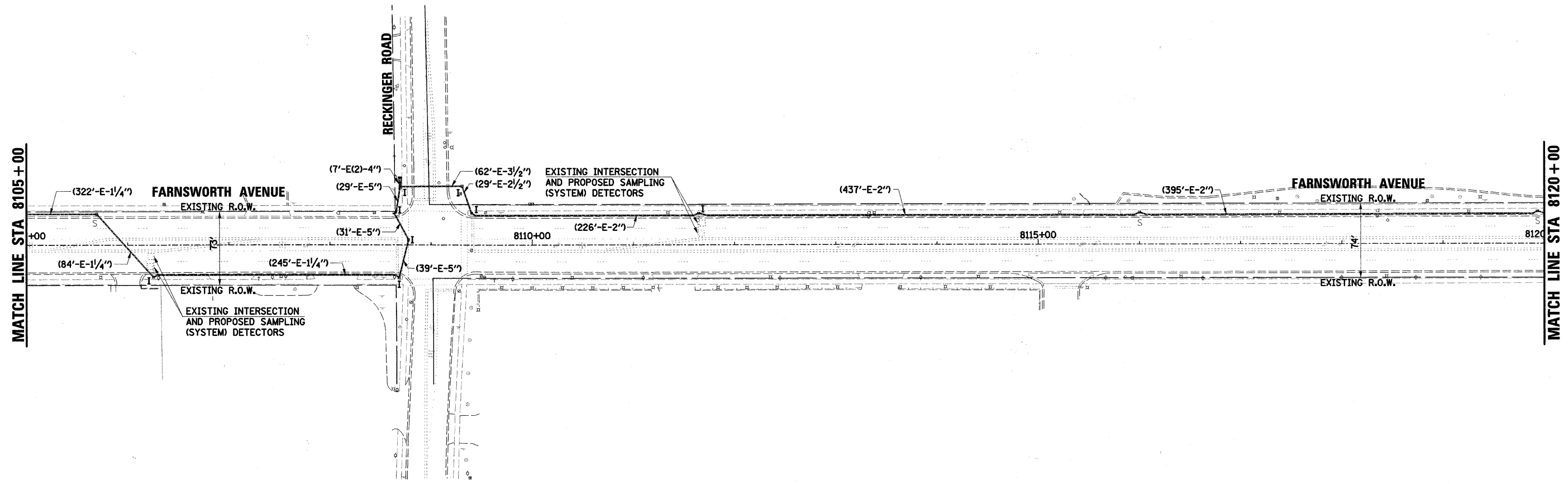

USER NAME = Mfeller	DESIGNED JRS	REVISED -
PLOT SCALE =	DRAWN JRS	REVISED -
PLOT DATE = 7/1/2011	CHECKED APS	REVISED -
	DATE -	REVISED -

STATE OF ILLINOIS  
 DEPARTMENT OF TRANSPORTATION

INTERCONNECT PLAN  
 SHEET 4 OF 5

SCALE:	SHEET NO.	OF SHEETS	STA.	TO STA.
--------	-----------	-----------	------	---------

F.A.P. RTE.	SECTION	COUNTY	TOTAL SHEETS	SHEET NO.
360	09-00289-00-TL	KANE	37	31
FED. ROAD DIST. NO.			ILLINOIS FED. AID PROJECT	
			CONTRACT NO. 63627	