

EXIST. CURVE 23N38-1
 PI STA. = 25+81.10
 $\Delta = 21^\circ 34' 32''$ (RT)
 D = 35° 59' 31"
 R = 159.19'
 T = 30.33'
 L = 59.95'
 E = 2.86'
 P.C. STA. = 25+50.77
 P.T. STA. = 26+10.71

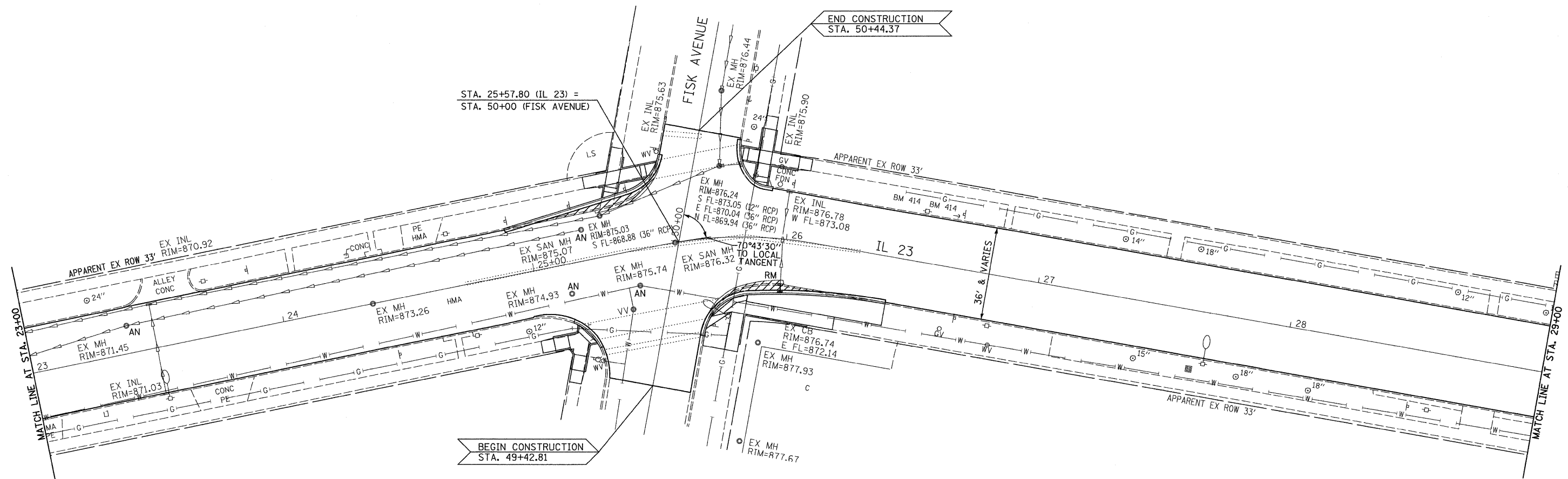

- X - TREE REMOVAL
- A - ADJUST
- AN - ADJUST WITH NEW FRAME & LID
- R - REMOVE
- RM - REMOVE TO MAINTAIN FLOW

BENCHMARK #414:
 RR SPIKE IN GUY POLE
 @ HSE 424
 EL.=879.53

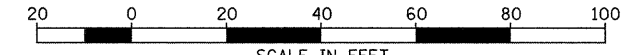
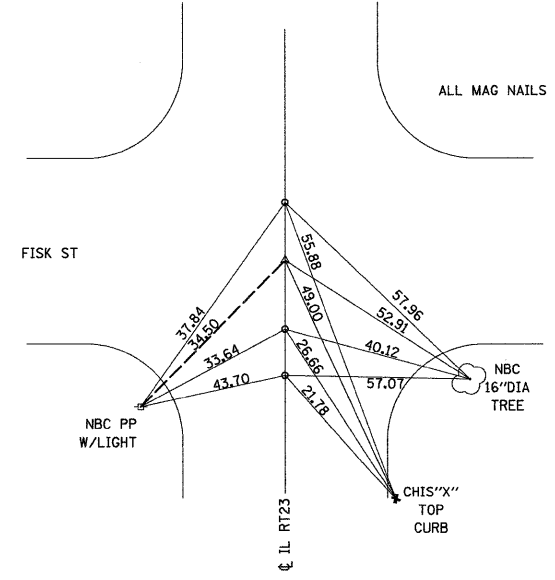

STA.25+57.80 RT23
 50+00.00 FISK
 PC 25+50.77
 PI 25+81.10
 PT 26+10.71

FILE NAME = D366983-SHT-PLAN-23-29.DGN	USER NAME = ---	DESIGNED - DJD	REVISED - ---	STATE OF ILLINOIS DEPARTMENT OF TRANSPORTATION	PLAN - IL 23	F.A.P. RTE. = 68	SECTION (28)N, TS & I	COUNTY DEKALB	TOTAL SHEETS 120	SHEET NO. 17
PLOT SCALE = 1"=20'	CHECKED - DJD	REVISED - ---	CONTRACT NO. 66983							
PLOT DATE = 01/11	DATE - 01/11	REVISED - ---	SCALE: 1"=20' SHEET NO. ___ OF ___ SHEETS STA. 23+00 TO STA. 29+00							
FED. ROAD DIST. NO. _ ILLINOIS FED. AID PROJECT										