

BEGIN CONSTRUCTION  
STA. 99+62.38

END CONSTRUCTION  
STA. 100+39.70

STA. 49+36.77 (IL 23) =  
STA. 100+00 (FRANKLIN STREET)

- X - TREE REMOVAL
- A - ADJUST
- AN - ADJUST WITH NEW FRAME & LID
- R - REMOVE
- RM - REMOVE TO MAINTAIN FLOW

BENCHMARK \*407:  
CHIS "X" TOP SE BOLT F.H. IN NW  
QUAD IL 23 & FRANKLIN ST.  
EL.=881.12

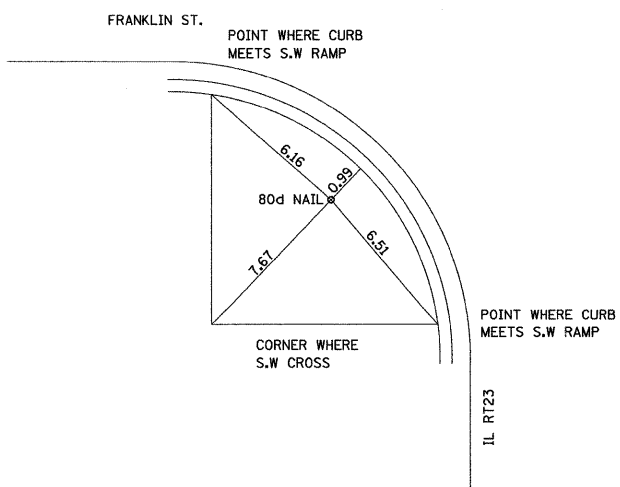

CP 23517 - STA. 49+56.93 -23,5438' RT

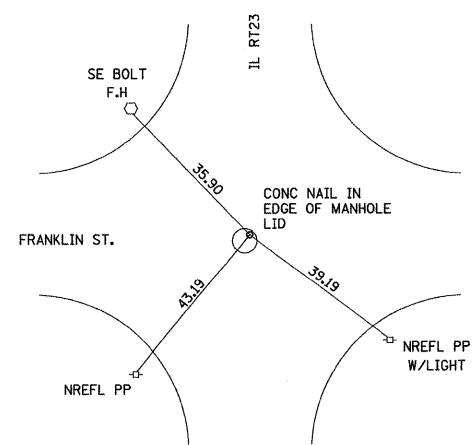

STA. 49+36.77 RT23  
100+00 FRANKLIN

FILE NAME = 0366983-SHT-PLAN-46-52.DGN	USER NAME = ---	DESIGNED - DJD	REVISED - ---	<b>STATE OF ILLINOIS DEPARTMENT OF TRANSPORTATION</b>	<b>PLAN - IL 23</b>	F.A.P. RTE. = 68	SECTION = (28)N, TS & I	COUNTY = DEKALB	TOTAL SHEETS = 120	SHEET NO. = 21
PLOT SCALE = 1"=20'	CHECKED - DJD	REVISED - ---	CONTRACT NO. 66983							
PLOT DATE = 01/11	DATE = 01/11	REVISED - ---	FED. ROAD DIST. NO. - ILLINOIS FED. AID PROJECT							
						SCALE: 1"=20'    SHEET NO. ___ OF ___ SHEETS    STA. 46+00 TO STA. 52+00				