

EXIST. CURVE 23N38-1  
 PI STA. = 25+81.10  
 $\Delta = 21^\circ 34' 32''$  (RT)  
 $D = 35^\circ 59' 31''$   
 $R = 159.19'$   
 $T = 30.33'$   
 $L = 59.95'$   
 $E = 2.86'$   
 P.C. STA. = 25+50.77  
 P.T. STA. = 26+10.71

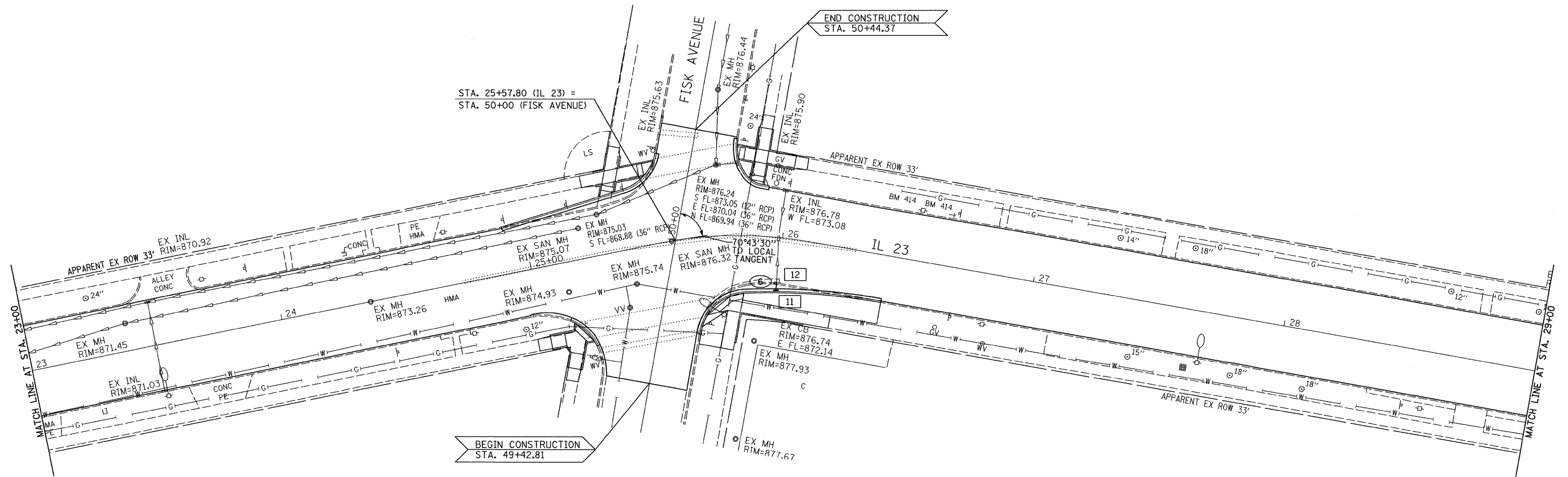
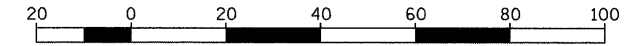

BENCHMARK #414:  
 RR SPIKE IN GUY POLE  
 @ HSE 424  
 EL.=879.53

NOTE: INLET RIM ELEVATIONS ARE AT  
 EDGE OF PAVEMENT.  
 STATIONS AND OFFSETS ARE AT  
 BACK OF CURB.

STRUCTURE NO.	11	12
STA	25+99.72	25+99.50
OFFSET	21.71' RT.	18.40' RT.
STRUCTURE TYPE	I-A	EX CB
F&G TYPE	3	--
RIM ELEVATION	876.83	876.74
EAST INVERT	872.18	876.14
WEST INVERT	--	--
NORTH INVERT	--	--
SOUTH INVERT	--	--
PIPE NUMBER	6	--
SIZE	12"	--
LENGTH	4'	--
CLASS	A	--
TYPE	1	--
% SLOPE	1%	--
TRENCH BACKFILL	1.2	--

FILE NAME =  
 D366983-SHT-DRAIN-23-29.DGN

USER NAME = ---  
 PLOT SCALE = 1"=20'  
 PLOT DATE = 01/11

DESIGNED - DJD  
 DRAWN - NV  
 CHECKED - DJD  
 DATE - 01/11

REVISED - ---  
 REVISED - ---  
 REVISED - ---  
 REVISED - ---

**STATE OF ILLINOIS  
 DEPARTMENT OF TRANSPORTATION**

**DRAINAGE AND UTILITY PLAN**

SCALE: 1"=20' SHEET NO. \_\_\_ OF \_\_\_ SHEETS STA. 23+00 TO STA. 29+00

F.A.P. RTE.	SECTION	COUNTY	TOTAL SHEETS	SHEET NO.
68	(28)N, TS & I	DEKALB	120	28
CONTRACT NO. 66983				
FED. ROAD DIST. NO. - ILLINOIS FED. AID PROJECT				