

- DETECTABLE WARNING
- SIDEWALK REMOVAL
- DRIVEWAY REMOVAL
- SODDING
- PAVEMENT PATCH
- M.E. MATCH EXISTING

SEE SHEET 92-98 FOR ADA SIDEWALK ACCESSIBILITY RAMP DETAILS.

\* NOTE - REMOVE EXISTING CONCRETE SIGN & LIGHT FOUNDATIONS TO A DEPTH OF 1' BELOW PROPOSED GRADE (INCLUDED WITH COST OF DRIVEWAY PAVEMENT REMOVAL). SIGN & LIGHT POLE WILL BE REMOVED BY OTHERS.

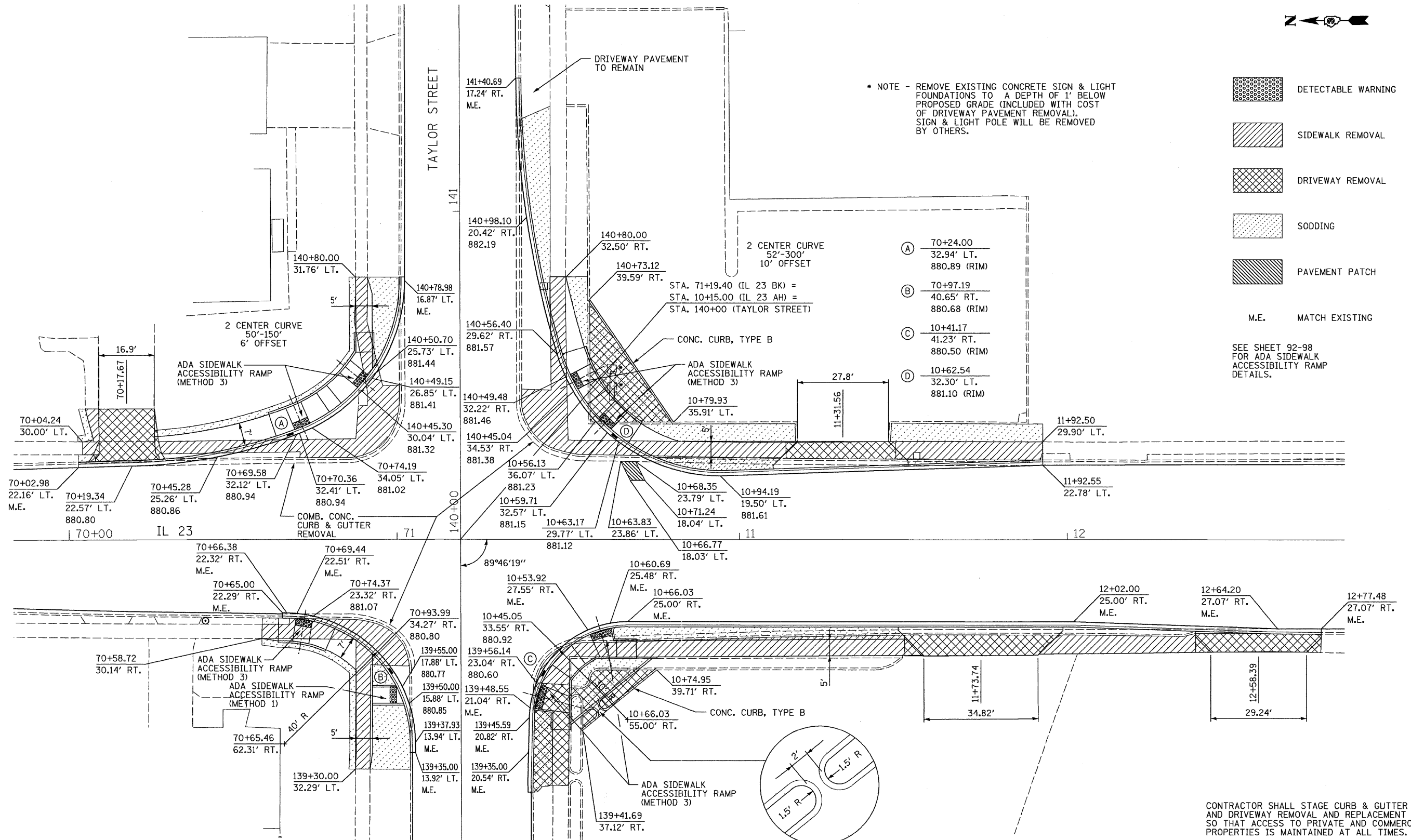

CONTRACTOR SHALL STAGE CURB & GUTTER AND DRIVEWAY REMOVAL AND REPLACEMENT SO THAT ACCESS TO PRIVATE AND COMMERCIAL PROPERTIES IS MAINTAINED AT ALL TIMES.

SEE PLAN SHEETS FOR PAVEMENT REMOVAL AND PAVEMENT WIDENING LOCATIONS.

|   |                 |                |               |   |   |                             |                |                       |               |                  |              |  |
|---|-----------------|----------------|---------------|---|---|-----------------------------|----------------|-----------------------|---------------|------------------|--------------|--|
| FILE NAME = D:\366\983-SHT-INTERSEC.DGN | USER NAME = --- | DESIGNED - DJD | REVISED - --- | <b>STATE OF ILLINOIS<br/>DEPARTMENT OF TRANSPORTATION</b> | <b>INTERSECTION DETAIL<br/>TAYLOR STREET</b>  |                             | F.A.P. RTE. 68 | SECTION (28N, TS & I) | COUNTY DEKALB | TOTAL SHEETS 120 | SHEET NO. 58 |  |
| PLOT SCALE = 1"=20'                     | CHECKED - DJD   | REVISED - ---  | REVISED - --- |   | SCALE: 1"=20'                                 | SHEET NO. ___ OF ___ SHEETS | STA. TO STA.   | CONTRACT NO. 66983    |               |                  |              |  |
| PLOT DATE = 01/11                       | DATE - 01/11    | REVISED - ---  | REVISED - --- |   | FED. ROAD DIST. NO. ILLINOIS FED. AID PROJECT |                             |                |                       |               |                  |              |  |
|   |                 |                |               |   |   |                             |                |                       |               |                  |              |  |