

CONSTRUCTION NOTES:

- MODIFY EXISTING TRAFFIC SIGNAL AND MASTER HORN CONTROLLERS AND CABINET ON EXISTING FOUNDATION.
- INSTALL UNINTERRUPTABLE POWER SUPPLY.
- REMOVE AND REPLACE EXISTING TRAFFIC SIGNAL POST ON NORTHEAST CORNER, NORTH OF RAILROAD ON NEW FOUNDATION AS SHOWN.
- REMOVE AND REPLACE TRAFFIC SIGNAL HEADS AND REMOVE AND REPLACE SOUTH FACING PEDESTRIAN SIGNAL HEAD ON EXISTING MAST ARM ASSEMBLY IN NORTHEAST CORNER, NORTH OF RAILROAD AS SHOWN.
- REMOVE AND REPLACE EXISTING COMBINATION MAST ARM AND POLE ON NORTHEAST CORNER, SOUTH OF RAILROAD ON EXISTING FOUNDATION AS SHOWN.
- REMOVE AND REPLACE COMBINATION MAST ARM AND POLE ON SOUTHEAST CORNER ON NEW FOUNDATION AS SHOWN.
- REMOVE AND REPLACE EXISTING HANDHOLE ON SOUTHEAST CORNER AS SHOWN.
- REMOVE AND REPLACE EXISTING TRAFFIC SIGNAL POST ON NEW FOUNDATION ON SOUTHEAST CORNER AS SHOWN.
- REMOVE AND REPLACE EXISTING PEDESTRIAN SIGNAL HEADS ON SOUTHEAST CORNER MOUNTED ON EXISTING LIGHT POLE AS SHOWN.
- REMOVE AND REPLACE EXISTING COMBINATION MAST ARM AND POLE ON SOUTHWEST CORNER, SOUTH OF RAILROAD ON NEW FOUNDATION AS SHOWN.
- REMOVE AND REPLACE EXISTING MAST ARM AND POLE ON SOUTHWEST CORNER, NORTH OF RAILROAD ON EXISTING FOUNDATIONS AS SHOWN.
- REMOVE AND REPLACE EXISTING COMBINATION MAST ARM AND POLE ON NORTHWEST CORNER ON NEW FOUNDATION AS SHOWN.
- INSTALL PEDESTRIAN SIGNAL HEAD ON NEW TRAFFIC SIGNAL POST ON NORTHWEST CORNER ON NEW FOUNDATION AS SHOWN.
- REMOVE AND REPLACE EXISTING TRAFFIC SIGNAL POST ON NORTHWEST CORNER ON NEW FOUNDATION AS SHOWN.
- REMOVE 2 EXISTING HANDHOLES AND INSTALL 1 NEW HANDHOLE ON NORTHWEST CORNER AS SHOWN.
- RELOCATE ALL RAILROAD CONFIRMATION SIGNALS, WAYSIDE HORNS, CABINETS AND RAILROAD WARNING SIGNAGE ONTO PROPOSED TRAFFIC SIGNAL STRUCTURES AS DIRECTED BY ENGINEER.
- REMOVE AND REPLACE CABLE IN EXISTING CONDUIT WHERE SHOWN.
- INSTALL NEW CABLE AND CONDUIT WHERE SHOWN.
- EXISTING HANDHOLES SHALL BE UTILIZED AS SHOWN.
- EXISTING FOUNDATIONS SHALL BE REMOVED AS SHOWN.
- EXISTING SERVICE INSTALLATION AND CABLE SHALL BE RE-UTILIZED.
- INSTALL NEW EMERGENCY VEHICLE PRIORITY SYSTEM ON PROPOSED TRAFFIC SIGNAL STRUCTURES AS SHOWN.
- PAINT EXISTING TRAFFIC SIGNAL CONTROLLER CABINET.

SCHEDULE OF QUANTITIES

ITEM NO.	DESCRIPTION	UNIT	TOTAL QUANTITY
72000200	SIGN PANEL - TYPE 2	SQ FT	60
81012600	CONDUIT IN TRENCH, 2" DIA., PVC	FOOT	91
81012700	CONDUIT IN TRENCH, 2 1/2" DIA., PVC	FOOT	101
81021340	CONDUIT PUSHED, 2 1/2" DIA., PVC	FOOT	24
81021370	CONDUIT PUSHED, 4" DIA., PVC	FOOT	401
81400700	HANDHOLE, PORTLAND CEMENT CONCRETE	EACH	2
81702110	ELECTRIC CABLE IN CONDUIT, 600V (XLP-TYPE USE) 1/C NO. 10	FOOT	3132
81900200	TRENCH AND BACKFILL FOR ELECTRICAL WORK	FOOT	192
82102250	LUMINAIRE, SODIUM VAPOR, HORIZONTAL MOUNT, 250 WATT	EACH	5
85000200	MAINTENANCE OF EXISTING TRAFFIC SIGNAL INSTALLATION	EACH	1
86200300	UNINTERRUPTABLE POWER SUPPLY, EXTENDED	EACH	1
87301215	ELECTRICAL CABLE IN CONDUIT, SIGNAL NO. 14 2C	FOOT	412
87301225	ELECTRIC CABLE IN CONDUIT, SIGNAL NO. 14 3C	FOOT	1853
87301245	ELECTRIC CABLE IN CONDUIT, SIGNAL NO. 14 5C	FOOT	3589
87301255	ELECTRIC CABLE IN CONDUIT, SIGNAL NO. 14 7C	FOOT	594
87502270	TRAFFIC SIGNAL POST, PAINTED STEEL 12 FT.	EACH	2
87502310	TRAFFIC SIGNAL POST, PAINTED STEEL 16 FT.	EACH	1
87502330	TRAFFIC SIGNAL POST, PAINTED STEEL 18 FT.	EACH	2
87701130	STEEL MAST ARM ASSEMBLY AND POLE 18 FT. (SPECIAL)	EACH	1
87704010	STEEL COMBINATION MAST ARM ASSEMBLY AND POLE 16 FT. (SPECIAL)	EACH	1
87704080	STEEL COMBINATION MAST ARM ASSEMBLY AND POLE 30 FT. (SPECIAL)	EACH	1
87704110	STEEL COMBINATION MAST ARM ASSEMBLY AND POLE 36 FT. (SPECIAL)	EACH	1
87704184	STEEL COMBINATION MAST ARM ASSEMBLY AND POLE 52 FT. (SPECIAL)	EACH	1
87800100	CONCRETE FOUNDATION, TYPE A	FOOT	15
87800415	CONCRETE FOUNDATION, TYPE E 36-INCH DIAMETER	FOOT	37
87900200	DRILL EXISTING HANDHOLE	EACH	10
88040070	SIGNAL HEAD, POLYCARBONATE, LED, 1-FACE, 3-SECTION, BRACKET MOUNTED	EACH	4
88040090	SIGNAL HEAD, POLYCARBONATE, LED, 1-FACE, 3-SECTION, MAST ARM MOUNTED	EACH	6
88040110	SIGNAL HEAD, POLYCARBONATE, LED, 1-FACE, 4-SECTION, BRACKET MOUNTED	EACH	1
88102810	PEDESTRIAN SIGNAL HEAD, POLYCARBONATE, LED, 1-FACE, BRACKET MOUNTED	EACH	8
88200410	TRAFFIC SIGNAL BACKPLATE, LOUVERED, FORMED PLASTIC	EACH	17
88700200	LIGHT DETECTOR	EACH	4
88700300	LIGHT DETECTOR AMPLIFIER	EACH	1
89502210	MODIFY EXISTING CONTROLLER AND CABINET	EACH	2
89502300	REMOVE ELECTRIC CABLE FROM CONDUIT	FOOT	6591
89502375	REMOVE EXISTING TRAFFIC SIGNAL EQUIPMENT	EACH	1
89502380	REMOVE EXISTING HANDHOLE	EACH	3
89502385	REMOVE EXISTING CONCRETE FOUNDATION	EACH	8
89730027	ELECTRIC CABLE IN CONDUIT, GROUNDING, NO. 6 1C	FOOT	986
X8808118	OPTICALLY PROGRAMMED SIGNAL HEAD, LED, 1-FACE, 3-SECTION, BRACKET MOUNTED	EACH	1
X8808120	OPTICALLY PROGRAMMED SIGNAL HEAD, LED, 1-FACE, 3-SECTION, MAST ARM MOUNTED	EACH	4
X8808121	OPTICALLY PROGRAMMED SIGNAL HEAD, LED, 1-FACE, 4-SECTION, MAST ARM MOUNTED	EACH	1
*3002181	RELOCATE EXISTING RAILROAD WAYSIDE HORN	EACH	4
*3002182	RELOCATE EXISTING RAILROAD WAYSIDE HORN CABINET	EACH	4
*3002183	RELOCATE EXISTING DUAL RAILROAD CONFIRMATION SIGNAL	EACH	1
*3002184	ELECTRICAL CABLE IN CONDUIT, NO. 16 2C TWISTED PAIR	FOOT	1223
*3002185	ELECTRICAL CABLE IN CONDUIT, NO. 16 10C	FOOT	1179
*3002214	ELECTRIC CABLE IN CONDUIT, COMMUNICATION, NO. 20 3/C	FOOT	817

THE CONTRACTOR SHALL CONTACT REPRESENTATIVES OF THE UNION PACIFIC RAILROAD AND ARRANGE FOR RAILROAD SIGNAL MAINTENANCE PERSONNEL TO BE PRESENT PRIOR TO ANY MODIFICATIONS BEING PERFORMED IN THE TRAFFIC SIGNAL OR MASTER HORN CABINETS AT THE ILLINOIS 23/ ILLINOIS 38 AND THE ILLINOIS 38/ 3RD STREET INTERSECTIONS.

THE ENGINEER IN COORDINATION WITH THE DISTRICT TRAFFIC SIGNAL ENGINEER AND THE ICC SHALL DETERMINE THE EXACT LOCATION IN THE FIELD SO THAT THE TRAFFIC SIGNAL POSTS AND APPURTENANCES DO NOT INTERFERE WITH THE VISIBILITY OF THE RAILROAD CROSSING SIGNALS.

- REMOVAL OF THE FOLLOWING ITEMS SHALL BE PAID FOR AS REMOVE EXISTING TRAFFIC SIGNAL EQUIPMENT:
- 3 EACH - TRAFFIC SIGNAL POST
 - 1 EACH - MAST ARM AND POLE
 - 4 EACH - COMBINATION MAST ARM AND POLE
 - 1 EACH - PEDESTRIAN SIGNAL POST
 - 5 EACH - SIGNAL HEAD, 1-FACE, 3-SECTION, BRACKET MOUNTED
 - 10 EACH - SIGNAL HEAD, 1-FACE, 3-SECTION, MAST ARM MOUNTED
 - 1 EACH - SIGNAL HEAD, 1-FACE, 4-SECTION, MAST ARM MOUNTED
 - 1 EACH - SIGNAL HEAD, 1-FACE, 4-SECTION, BRACKET MOUNTED
 - 8 EACH - PEDESTRIAN SIGNAL HEAD, 1-FACE, BRACKET MOUNTED
 - 4 EACH - EMERGENCY VEHICLE PRIORITY SYSTEM

STA. 11+59.00 (LINCOLN HWY / IL 38) =
STA. 41+42.40 (IL 23)

IL 38 / LINCOLN HIGHWAY

Δ REMOVAL OF AERIAL CABLE ATTACHED TO EXISTING MAST ARM POLE AT SOUTHWEST CORNER SOUTH OF RAILROAD TRACKS WILL BE INCLUDED IN COST OF REMOVE EXISTING TRAFFIC SIGNAL EQUIPMENT.

LOCATIONS OF MAST ARM ASSEMBLIES MAY BE CHANGED IN THE FIELD AS NECESSARY TO AVOID UTILITIES. THE NEW LOCATIONS SHALL BE COORDINATED WITH THE ENGINEER AND APPROVED BY THE DISTRICT TRAFFIC SIGNAL SECTION TO ENSURE THE NEW LOCATIONS MEET OPERATIONAL OFFSET/CLEAR ZONE REQUIREMENTS AND MAINTAIN PROPER POSITION OF SIGNAL HEADS IN RELATION TO THE TRAVELED LANES.

GRAPHIC SCALE



TRAFFIC CONTROL NOTES:

1. THE CONTRACTOR SHALL BE ALLOWED A MAXIMUM OF FOUR (4) HOURS TO TAKE THE EASTBOUND OR WESTBOUND ADVANCED SIGNALS OUT OF OPERATION WHILE THE EXISTING MAST ARMS, POLES AND SIGNALS ARE REPLACED WITH NEW STRUCTURES AND SIGNALS ON THE EXISTING FOUNDATIONS.
2. DURING THE PERIODS WHEN THE ADVANCED SIGNALS ARE NOT IN OPERATION, THE CONTRACTOR SHALL CONTROL THE INTERSECTION WITH FLAGGERS. THE NUMBER OF FLAGGERS WILL BE DETERMINED BY THE ENGINEER PRIOR TO SHUTDOWN.
3. THE CONTRACTOR SHALL BE REQUIRED TO FURNISH AN ADEQUATE NUMBER OF FLAGGERS TO CONTROL THE INTERSECTION.
4. THE FLAGGERS WILL NOT BE PAID FOR SEPARATELY BUT SHALL BE INCLUDED IN THE COST OF MAINTENANCE OF EXISTING TRAFFIC SIGNAL INSTALLATION.
5. THE CONTRACTOR SHALL ARRANGE FOR A RAILROAD FLAGGER TO BE PRESENT DURING THESE TIMES.
6. THE RAILROAD FLAGGER COST WILL BE INCURRED BY THE DEPARTMENT IN ACCORDANCE WITH ARTICLE 107.12 OF THE STANDARD SPECIFICATIONS.

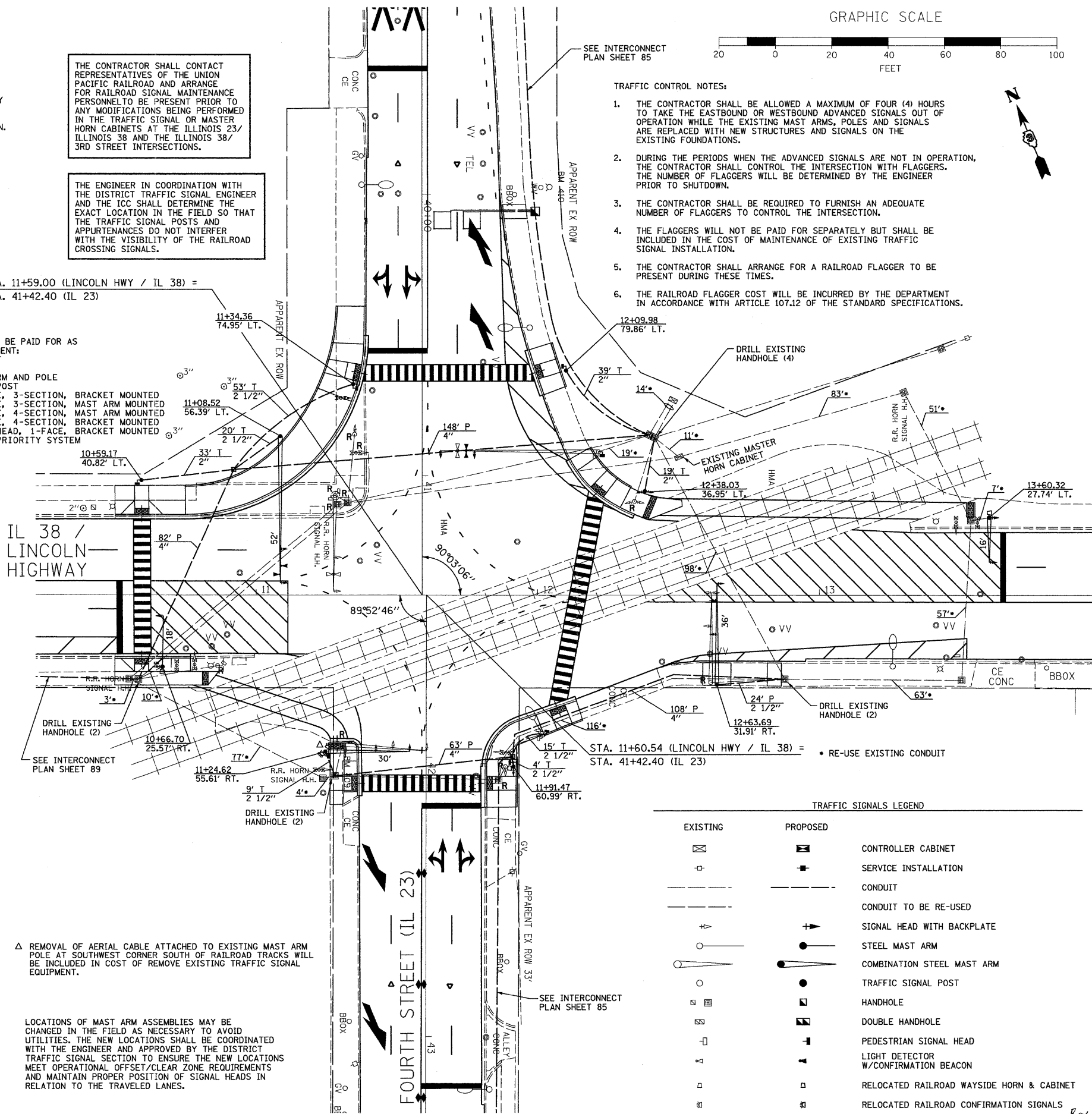

TRAFFIC SIGNALS LEGEND

EXISTING	PROPOSED	
[Symbol]	[Symbol]	CONTROLLER CABINET
[Symbol]	[Symbol]	SERVICE INSTALLATION
[Symbol]	[Symbol]	CONDUIT
[Symbol]	[Symbol]	CONDUIT TO BE RE-USED
[Symbol]	[Symbol]	SIGNAL HEAD WITH BACKPLATE
[Symbol]	[Symbol]	STEEL MAST ARM
[Symbol]	[Symbol]	COMBINATION STEEL MAST ARM
[Symbol]	[Symbol]	TRAFFIC SIGNAL POST
[Symbol]	[Symbol]	HANDHOLE
[Symbol]	[Symbol]	DOUBLE HANDHOLE
[Symbol]	[Symbol]	PEDESTRIAN SIGNAL HEAD
[Symbol]	[Symbol]	LIGHT DETECTOR W/CONFIRMATION BEACON
[Symbol]	[Symbol]	RELOCATED RAILROAD WAYSIDE HORN & CABINET
[Symbol]	[Symbol]	RELOCATED RAILROAD CONFIRMATION SIGNALS