

**STAGE CONSTRUCTION NOTES:**

1. STAGE II CONSTRUCTION SHALL CONSIST OF STAGE II REMOVAL OF THE EXISTING STRUCTURE, AND STAGE II CONSTRUCTION OF THE REPLACEMENT STRUCTURE, PAVEMENT REMOVAL, GRADING, GUARDRAIL, RIPRAP, ETC. STAGE II CONSTRUCTION SHALL BE DONE ACCORDING TO STAGE CONSTRUCTION AS DETAILED IN THE BRIDGE PLANS. TRAFFIC CONTROL SHALL BE IN ACCORDANCE WITH THE APPLICABLE PORTIONS OF STANDARD 701321 AND AS DETAILED IN THE STAGE CONSTRUCTION PLANS. THIS TRAFFIC CONTROL SHALL BE PAID FOR AS TRAFFIC CONTROL AND PROTECTION 701321 (SPECIAL).
2. THE MILLING AND RESURFACING PORTION OF THE PROJECT SHALL BE IN ACCORDANCE WITH THE APPLICABLE PORTIONS OF STANDARD 701306 AND AS DETAILED IN THE STAGE CONSTRUCTION PLANS. THIS TRAFFIC CONTROL SHALL BE PAID FOR AS TRAFFIC CONTROL AND PROTECTION 701306.

**NOTES:**

1. THE CONTRACTOR SHALL MAINTAIN ACCESS TO PRIVATE AND FIELD ENTRANCES LOCATED WITHIN THE LIMITS OF THE PROJECT.
2. TRAFFIC CONTROL & PROTECTION, STANDARD 701321 (SPECIAL) INCLUDES BOTH STAGE I & II AND ANY ADDITIONAL SIGNING OR TRAFFIC CONTROL DEVICES SHOWN ON THE STAGE CONSTRUCTION PLANS.
3. ALL ADDITIONAL TRAFFIC SIGNAL HEADS, LOOP DETECTORS AND ASSOCIATED EQUIPMENT REQUIRED TO MAINTAIN ACCESS AT THE FIELD AND DRIVEWAY ENTRANCES SHALL BE INCLUDED IN THE COST OF "TEMPORARY BRIDGE TRAFFIC SIGNALS"
4. THE COST OF "BARRICADES, TYPE III" SHALL BE INCLUDED IN THE COST OF "TRAFFIC CONTROL AND PROTECTION, STANDARD 701321 (SPECIAL)".
5. ALL SIDEROADS AND ENTRANCES WITHIN TRAFFIC CONTROL SHALL HAVE "NO RIGHT TURN ON RED" AND "STOP HERE ON RED" SIGNS. THE COST SHALL BE INCLUDED IN THE COST OF "TRAFFIC CONTROL AND PROTECTION, STANDARD 701321 (SPECIAL)".
6. CHANGEABLE MESSAGE BOARDS SHALL BE PLACED TWO WEEKS PRIOR TO ANY LANE CLOSURE.
7. THE LENGTH OF THE TEMPORARY CONCRETE BARRIER FOR STAGE I CONSTRUCTION IS 362.5 FT.

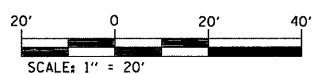
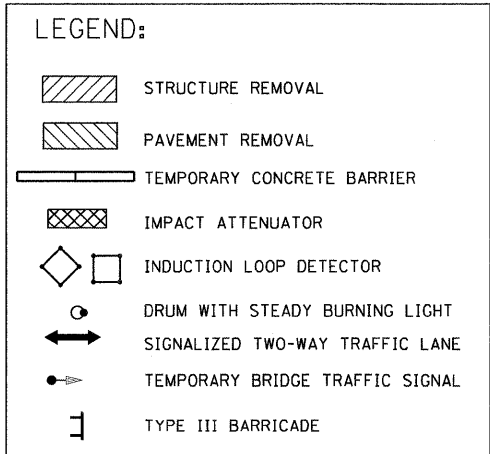

FILE NAME = c:\pwwork\pwwid\gelinh\dms52647\d876c21-sht-stage2.dgn	USER NAME = gelinh	DESIGNED -	REVISED -	<b>STATE OF ILLINOIS DEPARTMENT OF TRANSPORTATION</b>	<b>SUGGESTED STAGE II CONSTRUCTION AND TRAFFIC CONTROL</b>	F.A.P. RTE. = 690	SECTION = 481B	COUNTY = CLINTON	TOTAL SHEETS = 46	SHEET NO. = 11
	PLOT SCALE = 20.0000' / 1"	CHECKED -	REVISED -			SCALE: 1" = 20'	SHEET NO. 1 OF 1 SHEETS	STA. 619+50 TO STA. 627+50.00	CONTRACT NO. 76C21	
PLOT DATE = 6/21/2011	DATE -	REVISED -	REVISED -							