

LEGEND

- WORK ZONE
- TYPE III BARRICADE
- SIGN
- CONE, DRUM OR BARRICADE

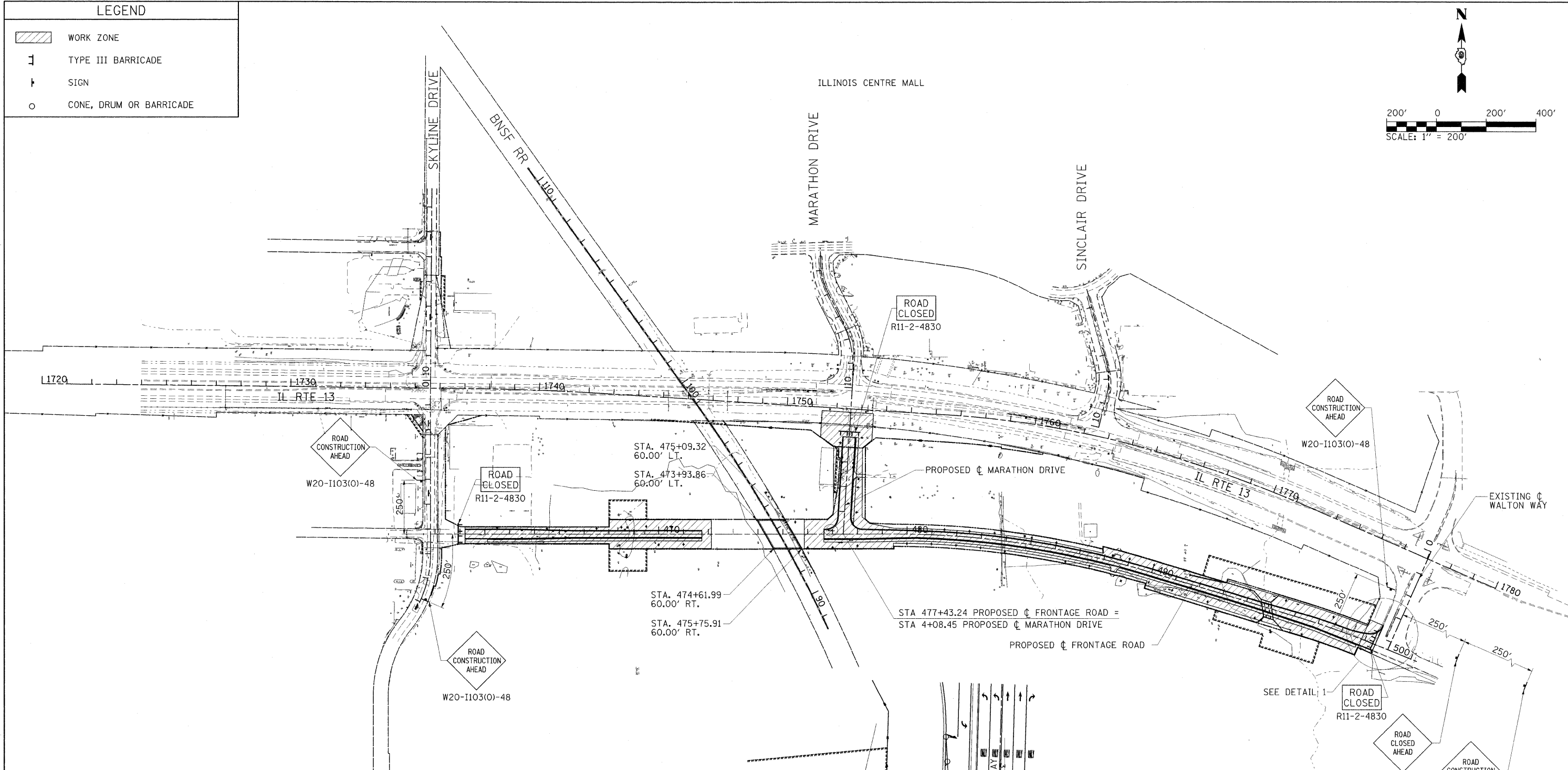

- NOTES:**
1. ADDITIONAL TRAFFIC CONTROL DEVICES MAY BE NECESSARY AS DIRECTED BY THE ENGINEER.
 2. THE FRONTAGE ROAD WILL BE CLOSED TO GENERAL TRAFFIC THROUGHOUT THE PROJECT PER TRAFFIC CONTROL STANDARD BLR-21, HOWEVER, ACCESS TO PRIVATE ENTRANCES WILL BE MAINTAINED AS DIRECTED BY THE ENGINEER.
 3. TRAFFIC CONTROL FOR THIS WORK SHALL BE PAID FOR AS TRAFFIC CONTROL AND PROTECTION (SPECIAL), LUMP SUM.
 4. CONTRACTOR MUST STAY AT LEAST 10 FEET FROM BNSF RAILROAD R.O.W. AT ALL TIMES.
 5. IF A TEMPORARY DAYTIME LANE CLOSURE IS NEEDED ON WALTON WAY, SET UP ADVANCE TRAFFIC CONTROL DEVICES ACCORDING TO STD. 701606.
 6. WHEN CONSTRUCTION OF THE FRONTAGE ROAD IS COMPLETE, THE CONTRACTOR SHALL SET UP ROAD CLOSURES AT ALL PAVEMENT STUBS INCLUDING BOTH SIDES OF THE EXISTING BNSF RAILROAD, THE WEST END OF THE FRONTAGE ROAD AND THE NORTH END OF MARATHON DRIVE. THESE CLOSURES SHALL REMAIN IN PLACE AFTER THE PROJECT IS COMPLETE UNTIL A FUTURE CONTRACT CONNECTS TO THE STUBS OR THE ROADS ARE CLOSED TO TRAFFIC. THE CLOSURES WILL BE PER TRAFFIC CONTROL STANDARD BLR-21 AND SHALL BE PAID FOR AS TRAFFIC CONTROL AND PROTECTION (SPECIAL), LUMP SUM.
 7. PER THE CONTRACT COMMITMENTS INCLUDED HEREIN, TREE CLEARING IS PROHIBITED FROM APRIL 1 TO SEPTEMBER 30 TO AVOID IMPACTS TO THE INDIANA BAT.

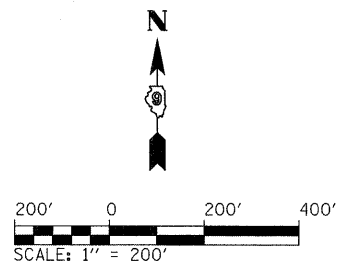
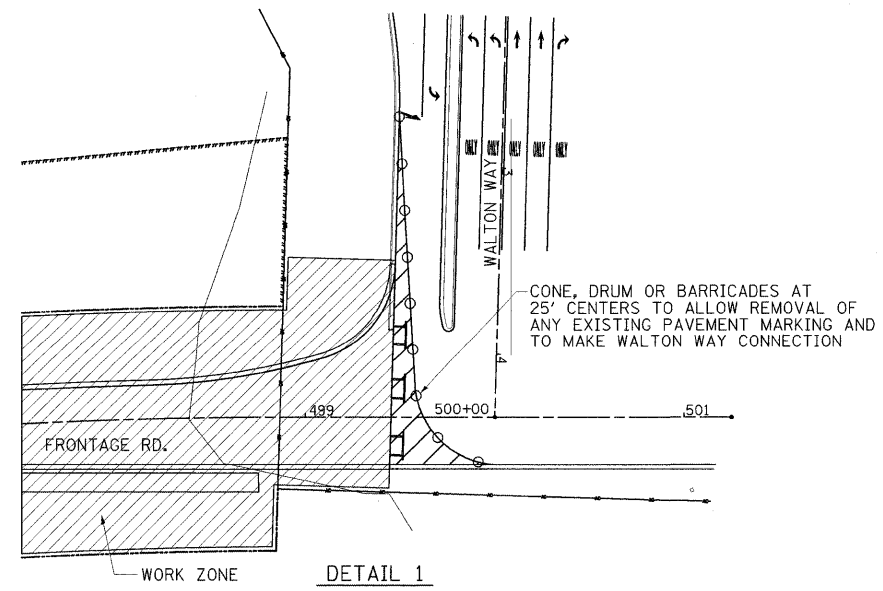

FILE NAME =	USER NAME = Brian Bond	DESIGNED - BMB	REVISED -
1:\dot\906603\draw\CADD_Sheets\Frontage	Road Contract\0998859-sht-mot.dgn	DRAWN - GLD	REVISED -
	PLOT SCALE = 200.0000 "/> IN.	CHECKED - SPH	REVISED -
	PLOT DATE = 3/17/2011	DATE - 3/16/11	REVISED -

**STATE OF ILLINOIS
DEPARTMENT OF TRANSPORTATION**

**MAINTENANCE OF TRAFFIC
CONTROL PLAN**

SCALE: 1" = 200' SHEET NO. OF SHEETS STA. 1720+00.00 TO STA. 1780+00.00

F.A. RTE.	SECTION	COUNTY	TOTAL SHEETS	SHEET NO.
331	(1X-1) R-7	WILLIAMSON	79	14
CONTRACT NO. 78251				
ILLINOIS FED. AID PROJECT				