

DATE	
BY	
ORIGINAL SURVEY	
SURVEYED	
PLOTTED	
REVISIONS	
NOTE BOOK	
NO.	
AREAS CHECKED	

DATE	
BY	
ORIGINAL SURVEY	
SURVEYED	
PLOTTED	
REVISIONS	
NOTE BOOK	
NO.	
AREAS CHECKED	

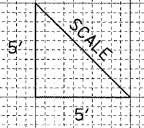
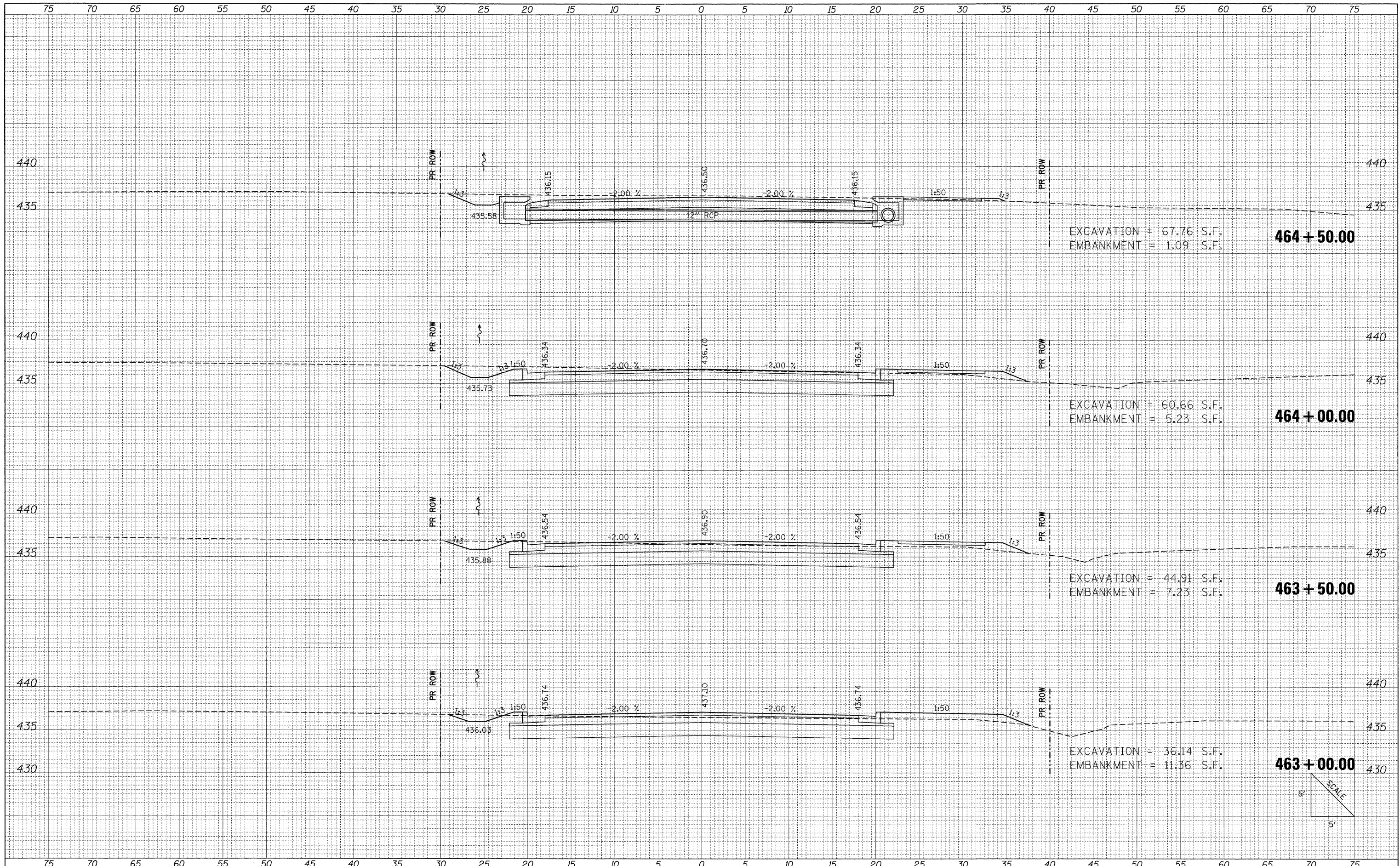

FILE NAME = I:\DOT\0906603\Draw\CADD_Sheets\Frontage Road	USER NAME = Brian Bond	DESIGNED - BMB	REVISED -	STATE OF ILLINOIS DEPARTMENT OF TRANSPORTATION	PROPOSED CROSS SECTIONS FRONTAGE ROAD		F.A. RTE. 331	SECTION (1X-1) R-7	COUNTY WILLIAMSON	TOTAL SHEETS 79	SHEET NO. 53	
	Contract\0906603\Draw\CADD_Sheets\Frontage Road	DRAWN - RAH	REVISED -		SCALE:	SHEET NO. OF SHEETS	STA. 463+00.00 TO STA. 464+50.00	CONTRACT NO. 78251		ILLINOIS FED. AID PROJECT		
	PLOT SCALE = 5.0000' / IN.	CHECKED - SPH	REVISED -									
	PLOT DATE = 3/17/2011	DATE - 3/16/11	REVISED -									