

BY	DATE
SURVEYED	
PLOTTED	
NOTE BOOK	
AREAS CHECKED	
NO.	

BY	DATE
SURVEYED	
PLOTTED	
NOTE BOOK	
AREAS CHECKED	
NO.	

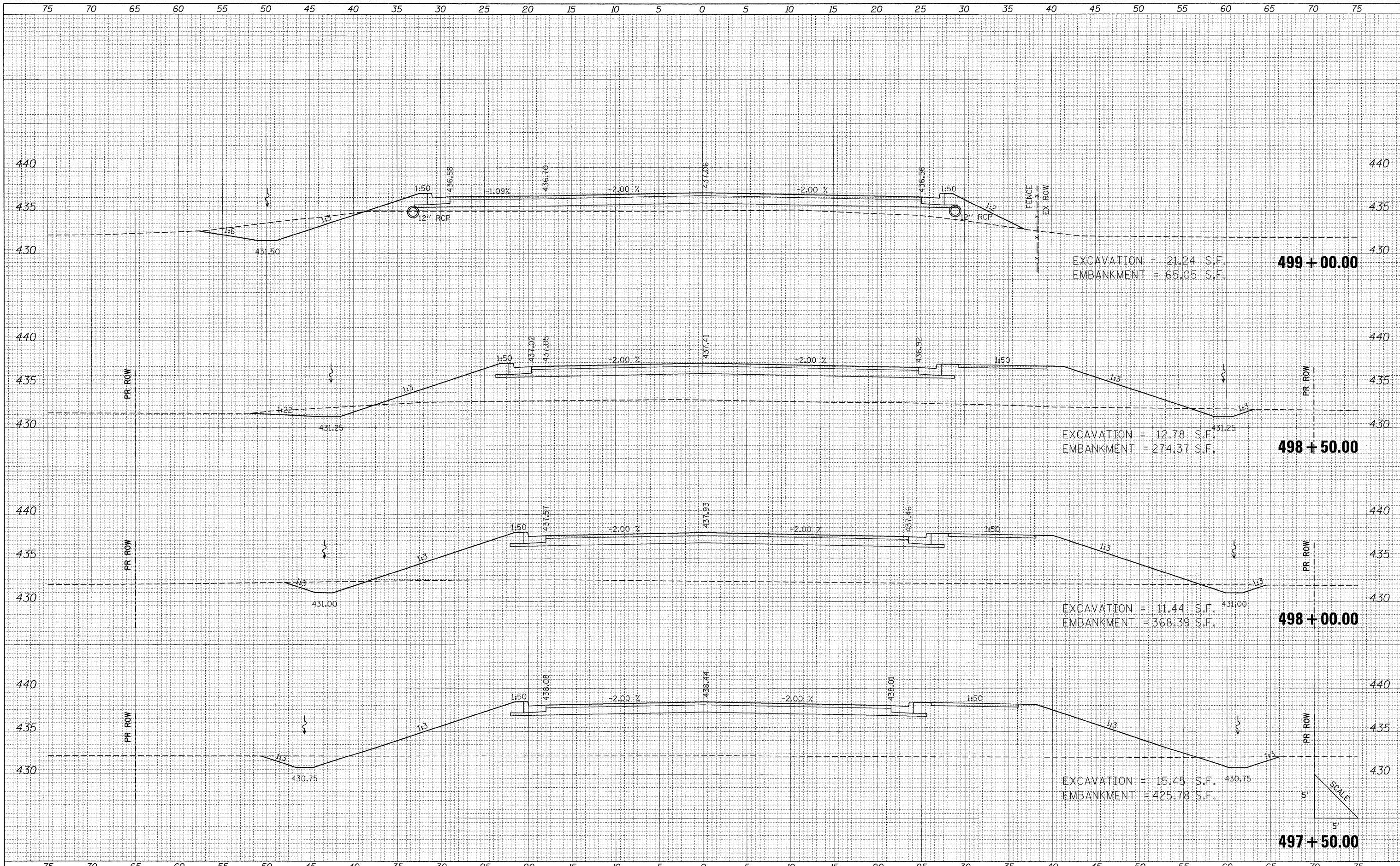

FILE NAME = I:\1001\0906603\Draw\CADD_Sheets\Frontage_Road	USER NAME = Brian Bond	DESIGNED - BMB	REVISED -	STATE OF ILLINOIS DEPARTMENT OF TRANSPORTATION	PROPOSED CROSS SECTIONS FRONTAGE ROAD			F.A. RTE. 331	SECTION (1X-1) R-7	COUNTY WILLIAMSON	TOTAL SHEETS 79	SHEET NO. 70
	CONTRACT \0906603-shr-xs\Frontage.dgn	DRAWN - RAH	REVISED -		SCALE:	SHEET NO. OF SHEETS	STA. 497+50.00 TO STA. 499+00.00	ILLINOIS FED. AID PROJECT				
	PLOT SCALE = 5.0000 "/td> <td>CHECKED - SPH</td> <td>REVISED -</td> <td colspan="8"></td>	CHECKED - SPH	REVISED -									
	PLOT DATE = 3/17/2011	DATE - 3/16/11	REVISED -									