

Notes:  
See sheet 11 of 24 for Sections C-C & D-D and View E-E.  
a<sub>3</sub>(E) and a<sub>4</sub>(E) bar spacings measured along  $\phi$  Rdwy.

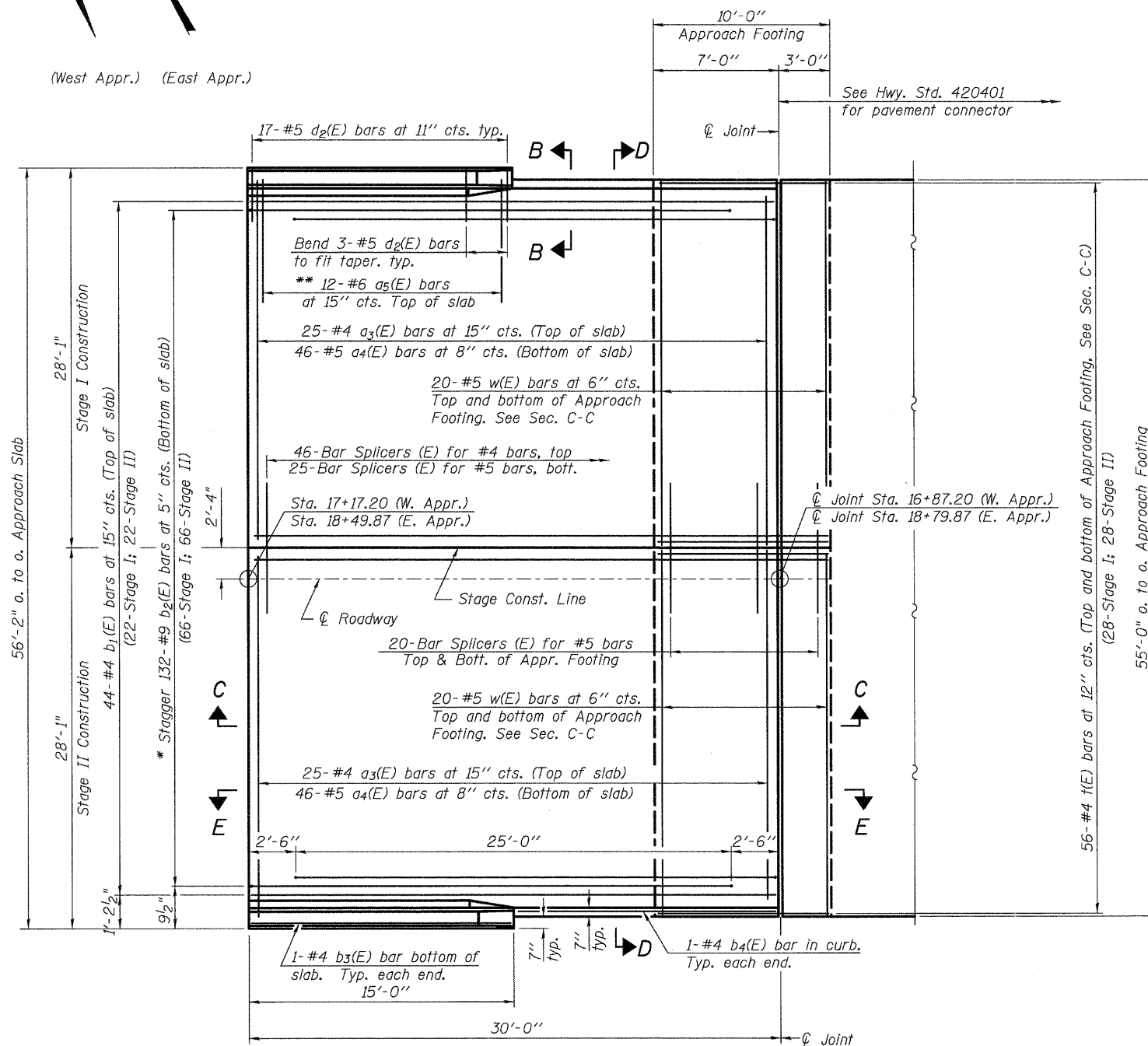

**PLAN**

(East Approach shown, West Approach similar)

- \* Tilt #9 b<sub>2</sub>(E) bars as required to maintain clearance.
- \*\* Space between a<sub>3</sub>(E) bars, typ. ea. parapet.

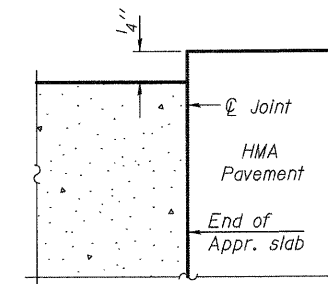

**FLEXIBLE PAVEMENT**

**DETAIL A**

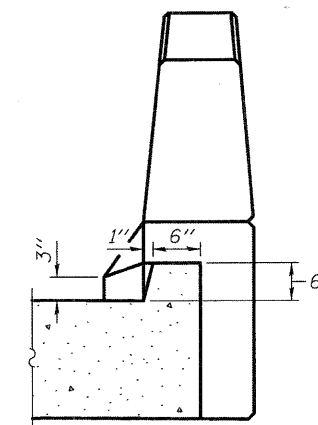

**VIEW B-B**

**MINIMUM BAR LAP**

- #4 bar = 2'-7"
- #5 bar = 3'-3"

(Sheet 1 of 2)

FILE NAME = I:\Projects\2010\1200054\_Bridge\B-void\Structure\1\Drawings\16107-87491-01P-BridgeAppr-Slab01.dgn



USER NAME = #USER*	DESIGNED - MLH	REVISED -
PLOT SCALE =	CHECKED - AEU	REVISED -
PLOT DATE = 7/6/2011	DRAWN - MLH	REVISED -
	CHECKED - AEU	REVISED -

**STATE OF ILLINOIS  
DEPARTMENT OF TRANSPORTATION**

**BRIDGE APPROACH SLAB DETAILS  
STRUCTURE NO. 019-6107**

SHEET NO. 10 OF 24 SHEETS

F.A.U. RTE.	SECTION	COUNTY	TOTAL SHEETS	SHEET NO.
5355	04-00167-00-BR	DEKALB	88	56
FED. ROAD DIST. NO.			ILLINOIS FED. AID PROJECT	
			CONTRACT NO. 87491	