



CODE NO.	ITEM	UNIT	TOTAL QUANTITY URBAN	CONSTRUCTION CODE				
				90% FEDERAL 10% STATE COOK 0021 LIGHTING	90% FEDERAL 10% STATE COOK 0044 OTHER / SIGNAGE			
67100100	MOBILIZATION	L SUM	1		1			
<del>70307120</del>	<del>TEMPORARY PAVEMENT MARKING - LINE 4" - TYPE IV TAPE</del>	<del>FOOT</del>	<del>12,851</del>		<del>12,851</del>	△		
70200100	NIGHTTIME WORK ZONE LIGHTING	L SUM	1		1			
<del>70307125</del>	<del>TEMPORARY PAVEMENT MARKING - LINE 4" - TYPE IV TAPE</del>	<del>FOOT</del>	<del>12,851</del>		<del>12,851</del>			
70300221	TEMPORARY PAVEMENT MARKING - LINE 4" - PAINT	FOOT	8,217		8,217			
70300231	TEMPORARY PAVEMENT MARKING - LINE 5" - PAINT	FOOT	2,255		2,255			
70300251	TEMPORARY PAVEMENT MARKING - LINE 8" - PAINT	FOOT	2,217		2,217	△		
70300261	TEMPORARY PAVEMENT MARKING - LINE 12" - PAINT	FOOT	80		80			
70400100	TEMPORARY CONCRETE BARRIER	FOOT	<del>3,300</del> 3,316		<del>3,300</del> 3,316			
70300150	SHORT TERM PAVEMENT MARKING REMOVAL	SQ FT	<del>15,787</del> 5,124		<del>15,787</del> 5,124			
<del>70400200</del>	<del>RELOCATE TEMPORARY CONCRETE BARRIER</del>	<del>FOOT</del>	<del>3,360</del>		<del>3,360</del>			
70600260	IMPACT ALTTENVATOR, TEMPORARY (FULLY REDIRECTIVE-NARROW), TEST LEVEL 3	EACH	1		1			
72400710	RELOCATE SIGN PANEL - TYPE 1	SQ FT	<del>444</del> 153		<del>444</del> 153	△		
72400720	RELOCATE SIGN PANEL - TYPE 2	SQ FT	<del>351</del> 483		<del>351</del> 483			
72600100	MILE POST MARKER ASSEMBLY	EACH	44		44			
72800100	TELESCOPING STEEL SIGN SUPPORT	FOOT	288		288			
78000200	THERMOPLASTIC PAVEMENT MARKING - LINE 4"	FOOT	<del>10,377</del> 3,030		<del>10,377</del> 3,030			
78000500	THERMOPLASTIC PAVEMENT MARKING - LINE 8"	FOOT	2,903		2,903			
78000600	THERMOPLASTIC PAVEMENT MARKING - LINE 12"	FOOT	430		430			
<del>78004354</del>	<del>PREFORMED PLASTIC PAVEMENT MARKING, TYPE D - INLAID - LINE 4"</del>	<del>FOOT</del>	<del>1,156</del>		<del>1,156</del>	△		
78004620	PREFORMED PLASTIC PAVEMENT MARKING, TYPE D - LINE 4"	FOOT	362		362			
78011025	GROOVING FOR RECESSED PAVEMENT MARKING - LINE 5"	FOOT	362		362			
<del>78004355</del>	<del>PREFORMED PLASTIC PAVEMENT MARKING, TYPE D - INLAID - LINE 5"</del>	<del>FOOT</del>	<del>6,662</del>		<del>6,662</del>			
78004625	PREFORMED PLASTIC PAVEMENT MARKING, TYPE D - LINE 5"	FOOT	2,247		2,247			
78011030	GROOVING FOR RECESSED PAVEMENT MARKING - LINE 6"	FOOT	2,247		2,247			
<del>78100100</del>	<del>RAISED REFLECTIVE PAVEMENT MARKER</del>	<del>EACH</del>	<del>46</del> 450		<del>46</del> 450			

\* SPECIALTY ITEM A - COOK COUNTY ELECTRICAL B - COOK COUNTY OTHER / SIGNAGE

Jacobs

DESIGNED - JJZ	REVISED -
DRAWN - HAR	REVISED -
CHECKED - CRH	REVISED -
DATE - 06/25/2021	REVISED -

STATE OF ILLINOIS  
DEPARTMENT OF TRANSPORTATION

SUMMARY OF QUANTITIES

SCALE: NTS SHEET 2 OF 5 SHEETS STA. TO STA.

△ REVISED SHEET 9/14/2022 SQ0-02				
F.A.I. RTE.	SECTION	COUNTY	TOTAL SHEETS	SHEET NO.
94	2020-235-L	COOK	148	5
CONTRACT NO. 62N04				
ILLINOIS FED. AID PROJECT				

REV-SEP

I:\Projects\2020\2020-235-L\Drawings\2020-235-L\2020-235-L-03.dwg  
 User: k-abmp  
 Date: 7/1/2022  
 Scale: NTS  
 Sheet: 3 of 5

CODE NO.	ITEM	UNIT	TOTAL QUANTITY URBAN	CONSTRUCTION CODE		
				90% FEDERAL 10% STATE COOK 0021 LIGHTING	90% FEDERAL 10% STATE COOK 0044 OTHER / SIGNAGE	
* 78200011	BARRIER WALL REFLECTORS, TYPE C	EACH	<del>263</del> 265		<del>263</del> 265	
78300200	RAISED REFLECTIVE PAVEMENT MARKER REMOVAL	EACH	<del>586</del> 450	<del>586</del>	450	
80400100	ELECTRIC SERVICE INSTALLATION	EACH	6	6		
80400200	ELECTRIC UTILITY SERVICE CONNECTION	L SUM	1	1		
81028240	UNDERGROUND CONDUIT, GALVANIZED STEEL, 4" DIA.	FOOT	<del>1,939</del> 2,053	<del>1,939</del> 2,053		
81028750	UNDERGROUND CONDUIT, COILABLE NONMETALLIC CONDUIT, 2" DIA.	FOOT	119	119		
81100320	CONDUIT ATTACHED TO STRUCTURE, 1" DIA., PVC COATED GALVANIZED STEEL	FOOT	<del>4,830</del> 3,828	<del>4,830</del> 3,828		
81100805	CONDUIT ATTACHED TO STRUCTURE, 3" DIA., PVC COATED GALVANIZED STEEL	FOOT	126	126		
81300220	JUNCTION BOX, STAINLESS STEEL, ATTACHED TO STRUCTURE, 6" X 6" X 4"	EACH	<del>102</del> 80	<del>102</del> 80		
81300530	JUNCTION BOX, STAINLESS STEEL, ATTACHED TO STRUCTURE, 12" X 10" X 6"	EACH	<del>39</del> 31	<del>39</del> 31		
81300830	JUNCTION BOX, STAINLESS STEEL, ATTACHED TO STRUCTURE, 18" X 18" X 8"	EACH	<del>14</del> 9	<del>14</del> 9		
<del>81603050</del>	<del>UNIT DUCT, 600V, 3-1C NO.6, 1/C NO.8 GROUND, (XLP-TYPE USE), 1" DIA. POLYETHYLENE</del>	<del>FOOT</del>	<del>3,075</del>	<del>3,075</del>		
81603090	UNIT DUCT, 600V, 3-1C NO.4, 1/C NO.6 GROUND, (XLP-TYPE USE), 1 1/4" DIA. POLYETHYLENE	FOOT	<del>80,588</del> 80,626	<del>80,588</del> 80,626		
81702110	ELECTRIC CABLE IN CONDUIT, 600V (XLP-TYPE USE) 1/C NO. 10	FOOT	<del>21,498</del> 17,242	<del>21,498</del> 17,242		
* 81702130	ELECTRIC CABLE IN CONDUIT, 600V (XLP-TYPE USE) 1/C NO. 6	FOOT	<del>606</del> 1,086	<del>606</del> 1,086		
* 81702140	ELECTRIC CABLE IN CONDUIT, 600V (XLP-TYPE USE) 1/C NO. 4	FOOT	<del>1,680</del> 1,840	<del>1,680</del> 1,840		

\* SPECIALTY ITEM A - COOK COUNTY ELECTRICAL B - COOK COUNTY OTHER / SIGNAGE



USER NAME: k-abmp	DESIGNED: JJZ	REVISED:
DRAWN: HAR	REVISIONS:	
CHECKED: CRH	REVISIONS:	
DATE: 06/25/2021	REVISIONS:	

STATE OF ILLINOIS  
DEPARTMENT OF TRANSPORTATION

SUMMARY OF QUANTITIES

SCALE: NTS SHEET 3 OF 5 SHEETS STA. TO STA.

REVISED SHEET 9/15/2022		S0Q-03	
F.A.T. RTE.	SECTION	COUNTY	TOTAL SHEETS
94	2020-235-L	COOK	148
			SHEET NO. 6
CONTRACT NO. 62N04			
ILLINOIS FED. AID PROJECT			

CODE NO.	ITEM	UNIT	TOTAL QUANTITY URBAN	CONSTRUCTION CODE			
				90% FEDERAL 10% STATE COOK 0021 LIGHTING	90% FEDERAL 10% STATE COOK 0044 OTHER / SIGNAGE		
81702220	ELECTRIC CABLE IN CONDUIT, 600V (XLP-TYPE USE) 1/C 350MCM	FOOT	<del>783</del> 468	<del>783</del> 468			
82110007	LUMINAIRE, LED, ROADWAY, OUTPUT DESIGNATION G	EACH	<del>113</del> 90	<del>113</del> 90			
82110008	LUMINAIRE, LED, ROADWAY, OUTPUT DESIGNATION H	EACH	<del>293</del> 288	<del>293</del> 288			
<del>82110022</del>	<del>LUMINAIRE, LED, UNDERPASS, WALLMOUNT, OUTPUT DESIGNATION E</del>	<del>EACH</del>	<del>54</del>	<del>54</del>			
82110027	LUMINAIRE, LED, UNDERPASS, SUSPENDED, OUTPUT DESIGNATION E	EACH	<del>48</del> 80	<del>48</del> 80			
83050770	LIGHT POLE, ALUMINUM, 47.5 FT. M.H., 10 FT. MAST ARM	EACH	4	4			
83050810	LIGHT POLE, ALUMINUM, 47.5 FT. M.H., 15 FT. MAST ARM	EACH	<del>287</del> 284	<del>287</del> 284			
<del>83050860</del>	<del>LIGHT POLE, ALUMINUM, 47.5 FT. M.H., 2-6 FT. MAST ARMS</del>	<del>EACH</del>	<del>25</del>	<del>25</del>			
83600365	LIGHT POLE FOUNDATION, METAL, 15" BOLT CIRCLE, 10" X 8"	EACH	284	284			
83800205	BREAKAWAY DEVICE, TRANSFORMER BASE, 15 INCH BOLT CIRCLE	EACH	284	284			
84200600	REMOVAL OF LIGHTING UNIT, NO SALVAGE	EACH	<del>174</del> 249	<del>174</del> 249			
84200804	REMOVAL OF POLE FOUNDATION	EACH	<del>149</del> 146	<del>149</del> 146			
84500110	REMOVAL OF LIGHTING CONTROLLER	EACH	6	6			
84500130	REMOVAL OF LIGHTING CONTROLLER FOUNDATION	EACH	<del>6</del> 4	<del>6</del> 4			
84500120	REMOVAL OF ELECTRIC SERVICE INSTALLATION	EACH	6	6			
89502300	REMOVE ELECTRIC CABLE FROM CONDUIT	FOOT	15,496	15,496			

\* SPECIALTY ITEM A - COOK COUNTY ELECTRICAL B - COOK COUNTY OTHER / SIGNAGE

I:\Projects\2020\2020-235-L\Drawings\Lighting\Drawings\89502300.dwg  
 User: kramb  
 Date: 7/1/2022  
 Scale: 1/8"=1'-0"  
 Plot Date: 7/1/2022  
 Plot Scale: 1/8"=1'-0"  
 Plot Date: 7/1/2022



USER NAME: kramb  
 DESIGNED: JJZ  
 DRAWN: HAR  
 CHECKED: CRH  
 DATE: 06/25/2021

REVISED: -  
 REVISED: -  
 REVISED: -  
 REVISED: -

STATE OF ILLINOIS  
DEPARTMENT OF TRANSPORTATION

SUMMARY OF QUANTITIES

SCALE: NTS SHEET 4 OF 5 SHEETS STA. TO STA.

REVISED SHEET 9/15/2022		SQ-04	
F.A.I. RTE.	SECTION	COUNTY	TOTAL SHEETS
94	2020-235-L	COOK	148
			7
CONTRACT NO. 62N04			
ILLINOIS FED. AID PROJECT			



C:\Users\korabmp\Documents\Civil\Projects\I-94\I-94 US 41 Smart Highway\Lighting Plans\50\_Scales\E2N04\_South\_Conventional\E02\_DE2N04-I-94-Civil-101.dgn

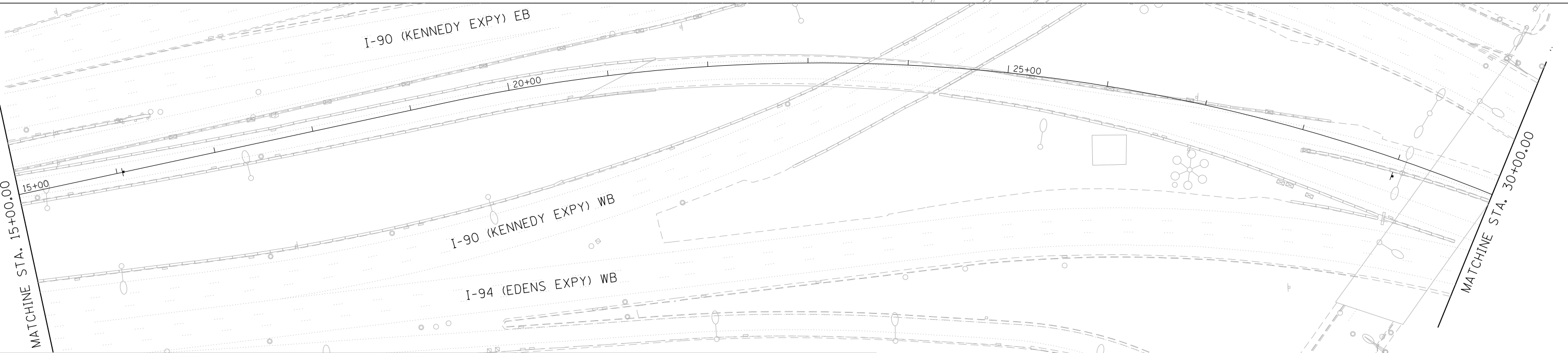
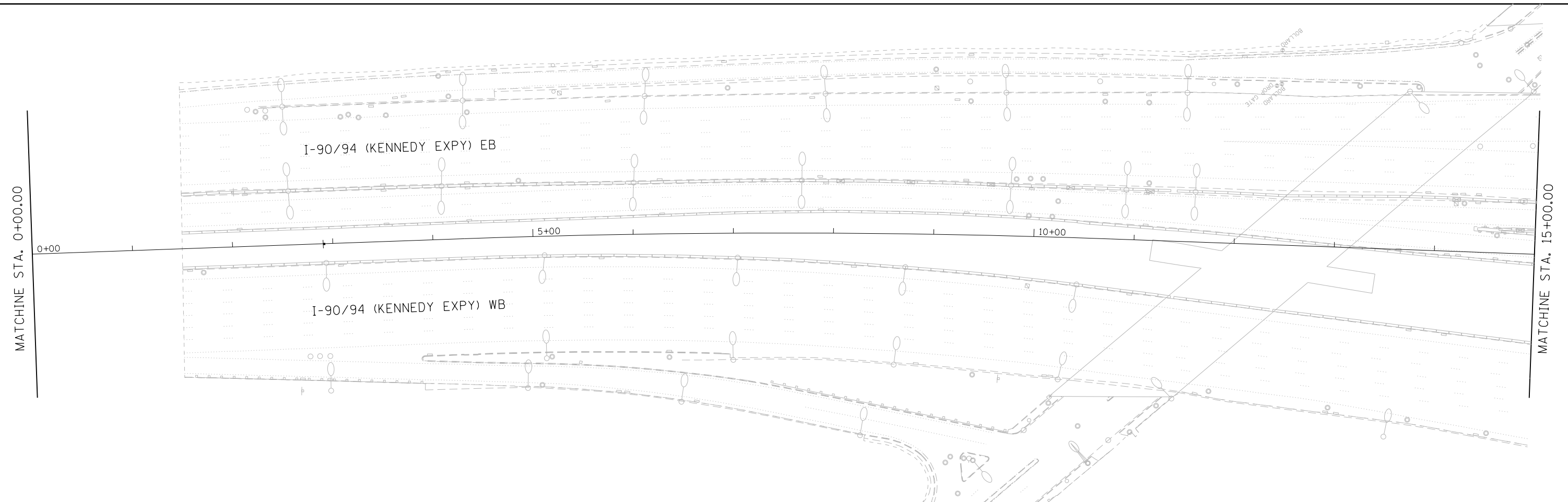

**PAVEMENT MARKING & RESTORATION LEGEND**

<p>① SHOULDER RUMBLE STRIPS - 16 INCH (64200116)</p> <p>② 4 INCH WHITE DOTTED LANE LINE, 3' DASH - 9' SKIP          PREFORMED PLASTIC PAVEMENT MARKING, TYPE D - LINE 4" (78004620)          GROOVING FOR RECESSED PAVEMENT MARKING 5" (78011025)</p> <p>③ 5 INCH WHITE LANE LINE, 10' DASH - 30' SKIP          PREFORMED PLASTIC PAVEMENT MARKING, TYPE D - LINE 5" (78004625)          GROOVING FOR RECESSED PAVEMENT MARKING 6" (78011030)</p>	<p>④ RAISED REFLECTIVE PAVEMENT MARKER (78100100) - ONE-WAY CRYSTAL</p> <p>⑤ THERMOPLASTIC PAVEMENT MARKING - LINE 4" (78000200) - YELLOW</p> <p>⑥ THERMOPLASTIC PAVEMENT MARKING - LINE 4" (78000200) - WHITE</p> <p>⑦ THERMOPLASTIC PAVEMENT MARKING - LINE 8" (78000500) - WHITE</p> <p>⑧ THERMOPLASTIC PAVEMENT MARKING - LINE 12" (78000600) - WHITE</p>
---	---



USER NAME = korabmp	DESIGNED - MMO	REVISED - 09/13/2022
PLOT SCALE =	DRAWN - MMO	REVISED -
PLOT DATE = 9/13/2022	CHECKED - MMK	REVISED -
	DATE - 06/25/2021	REVISED -

**STATE OF ILLINOIS**  
**DEPARTMENT OF TRANSPORTATION**

**I-94 / US 41 SMART HIGHWAY**  
**PAVEMENT MARKING & RESTORATION PLAN**  
 SCALE: 1"=50' SHEET 2 OF 14 SHEETS STA. 30+00 TO STA. 60+00

N  
 0 50 100 150  
 SCALE IN FEET

**1** REVISED SHEET 9/14/2022

F.A.I. RTE.	SECTION	COUNTY	TOTAL SHEETS	SHEET NO.
94	2020-235-L	COOK	148	30

**CIV-02**  
 CONTRACT NO. 62N04  
 ILLINOIS FED. AID PROJECT

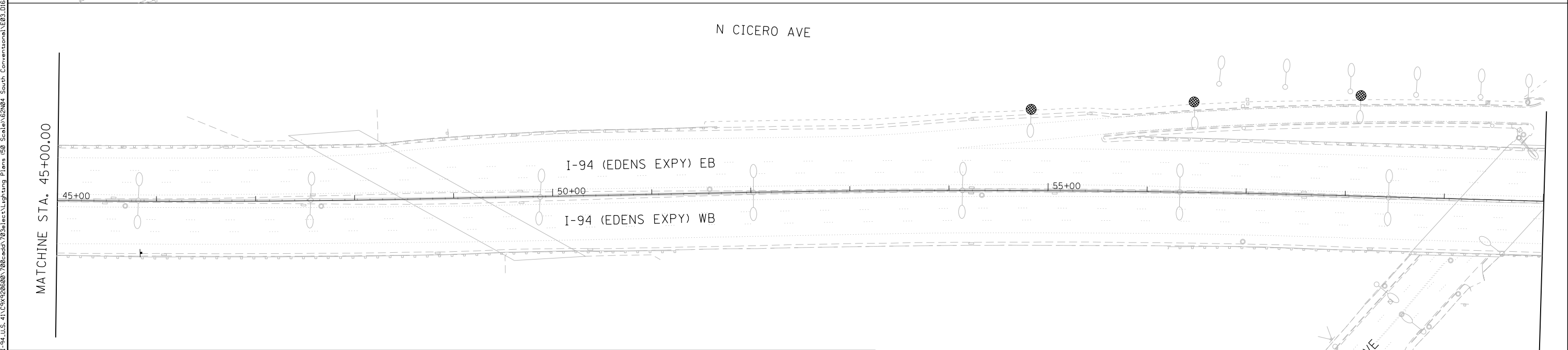
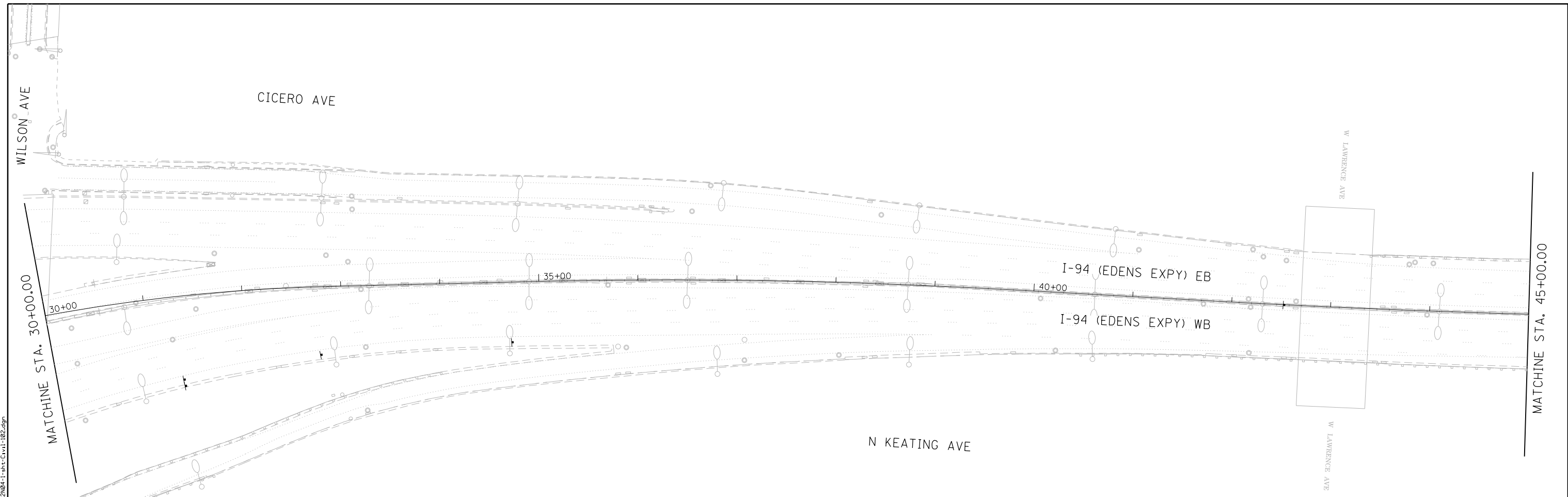

**PAVEMENT MARKING & RESTORATION LEGEND**

<p>① SHOULDER RUMBLE STRIPS, 16 INCH (64200116)</p> <p>② 4 INCH WHITE DOTTED LANE LINE, 3' DASH - 9' SKIP PERFORMED PLASTIC PAVEMENT MARKING, TYPE D - LINE 4" (78004620) GROOVING FOR RECESSED PAVEMENT MARKING 5" (78011025)</p> <p>③ 5 INCH WHITE LANE LINE, 10' DASH - 30' SKIP PERFORMED PLASTIC PAVEMENT MARKING, TYPE D - LINE 5" (78004625) GROOVING FOR RECESSED PAVEMENT MARKING 6" (78011030)</p>	<p>④ RAISED REFLECTIVE PAVEMENT MARKER (78100100) - ONE-WAY CRYSTAL</p> <p>⑤ THERMOPLASTIC PAVEMENT MARKING - LINE 4" (78000200) - YELLOW</p> <p>⑥ THERMOPLASTIC PAVEMENT MARKING - LINE 4" (78000200) - WHITE</p> <p>⑦ THERMOPLASTIC PAVEMENT MARKING - LINE 8" (78000500) - WHITE</p> <p>⑧ THERMOPLASTIC PAVEMENT MARKING - LINE 12" (78000600) - WHITE</p>
--	---

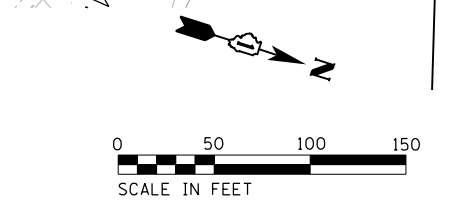

USER NAME = korabmp	DESIGNED - MMO	REVISED - 09/13/2022
PLOT SCALE =	DRAWN - MMO	REVISED -
PLOT DATE = 9/13/2022	CHECKED - MMK	REVISED -
	DATE - 06/25/2021	REVISED -

**STATE OF ILLINOIS  
DEPARTMENT OF TRANSPORTATION**

**I-94 / US 41 SMART HIGHWAY  
PAVEMENT MARKING & RESTORATION PLAN**

SCALE: 1"=50'      SHEET 3 OF 14 SHEETS      STA. 30+00 TO STA. 60+00

REVISED SHEET 9/14/2022				<b>CIV-03</b>
F.A.I. RTE.	SECTION	COUNTY	TOTAL SHEETS	SHEET NO.
94	2020-235-L	COOK	148	31
CONTRACT NO. 62N04				
ILLINOIS FED. AID PROJECT				

c:\p\project\1484\ER\_jacobscamb\1\Documents\94\I-94\_US\_41\Smart\_Highway\_Plan\_50\_Scale\62N04\_South\_Conventional\603\_DE2N04-I-94-Civ-1-182.dgn





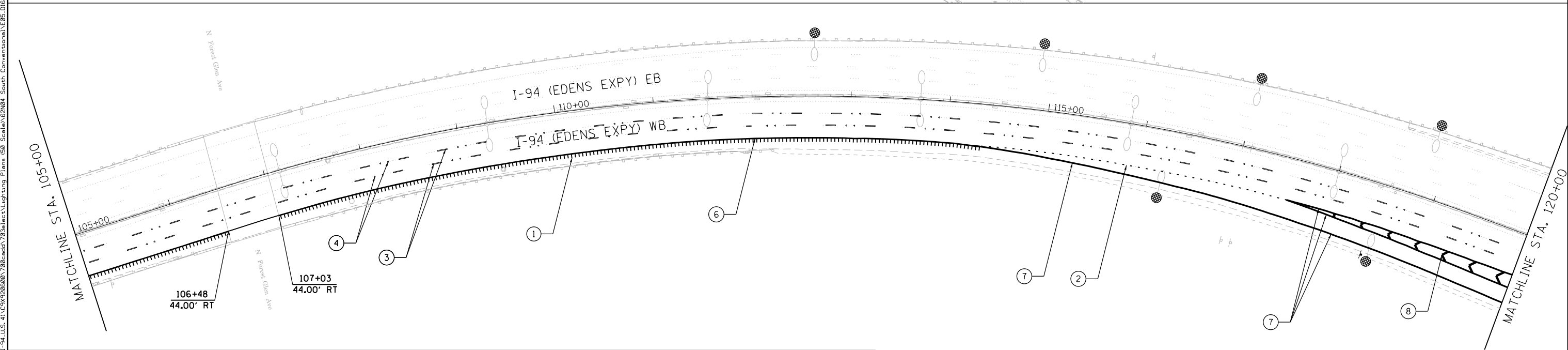
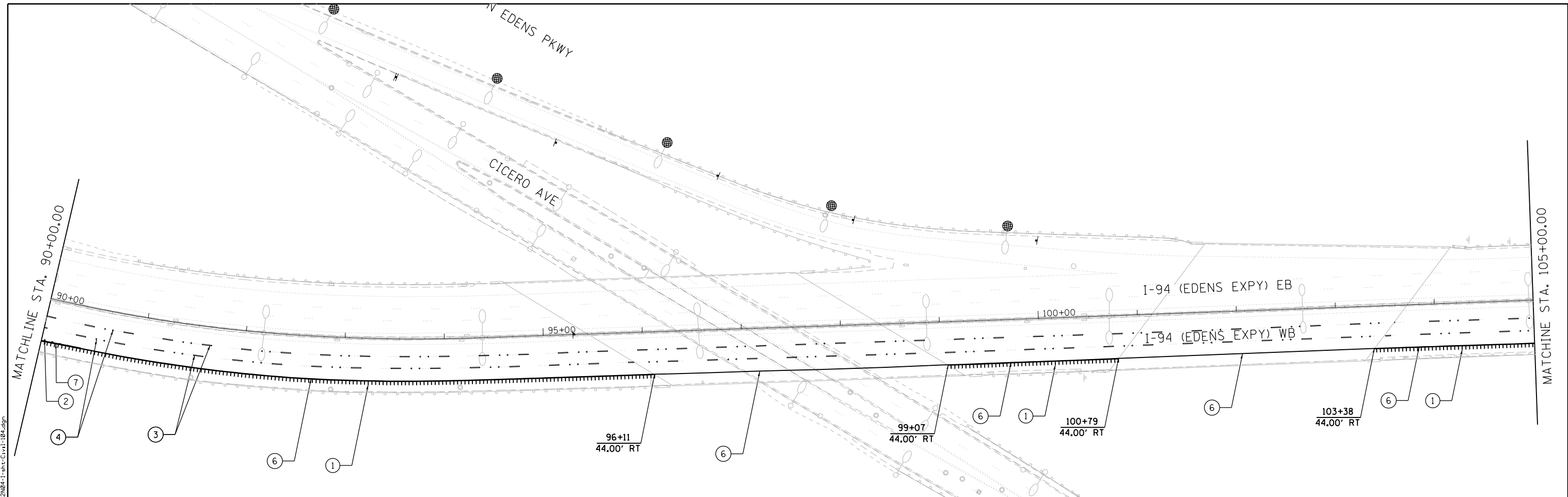

**PAVEMENT MARKING & RESTORATION LEGEND**

<p>① SHOULDER RUMBLE STRIPS - 16 INCH (64200116)</p> <p>② 4 INCH WHITE DOTTED LANE LINE, 3' DASH - 9' SKIP PERFORMED PLASTIC PAVEMENT MARKING, TYPE D - LINE 4" (78004620) GROOVING FOR RECESSED PAVEMENT MARKING 5" (78011025)</p> <p>③ 5 INCH WHITE LANE LINE, 10' DASH - 30' SKIP PERFORMED PLASTIC PAVEMENT MARKING, TYPE D - LINE 5" (78004625) GROOVING FOR RECESSED PAVEMENT MARKING 6" (78011030)</p>	<p>④ RAISED REFLECTIVE PAVEMENT MARKER (78100100) - ONE-WAY CRYSTAL</p> <p>⑤ THERMOPLASTIC PAVEMENT MARKING - LINE 4" (78000200) - YELLOW</p> <p>⑥ THERMOPLASTIC PAVEMENT MARKING - LINE 4" (78000200) - WHITE</p> <p>⑦ THERMOPLASTIC PAVEMENT MARKING - LINE 8" (78000500) - WHITE</p> <p>⑧ THERMOPLASTIC PAVEMENT MARKING - LINE 12" (78000600) - WHITE</p>
---	---

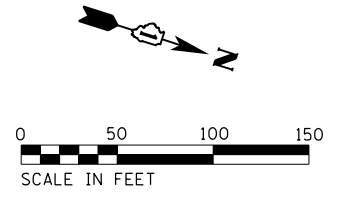

USER NAME = korabmp	DESIGNED - MMO	REVISED - 09/13/2022
PLOT SCALE =	DRAWN - MMO	REVISED -
PLOT DATE = 9/13/2022	CHECKED - MMK	REVISED -
	DATE - 06/25/2021	REVISED -

**STATE OF ILLINOIS  
DEPARTMENT OF TRANSPORTATION**

**I-94 / US 41 SMART HIGHWAY  
PAVEMENT MARKING & RESTORATION PLAN**

SCALE: 1"=50'      SHEET 5 OF 14 SHEETS      STA. 90+00 TO STA. 120+00

1 REVISED SHEET 9/14/2022				<b>CIV-05</b>	
F.A.I. RTE.	SECTION	COUNTY	TOTAL SHEETS	SHEET NO.	
94	2020-235-L	COOK	148	33	
CONTRACT NO. 62N04					
ILLINOIS FED. AID PROJECT					

C:\Users\korabmp\Documents\C9226688\I-94 US 41 Smart Highway\Lighting Plans\50 Scale\62N04\_South Conventional\605\_DE2N04-I-sh-Civil-184.dgn

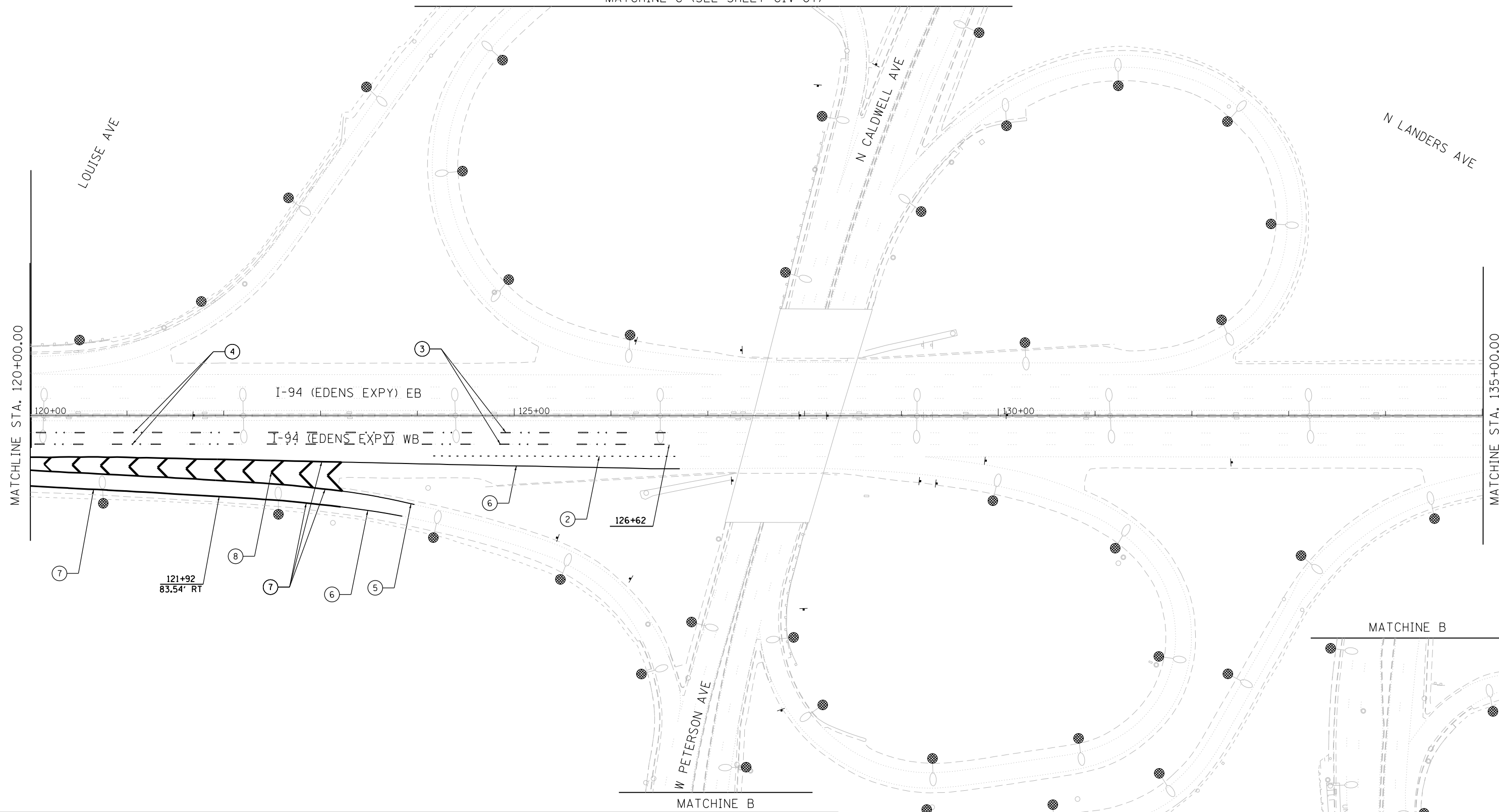

**PAVEMENT MARKING & RESTORATION LEGEND**

<p>① SHOULDER RUMBLE STRIPS, 16 INCH (64200116)</p> <p>② 4 INCH WHITE DOTTED LANE LINE, 3' DASH - 9' SKIP PERFORMED PLASTIC PAVEMENT MARKING, TYPE D - LINE 4" (78004620) GROOVING FOR RECESSED PAVEMENT MARKING 5" (78011025)</p> <p>③ 5 INCH WHITE LANE LINE, 10' DASH - 30' SKIP PERFORMED PLASTIC PAVEMENT MARKING, TYPE D - LINE 5" (78004625) GROOVING FOR RECESSED PAVEMENT MARKING 6" (78011030)</p>	<p>④ RAISED REFLECTIVE PAVEMENT MARKER (78100100) - ONE-WAY CRYSTAL</p> <p>⑤ THERMOPLASTIC PAVEMENT MARKING - LINE 4" (78000200) - YELLOW</p> <p>⑥ THERMOPLASTIC PAVEMENT MARKING - LINE 4" (78000200) - WHITE</p> <p>⑦ THERMOPLASTIC PAVEMENT MARKING - LINE 8" (78000500) - WHITE</p> <p>⑧ THERMOPLASTIC PAVEMENT MARKING - LINE 12" (78000600) - WHITE</p>
--	---

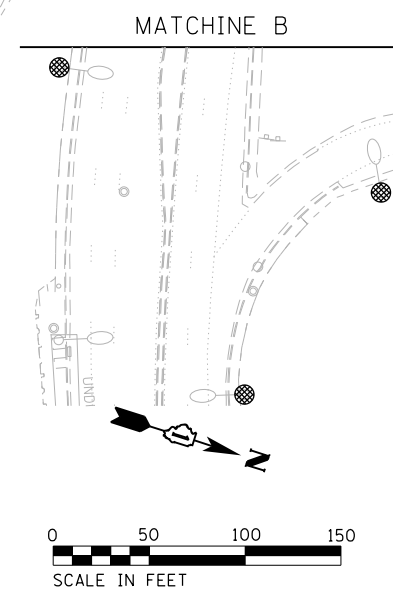

C:\Projects\I-94\I-94\_41\C9426680\708\cadd\708\select\Lighting Plans (50 Scale)\E2N04-South Conventional\E06-DIG2N04-I-sh-Civ1-185.dgn



USER NAME = korabmp	DESIGNED - MMO	REVISED - 09/13/2022
PLOT SCALE =	DRAWN - MMO	REVISIONS -
PLOT DATE = 9/13/2022	CHECKED - MMK	REVISIONS -
	DATE - 06/25/2021	REVISIONS -

**STATE OF ILLINOIS**  
**DEPARTMENT OF TRANSPORTATION**

**I-94 / US 41 SMART HIGHWAY**  
**PAVEMENT MARKING & RESTORATION PLAN**  
 SCALE: 1"=50' SHEET 6 OF 14 SHEETS STA. 120+00 TO STA. 150+00

① REVISED SHEET 9/14/2022				<b>CIV-06</b>	
F.A.I. RTE.	SECTION	COUNTY	TOTAL SHEETS	SHEET NO.	
94	2020-235-L	COOK	148	34	
CONTRACT NO. 62N04					ILLINOIS FED. AID PROJECT



C:\Users\korabmp\Documents\C9226680\_1-94\_ILS\_41\CS9226680\_708\cadd\708\sheet\Lighting Plans (50 Scale)\E2N04\_South Conventional\E08\_DIE2N04-1-ah-Civ1-107.dgn

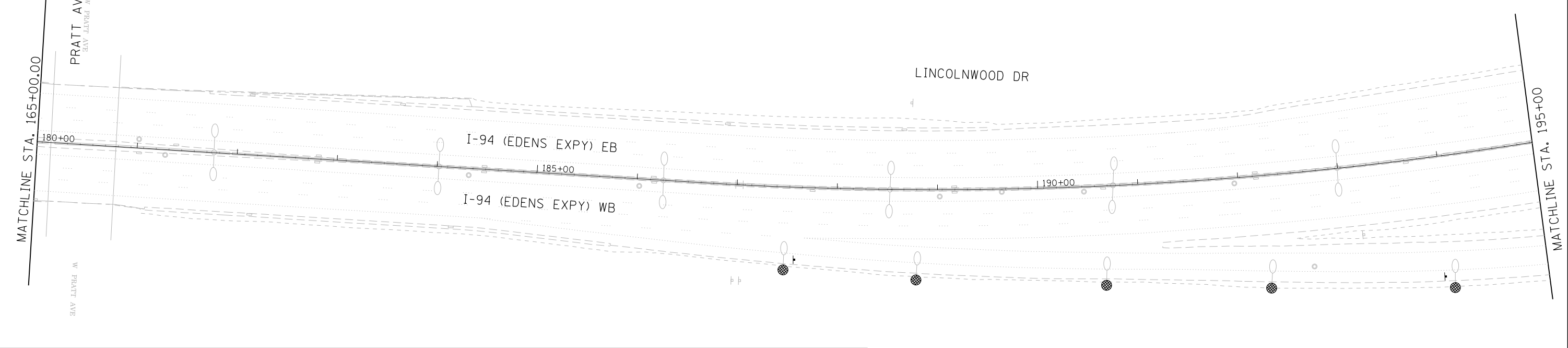
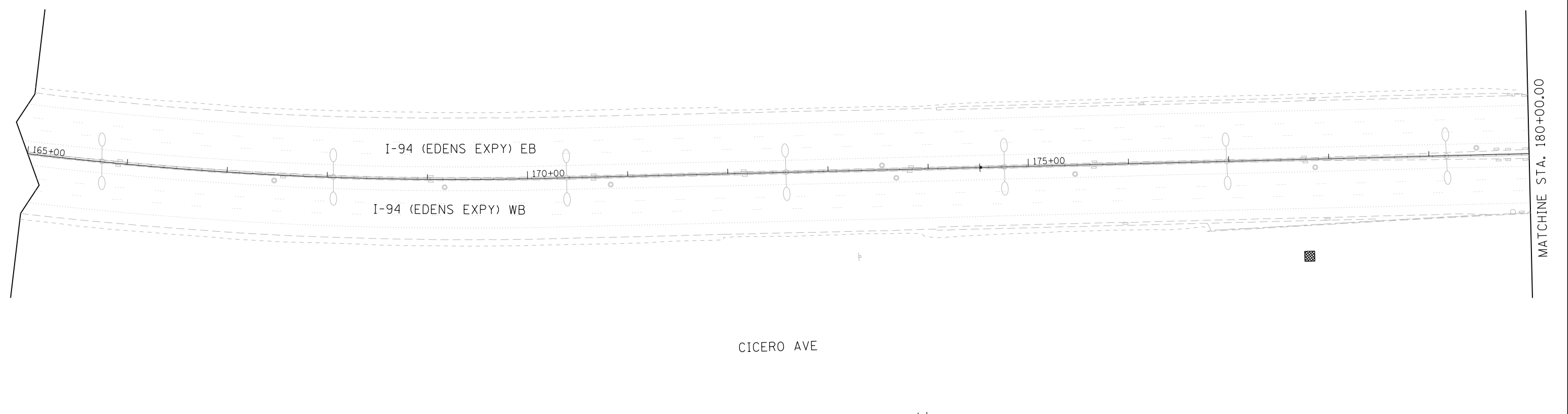

**PAVEMENT MARKING & RESTORATION LEGEND**

<p>① SHOULDER RUMBLE STRIPS, 16 INCH (64200116)</p> <p>② 4 INCH WHITE DOTTED LANE LINE, 3' DASH - 9' SKIP PERFORMED PLASTIC PAVEMENT MARKING, TYPE D - LINE 4" (78004620) GROOVING FOR RECESSED PAVEMENT MARKING 5" (78011025)</p> <p>③ 5 INCH WHITE LANE LINE, 10' DASH - 30' SKIP PERFORMED PLASTIC PAVEMENT MARKING, TYPE D - LINE 5" (78004625) GROOVING FOR RECESSED PAVEMENT MARKING 6" (78011030)</p>	<p>④ RAISED REFLECTIVE PAVEMENT MARKER (78100100) - ONE-WAY CRYSTAL</p> <p>⑤ THERMOPLASTIC PAVEMENT MARKING - LINE 4" (78000200) - YELLOW</p> <p>⑥ THERMOPLASTIC PAVEMENT MARKING - LINE 4" (78000200) - WHITE</p> <p>⑦ THERMOPLASTIC PAVEMENT MARKING - LINE 8" (78000500) - WHITE</p> <p>⑧ THERMOPLASTIC PAVEMENT MARKING - LINE 12" (78000600) - WHITE</p>
--	---

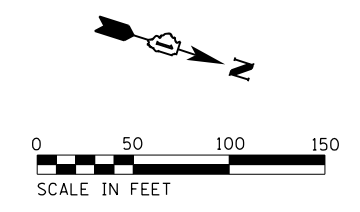

<b>Jacobs</b>	USER NAME = korabmp	DESIGNED - MMO	REVISED - 09/13/2022
	PLOT SCALE =	DRAWN - MMO	REVISED -
	PLOT DATE = 9/13/2022	CHECKED - MMK	REVISED -
		DATE - 06/25/2021	REVISED -

**STATE OF ILLINOIS**  
**DEPARTMENT OF TRANSPORTATION**

**I-94 / US 41 SMART HIGHWAY**  
**PAVEMENT MARKING & RESTORATION PLAN**

SCALE: 1"=50'      SHEET 8 OF 14 SHEETS      STA. 180+00 TO STA. 210+00

① REVISED SHEET 9/14/2022		<b>CIV-08</b>	
F.A.I. RTE.	SECTION	COUNTY	TOTAL SHEETS
94	2020-235-L	COOK	148
		SHEET NO. 36	
CONTRACT NO. 62N04			
ILLINOIS FED. AID PROJECT			















**LIGHTING LEGEND**

	EXISTING LIGHTING UNIT TO REMAIN
	EXISTING TWIN ARM LIGHTING UNIT TO REMAIN
	EXISTING LIGHTING UNIT TO REMAIN, LUMINAIRE TO BE REMOVED AND SALVAGED
	EXISTING TWIN ARM LIGHTING UNIT TO REMAIN, LUMINAIRES TO BE REMOVED AND SALVAGED
	EXISTING LIGHT POLE AND FOUNDATION TO REMAIN, ARMS, LUMINAIRES AND LIGHT CABLE TO BE REMOVED. LUMINAIRES TO BE SALVAGED
	EXISTING TWIN ARM LIGHTING UNIT AND FOUNDATION (UNLESS NOTED OTHERWISE) TO BE REMOVED, MEDIAN BARRIER TO BE RESTORED, LUMINAIRE TO BE SALVAGED
	EXISTING LIGHTING UNIT AND FOUNDATION (UNLESS NOTED OTHERWISE) TO BE REMOVED, LUMINAIRE TO BE SALVAGED
	EXISTING LIGHTING UNIT, INSTALL NEW LED LUMINAIRE (OUTPUT G), LUMINAIRE SAFETY CABLE ASSEMBLY AND INSTALL POLE GREEN GROUND WIRE
	EXISTING TWIN ARM LIGHT POLE ON MEDIAN BARRIER WALL. INSTALL NEW LED LUMINAIRE (OUTPUT G), LUMINAIRE SAFETY CABLE ASSEMBLY AND INSTALL POLE GREEN GROUND WIRE
	EXISTING TWIN ARM LIGHT POLE ON MEDIAN BARRIER WALL. INSTALL NEW 6FT DUAL MAST ARMS, NEW LED LUMINAIRES (OUTPUT G) AND LUMINAIRE SAFETY CABLE ASSEMBLY. INSTALL NEW POLE WIRE AND FUSE KITS
	PROPOSED LIGHTING UNIT 47.5 FT. MH ALUMINIUM POLE, 15 FT. MAST ARM, LED LUMINAIRE (OUTPUT H), IES TYPE II, 240V, ON NEW HELIX FOUNDATION AND TRANSFORMER BASE (UNLESS NOTED OTHERWISE)
	EXISTING UNDERPASS LUMINAIRE TO REMAIN
	EXISTING UNDERPASS LUMINAIRE TO BE REMOVED
	PROPOSED UNDERPASS LUMINAIRE, LED MOUNTING TYPE AS NOTED OUTPUT DESIGNATION F (UNLESS NOTED OTHERWISE)
	EXISTING HIGH MAST TOWER TO REMAIN
	EXISTING HIGH MAST TOWER AND FOUNDATION TO BE REMOVED
	EXISTING JUNCTION BOX TO REMAIN
	EXISTING HANDHOLE TO REMAIN
	PROPOSED JUNCTION BOX 18" X 18" X 8" ATTACHED TO STRUCTURE
	PROPOSED JUNCTION BOX 12" X 10" X 6" ATTACHED TO STRUCTURE
	PROPOSED JUNCTION BOX 6" X 6" X 4" ATTACHED TO STRUCTURE
	EXISTING LIGHTING CONTROLLER
	EXISTING ELECTRIC SERVICE INSTALLATION
	PROPOSED LIGHTING CONTROLLER
	PROPOSED ELECTRIC SERVICE INSTALLATION

	EXISTING CABLE TO REMAIN
	EXISTING CABLE TO BE REMOVED
	EXISTING CONDUIT TO REMAIN
	PROPOSED UNDERGROUND UNIT DUCT AS NOTED ON PLANS
	PROPOSED UNDERGROUND CONDUIT
	GROUND ROD 5/8" DIA. X 10'

**LIGHT POLE DESIGNATION**

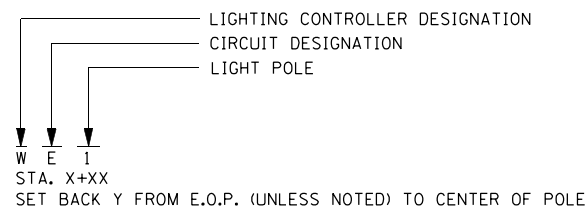

**LIGHTING BILL OF MATERIALS**

PAY ITEM DESCRIPTION	UNIT	QUANTITY
ELECTRIC SERVICE INSTALLATION	EACH	6
ELECTRIC UTILITY SERVICE CONNECTION	L SUM	1
UNDERGROUND CONDUIT, GALVANIZED STEEL, 4" DIA.	FOOT	2,053
UNDERGROUND CONDUIT, COILABLE NONMETALLIC CONDUIT, 2" DIA.	FOOT	119
CONDUIT ATTACHED TO STRUCTURE, 1" DIA., PVC COATED GALVANIZED STEEL	FOOT	3,828
CONDUIT ATTACHED TO STRUCTURE, 3" DIA., PVC COATED GALVANIZED STEEL	FOOT	126
JUNCTION BOX, STAINLESS STEEL, ATTACHED TO STRUCTURE, 6" X 6" X 4"	EACH	80
JUNCTION BOX, STAINLESS STEEL, ATTACHED TO STRUCTURE, 12" X 10" X 6"	EACH	31
JUNCTION BOX, STAINLESS STEEL, ATTACHED TO STRUCTURE, 18" X 18" X 8"	EACH	9
UNIT DUCT, 600V, 3-1C NO.4, 1/C NO.6 GROUND, (XLP-TYPE USE), 1 1/4" DIA. POLYETHYLENE	FOOT	80,626
ELECTRIC CABLE IN CONDUIT, 600V (XLP-TYPE USE) 1/C NO. 10	FOOT	17,242
ELECTRIC CABLE IN CONDUIT, 600V (XLP-TYPE USE) 1/C NO. 6	FOOT	1,086
ELECTRIC CABLE IN CONDUIT, 600V (XLP-TYPE USE) 1/C NO. 4	FOOT	1,840
ELECTRIC CABLE IN CONDUIT, 600V (XLP-TYPE USE) 1/C 350MCM	FOOT	468
LUMINAIRE, LED, ROADWAY, OUTPUT DESIGNATION G	EACH	84
LUMINAIRE, LED, ROADWAY, OUTPUT DESIGNATION H	EACH	288
LUMINAIRE, LED, UNDERPASS, SUSPENDED, OUTPUT DESIGNATION E	EACH	80
LIGHT POLE, ALUMINUM, 47.5 FT. M.H., 10 FT. MAST ARM	EACH	4
LIGHT POLE, ALUMINUM, 47.5 FT. M.H., 15 FT. MAST ARM	EACH	284
LIGHT POLE FOUNDATION, METAL, 15" BOLT CIRCLE, 10" X 8"	EACH	284
BREAKAWAY DEVICE, TRANSFORMER BASE, 15 INCH BOLT CIRCLE	EACH	284
REMOVAL OF LIGHTING UNIT, NO SALVAGE	EACH	244
REMOVAL OF POLE FOUNDATION	EACH	146
REMOVAL OF LIGHTING CONTROLLER	EACH	6
REMOVAL OF ELECTRIC SERVICE INSTALLATION	EACH	6
REMOVAL OF LIGHTING CONTROLLER FOUNDATION	EACH	4
REMOVE ELECTRIC CABLE FROM CONDUIT	FOOT	15,496
REMOVAL OF LUMINAIRE, SALVAGE	EACH	438
LIGHTING CONTROLLER, BASE MOUNTED, 480VOLT, 200AMP (DUAL), RADIO SCADA, FIBER OPTIC	EACH	6
ENGINEER'S FIELD OFFICE, TYPE A (SPECIAL)	CAL MO	18
REMOVAL OF UNDERPASS LIGHTING UNIT, NO SALVAGE	EACH	46
LUMINAIRE SAFETY CABLE ASSEMBLY	EACH	378
MAINTENANCE OF LIGHTING SYSTEM	CAL MO	18
REMOVAL OF TRANSFORMER BASE, SALVAGE	EACH	146
CONCRETE BARRIER WALL REPAIR	EACH	100
REMOVAL OF LIGHTING ARM, NO SALVAGE	EACH	50
6 FT DUAL MAST ARMS, 180 DEGREES APART	EACH	25



p:\Project\1404\ER\_jacobs\comb\1404\Documents\C9226688\_1-94\_U.S. 41\CS9226688\_708\cadd\708\select\Lighting Plans (50 - Scale).E2N04 - South Conventional\0162604 - ht-Lighting\_800.dgn



USER NAME = korabmp	DESIGNED - DU	REVISED - 09/13/2022
	DRAWN - DU	REVISED -
PLOT SCALE =	CHECKED - RAS	REVISED -
PLOT DATE = 9/13/2022	DATE - 06/25/2021	REVISED -

**STATE OF ILLINOIS  
DEPARTMENT OF TRANSPORTATION**

**I-94 /US 41 SMART HIGHWAY  
LIGHTING LEGEND**

SCALE: NTS SHEET 1 OF 78 SHEETS STA. TO STA.

REVISED SHEET 9/14/2022		LT-01	
F.A.I. RTE.	SECTION	COUNTY	TOTAL SHEETS
94	2020-235-L	COOK	148
		SHEET NO. 51	
CONTRACT NO. 62N04			
ILLINOIS FED. AID PROJECT			

- NOTES:
1. SEE SHEET LT-29 FOR UNDERPASS LIGHTING REMOVAL PLAN.
  2. LUMINAIRES AND POLE WIRING (HANDHOLE TO LUMINAIRE) TO BE REMOVED FROM THE STRUCTURE MOUNTED LIGHT POLES.
  3. THE EXISTING CONDUIT EMBEDDED IN THE MEDIAN BARRIER WALL IS CELLULOSE AND IS EASILY BREAKABLE AND COLLAPSIBLE. EXISTING CABLES CANNOT BE REMOVED. THE CONTRACTOR UNDER ANY CIRCUMSTANCES SHALL NOT REMOVE OR DAMAGE THE EXISTING CABLES EMBEDDED IN THE BARRIER WALL, AS IT WILL COLLAPSE THE CELLULOSE DUCT. THE CONTRACTOR SHALL TAKE PROPER MEASURES NOT TO DAMAGE THE EXISTING CABLES EMERGING FROM THE EXISTING MEDIAN BARRIER WALL FOUNDATIONS.
  4. EXISTING LIGHT POLE CA1/CB1 TO CA12/CB12 ON CENTER MEDIAN BARRIER SHALL REMAIN. EXISTING RIVETED ARMS TO BE REMOVED, NO SALVAGE, EXISTING HPS LUMINAIRES TO BE SALVAGED. EXISTING POLE WIRES TO BE REMOVED.

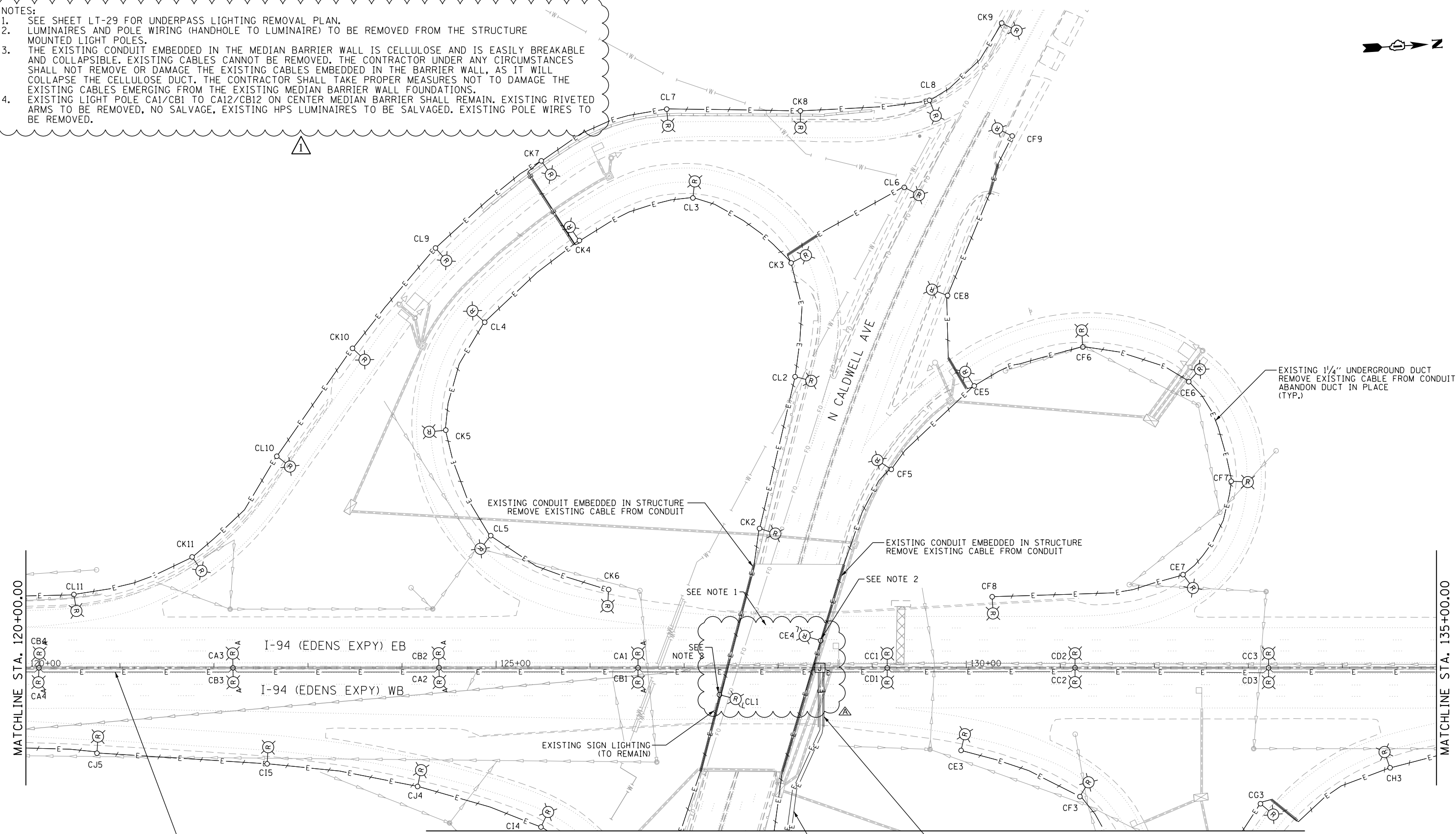

MATCHLINE STA. 120+00.00

MATCHLINE STA. 135+00.00

MATCHLINE A-A

EXISTING 4" CONDUIT EMBEDDED IN STRUCTURE  
EXISTING UNIT DUCT (3-1/C NO. 4, 1/4" DIA.) WITH NO. 6 BARE GROUND WIRE  
(TO REMAIN - TYP.)  
SEE NOTE 3 (TYP.)

EXISTING 3/2" UNDERGROUND CONDUIT  
(2) EXISTING UNIT DUCT (3-1/C NO. 4, 1/4" DIA.) WITH NO. 6 BARE GROUND WIRE  
(TO REMAIN)

EXISTING 1/4" UNDERGROUND DUCT  
(TO REMAIN)

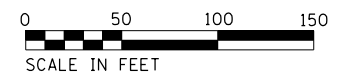

**Jacobs**

USER NAME = korabmp	DESIGNED - HP	REVISED - 09/13/2022
	DRAWN - MPK	REVISED -
PLOT SCALE =	CHECKED - RAS	REVISED -
PLOT DATE = 9/13/2022	DATE - 06/25/2021	REVISED -

**STATE OF ILLINOIS  
DEPARTMENT OF TRANSPORTATION**

**I-94 /US 41 SMART HIGHWAY  
I-94 LIGHTING REMOVAL PLANS**

SCALE: 1" = 50' SHEET 11 OF 78 SHEETS STA. 120+00 TO STA. 135+00

1 REVISED SHEET 9/14/2022				LT-11
F.A.I. RTE.	SECTION	COUNTY	TOTAL SHEETS	SHEET NO.
94	2020-235-L	COOK	148	61
CONTRACT NO. 62N04				
ILLINOIS FED. AID PROJECT				



- NOTES:
1. THE EXISTING CONDUIT EMBEDDED IN THE MEDIAN BARRIER WALL IS CELLULOSE AND IS EASILY BREAKABLE AND COLLAPSIBLE. EXISTING CABLES CANNOT BE REMOVED. THE CONTRACTOR UNDER ANY CIRCUMSTANCES SHALL NOT REMOVE OR DAMAGE THE EXISTING CABLES EMBEDDED IN THE BARRIER WALL, AS IT WILL COLLAPSE THE CELLULOSE DUCT. THE CONTRACTOR SHALL TAKE PROPER MEASURES NOT TO DAMAGE THE EXISTING CABLES EMERGING FROM THE EXISTING MEDIAN BARRIER WALL FOUNDATIONS.
  2. SEE SHEET LT-62 FOR UNDERPASS LIGHTING PLAN.
  3. INSTALL 2" CNC WITH 4-1/C NO. 4 AND 1/C NO. 6 GND BETWEEN LIGHT POLE AND EXISTING ELBOW IN BRIDGE. REUSE EXISTING CONDUIT EMBEDDED IN PARAPET.
  4. EXISTING LIGHT POLES BA1/BB1 TO BA13/BB13 AND CA1/CB1 TO CA12/CB12 ON CENTER MEDIAN BARRIER SHALL REMAIN. EXISTING RIVETED ARMS TO BE REMOVED, NO SALVAGE. EXISTING HPS LUMINAIRES TO BE SALVAGED, INSTALL TWIN 2-6 FT MAST ARMS CLAMPED AROUND EXISTING POLE SHAFT. INSTALL NEW POLE WIRES AND FUSE KITS; (RED, WHITE, GREEN ON CIRCUIT A AND BLACK, WHITE, GREEN ON CIRCUIT B). INSTALL NEW LED LUMINAIRES AND LUMINAIRE SAFETY CABLE ASSEMBLIES.

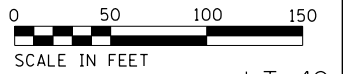
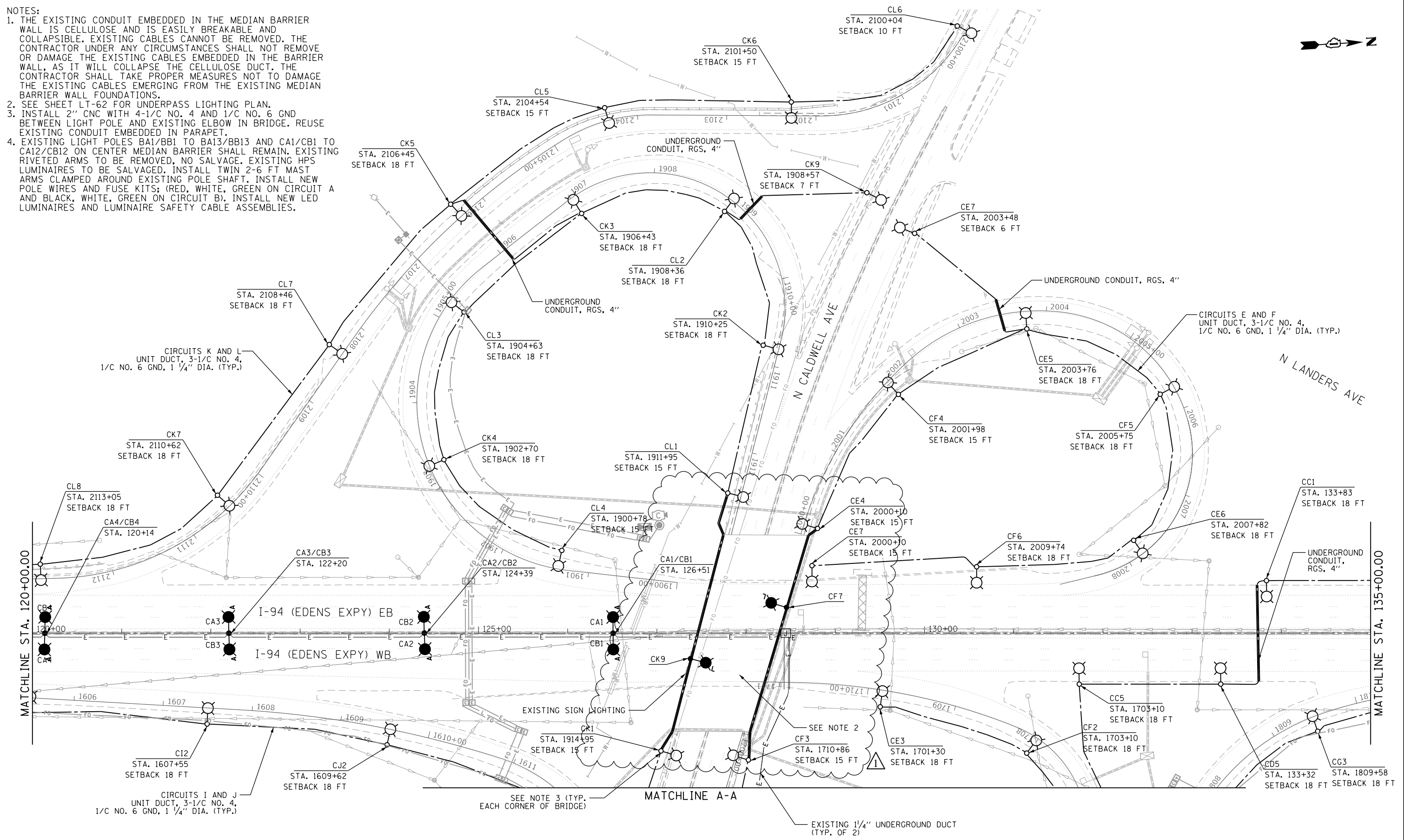

REVISED SHEET 9/14/2022 LT-42

Jacobs

USER NAME = korabmp	DESIGNED - RAS	REVISED - 09/13/2022
PLOT SCALE =	DRAWN - MPK	REVISED -
PLOT DATE = 9/13/2022	CHECKED - RAS	REVISED -
	DATE - 06/25/2021	REVISED -

STATE OF ILLINOIS  
DEPARTMENT OF TRANSPORTATION

I-94 / US 41 SMART HIGHWAY  
I-94 LIGHTING PLANS

SCALE: 1" = 50' SHEET 42 OF 78 SHEETS STA. 120+00 TO STA. 135+00

F.A.I. RTE.	SECTION	COUNTY	TOTAL SHEETS	SHEET NO.
94	2020-235-L	COOK	148	92

CONTRACT NO. 62N04  
ILLINOIS FED. AID PROJECT







