

GENERAL NOTES, CONT.

ORDERING LENGTH CONFIRMATION – DRAINAGE ITEMS

The Contractor shall consult with the Engineer in regard to the exact length of the box/pipe culverts, storm sewers, and/or pipe drains required prior to ordering these items.

NO PASSING ZONE VERIFICATION

The resident shall contact Operations to verify the location of no passing zones prior to placement of centerline striping.

JOB SPECIFIC NOTES

RIGHT-OF-WAY RESTRICTIONS

The Contractor shall be permitted to use the median for parking of paving equipment throughout the project limits. The locations shall be approved by the Resident Engineer and shall provide the following:

1. Any equipment parked in these areas shall be separated from traffic by barrier wall with impact attenuators on approach end of barrier wall or behind guardrail not including any Type 1 Terminals.
2. Storage of equipment shall not encroach upon the paved shoulder or be within 4' of the back of existing guardrail or 2' of temporary barrier wall. Barrier wall must be placed a minimum of 2' from the edge of passing lane.
3. Equipment parking areas shall be located on tangent sections of roadway and not in curves or any location with poor visibility of oncoming traffic.
4. The parking area shall be covered with aggregate to prevent tracking onto the roadway.

When lanes are reopened to traffic, the Contractor shall arrange within a reasonable time period to clean up and restore areas where equipment has been stored to the satisfaction of the Resident Engineer. The disturbed areas shall be seeded using Class 3 seed and covered with Mulch Method 3A or Erosion Control Blanket per Sections 250 and 251 of the Standard Specifications to restore turf to the median.

Any and all material, labor, and equipment costs necessary to comply with these required guidelines shall be included in the cost of project and will not be paid for separately.

IL 116 STATIONING

Contract plans were developed with surveyed stationing as shown in the plans and not with stationing stamped in pavement.

FAA HEIGHT RESTRICTIONS

FAA HEIGHT RESTRICTIONS								
LOCATION	LATITUDE	LONGITUDE	STATION	OFFSET	SITE ELEVATION	ABOVE GROUND LEVEL	ABOVE MEAN SEA LEVEL	
EB NORTH APPROACH	40-41-19.32N NAD 83	89-40-32.71 W	222+34	37.25 RT	618 FT	161 FT	779 FT	
EB SOUTH APPROACH	40-41-17N NAD 83	89-40-32.6W	224+69	46 RT	619 FT	161 FT	780 FT	
WB NORTH APPROACH	40-41-18.9N NAD 83	89-40-32.48W	222+77	33 RT	618 FT	161 FT	779 FT	
WB SOUTH APPROACH	40-41-16.46N NAD 83	89-40-31.41W	225+25	44.5 LT	619 FT	161 FT	780 FT	

1

CONDUIT IN PARAPET

The contractor shall furnish and install expansion/selection couplings on all embedded conduit sections that require them. the cost of the couplings shall be included in the bid price for the embedded conduit.

MODEL: Default
 FILE: \\nas01.pva.us:public\paw.bentley.com\PI\DOT\Documents\DOT_Offices\DH\dtdt_4\Project\3104_6888\ACAD\DATA\CAD\Sheets\31046888-4-shc-cover.dgn

USER NAME = \$USERS	DESIGNED -	REVISED -	STATE OF ILLINOIS DEPARTMENT OF TRANSPORTATION	GENERAL NOTES, CONT. & JOB SPECIFIC NOTES			F.A.I. RTE.	SECTION	COUNTY	TOTAL SHEETS	SHEET NO.
DRAWN -	REVISED -	474					(72-3HB-2)BR	PEORIA	126	3	
PLOT SCALE = 1:100	CHECKED -	REVISED -		SCALE:			SHEET 2 OF 3 SHEETS STA. TO STA.			CONTRACT NO. 68884	
PLOT DATE = 7/1/2022	DATE -	REVISED -					ILLINOIS		FED. AID PROJECT		

CONSTRUCTION CODE			
0004	0010	0010	0010
URBAN	BRIDGE	BRIDGE	BRIDGE
ROADWAY	REPLACEMENT	REPLACEMENT	REPLACEMENT
PEORIA	072-0252 (EB)	072-0253 (WB)	072-0253 (WB)
100% FEDERAL	90/10	90/10	100% FEDERAL

CODE NO.	ITEM	UNIT	TOTAL QUANTITY	100% FEDERAL	90/10	90/10	100% FEDERAL
20100500	TREE REMOVAL, ACRES	ACRE	0.75	0.75			
20200100	EARTH EXCAVATION	CU YD	3580	3580			
25000300	SEEDING, CLASS 3	ACRE	1.25	1.25			
25000400	NITROGEN FERTILIZER NUTRIENT	POUND	112.5	112.5			
25000500	PHOSPHORUS FERTILIZER NUTRIENT	POUND	112.5	112.5			
25000600	POTASSIUM FERTILIZER NUTRIENT	POUND	112.5	112.5			
25100127	MULCH, METHOD 3A	ACRE	1.25	1.25			
28000305	TEMPORARY DITCH CHECKS	FOOT	20	20			
28000400	PERIMETER EROSION BARRIER	FOOT	403	403			
28000500	INLET AND PIPE PROTECTION	EACH	4	4			
28100227	STONE RIPRAP, CLASS B4	TON	167	155		12	
28200200	FILTER FABRIC	SQ YD	1661	1644		17	
31100100	SUBBASE GRANULAR MATERIAL, TYPE A	TON	680	680			
40600275	BITUMINOUS MATERIALS (PRIME COAT)	POUND	235	235			



MODEL: Default
 FILE: M:\GIS\Projects\GIS\Projects\DOT_Offices\District_4\Projects\DA_68881\CAD\Drawings\CAD\Drawings\68881-Sub-500.dwg

USER NAME = \$USERS	DESIGNED -	REVISED -
PLOT SCALE = 1:100	DRAWN -	REVISED -
PLOT DATE = 8/8/2022	CHECKED -	REVISED -
	DATE -	REVISED -

**STATE OF ILLINOIS
DEPARTMENT OF TRANSPORTATION**

SUMMARY OF QUANTITIES

SCALE: SHEET 1 OF 10 SHEETS STA. TO STA.

F.A.I. RTE.	SECTION	COUNTY	TOTAL SHEETS	SHEET NO.
474	(72-3HB-2)BR	PEORIA	126	5
CONTRACT NO. 68884			ILLINOIS FED. AID PROJECT	

CONSTRUCTION CODE			
0004	0010	0010	0010
URBAN	BRIDGE	BRIDGE	BRIDGE
ROADWAY	REPLACEMENT	REPLACEMENT	REPLACEMENT
PEORIA	072-0252 (EB)	072-0253 (WB)	072-0253 (WB)
100% FEDERAL	90/10	90/10	100% FEDERAL

CODE NO.	ITEM	UNIT	TOTAL QUANTITY	0004	0010	0010	0010
40600295	POLYMERIZED BITUMINOUS MATERIALS (TACK COAT)	POUND	4638	4638			
40600982	HOT-MIX ASPHALT SURFACE REMOVAL - BUTT JOINT	SQ YD	3232	3232			
40603208	POLYMERIZED HOT-MIX ASPHALT BINDER COURSE, IL-9.5, N70	TON	128	128			
40603235	POLYMERIZED HOT-MIX ASPHALT BINDER COURSE, IL-19.0, N70	TON	126	126			
40604162	POLYMERIZED HOT-MIX ASPHALT SURFACE COURSE, IL-9.5, MIX "D", N70	TON	248	248			
40800050	INCIDENTAL HOT-MIX ASPHALT SURFACING	TON	11	11			
42000060	WELDED WIRE REINFORCEMENT	SQ YD	321	321			
42000080	PAVEMENT CONNECTOR (PCC) FOR BRIDGE APPROACH SLAB	SQ YD	487	487			
42000506	PORTLAND CEMENT CONCRETE PAVEMENT 10 1/4" (JOINTED)	SQ YD	707	707			
44000100	PAVEMENT REMOVAL	SQ YD	1172	1172			
44000400	GUTTER REMOVAL	FOOT	700	700			
44004250	PAVED SHOULDER REMOVAL	SQ YD	603	603			
48101200	AGGREGATE SHOULDERS, TYPE B	TON	23	23			
48203100	HOT-MIX ASPHALT SHOULDERS	TON	250	250			

MODEL: Default
 FILE: M:\GIS\Projects\GIS\Projects\DOT_Offices\District_4\Projects\DA_6888\CADData\CADsheets\6888-4-500.dgn

USER NAME = \$USERS	DESIGNED -	REVISED -
PLOT SCALE = 1:100	DRAWN -	REVISED -
PLOT DATE = 8/8/2022	CHECKED -	REVISED -
	DATE -	REVISED -

STATE OF ILLINOIS
DEPARTMENT OF TRANSPORTATION

SUMMARY OF QUANTITIES			
SCALE:	SHEET 2	OF 10 SHEETS	STA. TO STA.

F.A.I. RTE.	SECTION	COUNTY	TOTAL SHEETS	SHEET NO.
474	(72-3HB-2)BR	PEORIA	126	6
ILLINOIS FED. AID PROJECT			CONTRACT NO. 68884	

CONSTRUCTION CODE			
0004	0010	0010	0010
URBAN	BRIDGE	BRIDGE	BRIDGE
ROADWAY	REPLACEMENT	REPLACEMENT	REPLACEMENT
PEORIA	072-0252 (EB)	072-0253 (WB)	072-0253 (WB)
100% FEDERAL	90/10	90/10	100% FEDERAL

CODE NO.	ITEM	UNIT	TOTAL QUANTITY				
51100100	SLOPE WALL 4 INCH	SQ YD	1949		998		951
51201610	FURNISHING STEEL PILES HP12X63	FOOT	1138		569	569	
51201900	FURNISHING STEEL PILES HP14X89	FOOT	1560		806		754
51202305	DRIVING PILES	FOOT	2698		1375	1323	
51203610	TEST PILE STEEL HP12X63	EACH	2		1	1	
51203900	TEST PILE STEEL HP14X89	EACH	4		2	2	
51204650	PILE SHOES	EACH	56		28	28	
51500100	NAME PLATES	EACH	2		1	1	
52100010	ELASTOMERIC BEARING ASSEMBLY, TYPE I	EACH	24		12	12	
52100520	ANCHOR BOLTS, 1"	EACH	48		24	24	
52100530	ANCHOR BOLTS, 1 1/4"	EACH	48		24	24	
52200010	TEMPORARY SHEET PILING	SQ FT	660	660			
52200020	TEMPORARY SOIL RETENTION SYSTEM	SQ FT	3078	660	1532	886	
54003000	CONCRETE BOX CULVERTS	CU YD	42.6	42.6			

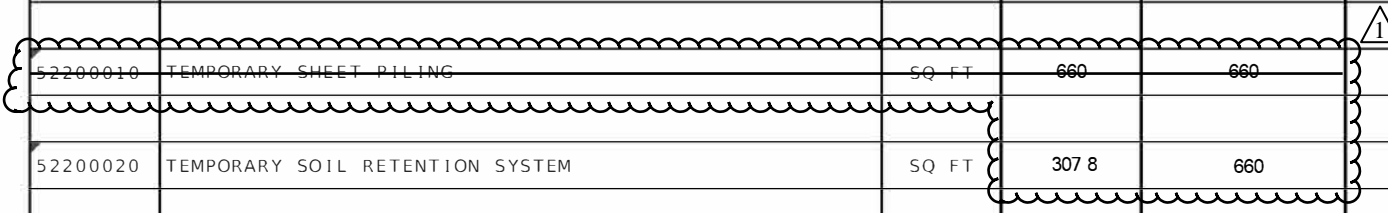

MODEL: Default
 FILE: M:\GIS\Projects\GIS\Projects\DOT\Office\District_4\Projects\DOT_6888\CAD\Drawings\CAD\Drawings\DOT_6888\4-818-500.dgn

USER NAME = \$USERS	DESIGNED -	REVISED -
PLOT SCALE = 1:100	DRAWN -	REVISED -
PLOT DATE = 8/8/2022	CHECKED -	REVISED -
	DATE -	REVISED -

**STATE OF ILLINOIS
DEPARTMENT OF TRANSPORTATION**

SUMMARY OF QUANTITIES			
SCALE:	SHEET 4	OF 10 SHEETS	STA. TO STA.

F.A.I. RTE.	SECTION	COUNTY	TOTAL SHEETS	SHEET NO.
474	(72-3HB-2)BR	PEORIA	126	8
ILLINOIS FED. AID PROJECT			CONTRACT NO. 68884	

CODE NO.	ITEM	UNIT	TOTAL QUANTITY	CONSTRUCTION CODE			
				0004	0010	0010	0010
				URBAN	BRIDGE	BRIDGE	BRIDGE
				ROADWAY	REPLACEMENT	REPLACEMENT	REPLACEMENT
				PEORIA	072-0252 (EB)	072-0253 (WB)	072-0253 (WB)
	100% FEDERAL	90/10	90/10	100% FEDERAL			
* 78100100	RAISED REFLECTIVE PAVEMENT MARKER	EACH	7	7			
* 78200005	GUARDRAIL REFLECTORS, TYPE A	EACH	6	6			
78300200	RAISED REFLECTIVE PAVEMENT MARKER REMOVAL	EACH	15	15			1
81200230	CONDUIT EMBEDDED IN STRUCTURE, 2' DIA., PVC	FOOT	500		500		
X0322881	TREE TRIMMING	EACH	1	1			1
81300948	JUNCTION BOX, STAINLESS STEEL, ATTACHED TO STRUCTURE, 24"X24"X10"	EACH	2		2		
X0326662	CURED-IN-PLACE PIPE LINER, 24"	FOOT	40	40			
X0326663	CURED-IN-PLACE PIPE LINER, 30"	FOOT	76	76			
X0426200	DEWATERING	L SUM	1	1			
X2130010	EXPLORATION TRENCH, SPECIAL	FOOT	254	254			
X2810228	STONE RIPRAP, CLASS B4 (SPECIAL)	TON	1096	1096			
X4420201	PAVEMENT PATCHING (SPECIAL)	SQ YD	299	299			
X5015225	PIPE CULVERT REMOVAL (SPECIAL)	FOOT	448	448			
X5030250	BRIDGE DECK GROOVING (LONGITUDINAL)	SQ YD	1724		984	740	
54390382	INSERTION CULVERT LINER 108"	FOOT	526	526			1
X6050310	FILLING INLETS, SPECIAL	EACH	1	1			

*= SPECIALTY ITEM

MODEL: Default
 FILE: M:\GIS\Projects\68884\Drawings\DOT\Office\Drawings\68884\CAD\Drawings\68884-818-500.dgn

USER NAME = \$USERS	DESIGNED -	REVISED -
PLOT SCALE = 1:100	DRAWN -	REVISED -
PLOT DATE = 8/8/2022	CHECKED -	REVISED -
	DATE -	REVISED -

**STATE OF ILLINOIS
DEPARTMENT OF TRANSPORTATION**

SUMMARY OF QUANTITIES

SCALE: SHEET 8 OF 10 SHEETS STA. TO STA.

F.A.I. RTE.	SECTION	COUNTY	TOTAL SHEETS	SHEET NO.
474	(72-3HB-2)BR	PEORIA	126	12
ILLINOIS FED. AID PROJECT			CONTRACT NO. 68884	

I-474 PAVEMENT TABLE

LOCATION	LENGTH	DL & PL WIDTH	AVG. RAMP E WIDTH	HMA SURFACE REMOVAL - BUTT JOINT	POLY. HMA SURFACE COURSE, IL-9.5, MIX "D", N70	POLY. HMA BINDER COURSE, IL-9.5, N70	POLY. HMA BINDER COURSE, IL-19.0, N70	PAVEMENT REMOVAL	SUBBASE GRANULAR MATERIAL, TYPE A	PCC PAVEMENT 10 1/4" (JOINTED)	WELDED WIRE REINFORCEMENT	PAVEMENT CONNECTOR (PCC) FOR BRIDGE APPROACH SLAB	POLYMERIZED BITUMINOUS MATERIALS (TACK COAT)	MATERIAL TRANSFER DEVICE		
					2"	1.5" OR 2"	VARIES		VARIES				0.08 LBS/SQ FT			
					TON	TON	TON		TON				SQ. YD.		TON	
EASTBOUND I-474																
STA. 218+50.0	TO	219+42.0	92.0	24.0	17.0	419.2	46.9						301.8	46.9		
STA. 219+42.0	TO	219+92.0	50.0	24.0	15.8	221.0	24.8	24.8					318.2	49.5		
STA. 219+92.0	TO	220+34.0	42.0	24.0	14.8	181.0	20.3	20.3					390.9	60.8		
STA. 220+34.0	TO	221+22.8	88.8	24.0	13.3	367.8	41.2	41.2					1059.2	187.9		
STA. 221+22.8	TO	221+39.5	16.7	EXPANSION JOINT												
STA. 221+39.5	TO	221+84.9	45.4	24.0	11.5				178.8	114.1	178.8					
STA. 221+84.9	TO	222+14.5	VARIES						196.8	69.9	104.2	139.8				
STA. 222+14.5	TO	224+92.4	BRIDGE													
STA. 224+92.4	TO	225+16.6	VARIES						93.2	29.4	80.9	115.1				
STA. 225+16.6	TO	225+71.2	54.6	24.0	3.8				168.7	53.8	168.7					
STA. 225+71.2	TO	225+87.9	16.7	EXPANSION JOINT												
STA. 225+87.9	TO	226+32.5	44.7	24.0	2.3	130.6	14.6	11.0					188.1	25.6		
STA. 226+32.5	TO	226+92.0	59.5	24.0	0.9	164.7	18.4						237.1	18.4		
WESTBOUND I-474																
STA. 219+90.0	TO	221+27.0	137.0	24.0		365.3	40.9						263.0	40.9		
STA. 221+27.0	TO	221+54.4	27.4	24.0		73.2	8.2	6.1					105.4	14.3		
STA. 221+54.4	TO	221+71.1	16.7	EXPANSION JOINT												
STA. 221+71.1	TO	222+35.0	63.9	24.0					170.3	68.8	170.3					
STA. 222+35.0	TO	222+59.4	24.4	24.0					94.7	32.4	65.2	116.0				
STA. 222+59.4	TO	225+37.3	BRIDGE													
STA. 225+37.3	TO	225+63.8	26.5	24.0					80.7	25.8	70.6	116.0				
STA. 225+63.8	TO	226+34.6	70.8	24.0					188.9	51.6	188.9					
STA. 226+34.6	TO	226+51.3	16.7	EXPANSION JOINT												
STA. 226+51.3	TO	227+59.3	108.0	24.0		288.0	32.3	24.2					414.7	56.4		
SUBTOTAL						2210.7	247.6	127.5	125.8	1172	445.7	706.7	320.9	486.8	3278.4	500.9
SHOULDER TABLE						1021.6				233.6				1360.0		
JOB TOTAL						3232.0	248.0	128.0	126.0	1172	679.0	707.0	321.0	487.0	4638.0	501.0



MODEL: Default
 FILE: M:\GIS\Projects\GIS\Projects\DOT_Offices\District_4\Projects\DOT_68884\CAD\Drawings\CAD\Drawings\DOT_68884-474-schedule.dgn

USER NAME = \$USERS	DESIGNED -	REVISED -
	DRAWN -	REVISED -
PLOT SCALE = 1:100	CHECKED -	REVISED -
PLOT DATE = 7/26/2022	DATE -	REVISED -

STATE OF ILLINOIS
DEPARTMENT OF TRANSPORTATION

SCHEDULE OF QUANTITIES

SCALE: SHEET 1 OF 6 SHEETS STA. TO STA.

F.A.I. RTE.	SECTION	COUNTY	TOTAL SHEETS	SHEET NO.
474	(72-3HB-2)BR	PEORIA	126	15
ILLINOIS FED. AID PROJECT			CONTRACT NO. 68884	

I-474 SHOULDER TABLE														
LOCATION				LENGTH	INSIDE SHLDR WIDTH	OUTSIDE SHLDR WIDTH	HMA SURFACE REMOVAL - BUTT JOINT	HMA SHOULDERS	PAVED SHOULDER REMOVAL	PCC SHOULDERS 10 1/4"	SUBBASE GRANULAR MATERIAL, TYPE A	POLY. BITUMINOUS MATERIALS (TACK COAT)	AGGREGATE SHOULDERS, TYPE B	SHOULDER RUMBLE STRIPS, 16 INCH
								VARIES	SQ. YD.	SQ. YD.	VARIES	0.08 LBS/SQ FT	TON	TON
				FOOT	FOOT	FOOT	SQ. YD.	SQ. YD.	SQ. YD.	TON	POUND	TON	FOOT	
EASTBOUND I-474														
STA.	218+50.0	TO	219+42.0	92.0	6.0	6.0	122.7	13.7				88.3		92.0
STA.	219+42.0	TO	219+92.0	50.0	6.0	6.0	66.7	14.9				96.0		50.0
STA.	219+92.0	TO	220+34.0	42.0	6.0	6.0	56.0	18.8				121.0		42.0
STA.	220+34.0	TO	221+22.8	88.8	6.0	6.0	118.4	60.5				255.7		88.8
STA.	221+22.8	TO	221+39.5	16.7	6.0	6.0								
STA.	221+39.5	TO	221+84.9	45.4	6.0	6.0		60.5	60.5	40.1				
STA.	221+84.9	TO	222+14.5		VARIES			68.4		22.9				
STA.	222+14.5	TO	224+92.4		BRIDGE									
STA.	224+92.4	TO	225+16.6		VARIES			39.4		13.9			2.8	
STA.	225+16.6	TO	225+71.2	54.6	6.0	6.6		76.3	76.3	23.5			6.2	
STA.	225+71.2	TO	225+87.9	16.7	6.0	7.2							1.9	
STA.	225+87.9	TO	226+32.5	44.6	6.0	7.7	67.8	13.3			97.6		5.1	89.2
STA.	226+32.5	TO	226+92.0	59.5	6.0	10.0	105.8	11.8			76.2		6.8	119.0
WESTBOUND I-474														
STA.	219+90.0	TO	221+27.0	137.0	6.0	10.0	243.6	27.3				175.4		274.0
STA.	221+27.0	TO	221+54.4	27.4	6.0	10.0	48.7	9.5				70.1		54.8
STA.	221+54.4	TO	221+71.1	16.7	6.0	10.0								
STA.	221+71.1	TO	222+35.0	63.9	6.0	10.0		113.5	113.5	41.9				
STA.	222+35.0	TO	222+59.4	24.4	6.0	10.0		66.7		24.9				
STA.	222+59.4	TO	225+37.3		BRIDGE									
STA.	225+37.3	TO	225+63.8	26.5	6.0	10.0		52.6		14.9				
STA.	225+63.8	TO	226+34.6	70.8	6.0	10.0		125.9	125.9	30.1				
STA.	226+34.6	TO	226+51.3	16.7	6.0	10.0								
STA.	226+51.3	TO	227+59.3	108.0	6.0	10.0	192.0	37.6			276.5			216.0
SUBTOTAL							1021.6	207.6	603	376.3	212.2	1256.8	22.7	1025.8
IL 116 STAGING TABLES								42.0			21.3	103.2		
JOB TOTAL							SEE PVT TABLE	250.0	603	376.0	SEE PVT TABLE		23.0	1026.0

EXPANSION JOINT												
LOCATION				LENGTH	DL & PL WIDTH	AVG. RAMP E WIDTH	INSIDE SHLDR WIDTH	OUTSIDE SHLDR WIDTH	PAVEMENT PATCHING (SPECIAL)	EXPANSION JOINT (SPECIAL)	PIPE UNDERDRAINS 4" (SPECIAL)	CONCRETE HEADWALLS FOR PIPE DRAINS
EASTBOUND I-474												
STA.	221+22.8	TO	221+39.5	16.7	24.0	12.1	6.0	6.0	85.4	48.1	12.1	2.0
STA.	225+71.2	TO	225+87.9	16.7	24.0	3.1	6.0	7.2	71.6	40.3	6.5	2.0
NORTH BRIDGE APPROACH												
SOUTH BRIDGE APPROACH												
WESTBOUND I-474												
STA.	221+54.4	TO	221+71.1	16.7	24.0		6.0	10.0	71.1	40.0	9.0	2.0
STA.	226+34.6	TO	226+51.3	16.7	24.0		6.0	10.0	71.1	40.0	14.0	2.0
NORTH BRIDGE APPROACH												
SOUTH BRIDGE APPROACH												
SUBTOTAL									299.3	168.4	41.6	16.0
JOB TOTAL									299.0	168.0	42.0	16.0

MODEL: Default
 FILE: M:\GIS\Projects\I-474\I-474_Schedule.dgn
 PLOT DATE = 7/26/2022

USER NAME = \$USERS	DESIGNED -	REVISED -
	DRAWN -	REVISED -
PLOT SCALE = 1:100	CHECKED -	REVISED -
PLOT DATE = 7/26/2022	DATE -	REVISED -

**STATE OF ILLINOIS
DEPARTMENT OF TRANSPORTATION**

SCHEDULE OF QUANTITIES			
SCALE:	SHEET 2	OF 6	SHEETS
STA.		TO STA.	

F.A.I. RTE.	SECTION	COUNTY	TOTAL SHEETS	SHEET NO.
474	(72-3HB-2)BR	PEORIA	126	16
ILLINOIS FED. AID PROJECT			CONTRACT NO. 68884	

IL 116 STAGING								
LOCATION	EARTH EX. CU. YD.	SUBBASE GRANULAR MATERIAL, TYPE A	HMA SHOULDERS	INCIDENTAL HMA SURFACING	BITUMINOUS MATERIALS (PRIME COAT)	POLY. BITUMINOUS MATERIALS (TACK COAT)	GUTTER REMOVAL FOOT	CLASS SI CONCRETE (OUTLET), SPECIAL
		4" TON	8" TON	TON	0.25 LBS/SQ. FT. POUND	0.08 LBS/SQ. FT. POUND		CU. YD.
LT. IL 116 SLOPE WALL (EB)	2412							
STA. 16+58.0 TO 17+18.0				7.5	23.6	19.4	60.0	12.7
STA. 18+52.8 TO 19+05.6	2.3							
STA. 20+50.4 TO 21+82.5	22.7	21.3	42.0		210.9	67.5	132.0	
RT. IL 116 SLOPE WALL (WB)	1141							
STA. 18+92.5 TO 19+28.4				3.8		16.3		
SUBTOTAL	3578	21.3	42.0	11.3	234.5	103.2	192.0	12.7
TOTAL	3578	SEE SHLDR TABLE		11.0	235.0	SEE SHLDR TABLE	SEE IL 116 PLAN TABLE	

PAVEMENT MARKINGS										
LOCATION	MODIFIED URETHANE PAVEMENT MARKING LINE - 6"				GROOVING FOR RECESSED PAVEMENT MARKING 7" FOOT	MODIFIED URETHANE PAVEMENT MARKING LINE - 8"		GROOVING FOR RECESSED PAVEMENT MARKING 9" FOOT	RAISED REFLECTIVE PAVEMENT MARKER EACH	RAISED REFLECTIVE PAVEMENT MARKER REMOVAL EACH
	WHITE SOLID FOOT	YELLOW SOLID FOOT	WHITE SKIP FOOT	YELLOW SKIP FOOT		WHITE SKIP FOOT	WHITE SOLID FOOT			
	EASTBOUND I-474									
STA. 191+20.0 TO 212+00.0			520.0		520.0					
STA. 212+00.0 TO 213+11.5	111.5	111.5	30.0		253.0					
STA. 213+11.5 TO 219+42.2	630.7	630.7	160.0		1421.4		1262.0	1262.0		
STA. 219+42.2 TO 222+14.5	272.3	272.3	70.0		614.6	69.0		69.0	3.0	5.0
STA. 222+14.5 TO 224+92.4	277.9	277.9	70.0		625.8	69.0		69.0		
STA. 224+92.4 TO 226+84.3	191.9	191.9	50.0		433.8	48.0		48.0		
STA. 226+84.3 TO 227+35.0	50.7	50.7	10.0		111.4				1.0	3.0
STA. 227+35.0 TO 230+00.0	265.0	265.0	60.0		590.0					
WESTBOUND I-474										
STA. 217+49.0 TO 219+90.0	241.0	241.0	60.0		542.0					
STA. 219+90.0 TO 222+59.4	269.4	269.4	70.0		608.8				2.0	4.0
STA. 222+59.4 TO 225+37.3	277.9	277.9	70.0		625.8					
STA. 225+37.3 TO 230+88.0	550.7	550.7	140.0		1241.4				1.0	3.0
STA. 230+88.0 TO 251+68.0			520.0		520.0					
IL 116										
STA. 16+00.0 TO 23+00.0	1400.0	700.0		180.0						
SUBTOTAL	4539.0	3839.0	1830.0	180.0	8108.0	186.0	1262.0	1448.0	7.0	15.0
TOTAL	10388.0				8108.0	1448.0	1448.0	1448.0	7.0	15.0

TEMPORARY PAVEMENT MARKINGS						
LOCATION	TEMPORARY PAVEMENT MARKING - LINE 6"- PAINT				TEMPORARY PAVEMENT MARKING - LINE 8"- PAINT	
	WHITE SOLID FOOT	YELLOW SOLID FOOT	WHITE SKIP FOOT	YELLOW SKIP FOOT	WHITE SKIP FOOT	WHITE SOLID FOOT
	EASTBOUND I-474					
STA. 218+50.0 TO 219+42.2	92.2	92.2	20.0			185.0
STA. 219+42.2 TO 222+14.5	272.3	272.3	70.0		69.0	
STA. 222+14.5 TO 224+92.4	277.9	277.9	70.0		69.0	
STA. 224+92.4 TO 226+84.3	191.9	191.9	50.0		48.0	
STA. 226+84.3 TO 226+92.0	7.7	7.7	0.0			
WESTBOUND I-474						
STA. 219+90.0 TO 222+59.4	269.4	269.4	70.0			
STA. 222+59.4 TO 225+37.3	277.9	277.9	70.0			
STA. 225+37.3 TO 227+59.3	222.0	222.0	60.0			
SUBTOTAL	1611.3	1611.3	410.0	0.0	186.0	185.0
TOTAL	3633.0				371.0	

MODEL: Default
 FILE: M:\116\116-2\116-2.dwg
 PLOT DATE = 7/26/2022
 USER NAME = \$USER\$
 DESIGNED -
 DRAWN -
 CHECKED -
 DATE -
 REVISED -
 REVISED -
 REVISED -
 REVISED -
 STATE OF ILLINOIS
 DEPARTMENT OF TRANSPORTATION
 SCHEDULE OF QUANTITIES
 SCALE: SHEET 6 OF 6 SHEETS STA. TO STA.
 F.A.I. RTE. SECTION COUNTY TOTAL SHEETS SHEET NO.
 474 (72-3HB-2)BR PEORIA 126 20
 CONTRACT NO. 68884
 ILLINOIS FED. AID PROJECT

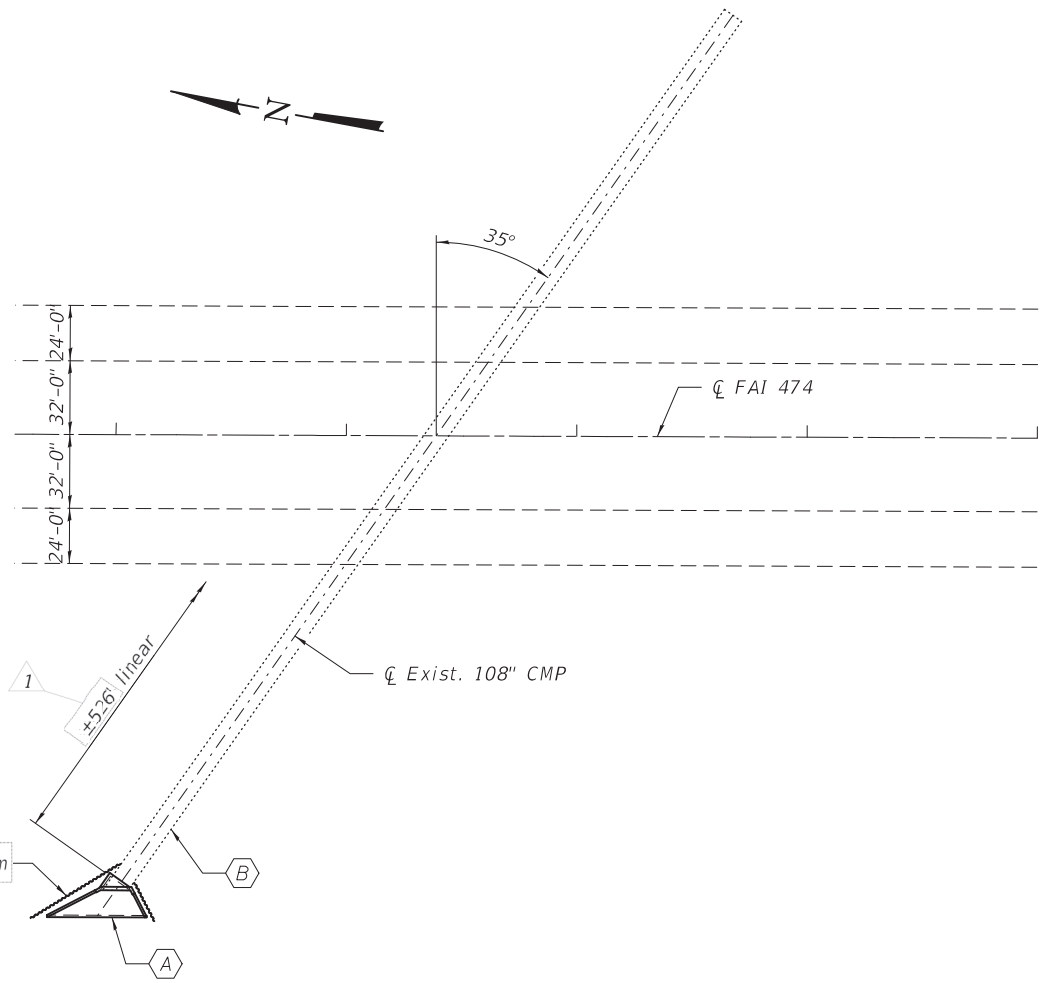

- (A) - Remove and replace existing concrete end section and replace with a new cast in place concrete end section. (West end only)
- (B) - Install a new culvert liner. Per material properties and installation requirements, see Art. 543 of the Standard Specifications. Estimated fill height = 50'-0".

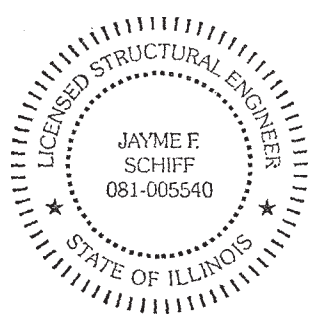

EXPIRES 11-30-2022

GENERAL NOTES

Reinforcement bars designated (E) shall be epoxy coated.
 Plan dimensions and details relative to existing plans are subject to nominal construction variations. The Contractor shall field verify existing dimensions and details affecting new construction and make necessary approved adjustments prior to construction or ordering of materials. Such variations shall not be cause for additional compensation for a change in scope of the work, however, the Contractor will be paid for the quantity actually furnished at the unit price bid for the work.

1 All incoming culverts shall be located, inspected, cleaned and repaired prior to the insertion liner being placed in the host culvert. Upon completion of the insertion liner, all drainage from the incoming culverts shall be reestablished to the satisfaction of the Engineer. This work shall be included in the cost of the INSERTION CULVERT LINER.

BILL OF MATERIAL

ITEM	UNIT	QUANTITY
Insertion Culvert Liner 108"	Foot	526
Concrete Removal	Cu. Yd.	22.8
Concrete Box Culvert	Cu. Yd.	42.6
Reinforcement Bars, Epoxy Coated	Pound	12850
Temporary Soil Retention System	Sq. Ft.	660

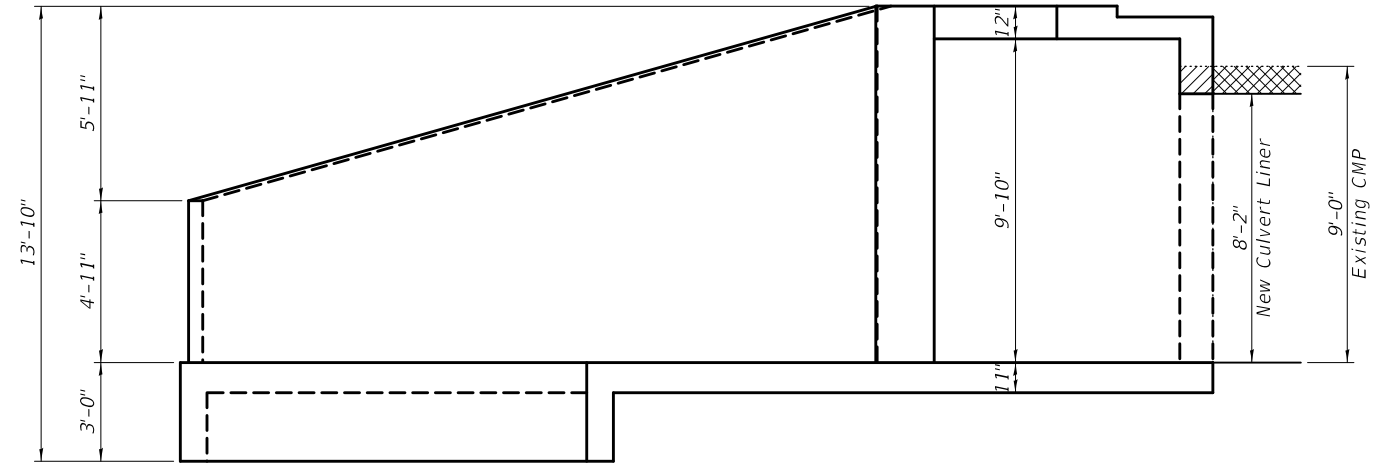
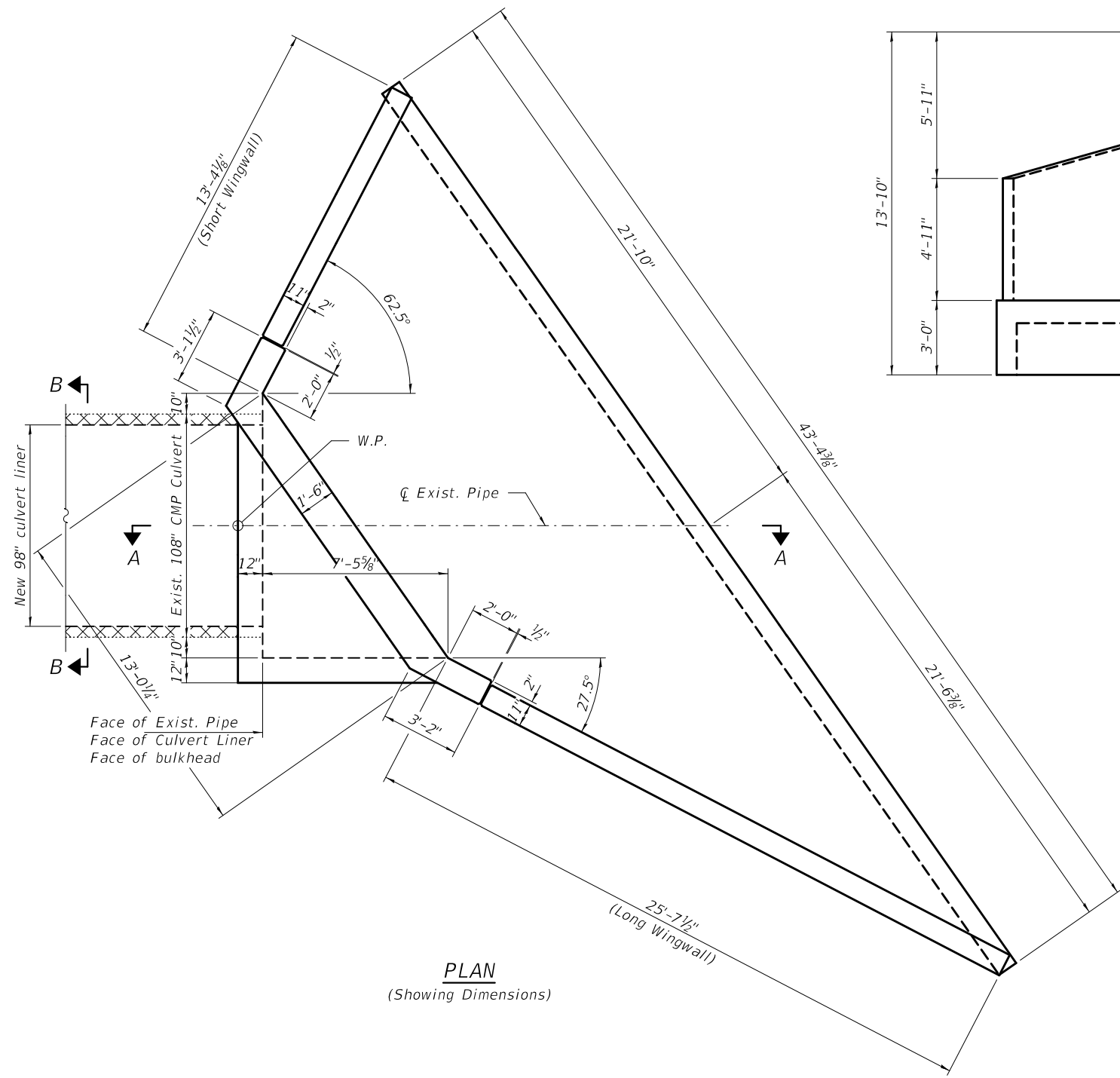

SECTION A-A

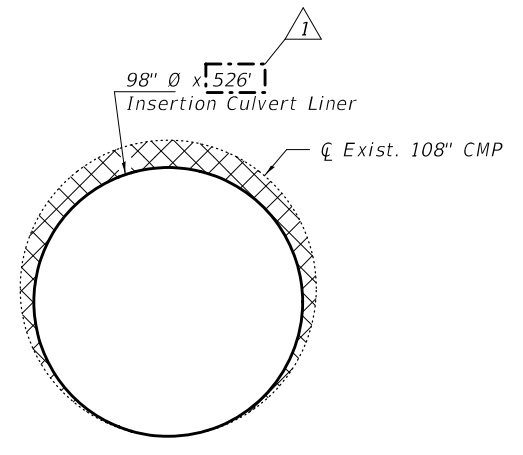

SECTION B-B

BILL OF MATERIAL

Bar	No.	Size	Length	Shape
b(E)	12	#6	30'-2"	—
b1(E)	12	#6	32'-11"	—
b2(E)	4	#6	23'-2"	—
b3(E)	2	#6	33'-5"	—
b4(E)	2	#6	14'-4"	—
b5(E)	14	#6	11'-11"	—
d(E)	43	#4	4'-9"	—
h(E)	28	#6	23'-2"	—
h1(E)	13	#6	23'-7"	—
h2(E)	2	#6	23'-11"	—
h3(E)	28	#6	10'-11"	—
h4(E)	13	#6	11'-0"	—
h5(E)	2	#6	12'-4"	—
h6(E)	3	#6	12'-10"	—
h7(E)	3	#7	12'-10"	—
h8(E)	11	#6	9'-0"	—
h9(E)	10	#6	9'-2"	—
h10(E)	11	#6	9'-8"	—
h11(E)	8	#6	10'-6"	—
h12(E)	18	#6	10'-2"	—
h13(E)	22	#6	4'-2"	—
h14(E)	11	#6	4'-9"	—
h15(E)	6	#6	13'-4"	—
h16(E)	16	#6	6'-2"	—
h17(E)	8	#5	10'-9"	—
h18(E)	14	#6	3'-2"	—
h19(E)	4	#6	1'-10"	—
s(E)	13	#5	4'-7"	—
v(E)	84	#6	15'-0"	—
v1(E)	84	#6	19'-8"	—
v2(E)	84	#6	5'-10"	—
v3(E)	84	#6	6'-6"	—
w(E)	21	#6	13'-7"	—
w1(E)	5	#6	31'-5"	—
w2(E)	8	#6	31'-7"	—
w(3E)	7	#6	15'-0"	—
Concrete Box Culverts	Cu. Yd.		42.6	
Reinforcement Bars, Epoxy Coated	Pound		12850	

Grout or cellular concrete.
See Standard Specifications.

DESIGNED - VHV	EXAMINED - <i>Timothy A. ...</i>	DATE - AUGUST 19, 2022
CHECKED - JSB	PASSED - <i>Joanne F. ...</i>	REVISED 09/13/2022 ATH
DRAWN - daburdell		REVISED -
CHECKED - VHV JSB		

**STATE OF ILLINOIS
DEPARTMENT OF TRANSPORTATION**

**CULVERT DETAILS
SN 072-1008**

SHEET NO. 2 OF 5 SHEETS

F.A.I. RTE.	SECTION	COUNTY	TOTAL SHEETS	SHEET NO.
474	(72-3HB-2)BR	PEORIA	126	119
				CONTRACT NO. 68884
ILLINOIS FED. AID PROJECT				