

F.A.I. RTE.	SECTION	COUNTY	TOTAL SHEETS	SHEET NO.
94/90		COOK	556	47
STA.	TO STA.			
FED. ROAD DIST. NO.	ILLINOIS	FED. AID PROJECT		
62300	818, ETC. 2324.6-IPR-8			

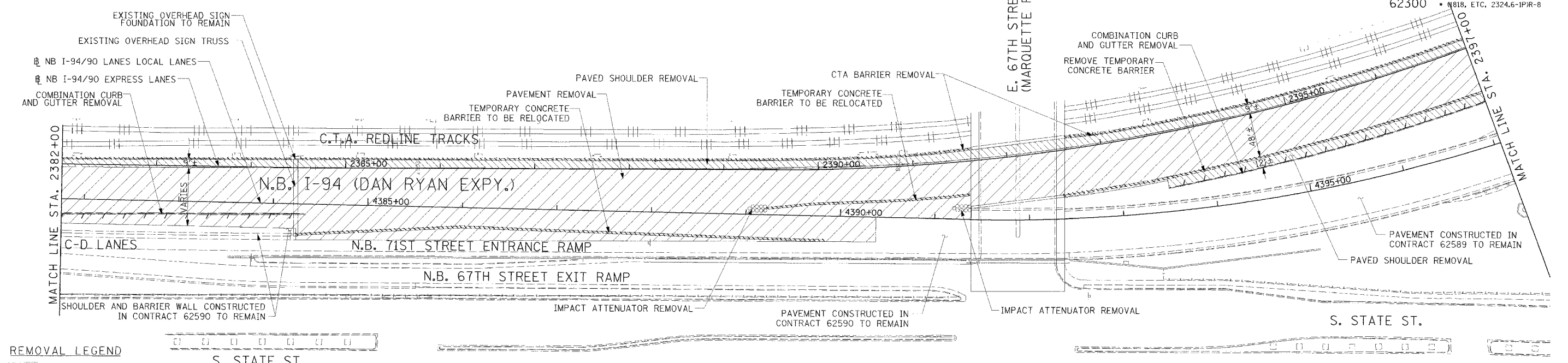

- REMOVAL LEGEND**
- PAVEMENT REMOVAL
 - PAVED SHOULDER REMOVAL
 - COMBINATION CURB AND GUTTER REMOVAL
 - CONCRETE BARRIER OR GUARD RAIL REMOVAL

NOTE:
1. THE LOCATION OF PAVEMENT CONSTRUCTED IN PREVIOUS CONTRACTS IS BASED OFF OF CONTRACT PLAN DRAWINGS. THE CONTRACTOR MUST VERIFY LIMITS OF PREVIOUS CONSTRUCTION IN THE FIELD.

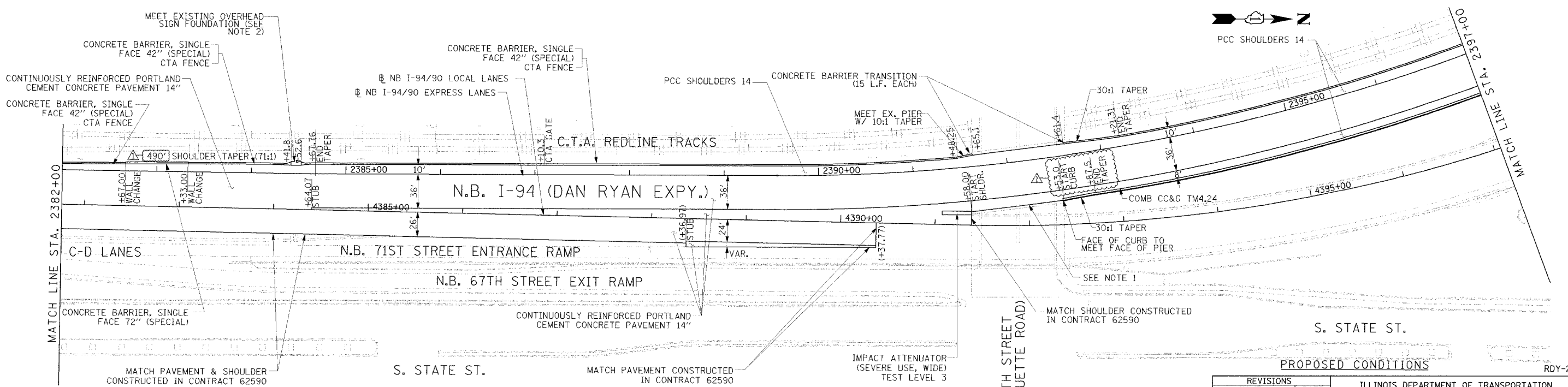

- NOTES:**
- BRIDGE OVER EXPRESS LANES OMITTED FOR CLARITY.
 - TAPER FACE OF BARRIER TOWARDS TRAFFIC AT A 30:1 RATE AND AWAY FROM TRAFFIC AT A 10:1 RATE TO MEET EXISTING FOUNDATION BARRIER FACE. ON THE CTA SIDE, TAPER BACK OF WALL AT A 3:1 RATE TO MEET BACK OF FOUNDATION. WIDENING OF WALL IS PAID FOR AS CONCRETE BARRIER TRANSITION (9 LF).

STATIONING

*** STATION PROVIDED FROM THE NB I-90/94 EXPRESS LANES

(***) STATION PROVIDED FROM THE NB I-90/94 LOCAL LANES

[***] STATION PROVIDED FROM THE SLIP RAMP

- LEGEND**
- TEMPORARY PAVEMENT (INTERSTATE)/TEMPORARY SHOULDER
 - TEMPORARY CONCRETE BARRIER

REVISIONS	
NAME	DATE
ADDENDUM I	8/12/05

ILLINOIS DEPARTMENT OF TRANSPORTATION
F.A.I. 94/90 (DAN RYAN EXPRESSWAY)
31ST STREET TO 71ST STREET
NB EXPRESS LANE RECONSTRUCTION
EXISTING AND PROPOSED PLAN
NORTHBOUND STA. 2382+00 TO STA. 2397+00

SCALE: 1"=50'
DATE: 7/7/05

DRAWN BY: TAJ
CHECKED BY: PJM



P:\02\009\035\com 148\5\cead\4\app\400\25\27 08/09/2005 04:26:37 PM